

DATE	
BY	
PLAN	
SURVEYED	
PLOTTED	
ALIGNMENT CHECKED	
NOTE BOOK	
CADD FILE NAME	
NO.	

DATE	
BY	
PLAN	
SURVEYED	
PLOTTED	
ALIGNMENT CHECKED	
NOTE BOOK	
CADD FILE NAME	
NO.	

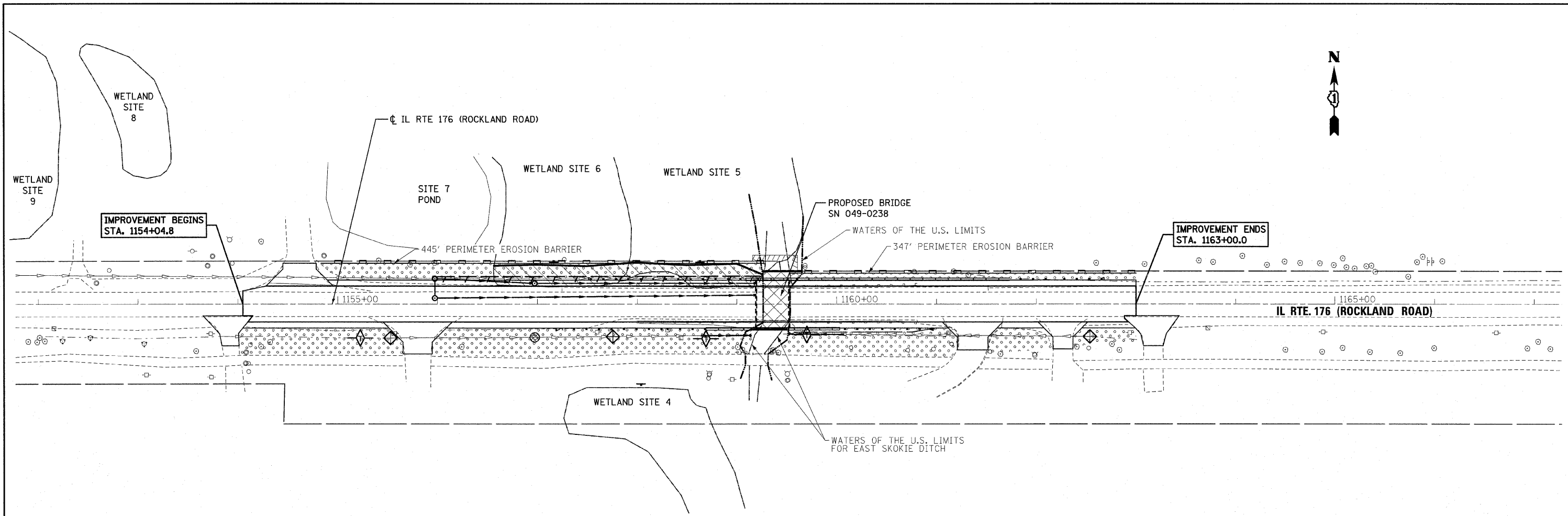

**EROSION CONTROL NOTES**

1. THE EROSION CONTROL MEASURES INDICATED ON THE PLANS ARE THE MINIMUM REQUIREMENTS. ADDITIONAL MEASURES MAY BE REQUIRED, AS DIRECTED BY THE ENGINEER.
2. THE CONTRACTOR SHALL TAKE ALL PRECAUTIONS TO PREVENT POLLUTION OF STORM WATER AND SHALL FOLLOW IEPA & IDOT CONSTRUCTION MEMORANDUM NO. 02-60.
3. ALL VEGETATIVE AND STRUCTURAL EROSION CONTROL PRACTICES SHALL BE CONSTRUCTED AND MAINTAINED IN ACCORDANCE WITH THE MINIMUM STANDARDS AND SPECIFICATIONS OF THE "ILLINOIS PROCEDURES AND STANDARDS FOR URBAN SOIL EROSION AND SEDIMENTATION CONTROL" AND THE "STANDARDS AND SPECIFICATIONS FOR SOIL EROSION AND SEDIMENT CONTROL" OF THE ILLINOIS ENVIRONMENTAL PROTECTION AGENCY.
4. SOIL DISTURBANCE SHALL BE CONDUCTED IN SUCH A MANNER AS TO MINIMIZE EROSION. SOIL STABILIZATION MEASURES SHALL CONSIDER THE TIME OF YEAR, SITE CONDITIONS AND THE USE OF TEMPORARY OR PERMANENT MEASURES.
5. THE MAINTENANCE AND REPAIR OR REPLACEMENT OF EROSION CONTROL ITEMS, WHEN DIRECTED BY THE ENGINEER, WILL NOT BE PAID FOR SEPARATELY, BUT SHALL BE INCLUDED IN THE COST OF THE ASSOCIATED PAY ITEMS.
6. ALL STORM SEWER FACILITIES THAT ARE OR WILL BE FUNCTIONING DURING CONSTRUCTION SHALL BE PROTECTED, FILTERED OR OTHERWISE TREATED TO REMOVE SEDIMENT. MUD AND SEDIMENT DEPOSITS SHALL BE REMOVED FROM THE ROADWAY AT THE END OF EACH WORK DAY BY SHOVELING AND/OR SWEEPING.
7. INLET FILTERS SHALL BE PLACED ON ALL CATCH BASINS, INLETS, AND MANHOLES WITH OPEN GRATES.
8. THE CONTRACTOR SHALL APPLY TEMPORARY EROSION CONTROL SEEDING TO ALL ERODIBLE BARE EARTH AREAS WITHIN 7 DAYS AFTER THE EARTH IS EXPOSED. APPLICATION RATE USED: 100 LB/ACRE
9. BROADCASTING OF THE SEED BY MACHINE, HAND METHODS, HYDRAULIC SEEDING OR OTHER METHODS APPROVED BY THE ENGINEER WILL BE ALLOWED FOR TEMPORARY EROSION CONTROL SEEDING.
10. TOPSOIL AND FERTILIZER NUTRIENTS ARE NOT REQUIRED FOR TEMPORARY EROSION CONTROL SEEDING.
11. SEED BED PREPARATION WILL NOT BE REQUIRED FOR TEMPORARY EROSION CONTROL SEEDING IF THE SOIL IS IN A LOOSE CONDITION. LIGHT DISKING SHALL BE DONE IF THE SOIL IS HARD PACKED OR CAKED.
12. MULCH WILL NOT BE REQUIRED AFTER TEMPORARY EROSION CONTROL SEEDING HAS BEEN COMPLETED ON AREAS WITH SLOPES FLATTER THAN 1:3 (V:H) THAT ARE TEMPORARY SEEDED BEFORE NOVEMBER 2.
13. MULCH, METHOD 2 (PROCEDURE 2) SHALL BE PLACED IN ACCORDANCE WITH THE REQUIREMENT OF THE STANDARD SPECIFICATIONS AFTER TEMPORARY EROSION CONTROL SEEDING HAS BEEN COMPLETED ON AREAS WITH SLOPES STEEPER THAN 1:3 (V:H) THAT ARE TEMPORARY SEEDED BEFORE NOVEMBER 2.
14. EROSION CONTROL BLANKET SHALL BE PLACED IN ACCORDANCE WITH THE REQUIREMENTS OF THE STANDARD SPECIFICATIONS AFTER TEMPORARY EROSION CONTROL SEEDING HAS BEEN COMPLETED ON ALL AREAS THAT ARE TEMPORARY SEEDED ON OR AFTER NOVEMBER 2.
15. ALL TEMPORARY INFORMATION SIGNS, PERIMETER EROSION BARRIER AND TEMPORARY FENCE SHALL BE INSTALLED WITHIN THE TEMPORARY EASEMENT, PROPOSED RIGHT-OF-WAY OR EXISTING RIGHT-OF-WAY.
16. 'WETLANDS' SIGNS SHALL BE ATTACHED TO THE PERIMETER EROSION BARRIER POST AT EACH WETLAND. SIGNS ARE AVAILABLE FROM THE IDOT ROADSIDE DEVELOPMENT UNIT (847) 705-4171. THE COST TO PICK UP AND INSTALL THESE SIGNS FROM THE IDOT ROADSIDE DEVELOPMENT UNIT SHALL BE INCLUDED IN THE PAY ITEM FOR 'PERIMETER EROSION BARRIER'.

**EROSION CONTROL LEGEND**

PERIMETER EROSION BARRIER	
RIPRAP	
TEMPORARY INFORMATION SIGNING (FOR WETLAND AREAS)	
TEMPORARY EROSION CONTROL SEEDING	
DRAINAGE PROTECTION (PAID FOR AS PERIMETER EROSION BARRIER)	
INLET FILTER	
TEMPORARY DITCH CHECK	

1160J67-sht-eros.dgn  
2/1/2011  
2:13:48 PM



DESIGNED	NWS	REVISED	- 2/10/2011
DRAWN	NWS	REVISED	-
CHECKED	RJD	REVISED	-
DATE	JANUARY 3, 2011	REVISED	-

**STATE OF ILLINOIS  
DEPARTMENT OF TRANSPORTATION**

**IL ROUTE 176 OVER EAST SKOKIE DITCH  
EROSION CONTROL PLAN**

SCALE: 1"=50' SHEET NO. 1 OF 1 SHEETS STA. TO STA.

F.A.U. RTE.	SECTION	COUNTY	TOTAL SHEETS	SHEET NO.
1238	C-B-I	LAKE	62	17
CONTRACT NO. 60J67				
ILLINOIS FED. AID PROJECT				