

STORM SEWER KEY
 10 DRAINAGE STRUCTURE NUMBER
 10 STORM SEWER NUMBER

ABBREVIATIONS
 1-CL FRAMES & LIDS, TYPE 1, CLOSED LID
 FST PRECAST REINFORCED CONCRETE FLAT SLAB TOP
 MH-A* MANHOLES, TYPE A, *FT DIA
 RCP PRECAST REINFORCED CONCRETE PIPE
 CMP CORRUGATED METAL PIPE
 WALL PIPE OUTLETS THROUGH BRIDGE WALL
 INV PIPE INVERT
 SS-T2-A STORM SEWER, TYPE 2, CLASS A
 PC-T1-D PIPE CULVERT, TYPE 1, CLASS D
 TBF TRENCH BACKFILL
 MES METAL END SECTION FOR PIPE CULVERTS

PIPE TABLE									
NO	TYPE	UPSTREAM STATION	DOWNSTREAM STATION	MAT	SIZE	SLOPE	LIN FT	TBF (CYD)	
1	SS-T2-A	1156+97 21.0 LT	1159+19 21.0 LT	RCP	30"	0.18%	220	174	
2	SS-T2-A	1155+97 25.5 LT	1156+97 21.0 LT	RCP	30"	0.16%	96	75	
3	SS-T2-A	1155+97 6.0 LT	1159+19 9.0 LT	RCP	30"	0.14%	320	162	
4	SS-T2-A	1155+97 25.5 LT	1155+97 6.0 LT	RCP	30"	0.67%	15	9	
5	PC-T1-D	1158+65 31.7 RT	1159+14 31.3 RT	CMP	15"	*1.18%	47	35	
6	PC-T1-D	1160+07 30.4 RT	1159+52 30.0 RT	CMP	18"	*1.89%	53	12	*MATCH EXISTING

DATE: _____ BY: _____
 SURVEYED: _____ GRADES CHECKED: _____
 PLAN: _____ NOTE BOOK NO.: _____
 NO. _____

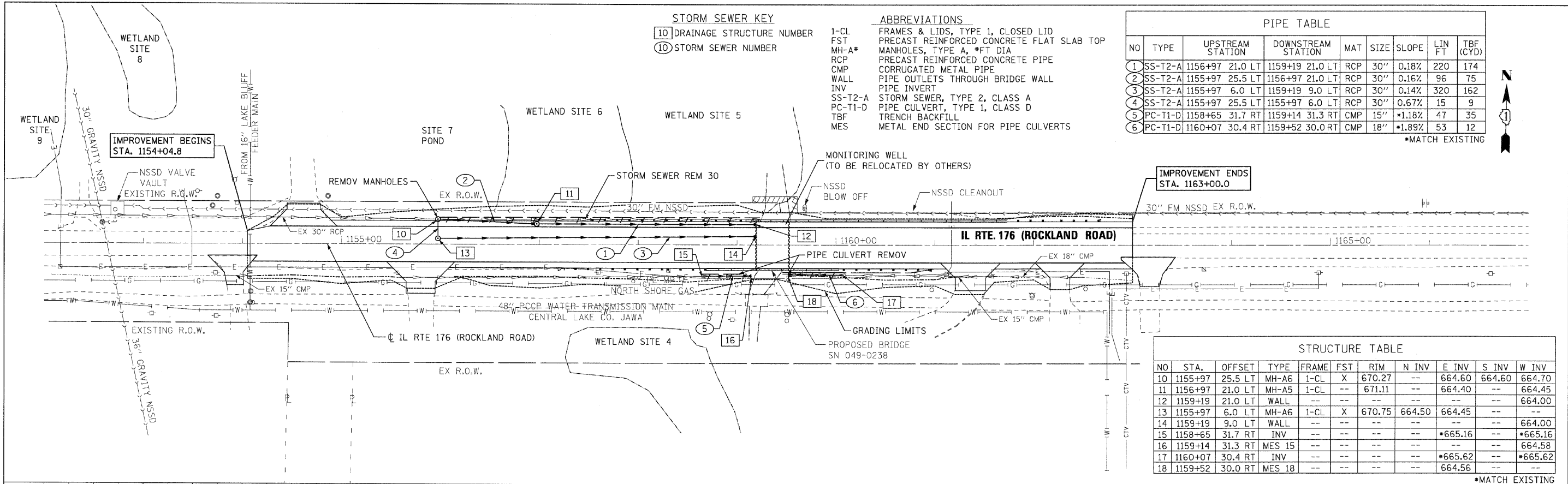

STRUCTURE TABLE											
NO	STA.	OFFSET	TYPE	FRAME	FST	RIM	N INV	E INV	S INV	W INV	
10	1155+97	25.5 LT	MH-A6	1-CL	X	670.27	--	664.60	664.60	664.70	
11	1156+97	21.0 LT	MH-A5	1-CL	--	671.11	--	664.40	--	664.45	
12	1159+19	21.0 LT	WALL	--	--	--	--	--	--	664.00	
13	1155+97	6.0 LT	MH-A6	1-CL	X	670.75	664.50	664.45	--	--	
14	1159+19	9.0 LT	WALL	--	--	--	--	--	--	664.00	
15	1158+65	31.7 RT	INV	--	--	--	--	*665.16	--	*665.16	
16	1159+14	31.3 RT	MES 15	--	--	--	--	--	--	664.58	
17	1160+07	30.4 RT	INV	--	--	--	--	*665.62	--	*665.62	
18	1159+52	30.0 RT	MES 18	--	--	--	--	664.56	--	--	*MATCH EXISTING

DATE: _____ BY: _____
 SURVEYED: _____ GRADES CHECKED: _____
 PROFILE: _____ NOTE BOOK NO.: _____
 NO. _____

