

DATE	
BY	
DESIGNED	
CHECKED	
ALIGNED	
NOTED	
FILED	
NO.	

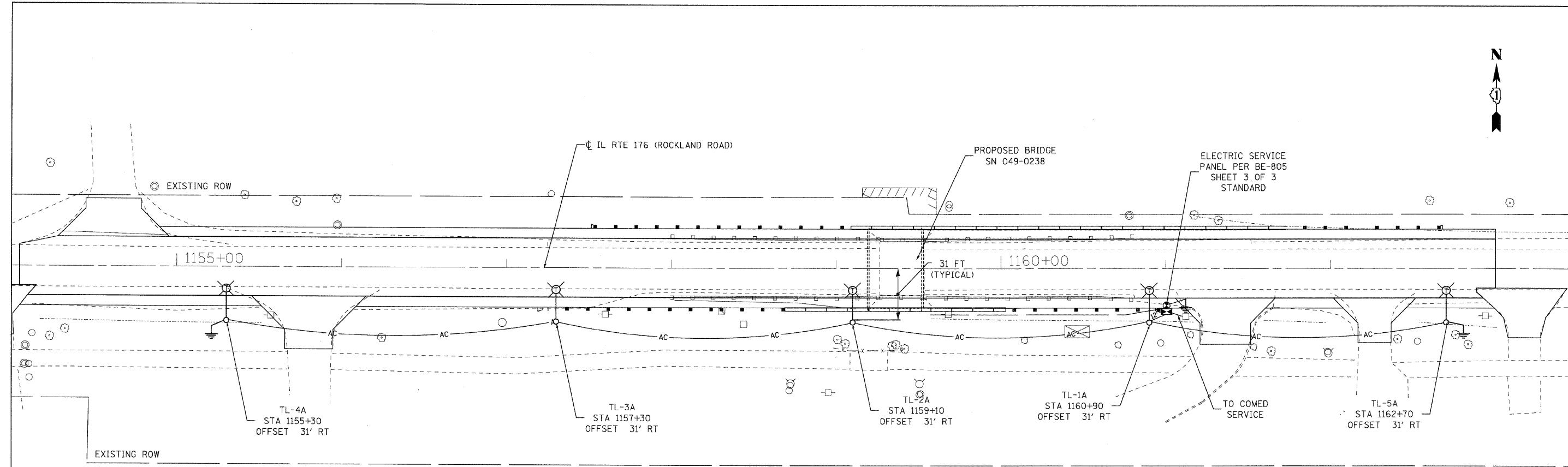

DATE	
BY	
DESIGNED	
CHECKED	
ALIGNED	
NOTED	
FILED	
NO.	

GENERAL NOTES

- CONTACT TO THE ELECTRIC UTILITY SHALL BE INITIATED BEFORE THE PRECONSTRUCTION MEETING, AND DOCUMENTATION OF CONTACT SHALL BE PRESENTED AT THAT MEETING. NO PLACEMENT OF POLES WILL BE ALLOWED WITHOUT EVIDENCE OF SIGNED AGREEMENT WITH THE ELECTRIC UTILITY, FURNISHED TO THE ENGINEER.
- THE LAYOUT PRESENTED APPLIES TO THE BRIDGES NOT EXCEEDING 250' SPAN AS DESCRIBED IN NOTE 2 OF SHEET 1 OF 3 (BE-805) IDOT PLAN.
- THE LAYOUT OF THE TEMPORARY EQUIPMENT WILL VARY BASED ON FIELD CONDITIONS, STAGING, UTILITY IMPACTS, AND ELECTRIC SERVICE LOCATION AS COORDINATED WITH ELECTRIC UTILITY. THE CONTRACTOR SHALL SUBMIT A PLAN INDICATING SETTING OF POLES, TRAFFIC SIGNAL AND COMBINED POWER SERVICE. PLANS MUST BE APPROVED BY ENGINEER BEFORE POLES ARE PLACED.
- THE ELECTRIC SERVICE SHALL BE 240/120V. WHERE 240 V SERVICE IS NOT AVAILABLE CONTRACTOR WILL SUBMIT A PROPOSAL FOR 120V SERVICE. DROP CABLE MAIN BREAKER AND ALL OTFGHER SERVICE APPURTENANCES SHALL BE APPROPRIATELY RATED & INCLUDED REGARDLESS OF THE SERVICE VOLTAGE APPLIED.
- LIGHT POLE SETBACK FROM THE EDGE OF TRAVEL PAVEMENT SHALL BE 18 FT. UNLESS THE LIGHT POLE IS BEHIND GUARDRAIL. THE LIGHT POLES INSTALLED BEHIND THE GUARDRAIL OR BARRIER WALL SHOULD HAVE 8 FT. SETBACK FROM THE BACK OF SHOULDER AND/OR AS DIRECTED BY ENGINEER.
- EACH LIGHTING UNIT SHALL BE CONTROLLED BY A PHOTO CELL MOUNTED ON EACH LUMINAIRE FED FROM TEMPORARY SERVICE DISCONNECT BOX. OTHERS MEANS OF LUMINAIRE CONTROL CAN BE CONSIDERED IF APPROVED BY THE ENGINEER.
- CONTRACTOR SHALL SPLICE AERIAL CABLE AT THE LIGHT POLE USING HEAT SHRINKABLE CAPS WITH FACTORY APPLIED WATER PROOF SEALANT OR APPROVED UL LISTED AERIAL TAP DEVICE. ALL AREAS DISTURBED UNDER THIS CONTRACT SHALL BE RESTORED TO ORIGINAL CONDITION TO SATISFACTION OF ENGINEER.
- REMOVAL OF TEMPORARY LIGHTS IS INCLUDED IN THE PAY ITEM "TEMPORARY LIGHTING FOR SINGLE LANE STAGING".

TEMPORARY LIGHTING LEGEND

- 400W, 120V MCIII HPS, WITH PHOTOCELL, 15' MA, 50' MH ON WOOD POLE, CLASS 4
- 3-1/C N02 AERIAL CABLE ALUMINUM WITH MESSENGER WIRE
- TEMPORARY LIGHTING UNIT NUMBER-ONE CIRCUIT A
- GROUND ROD 5/8" DIA x 10'
- TEMPORARY LIGHTING CONTROLLER
- TEMPORARY WOOD POLE NOMINAL 60 FT, CLASS 4

SCHEDULE OF QUANTITY

PAY ITEM #	DESCRIPTION	UNIT	QUANTITY
X0326276	TEMPORARY LIGHTING FOR SINGLE LANE STAGING	L SUM	1

...D160J67-shf-llght.dgn
12/23/2010
9:43:23 AM



DESIGNED	SM	REVISED	-
DRAWN	GEW	REVISED	-
CHECKED	RJD	REVISED	-
DATE	JANUARY 3, 2011	REVISED	-

STATE OF ILLINOIS
DEPARTMENT OF TRANSPORTATION

IL ROUTE 176 OVER EAST SKOKIE DITCH
TEMPORARY LIGHTING PLAN

SCALE: 1"=30' SHEET NO. OF SHEETS STA. TO STA.

F.A.U. RTE.	SECTION	COUNTY	TOTAL SHEETS	SHEET NO.
1238	C-B-1	LAKE	61	28
CONTRACT NO. 60J67				
ILLINOIS FED. AID PROJECT				