

RESTORATION OF WORK AREA

RESTORATION OF THE TRAFFIC SIGNAL WORK AREA SHALL BE INCIDENTAL TO THE RELATED PAY ITEM SUCH AS FOUNDATION, CONDUIT, HANDHOLE, TRENCH AND BACKFILL, ETC., AND NO EXTRA COMPENSATION SHALL BE ALLOWED. ALL ROADWAY SURFACES SUCH AS SHOULDERS, MEDIANS, SIDEWALKS, PAVEMENT, ETC. SHALL BE REPLACED IN KIND. ALL DAMAGE TO MOWED LAWNS SHALL BE REPLACED WITH AN APPROVED SOD, AND ALL DAMAGE TO UNMOWED FIELDS SHALL BE SEED IN ACCORDANCE WITH STANDARD SPECIFICATIONS 252 AND 250 RESPECTIVELY.

THE FOLLOWING ITEMS SHALL BE REMOVED BY THE CONTRACTOR AND SHALL BE DISPOSED OF BY THEM OUTSIDE THE RIGHT-OF-WAY AT THEIR EXPENSE. THE SALVAGE VALUE OF THE REMOVED EQUIPMENT SHALL BE REFLECTED IN THE CONTRACT BID PRICE.

- 1 EACH CONTROLLER AND CABINET (COMPLETE)
- 5 EACH SIGNAL HEAD, 1-FACE, 3-SECTION
- 2 EACH SIGNAL HEAD, 1-FACE, 4-SECTION
- 1 EACH SIGNAL HEAD, 1-FACE, 5-SECTION
- 1 EACH SIGNAL HEAD, 2-FACE, 1-3 SECTION, 1-5 SECTION
- 4 EACH TRAFFIC SIGNAL BACKPLATE
- 1 EACH TRAFFIC SIGNAL POST

NOTE:

THE CONTRACTOR SHALL BE REQUIRED TO MAINTAIN THE OPERATION OF THE TRAFFIC SIGNALS DURING THE ENTIRE PROJECT.

NOTE:

ALL EXISTING SIGNAL HEADS SHALL BE REPLACED WITH L.E.D. SIGNAL HEADS.

REMOVAL AND INSTALLATION NOTES:

- 1 REMOVE EXISTING CONTROLLER AND CABINET. INSTALL NEW FULL-ACTUATED CONTROLLER AND TYPE IV CABINET. INSTALL 4 FEET CONCRETE MAINTENANCE PAD (SEE DETAIL "A" ON THIS SHEET). INSTALL UPS.
- 2 REMOVE EXISTING SIGNAL HEAD, 2-FACE, 1-3 SECTION, 1-5 SECTION, BRACKET MOUNTED. INSTALL NEW SIGNAL HEAD, LED, 2-FACE, 5-SECTION, BRACKET MOUNTED.
- 3 REMOVE EXISTING SIGNAL HEAD, 1-FACE 3-SECTION, BRACKET MOUNTED. INSTALL NEW SIGNAL HEAD, LED, 1-FACE 3-SECTION, BRACKET MOUNTED.
- 4 REMOVE EXISTING SIGNAL HEAD, 1-FACE 3-SECTION, MAST ARM MOUNTED.
- 5 INSTALL NEW SIGNAL HEAD, LED, 1-FACE 3-SECTION, MAST ARM MOUNTED.
- 6 REMOVE EXISTING SIGNAL HEAD, 1-FACE 5-SECTION, MAST ARM MOUNTED.
- 7 INSTALL NEW SIGNAL HEAD, LED, 1-FACE 5-SECTION, MAST ARM MOUNTED.
- 8 REMOVE EXISTING SIGNAL HEAD, 1-FACE, 4-SECTION, BRACKET MOUNTED. INSTALL NEW SIGNAL HEAD, LED, 3-FACE, 3-SECTION, BRACKET MOUNTED.
- 9 REMOVE EXISTING SIGNAL HEAD, 1-FACE, 4-SECTION, BRACKET MOUNTED. INSTALL NEW SIGNAL HEAD, LED, 1-FACE, 3-SECTION, BRACKET MOUNTED.
- 10 INSTALL NEW SIGNAL HEAD, LED, 1-FACE 3-SECTION, BRACKET MOUNTED.
- 11 REMOVE EXISTING SIGNAL HEAD, 1-FACE, 3-SECTION, BRACKET MOUNTED. REMOVE POST AND FOUNDATION.

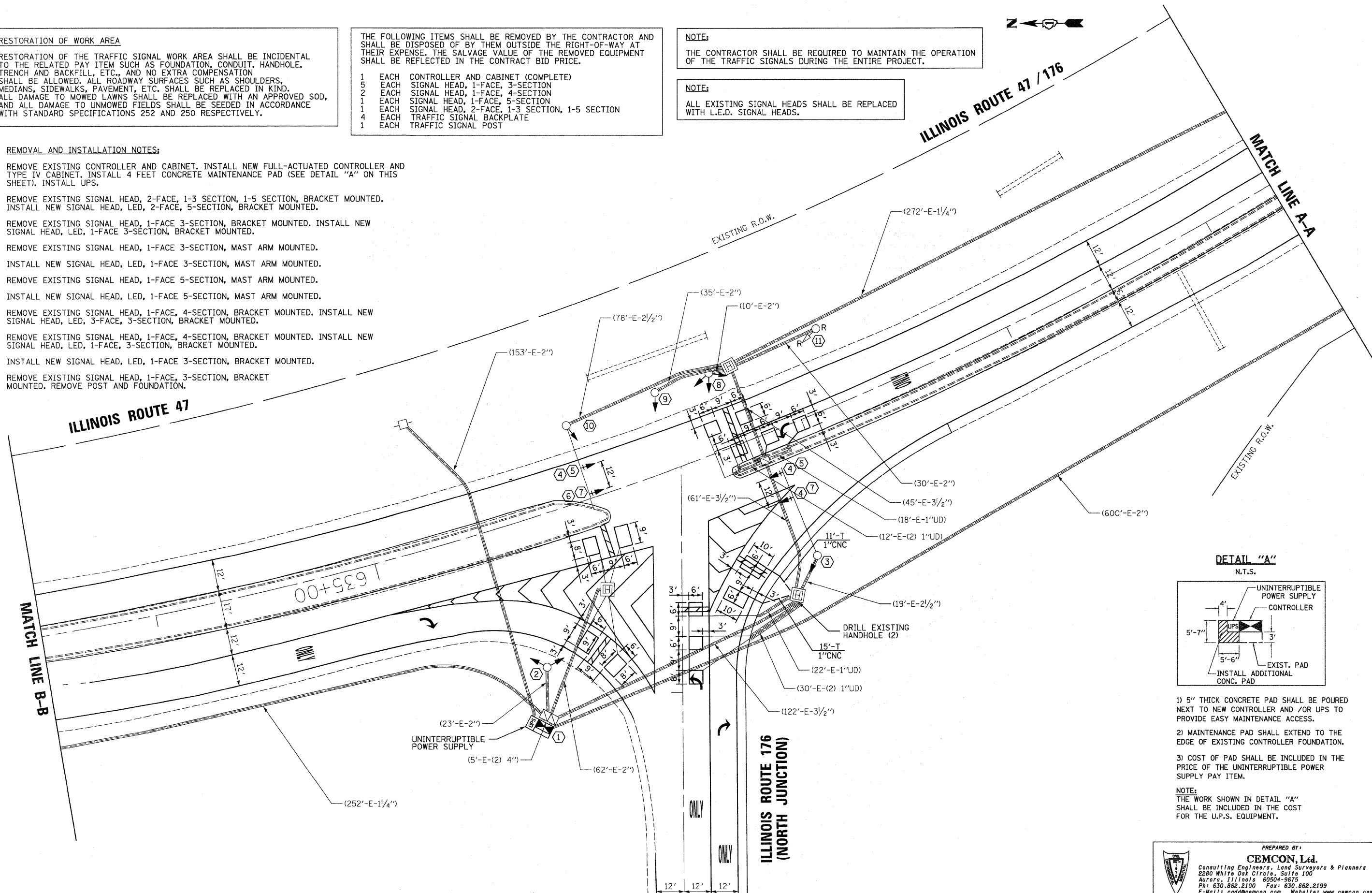

DETAIL "A"
N.T.S.

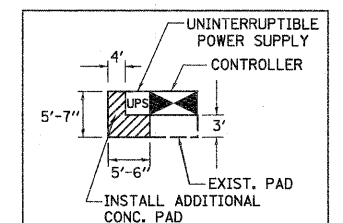

- 1) 5" THICK CONCRETE PAD SHALL BE POURED NEXT TO NEW CONTROLLER AND /OR UPS TO PROVIDE EASY MAINTENANCE ACCESS.
 - 2) MAINTENANCE PAD SHALL EXTEND TO THE EDGE OF EXISTING CONTROLLER FOUNDATION.
 - 3) COST OF PAD SHALL BE INCLUDED IN THE PRICE OF THE UNINTERRUPTIBLE POWER SUPPLY PAY ITEM.
- NOTE:**
THE WORK SHOWN IN DETAIL "A" SHALL BE INCLUDED IN THE COST FOR THE U.P.S. EQUIPMENT.

PREPARED BY:
CEMCON, Ltd.
Consulting Engineers, Land Surveyors & Planners
2280 White Oak Circle, Suite 100
Aurora, Illinois 62904-9875
Ph: 630.862.2100 Fax: 630.862.2199
E-Mail: cadd@cemcon.com Website: www.cemcon.com

FILE NAME = MICROST\3520\93\ RTE 47 WEST SIG.DGN	USER NAME = RDS	DESIGNED - KK	REVISED -
PLOT SCALE = 1"=20'	CHECKED - BPT	REVISIONS -	REVISIONS -
PLOT DATE = 12-17-10	DATE - 12-17-10	REVISIONS -	REVISIONS -

STATE OF ILLINOIS
DEPARTMENT OF TRANSPORTATION

TRAFFIC SIGNAL MODIFICATION PLAN
ILLINOIS ROUTE 47 / 176 AT ILLINOIS ROUTE 176 (NORTH JUNCTION)

SCALE: N.T.S. SHEET NO. OF SHEETS STA. TO STA.

F.A.P. RTE. 326	SECTION 105 N-4	COUNTY McHENRY	TOTAL SHEETS 60	SHEET NO. 33
FED. ROAD DIST. NO. ILLINOIS		FED. AID PROJECT		
		CONTRACT NO. 60K18		