

**ANCHOR BOLT DETAILS**

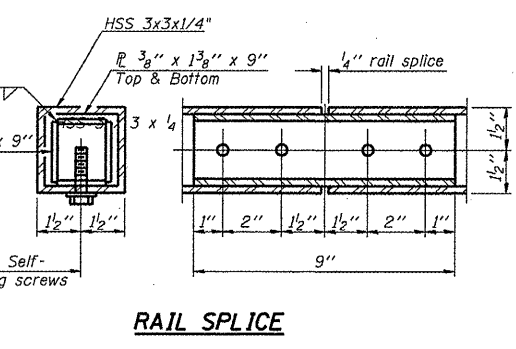
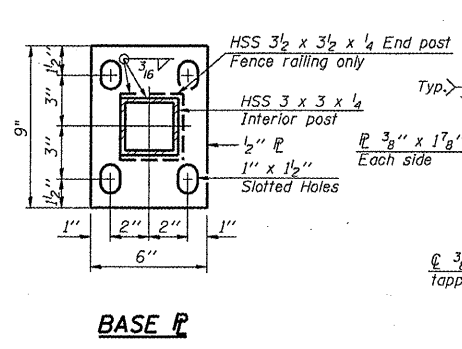

The Contractor shall use 5/8" diameter epoxy grouted anchors according to the Standard Specification 584.

All steel rail elements shall be galvanized according to Article 509.05 of the Standard Specifications.

**BILL OF MATERIAL**

| Item                            | Unit | Total Quantity | Loc. 1          |
|---------------------------------|------|----------------|-----------------|
| Bridge Fence Railing (Sidewalk) | Foot | 398            | 022-0143<br>398 |

7-1-10 (10'-0" Maximum Post Spacing)

|   |                            |            |           |
|---|----------------------------|------------|-----------|
| FILE NAME =   | USER NAME = gorengautab    | DESIGNED - | REVISED - |
| as\pwwork\pwwork\gorengautab\0208786\0164110-sht-plen.dgn | 0164110-sht-plen.dgn       | DRAWN -    | REVISED - |
|   | PLOT SCALE = 1/8" = 1' IN. | CHECKED -  | REVISED - |
|   | PLOT DATE = 12/8/2010      | DATE -     | REVISED - |

**STATE OF ILLINOIS**  
**DEPARTMENT OF TRANSPORTATION**

**BRIDGE FENCE RAILING, SIDEWALK MOUNTED (MODIFIED)**  
**STRUCTURE NO. 022-0143**

SCALE: SHEET NO. OF SHEETS STA. TO STA.

|                           |            |        |              |           |
|---------------------------|------------|--------|--------------|-----------|
| F.A.P. RTE.               | SECTION    | COUNTY | TOTAL SHEETS | SHEET NO. |
| 338                       | 2010-123-1 | DUPAGE | 11           | ?         |
| CONTRACT NO. 60M60        |            |        |              |           |
| ILLINOIS FED. AID PROJECT |            |        |              |           |