

Existing Structures: S.N. 099-0301 carrying I-80 Eastbound over Houbolt Road was constructed in 1992 as FAI Route 80, Section 99-2(K & HB-1 R). The structure consists of a single-span plate girder beam and reinforced concrete deck superstructure supported by integral abutments. The skew is 14°03'57" forward left.

Stage construction shall be utilized to maintain traffic during construction.

No salvage.

**INDEX OF SHEETS**

1. General Plan, Notes & Total Bill of Material
- 2-3. For Information Only - Existing Drainage System Details

**TOTAL BILL OF MATERIAL**

ITEM	UNIT	SUPER	SUB	TOTAL
Concrete Sealer	Sq. Ft.	10,000	-	10,000
Cleaning Drainage System	L Sum	1	-	1
Bonded Preformed Joint Sealer, 4 Inch	Foot	92	-	92

**SCOPE OF WORK**

1. Apply concrete sealer to bridge deck, parapets and approach slabs.
2. Clean bridge drainage system.
3. Remove and replace preformed joint seal at end of approach pavement.

**DESIGN SPECIFICATIONS**

2002 AASHTO Standard Specifications for Highway Bridges, 17th Edition

**DESIGN STRESSES**

f'c = 3,500 psi

**GENERAL NOTES**

1. Plan dimensions and details relative to existing plans are subject to nominal construction variations. The Contractor shall field verify existing dimensions and details affecting new construction and make necessary approved adjustments prior to construction or ordering of materials. Such variations shall not be cause for additional compensation for a change in scope of work, however, the Contractor will be paid for the quantity actually furnished at the unit price bid for the work.
2. Concrete Sealer shall be applied to the bridge deck and the inside vertical and the top horizontal face of parapets, and approach slabs. All surfaces to be sealed should be thoroughly cleaned prior to sealer application. Cost of cleaning is included with Concrete Sealer, see Special Provisions.
3. Clean Drainage System shall include bridge deck scuppers and approach slab drainage structures and shall be performed according to Special Provision Cleaning Drainage System.
4. Cost of preformed joint seal removal included in the cost of Bonded Preformed Joint Seal, 4".
5. See roadway plans for maintenance of traffic requirements.

6. Sidewalks adjacent to Houbolt Road are under the jurisdiction of the Forest Preserve District of Will County as part of the Rock Run Trail. The Contractor shall obtain a permit from the Forest Preserve District of Will County for access to the structure or placement of materials or equipment requiring the use of the sidewalks underneath the structure. The cost of the permit and other requirements by the District shall be included in the cost of Clean Drainage System. The Contractor shall contact the Forest Preserve District of Will County prior to starting any work at:

Forest Preserve District of Will County  
 Attn: Deborah Specht  
 Real Estate Manager  
 17540 W. Laraway Road  
 Joliet, IL 60433  
 (815) 722-5471

7. Existing pavement markings shall be temporarily covered prior to application of the deck surface treatment, to prevent the material from being applied to the markings. The temporary covering shall be removed after application of the deck surface treatment and prior to opening to traffic. Cost included with Concrete Sealer.

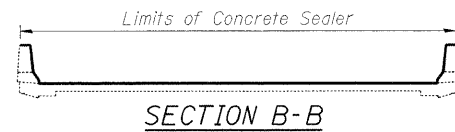

SECTION B-B

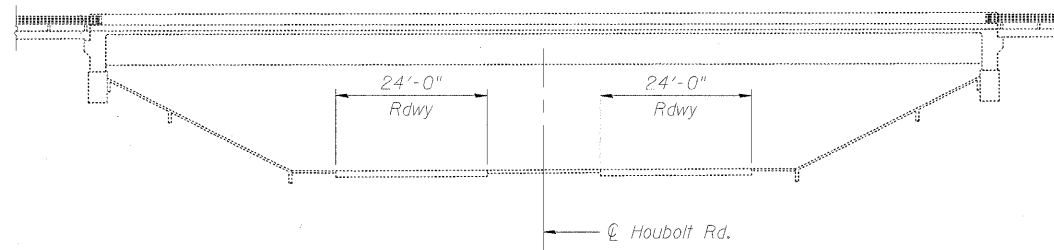

ELEVATION

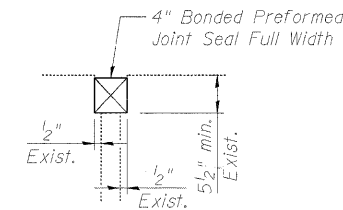

SECTION A-A

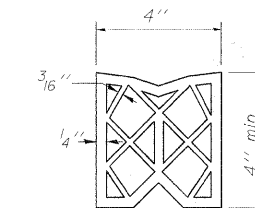

PREFORMED JOINT SEAL

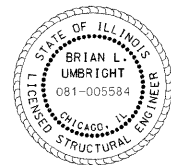

SIGNED: *Brian L. Umbright*  
 DATE: Jan. 17, 2011  
 EXPIRES: November 30, 2012

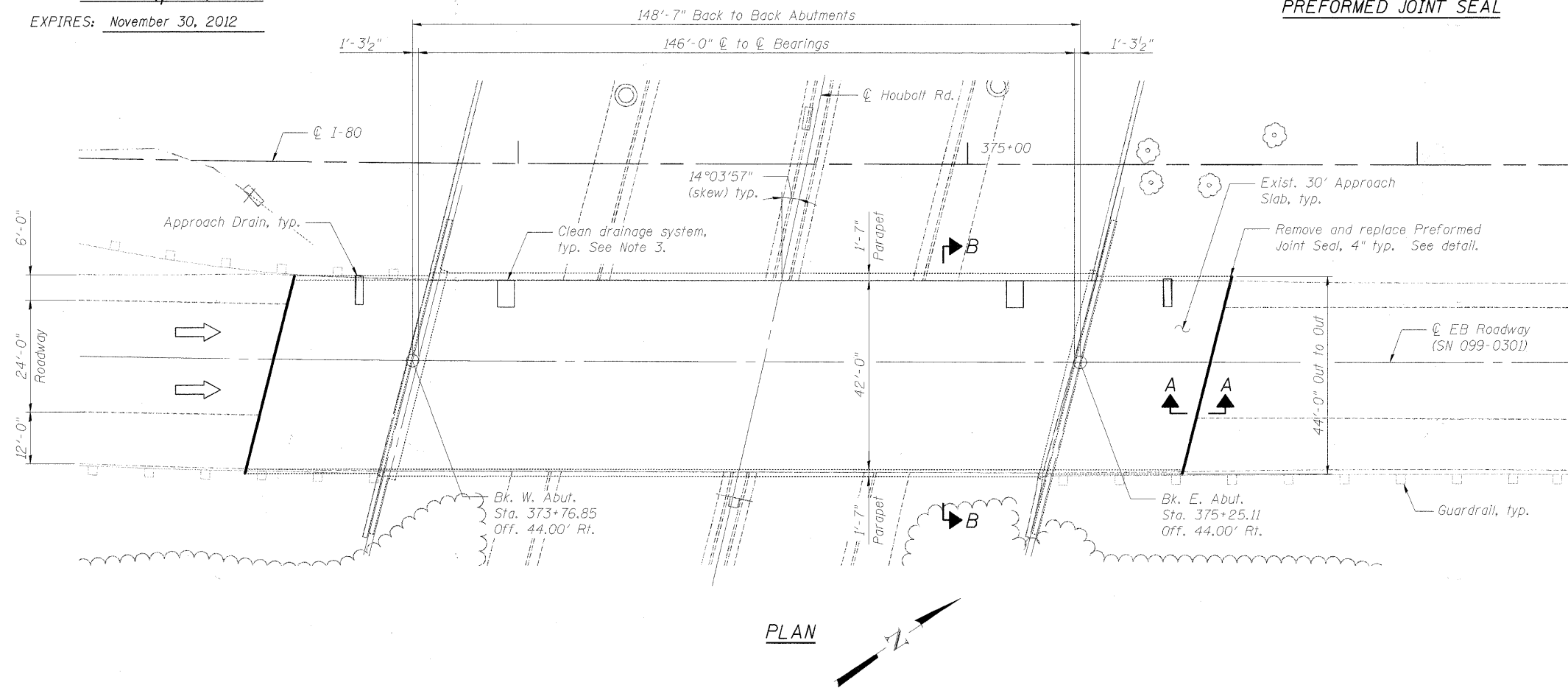

PLAN

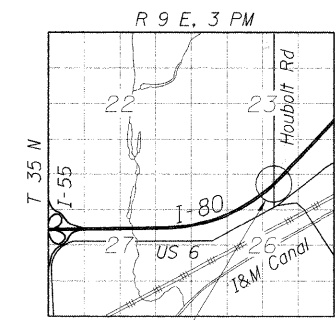

LOCATION SKETCH

DESIGNED - JJ	REVISÉ -
DRAWN - LAM	REVISÉ -
CHECKED - DF	REVISÉ -
DATE - 01/21/2011	REVISÉ -



STATE OF ILLINOIS  
 DEPARTMENT OF TRANSPORTATION

GENERAL PLAN, NOTES & TOTAL BILL OF MATERIAL  
 EASTBOUND FAI-80 OVER HOUBOLT ROAD  
 STRUCTURE NO. 099-0301

SHEET NO. S-1 OF S-3 SHEETS

F.A.I. RTE.	SECTION	COUNTY	TOTAL SHEETS	SHEET NO.
80	99-1-RS-4	WILL	116	95
FED. ROAD DIST. NO.			ILLINOIS FED. AID PROJECT	