

CONTRACT 60M65 - WESTBOUND MIDLAND AVENUE TO GRUNDY COUNTY LINE
 CONTRACT 60M63 - EASTBOUND GRUNDY COUNTY LINE TO MIDLAND AVENUE

CONTRACT 60M66 - WESTBOUND US ROUTE 6 TO MIDLAND AVENUE
 CONTRACT 60M64 - EASTBOUND MIDLAND AVENUE TO US ROUTE 6

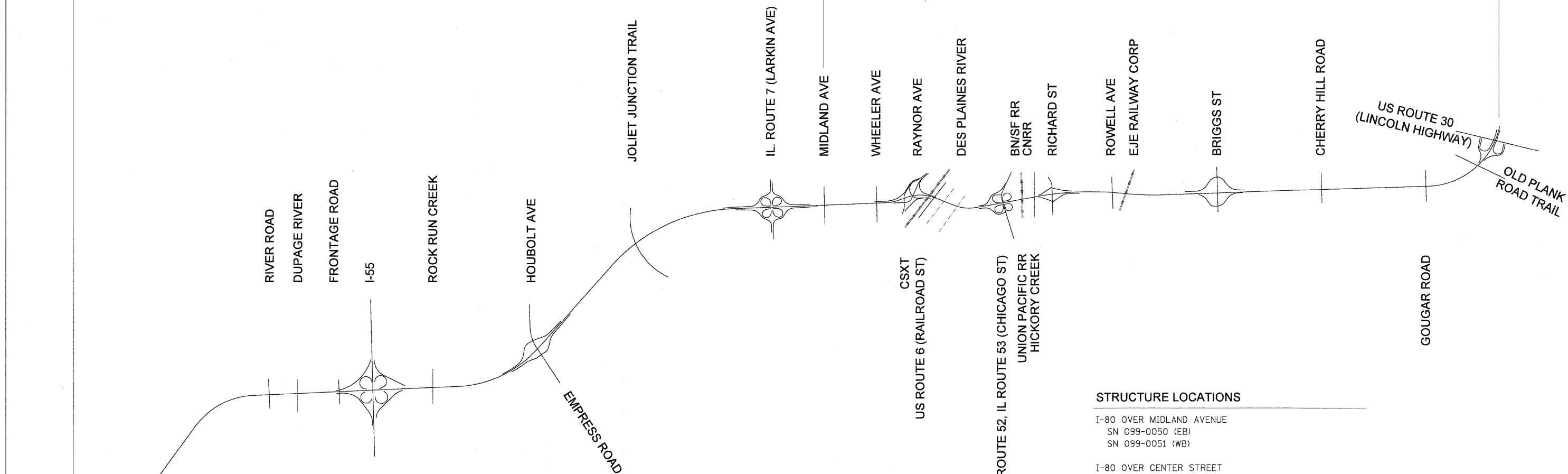

STRUCTURE LOCATIONS

- I-80 OVER DUPAGE RIVER
SN 099-0040 (EB)
SN 099-0041 (WB)
- I-55 SB TO I-80 WB RAMP
SN 099-0308
- I-80 OVER FRONTAGE ROAD
SN 099-0042 (EB)
SN 099-0043 (WB)
- I-80 OVER I-55
SN 099-0044 (EB)
SN 099-0045 (WB)
- I-80 OVER ROCK RUN CREEK
SN 099-0046 (EB)
SN 099-0047 (WB)
- I-80 OVER HOUBOLT ROAD
SN 099-0301 (EB)
SN 099-0302 (WB)
- I-80 OVER JOLIET JUNCTION TRAIL
SN 099-0048 (EB)
SN 099-0049 (WB)

STRUCTURE LOCATIONS

- I-80 OVER MIDLAND AVENUE
SN 099-0050 (EB)
SN 099-0051 (WB)
- I-80 OVER CENTER STREET
SN 099-0052 (EB)
SN 099-0053 (WB)
- I-80 OVER CENTER STREET RAMP
SN 099-0054 (WB)
SN 099-0055 (EB)
- I-80 OVER DES PLAINES RIVER / US-6 (RAILROAD ST)
SN 099-0056 (EB)
SN 099-0057 (WB)
- I-80 OVER IL53 / US-52 / CHICAGO ST
SN 099-0058 (WB)
SN 099-0059 (EB)
- I-80 OVER BNSF RR / GARDNER STREET
SN 099-0060 (EB)
SN 099-0061 (WB)
- I-80 OVER HICKORY CREEK
SN 099-0062 (EB)
SN 099-0063 (WB)
- I-80 OVER RICHARDS STREET
SN 099-0064 (EB)
SN 099-0065 (WB)
- I-80 OVER ROWELL AVE / EJE RR
SN 099-0066 (EB)
SN 099-0067 (WB)

USER NAME = ddrinkevich	DESIGNED - LLS/JG	REVISED -
PLOT SCALE = 50:1	DRAWN - PMS/DC	REVISED -
PLOT DATE = 18-JAN-2011	CHECKED - JAL	REVISED -
	DATE - 01/19/2011	REVISED -



**STATE OF ILLINOIS
 DEPARTMENT OF TRANSPORTATION**

SCHEMATIC DIAGRAM

SCALE: N.T.S. SHEET NO. 1 OF 1 SHEETS STA. N/A TO STA. N/A

F.A.I. RTE.	SECTION	COUNTY	TOTAL SHEETS	SHEET NO.
80	99 (3&4) RS-4	WILL	117	11
CONTRACT NO. 60M65				
FED. ROAD DIST. NO. 1 ILLINOIS FED. AID PROJECT				

FILE NAME = IP-FWP:ms34562\0160M63-sht-schematic.dgn