

NOTES

1. ALL EASTBOUND WORK IS IN CONTRACT 60M63 AND ALL WESTBOUND WORK IS IN CONTRACT 60M65.
2. THE CONTRACTOR SHALL USE IDOT STANDARDS 701446-02, 701400-05, AND 701406-06 FOR WORK ON I-55, REFER TO STRUCTURAL PLANS. ALL TRAFFIC CONTROL, DEVICES, BARRICADES, DRUMS, LANE CLOSURES, TEMPORARY PAVEMENT MARKINGS, ETC. ALONG THE CROSS ROADS WITHIN THE CONTRACT LIMITS, UNLESS OTHERWISE SPECIFIED IN THE TRAFFIC CONTROL PLANS, SHALL NOT BE PAID FOR SEPARATELY, BUT SHALL BE INCLUDED IN THE LUMP SUM FOR "TRAFFIC CONTROL AND PROTECTION (EXPRESSWAY)".
3. THE CONTRACTOR AT NO TIME SHALL CLOSE LANE 2 OF STAGED CONSTRUCTION AND SHALL NOT RESTRICT ACCESS TO OR FROM I-55.

LEGEND:

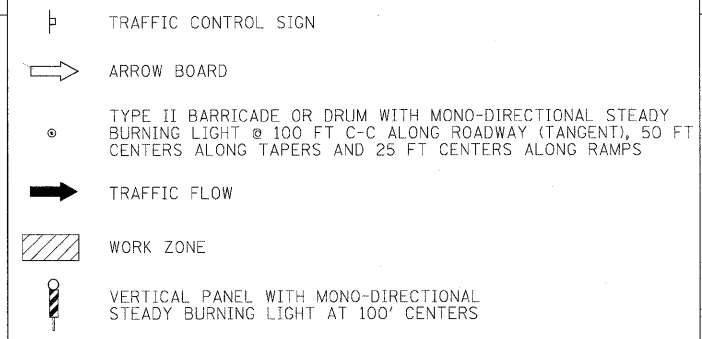

DESIGNED - LLS/JG	REVISED - 02/15/11
DRAWN - PMS/DC	REVISED -
CHECKED - JAL	REVISED -
DATE - 01/19/2011	REVISED -



**STATE OF ILLINOIS
DEPARTMENT OF TRANSPORTATION**

**MAINTENANCE OF TRAFFIC - STAGE 2
I-80 MAINLINE**

SCALE: 1"=50' SHEET NO. 2 OF 3 SHEETS STA. 275+00 TO STA. 305+00

F.A.I. RTE.	SECTION	COUNTY	TOTAL SHEETS	SHEET NO.
80	99 (3&4) RS-4	WILL	117	44
FED. ROAD DIST. NO. 1 ILLINOIS FED. AID PROJECT			CONTRACT NO. 60M65	

FILE NAME = IP_PWDms34560\1160M63-shr-MOT-STG-2.pln.03.dgn