

**LEGEND:**

- TRAFFIC CONTROL SIGN
- ARROW BOARD
- TYPE II BARRICADE OR DRUM WITH MONO-DIRECTIONAL STEADY BURNING LIGHT @ 100 FT C-C ALONG ROADWAY (TANGENT), 50 FT CENTERS ALONG TAPERS AND 25 FT CENTERS ALONG RAMPS
- TRAFFIC FLOW
- WORK ZONE
- VERTICAL PANEL WITH MONO-DIRECTIONAL STEADY BURNING LIGHT AT 100' CENTERS

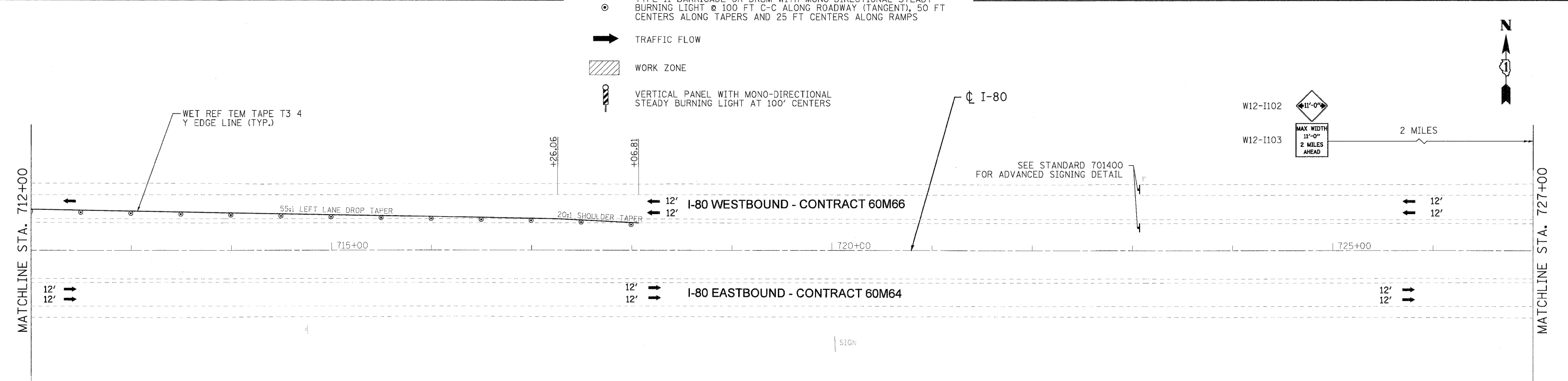

- NOTES:**
- ALL I-80 EASTBOUND WORK INCLUDED IN CONTRACT NO. 60M64 AND ALL I-80 WESTBOUND WORK INCLUDED IN CONTRACT NO. 60M66.
  - SIGNS W12-I102 AND W12-I103 SHALL ALSO BE PLACED ON BRIGGS STREET AND US ROUTE 30 FOR TRAFFIC TURNING ONTO THE I-80 WESTBOUND RAMPS.

USER NAME = mvaak(Rdwy_Lis1e)	DESIGNED - MJV	REVISED -		<b>STATE OF ILLINOIS</b> <b>DEPARTMENT OF TRANSPORTATION</b>	<b>MAINTENANCE OF TRAFFIC - STAGE 2</b> <b>I-80 MAINLINE</b>			F.A.I. RTE.	SECTION	COUNTY	TOTAL SHEETS	SHEET NO.	
PLOT CONFIG = PDF(Large).plt	DRAWN - MJV	REVISED -						80	99 (4 & 4-1) RS-3	WILL	203	57	
PLOT SCALE = 1:50	CHECKED - DTH	REVISED -			SCALE: 1"=50'			SHEET NO. 11 OF 11 SHEETS STA. 697+00.00 TO STA. 727+00.00			CONTRACT NO. 60M66		
PLOT DATE = 1/18/2011	DATE - 1/20/2011	REVISED -			FED. ROAD DIST. NO. 1 ILLINOIS FED. AID PROJECT								

FILE NAME = ...N160M64-shr-staging-02-03.dgn