

**STAGE I CONSTRUCTION & TRAFFIC**  
(Looking East)

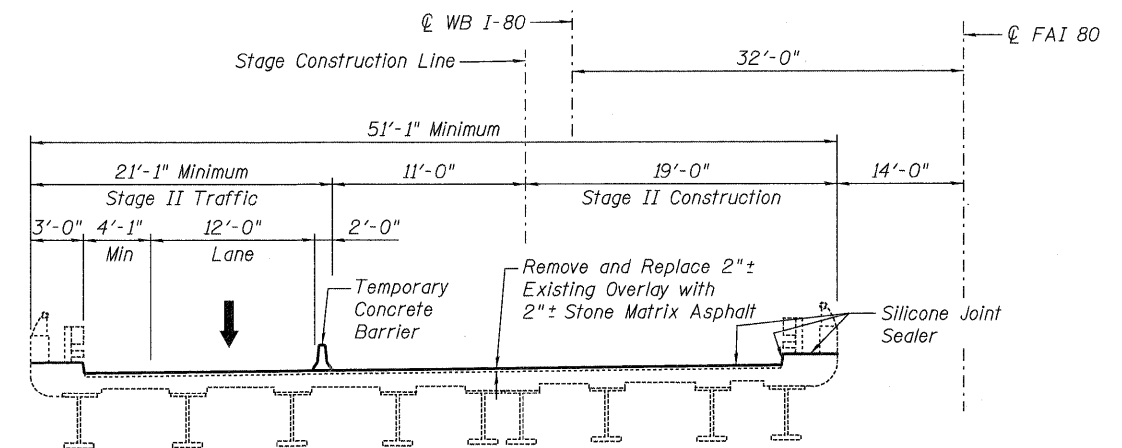

**STAGE II CONSTRUCTION & TRAFFIC**  
(Looking East)

ITEM	UNIT	TOTAL
Polymerized Hot-Mix Asphalt Surface Course, Stone Matrix Asphalt, N80	Ton	151
Hot-Mix Asphalt Surface Removal (Deck)	Sq. Yd.	1,340
Protective Shield	Sq. Yd.	1,564

**NOTES:**

- Limits of protective shield extend from abutment to abutment and from out to out of parapet.
- For temporary concrete barrier details, see Standard 704001. Cost included in Roadway Plans. For anchoring to bridge deck, see Sheet S-8 of 8.

DESIGNED - PCA	REVISED -
DRAWN - RCW	REVISED -
CHECKED - MEA	REVISED -
DATE - 01/21/2011	REVISED -



**STATE OF ILLINOIS**  
**DEPARTMENT OF TRANSPORTATION**

**CONSTRUCTION STAGING**  
**WESTBOUND FAI-80 OVER HICKORY CREEK**  
**STRUCTURE NO. 099-0063**

SHEET NO. S-2 OF 8 SHEETS

F.A.I. RTE. 80	SECTION 99 (4&4-1) RS-3	COUNTY WILL	TOTAL SHEETS 203	SHEET NO. 167
CONTRACT NO. 60M66				
FED. ROAD DIST. NO. 1 (ILLINOIS) FED. AID PROJECT				