

TYPICAL SECTION
STA. 4191+83 TO STA. 4195+00

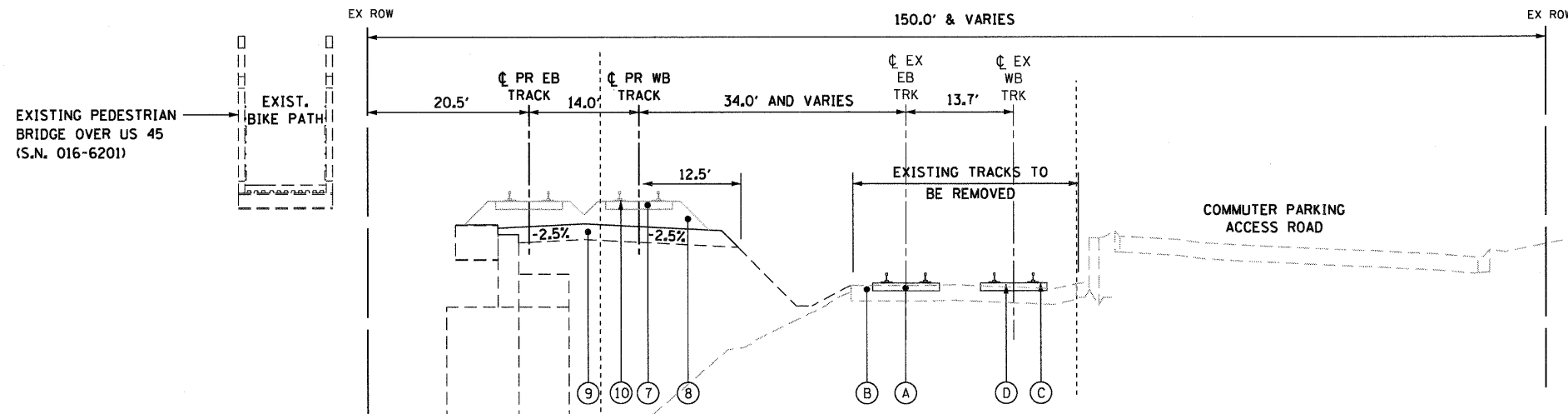

TYPICAL SECTION @ RAILROAD BRIDGE
STA. 4195+00 TO STA. 4197+50

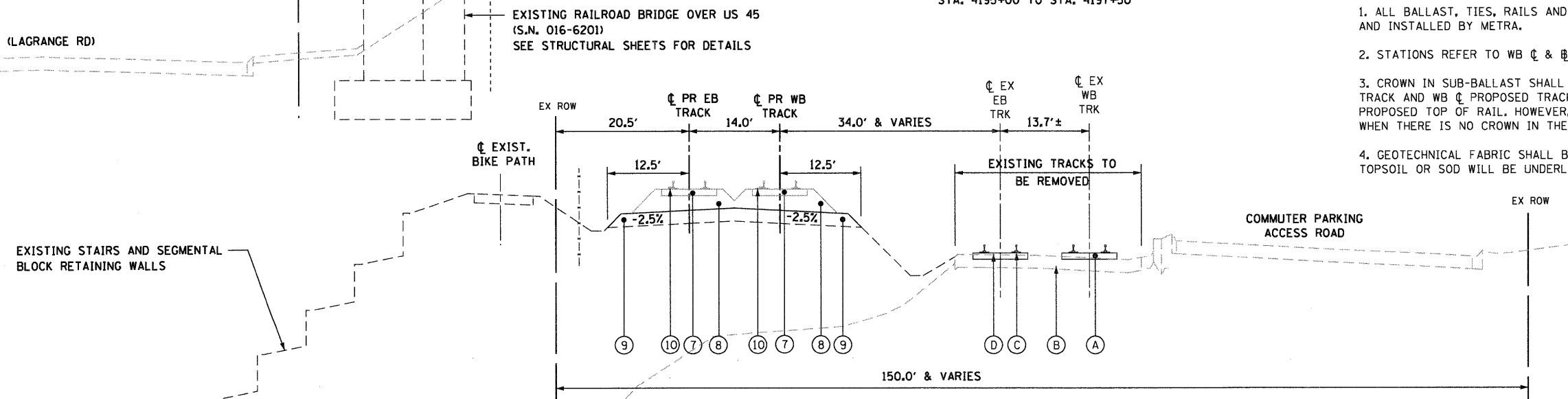

TYPICAL SECTION ADJACENT TO BIKE PATH
STA. 4197+50 TO STA. 4199+00

- EXISTING LEGEND**
- (A) 12" BALLAST
 - (B) 12" SUB-BALLAST
 - (C) RAILS
 - (D) TIMBER CROSS TIE
 - (E) SIDEWALK
 - (F) PLATFORM
- PROPOSED LEGEND**
- (1) HOT-MIX ASPHALT SURFACE COURSE, MIX "D", N50 1 1/2"
 - (2) BITUMINOUS MATERIALS (PRIME COAT)
 - (3) HOT-MIX ASPHALT BINDER COURSE, IL-19.0 N50 2 1/4"
 - (4) PORTLAND CEMENT CONCRETE BASE COURSE 9"
 - (5) AGGREGATE SUBGRADE 12"
 - (6) CONCRETE MEDIAN
 - (7) CROSS TIES
 - (8) 12" BALLAST
 - (9) 12" SUB-BALLAST
 - (10) RAILS
 - (11) TOPSOIL STRIPPING, 4" (NOTE 5)
 - (12) TIERED SEGMENTAL BLOCK WALL
 - (13) TOPSOIL FURNISH AND PLACE, 4"
 - (14) GEOTECHNICAL FABRIC FOR GROUND STABILIZATION (NOTE 4)
 - (15) SODDING, SALT TOLERANT
 - (16) EMBANKMENT
 - (17) HOT-MIX ASPHALT SURFACE COURSE, MIX "D", N50 (2")
 - (18) AGGREGATE (PRIME COAT)
 - (19) AGGREGATE BASE COURSE, TYPE B 6"
 - (20) CONCRETE GUTTER, TYPE B

- NOTES:**
1. ALL BALLAST, TIES, RAILS AND APPURTENANCES SHALL BE SUPPLIED AND INSTALLED BY METRA.
 2. STATIONS REFER TO WB C & E PROPOSED TRACK.
 3. CROWN IN SUB-BALLAST SHALL BE CENTERED BETWEEN EB C PROPOSED TRACK AND WB C PROPOSED TRACK AT AN ELEVATION OF 2.06' BELOW PROPOSED TOP OF RAIL. HOWEVER, THIS ELEVATION DOES NOT APPLY WHEN THERE IS NO CROWN IN THE BALLAST.
 4. GEOTECHNICAL FABRIC SHALL BE PLACED AT ALL LOCATIONS WHERE TOPSOIL OR SOD WILL BE UNDERLAIN BY EXISTING SUB-BALLAST.

McDonough Associates Inc.
 Engineers / Architects
 130 East Randolph Street, Chicago, Illinois 60601

FILE NAME = D162ND9-SHT-TYPICAL02.dgn	USER NAME = TKluegel	DESIGNED - BA	REVISED -	STATE OF ILLINOIS DEPARTMENT OF TRANSPORTATION	TYPICAL SECTIONS			F.A.P. RTE.	SECTION	COUNTY	TOTAL SHEETS	SHEET NO.	
PLOT SCALE = 1/10	CHECKED - MJT	DATE - 12/17/10	REVISED -		SCALE: N.T.S.	SHEET NO. 2 OF 4 SHEETS	STA.	TO STA.	330	2010-135-1	COOK	101	10
									TS-02		CONTRACT NO. 60N09		
									ILLINOIS FED. AID PROJECT				