

# DRAINAGE BASINS OF LAKE COUNTY

## I. FOX RIVER WATERSHED

1. Upper Fox River
2. Sequoit Creek
3. Fish Lake Drain
4. Squaw Creek
5. Lower Fox River
6. Multon Creek
7. Siocum Lake Drain
8. Tower Lake Drain
9. Flint Creek

## II. DES PLAINES RIVER WATERSHED

10. North Mill Creek
11. Mill Creek
12. Newport Drainage Ditch
13. Upper Des Plaines River
14. Bull Creek
15. Indian Creek
16. Lower Des Plaines River
17. Buffalo Creek
18. Aptakasic Creek

## III. LAKE MICHIGAN WATERSHED

19. Kellogg Creek
20. Dead River
21. Waukegan River
22. Pettibone Creek
23. Bluff/Ravine

## IV. CHICAGO RIVER WATERSHED

24. Skokie River
25. Middle Fork
26. West Fork

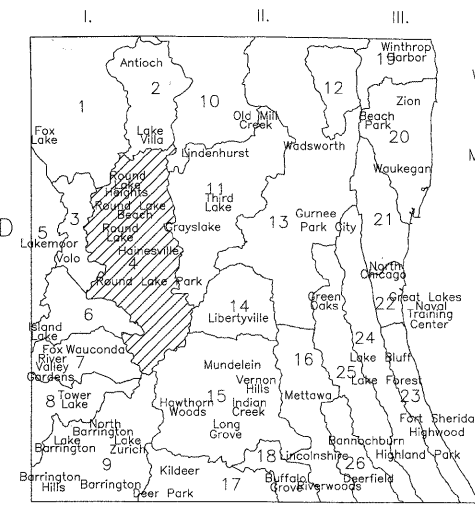

## SMC TYPICAL CONSTRUCTION SEQUENCE

1. INSTALLATION OF SOIL EROSION AND SEDIMENT CONTROL SE/SC MEASURES
    - A. SELECTIVE VEGETATION REMOVAL FOR SILT FENCE INSTALLATION
    - B. SILT FENCE INSTALLATION
    - C. CONSTRUCTION FENCING AROUND AREAS NOT TO BE DISTURBED
    - D. STABILIZED CONSTRUCTION ENTRANCE
  2. TREE REMOVAL WHERE NECESSARY (CLEAR & GRUB)
  3. CONSTRUCT SEDIMENT TRAPPING DEVICES (SEDIMENT TRAPS, BASINS\*)
  4. CONSTRUCT DETENTION FACILITIES AND OUTLET CONTROL STRUCTURE WITH RESTRICTOR & TEMPORARY PERFORATED RISER
  5. STRIP TOPSOIL, STOCKPILE TOPSOIL AND GRADE SITE
  6. TEMPORARILY STABILIZE TOPSOIL STOCKPILES (SEED AND SILT FENCE AROUND TOE OF SLOPE)
  7. INSTALL STORM SEWER, SANITARY SEWER, WATER AND ASSOCIATED INLET & OUTLET PROTECTION
  8. PERMANENTLY STABILIZE DETENTION BASINS WITH SEED AND EROSION CONTROL BLANKET
  9. TEMPORARILY STABILIZE ALL AREAS INCLUDING LOTS THAT HAVE REACHED TEMPORARY GRADE
  10. INSTALL ROADWAYS
  11. PERMANENTLY STABILIZE ALL OUTLOT AREAS
  12. INSTALL STRUCTURES AND GRADE INDIVIDUAL LOTS
  13. PERMANENTLY STABILIZE LOTS
  14. REMOVE ALL TEMPORARY SE/SC MEASURES AFTER THE SITE IS STABILIZED WITH VEGETATION
- \* SOIL EROSION AND SEDIMENT CONTROL MAINTENANCE MUST OCCUR EVERY TWO WEEKS AND AFTER EVERY 1/2" OR GREATER RAINFALL EVENT

## SEDIMENTATION AND EROSION CONTROL NOTES

1. SOIL DISTURBANCE SHALL BE CONDUCTED IN SUCH A MANNER AS TO MINIMIZE EROSION. SOIL STABILIZATION MEASURES SHALL CONSIDER THE TIME OF YEAR, SITE CONDITIONS AND THE USE OF TEMPORARY OR PERMANENT MEASURES.
2. SOIL EROSION AND SEDIMENT CONTROL FEATURES SHALL BE CONSTRUCTED PRIOR TO THE COMMENCEMENT OF HYDROLOGIC DISTURBANCE OF UPLAND AREAS.
3. DISTURBED AREAS SHALL BE STABILIZED WITH TEMPORARY OR PERMANENT MEASURES WITHIN 14 CALENDAR DAYS OF THE END OF ACTIVE HYDROLOGIC DISTURBANCE, OR REDISTURBANCE.
4. AREAS OR EMBANKMENTS HAVING SLOPES GREATER THAN OR EQUAL TO 3H:1V, AND APPROVED BY THE ENFORCEMENT OFFICER, SHALL BE STABILIZED WITH SOD, MAT, OR BLANKET IN COMBINATION WITH SEEDING.
5. EROSION CONTROL BLANKET SHALL BE REQUIRED ON ALL INTERIOR DETENTION BASIN SIDE SLOPES BETWEEN NORMAL WATER LEVEL AND HIGH WATER LEVEL.
6. ALL STORM SEWERS THAT ARE OR WILL BE FUNCTIONING DURING CONSTRUCTION SHALL BE PROTECTED BY AN APPROPRIATE SEDIMENT CONTROL MEASURE.
7. ALL TEMPORARY EROSION AND SEDIMENT CONTROL MEASURES SHALL BE REMOVED WITHIN 30 DAYS AFTER FINAL SITE STABILIZATION IS ACHIEVED OR AFTER THE TEMPORARY MEASURES ARE NO LONGER NEEDED.
8. ALL TEMPORARY AND PERMANENT EROSION CONTROL MEASURES MUST BE MAINTAINED AND REPAIRED AS NEEDED. THE PROPERTY OWNER SHALL BE ULTIMATELY RESPONSIBLE FOR MAINTENANCE AND REPAIR.
9. A STABILIZED MAT OF AGGREGATE UNDERLAIN WITH FILTER CLOTH (OR OTHER APPROPRIATE MEASURE) SHALL BE LOCATED AT ANY POINT WHERE TRAFFIC WILL BE ENTERING OR LEAVING A CONSTRUCTION SITE TO OR FROM A PUBLIC RIGHT-OF-WAY, STREET, ALLEY OR PARKING AREA. ANY SEDIMENT OR SOIL REACHING AN IMPROVED PUBLIC RIGHT-OF-WAY, STREET, ALLEY OR PARKING AREA SHALL BE REMOVED BY SCRAPING OR STREET CLEANING AS ACCUMULATIONS WARRANT AND TRANSPORTED TO A CONTROLLED SEDIMENT DISPOSAL AREA.
10. SOIL STOCKPILES SHALL NOT BE LOCATED IN A FLOOD PRONE AREA OR A DESIGNATED BUFFER PROTECTING WATERS OF THE UNITED STATES OR ISOLATED WATERS OF LAKE COUNTY.
11. IF DEWATERING SERVICES ARE USED, ADJOINING PROPERTIES AND DISCHARGE LOCATIONS SHALL BE PROTECTED FROM EROSION. DISCHARGES SHALL BE Routed THROUGH AN EFFECTIVE SEDIMENT CONTROL MEASURES (E.G. SEDIMENT TRAP, SEDIMENT BASIN, OR OTHER APPROPRIATE MEASURE.)
12. THE EROSION CONTROL MEASURES INDICATED ON THE PLANS ARE THE MINIMUM REQUIREMENTS. ADDITIONAL MEASURES MAY BE REQUIRED, AS DIRECTED BY THE ENGINEER OR GOVERNING AGENCY.
13. QUANTITIES HAVE BEEN PROVIDED FOR HEAVY DUTY EROSION CONTROL BLANKET, FLOCCULATION LOGS, FLOCCULATION POWDER, AND TEMPORARY FENCE TO BE USED AT THE DIRECTION OF THE RESIDENT ENGINEER.

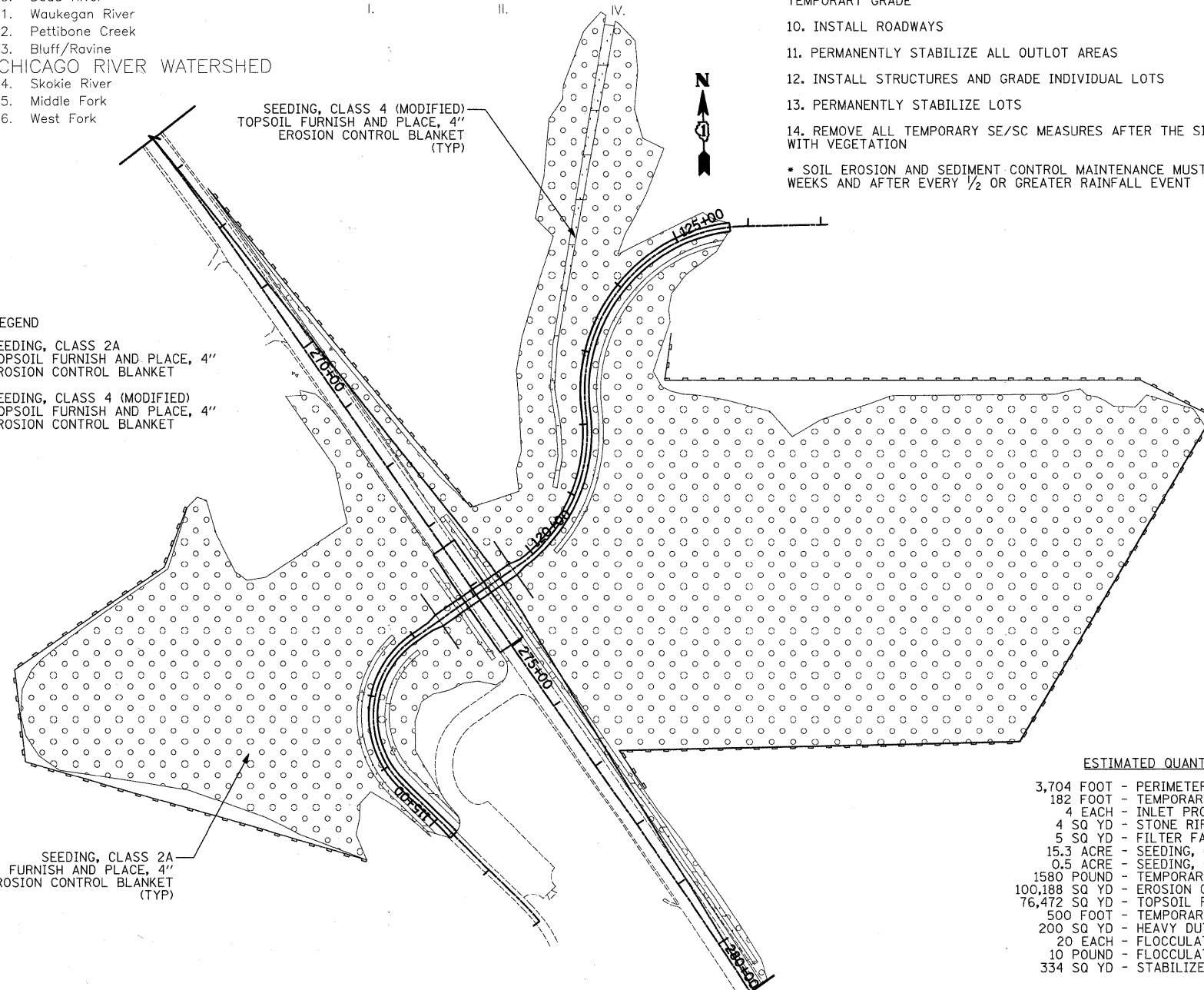

DATE	
BY	
SURVEYED	
PLOTTED	
TEMPLATE	
AREAS CHECKED	
NO.	

DATE	
BY	
SURVEYED	
PLOTTED	
TEMPLATE	
AREAS CHECKED	
NO.	

- LEGEND**
- SEEDING, CLASS 2A  
TOPSOIL FURNISH AND PLACE, 4"  
EROSION CONTROL BLANKET
  - SEEDING, CLASS 4 (MODIFIED)  
TOPSOIL FURNISH AND PLACE, 4"  
EROSION CONTROL BLANKET

**ESTIMATED QUANTITIES:**

- 3,704 FOOT - PERIMETER EROSION BARRIER
- 182 FOOT - TEMPORARY DITCH CHECKS
- 4 EACH - INLET PROTECTION, SPECIAL
- 4 SQ YD - STONE RIPRAP, CLASS A1
- 5 SQ YD - FILTER FABRIC
- 15.3 ACRE - SEEDING, CLASS 2A
- 0.5 ACRE - SEEDING, CLASS 4 (MODIFIED)
- 1580 POUND - TEMPORARY EROSION CONTROL SEEDING
- 100,188 SQ YD - EROSION CONTROL BLANKET
- 76,472 SQ YD - TOPSOIL FURNISH AND PLACE, 4"
- 500 FOOT - TEMPORARY FENCE
- 200 SQ YD - HEAVY DUTY EROSION CONTROL BLANKET
- 20 EACH - FLOCCULATION LOGS
- 10 POUND - FLOCCULATION POWDER
- 334 SQ YD - STABILIZED CONSTRUCTION ENTRANCE

**NOTE:**

1. STABILIZED CONSTRUCTION ENTRANCES SHALL BE CONSTRUCTED DURING BOTH STAGE 1 AND STAGE 2 AT LOCATIONS DESIGNATED BY THE ENGINEER.
2. ALL AREAS SHALL BE RESTORED WITH SEEDING, CLASS 2A AND EROSION CONTROL BLANKET, WITH THE EXCEPTION OF DITCH FLOW AREAS. DITCH FLOW AREAS SHALL BE SEEDING WITH CLASS 4 (MODIFIED) ALONG THE DITCH BOTTOM AND 2 FT EACH SIDE FOR THE BACK AND FRONT SLOPES.
3. EARTHWORK EXCAVATION SHALL CONSIST OF THE EXCAVATION AND TRANSPORTATION OF SUITABLE EXCAVATED MATERIAL TO EMBANKMENT LOCATIONS THROUGHOUT THE LIMITS OF THE TRAIL ALIGNMENT AT THE DIRECTION OF THE ENGINEER. THIS WORK SHALL ALSO INCLUDE EXCAVATION, TRANSPORTATION, AND DISPOSAL OF EXCESS AND UNSUITABLE MATERIALS. SUITABLE EXCAVATED MATERIALS SHALL NOT BE WASTED WITHOUT PERMISSION OF THE ENGINEER. ALL UNSUITABLE AND/OR EXCESS MATERIAL SHALL BE DISPOSED OF OUTSIDE THE TRAIL ALIGNMENT BUT IN PROXIMITY TO THE PROJECT CORRIDOR AND AT THE DIRECTION OF THE ENGINEER. THERE IS NO HAUL-OFF ANTICIPATED. REMOVAL AND DISPOSAL OF ALL EXCESS AND/OR SURPLUS, UNSTABLE, AND UNSUITABLE MATERIALS AND ORGANIC WASTE, SHALL BE INCLUDED IN THE CONTRACT UNIT PRICE FOR "EARTH EXCAVATION" AND "STRUCTURE EXCAVATION".
4. MAINTENANCE OF TEMPORARY EROSION CONTROL SYSTEMS SHALL INCLUDE THE REPAIR OF THE VARIOUS SYSTEMS, REMOVAL OF ENTRAPPED SEDIMENT AND CLEANING OF ANY SILT FILTER FABRIC. THE SEDIMENT SHALL BE REMOVED AS DIRECTED BY THE ENGINEER AND DISPOSED OF ACCORDING TO ARTICLE 202.03 OF THE "STANDARD SPECIFICATIONS". MAINTENANCE OF TEMPORARY EROSION CONTROL ITEMS SHALL BE INCLUDED IN THE COST OF TEMPORARY EROSION CONTROL ITEMS BEING INSTALLED.

USER NAME = pk	DESIGNED - PK	REVISED -
FILE NAME ...cd\sheet\05 EC\2130_EC.dgn	DRAWN - JRR	REVISED -
PLOT SCALE 60.00' / IN.	CHECKED - RTM	REVISED -
PLOT DATE = 12/16/2010	DATE - 12/17/2010	REVISED -

STATE OF ILLINOIS  
DEPARTMENT OF TRANSPORTATION

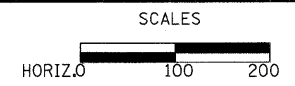

LANDSCAPING AND EROSION CONTROL  
FORT HILL TRAIL BIKE PATH UNDERPASS

F.A.U. RTE.	SECTION	COUNTY	TOTAL SHEETS	SHEET NO.
3602	08-F3000-07-BT	LAKE	60	10A
CONTRACT NO. 63422				
FED. ROAD DIST. NO. 1 ILLINOIS FED. AID PROJECT				

SHEET NO. 2 OF 2 SHEETS STA. TO STA.