

Existing Structure  
None

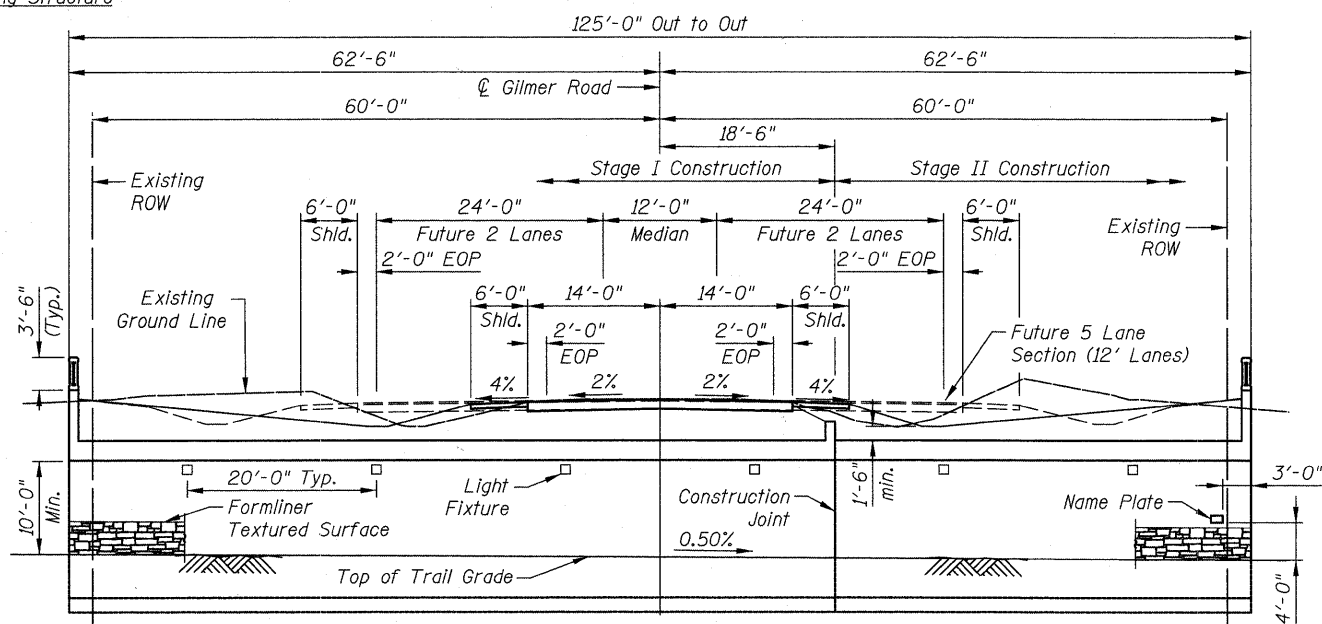

**LONGITUDINAL SECTION**  
(Looking North)

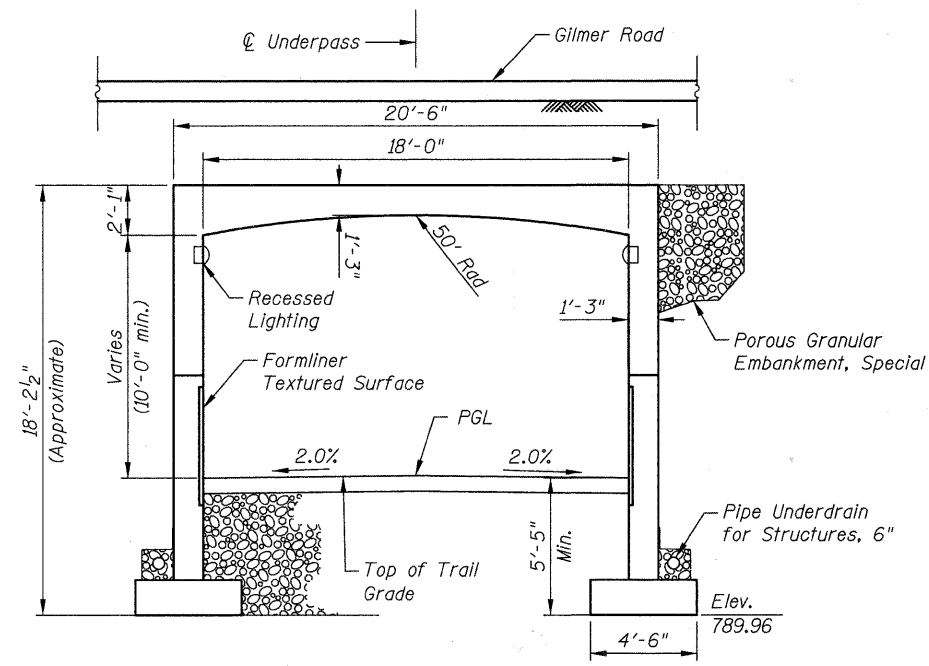

**CROSS SECTION**

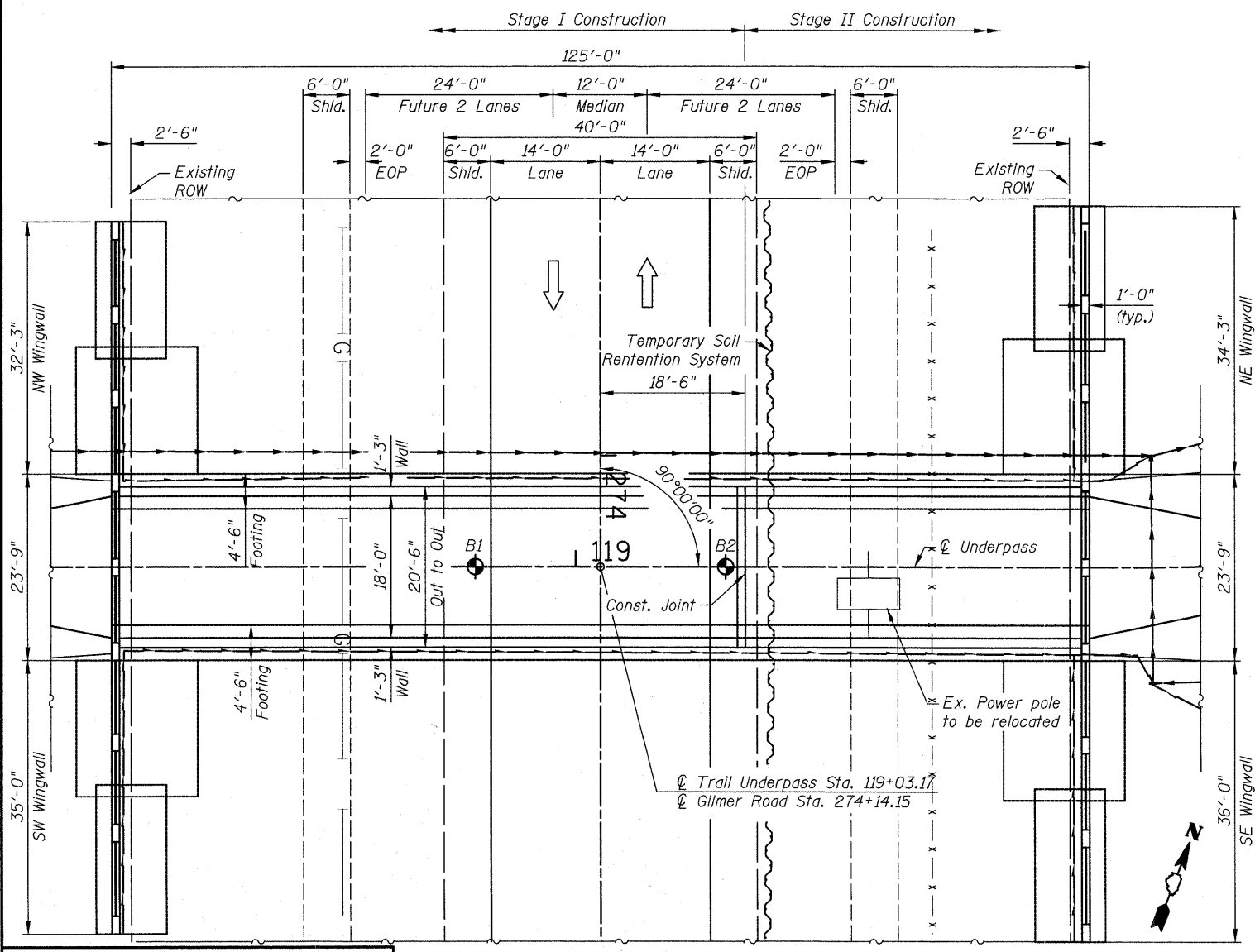

**PLAN**

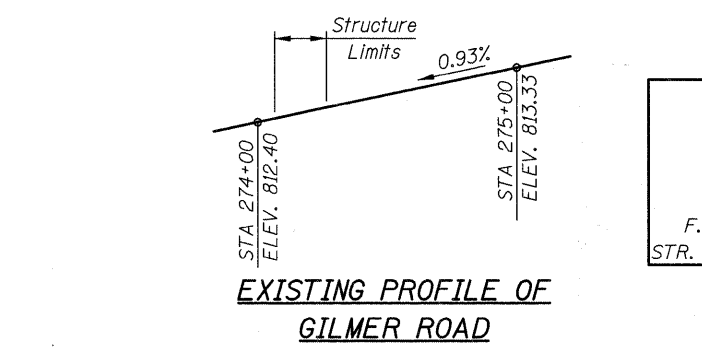

**EXISTING PROFILE OF GILMER ROAD**

GILMER ROAD  
BUILT 201 BY  
LAKE COUNTY FOREST  
PRESERVE DISTRICT  
SEC 08-00073-07-BT  
F.A.U. 3602 STA. 274+14.15  
STR. NO. 049-N006 LOADING HS20

**NAME PLATE**  
See Std. 515001

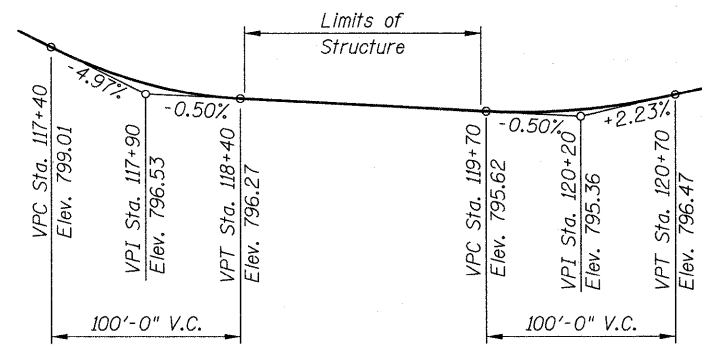

**PROPOSED PROFILE GRADE TRAIL UNDERPASS**

(Along PGL)

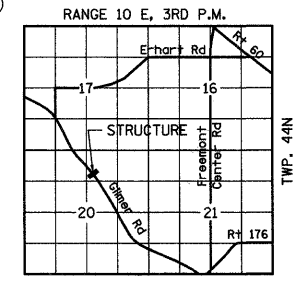

**LOCATION SKETCH**

- LEGEND**
- Pipe Underdrain
  - Storm Sewer
  - Gasline
  - x - x - x Fence
  - ⊙ Soil Boring Location

F.A.U. ROUTE NO.	SECTION	COUNTY	TOTAL SHEETS	SHEET NO.
3602	08-F3000-07-BT	LAKE	60	14

Contract #63422

**INDEX OF SHEETS**

- S1. General Plan & Longitudinal Section
- S2. General Notes & Total Bill of Material & Staging Details
- S3. Underpass Plan & Elevation
- S4. Underpass Details
- S5. West Wingwall Details
- S6. East Wingwall Details
- S7. Wingwall Details
- S8. Architectural Details
- S9. Bar Splicer Assembly Details
- S10. Temporary Concrete Barrier Details
- S11. Soil Boring Logs

**DESIGN SPECIFICATIONS**

AASHTO Standard Spec. for Highway Bridges

**DESIGN STRESSES**

**FIELD UNITS**

$f'_c = 3,500$  psi  
 $f_y = 60,000$  psi (Reinforcement)

**BEARING PRESSURES**

Maximum applied bearing pressure = 3,000 psf  
Allowable bearing pressure = 3,000 psf

**LOADING HS-20**

Allow 50 psf for Future Wearing Surface.

CIVILTECH ENGINEERING, INC.  
GREGORY J. HATLESTAD, S.E.



GREGORY J. HATLESTAD, S.E.  
# 081-005562

EXP 11/30/2012

DATE 12/17/2010

I certify that to the best knowledge, information and belief, this bridge design is structurally adequate for the design loading shown on the plans. The design is an economical one for the style of the structure and complies with requirements of the current AASHTO Standard Specifications for Highway Bridges.

LAKE COUNTY FOREST PRESERVE DISTRICT

**GENERAL PLAN & LONGITUDINAL SECTION**  
**GILMER ROAD TRAIL UNDERPASS**  
**SEC 08-F3000-07-BT**  
**STA. 274+14.15**  
**STRUCTURE NO. 049-N006**

DRAWN BY: D. Atkins  
CHECKED BY: G. Hatlestad  
DATE: December 17, 2010

REVISIONS	
NAME	DATE

**CIVILTECH**  
450 E Devon Ave, Suite 300  
Itasca, Illinois 60143  
Tel: 630.773.3900 Fax: 630.773.3975  
www.civiltechinc.com

j:\2010\phase 2\cd\sheet\07\_struct\01.dgn 12/17/2010 12:20:07 PM