

PLAN	REVISION	DATE
NO.	NO.	NO.
BY	BY	BY
DATE	DATE	DATE

PROFILE	REVISION	DATE
NO.	NO.	NO.
BY	BY	BY
DATE	DATE	DATE

FILE NAME = L:\KANE\CO\202\6093\Dr-04\Exhibit\Site\Assessments\CADD_Sheets\DR_06.dwg

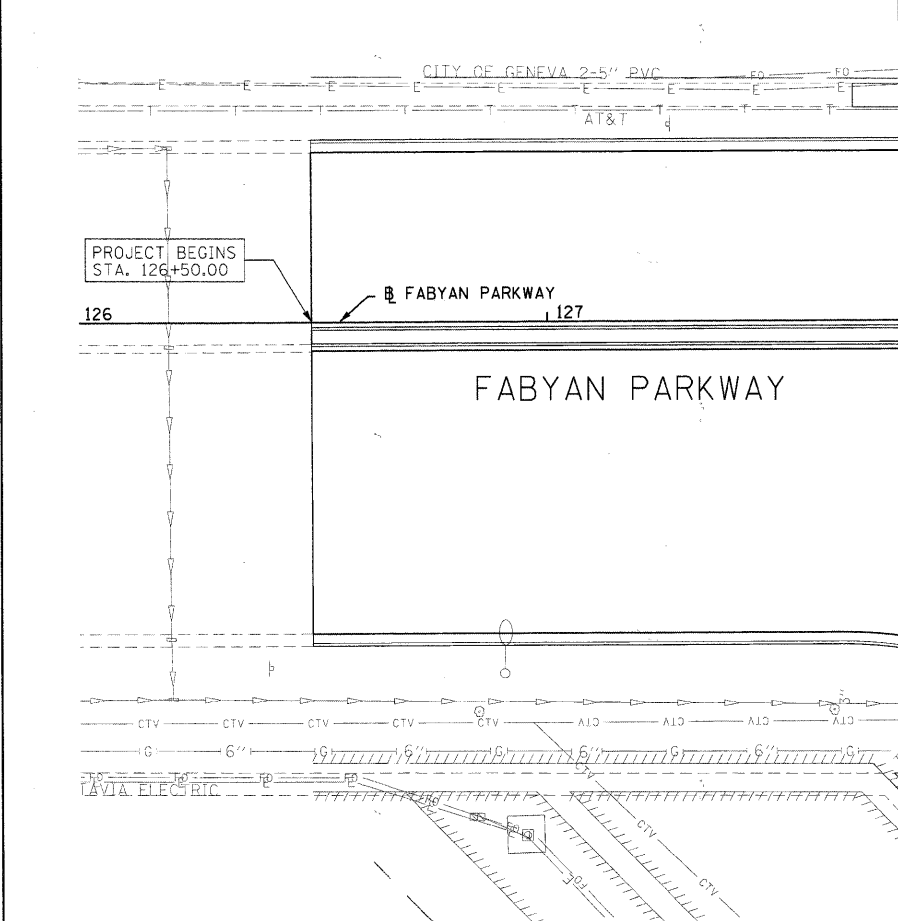

MATCHLINE STA. 127+75.00 (SEE SHEET NO. 46)

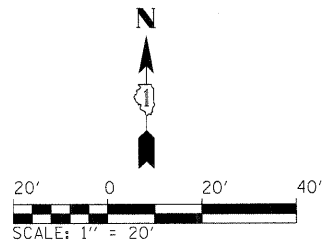

SEE DRAINAGE AND UTILITY SHEET 46 FOR DRAINAGE INFORMATION

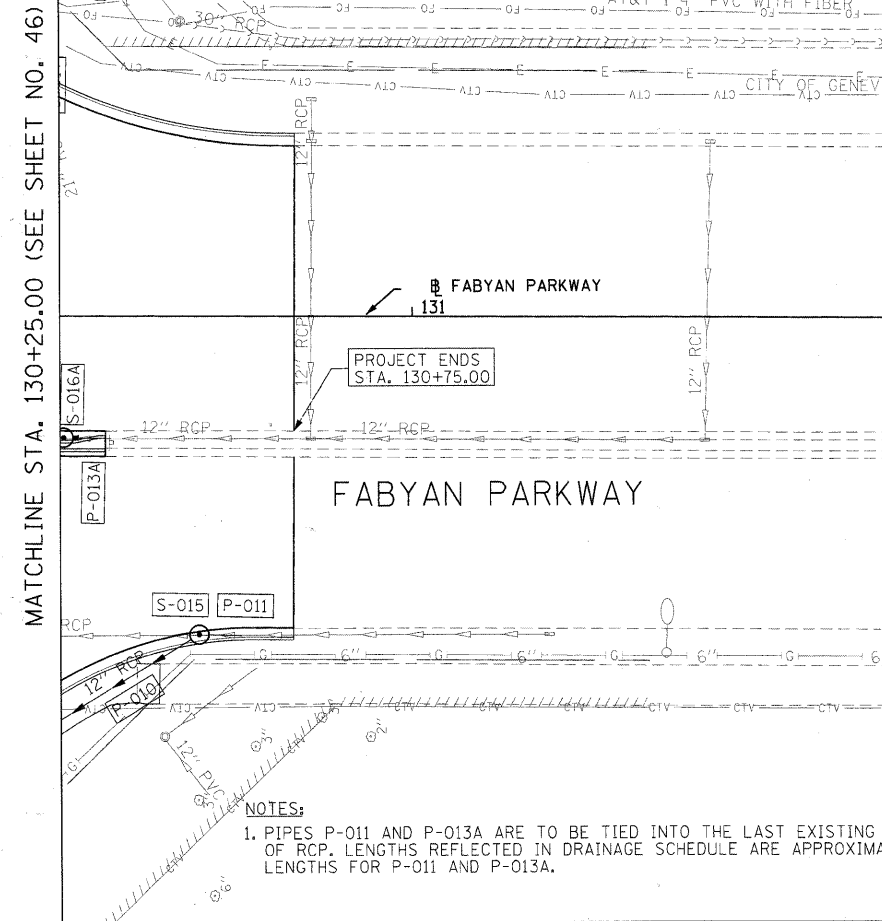

MATCHLINE STA. 130+25.00 (SEE SHEET NO. 46)

NOTES:
1. PIPES P-011 AND P-013A ARE TO BE TIED INTO THE LAST EXISTING JOINT OF RCP. LENGTHS REFLECTED IN DRAINAGE SCHEDULE ARE APPROXIMATE LENGTHS FOR P-011 AND P-013A.

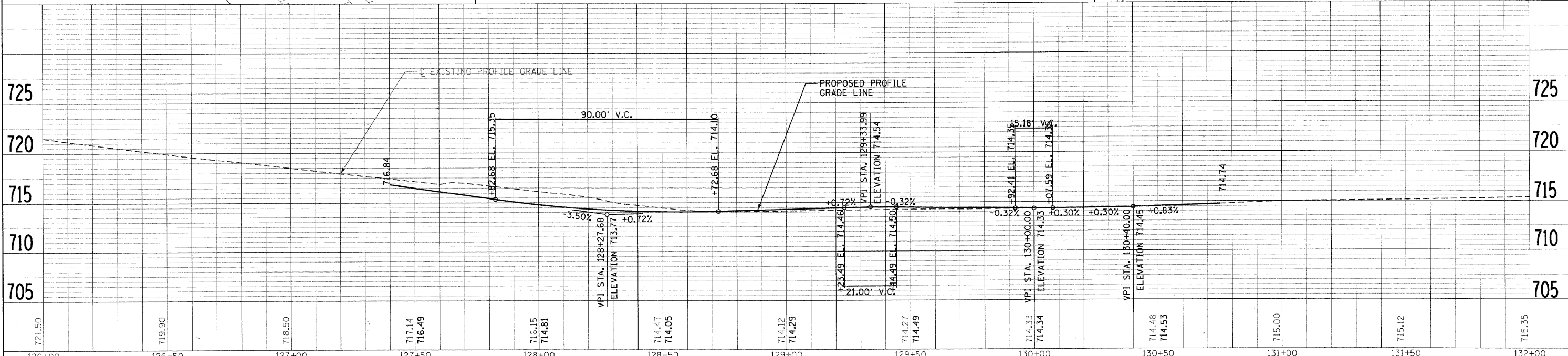

126+00	126+50	127+00	127+50	128+00	128+50	129+00	129+50	130+00	130+50	131+00	131+50	132+00
721.50	719.90	718.50	717.14 716.49	716.15 714.81	714.47 714.05	714.12 714.29	714.27 714.49	714.33 714.34	714.48 714.53	715.00	715.12	715.35

CMT
CRAWFORD, MURPHY & TULLY, INC.
CONSULTING ENGINEERS
License No. 984-000613

USER NAME = Matt Baldwin	DESIGNED - PWK	REVISED -
PLOT SCALE = 20,0000' / 1"	DRAWN - ERD	REVISED -
PLOT DATE = 2/7/2011	CHECKED - KDF	REVISED -
	DATE - 12/29/2010	REVISED -

**STATE OF ILLINOIS
DEPARTMENT OF TRANSPORTATION**

DRAINAGE AND UTILITY PLAN

SCALE: 20' H 5' V SHEET NO. 6 OF 6 SHEETS STA. TO STA.

F.A.P. RTE. 336	SECTION 01-00269-00-CH	COUNTY KANE	TOTAL SHEETS 124	SHEET NO. 49
CONTRACT NO. 63533				
ILLINOIS FED. AID PROJECT				