

DATE	
BY	
SURVEYED	
PLOTTED	
TEMPLATE	
NOTE BOOK	
AREAS CHECKED	
NO.	

DATE	
BY	
SURVEYED	
PLOTTED	
TEMPLATE	
NOTE BOOK	
AREAS CHECKED	
NO.	

NOTE: CROSS-SECTIONS DO NOT SHOW UNDERCUT OF UNSUITABLE MATERIAL. ANTICIPATED LOCATION AND AMOUNT OF UNDERCUT ARE SHOWN ON SHEET 13.

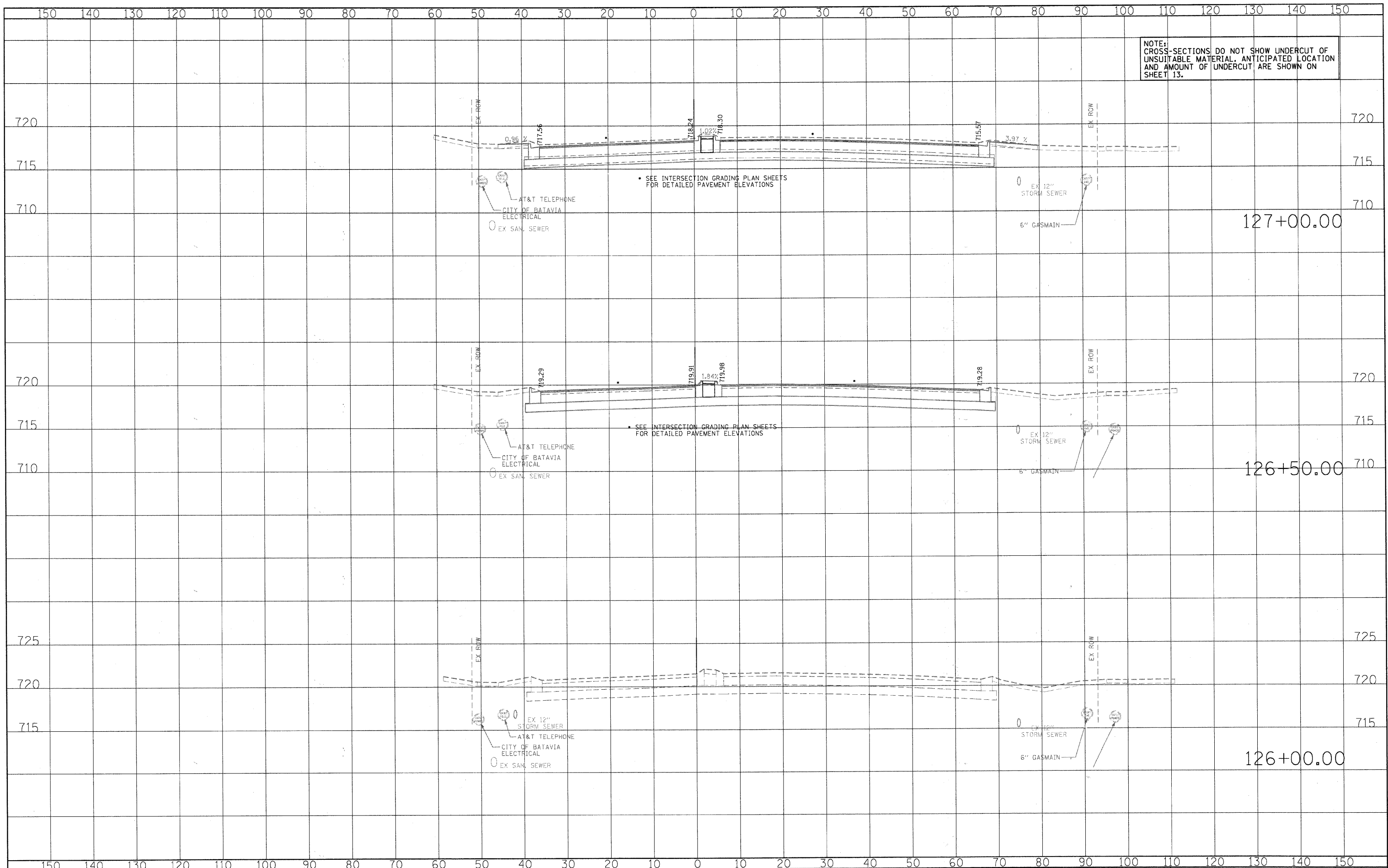

FILE NAME = L:\KANE\0922869\Draw\CAD\Draw\Sheet\13.SHEET\13.FABYAN.DWG



USER NAME = Matt Baldwin	DESIGNED - PWK	REVISED -
PLOT SCALE = 10.0000' / IN.	DRAWN - ERD	REVISED -
PLOT DATE = 12/29/2010	CHECKED - KDF	REVISED -
	DATE -	REVISED -

STATE OF ILLINOIS  
DEPARTMENT OF TRANSPORTATION

FABYAN PARKWAY CROSS-SECTIONS  
SCALE: 1" = 10'  
SHEET NO. OF SHEETS STA. 126+00.00 TO STA. 127+00.00

F.A.P. RTE.	SECTION	COUNTY	TOTAL SHEETS	SHEET NO.
336	01-00269-00-CH	KANE	124	115
FED. ROAD DIST. NO. ILLINOIS FED. AID PROJECT			CONTRACT NO. 63533	