

| NO. | STATION | OFFSET | TYPE | FRAME | RIM / EP | INVERT |
|-------|---------|----------|-------------------------|----------------------|------------|--|
| S-1 | 22+46 | 12' RT | MANHOLE, TYPE A, 5' | TY 1 OL (SPECIAL 4") | 662.72 EP | 658.12 36" NE, 659.71 12" W, EX 658.12± 30" S |
| S-1A | 22+26 | 12' RT | CATCH BASIN, TYPE A, 4' | TY 1 OL | 662.72 EP | 659.80 12" E |
| S-1B | 22+55 | 12' LT | CATCH BASIN, TYPE A, 4' | TY 1 OL | 662.76 EP | 659.86 12" E |
| S-2 | 22+80 | 0' RT | MANHOLE, TYPE A, 6' | TY 1 CL | 663.43 RIM | 658.18 36" NE & SW, 658.18 15" N, 659.86 12" SE |
| S-2A | 22+80 | 12' RT | CATCH BASIN, TYPE A, 4' | TY 1 OL | 663.15 EP | 659.98 12" NW |
| S-EX1 | 22+81 | 12' RT | EXISTING CATCH BASIN | EXISTING OL | 662.78 RIM | 658.18 15" SE, EX 658.18± 15" NW, EX 658.23± 27" NE & SW |
| S-3 | 23+37 | 6' LT | MANHOLE, TYPE A, 5' | TY 1 CL | 663.58 RIM | 658.26 36" NE & SW |
| S-4 | 24+43 | 6' LT | MANHOLE, TYPE A, 6' | TY 1 CL | 664.12 RIM | 658.43 36" NE & SW, 659.00 15" NW, 659.00 12" SE |
| S-5 | 24+43 | 16' RT | CATCH BASIN, TYPE A, 4' | TY 1 OL | 663.50 EP | 659.46 12" NW & NE |
| S-6 | 24+84 | 16' RT | INLET, TYPE A | TY 1 OL | 663.60 EP | 660.78 12" SW |
| S-EX2 | 24+49 | 18.5' LT | EXISTING MANHOLE | EXISTING OL | 663.36 RIM | 659.18 15" SE, EX 659.18± 27" NE, EX 659.39± 27" SW |

GLEN OAKS DRIVE

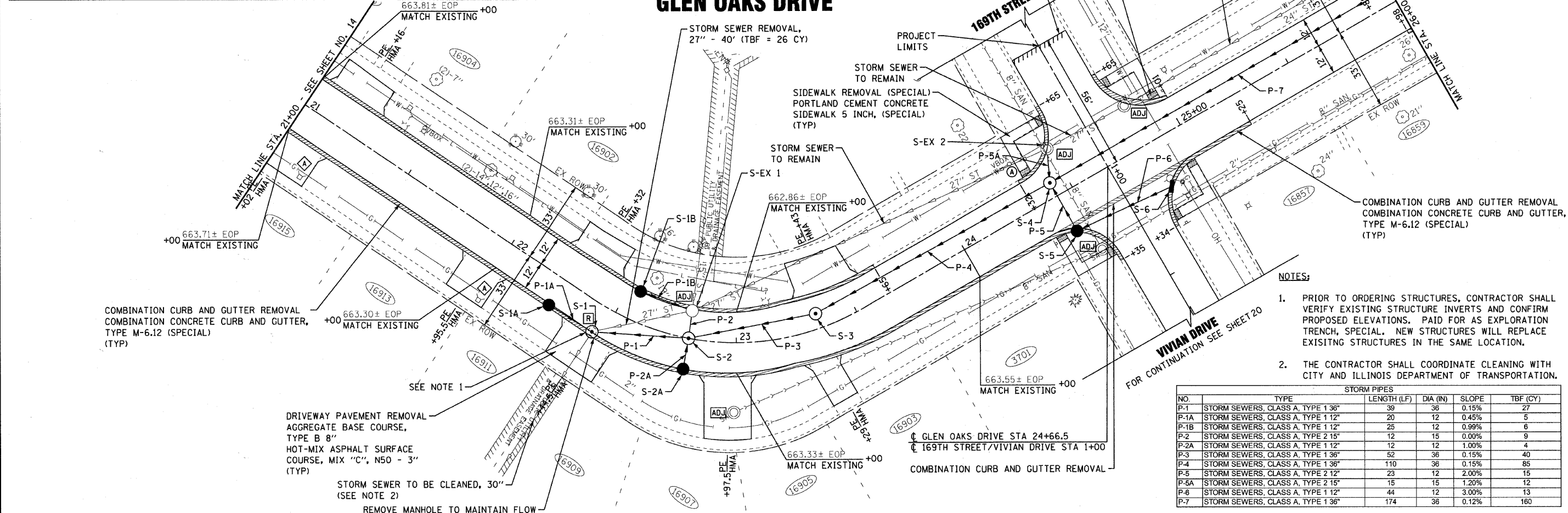

- NOTES:**
- PRIOR TO ORDERING STRUCTURES, CONTRACTOR SHALL VERIFY EXISTING STRUCTURE INVERTS AND CONFIRM PROPOSED ELEVATIONS. PAID FOR AS EXPLORATION TRENCH, SPECIAL. NEW STRUCTURES WILL REPLACE EXISTING STRUCTURES IN THE SAME LOCATION.
 - THE CONTRACTOR SHALL COORDINATE CLEANING WITH CITY AND ILLINOIS DEPARTMENT OF TRANSPORTATION.

| STORM PIPES | | | | | |
|-------------|------------------------------------|-------------|----------|-------|----------|
| NO. | TYPE | LENGTH (LF) | DIA (IN) | SLOPE | TBF (CY) |
| P-1 | STORM SEWERS, CLASS A, TYPE 1 3/8" | 39 | 36 | 0.15% | 27 |
| P-1A | STORM SEWERS, CLASS A, TYPE 1 1/2" | 20 | 12 | 0.45% | 5 |
| P-1B | STORM SEWERS, CLASS A, TYPE 1 1/2" | 25 | 12 | 0.99% | 6 |
| P-2 | STORM SEWERS, CLASS A, TYPE 2 1/5" | 12 | 15 | 0.00% | 9 |
| P-2A | STORM SEWERS, CLASS A, TYPE 1 1/2" | 12 | 12 | 1.00% | 4 |
| P-3 | STORM SEWERS, CLASS A, TYPE 1 3/8" | 52 | 36 | 0.15% | 40 |
| P-4 | STORM SEWERS, CLASS A, TYPE 1 3/8" | 110 | 36 | 0.15% | 85 |
| P-5 | STORM SEWERS, CLASS A, TYPE 2 1/2" | 23 | 12 | 2.00% | 15 |
| P-5A | STORM SEWERS, CLASS A, TYPE 2 1/5" | 15 | 15 | 1.20% | 12 |
| P-6 | STORM SEWERS, CLASS A, TYPE 1 1/2" | 44 | 12 | 3.00% | 13 |
| P-7 | STORM SEWERS, CLASS A, TYPE 1 3/8" | 174 | 36 | 0.12% | 160 |

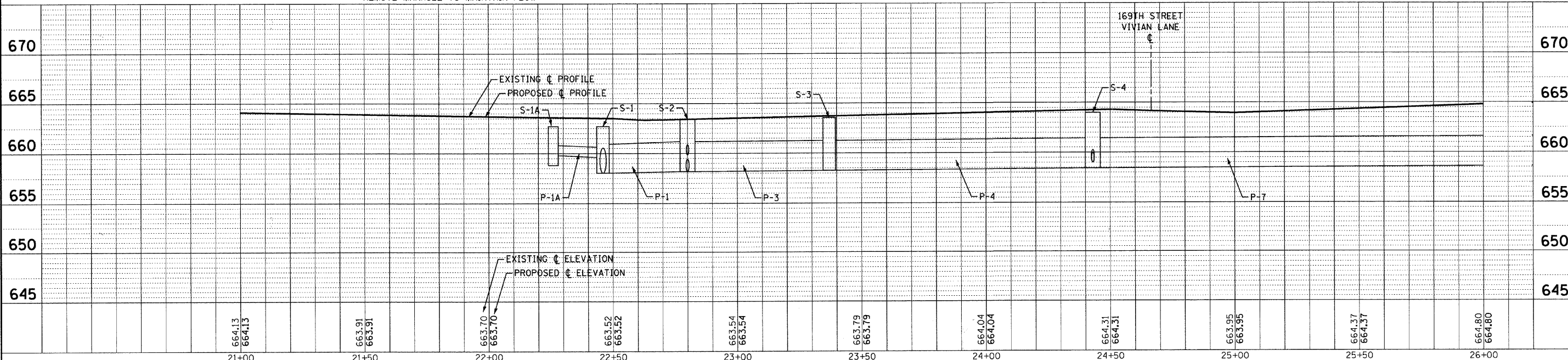

| | | | | | | | | | | |
|--|-----------------|--------------------------------|---|---|---|----------------|---------|--------|--------------------|-----------|
| | DESIGNED - MWP | REVISED - 12-01-10 IDOT REVIEW | CITY OF COUNTRY CLUB HILLS, ILLINOIS GLEN OAKS DRIVE INFRASTRUCTURE IMPROVEMENTS | PLAN AND PROFILE GLEN OAKS DRIVE | SCALE: H: 1"=20' V: 1"=5' STA. 21+00 TO STA. 26+00 | F.A. RTE. | SECTION | COUNTY | TOTAL SHEETS | SHEET NO. |
| | DRAWN - KAR | REVISED - | | | | 04-00027-03-PV | COOK | 36 | 15 | |
| | CHECKED - RWL | REVISED - | | | | C-91-004-05 | | | | |
| | DATE - 10-01-10 | FILE - 041180-PP3.shx | | | | | | | CONTRACT NO. 63539 | |

COPYRIGHT © 2010 BY BAXTER & WOODMAN, INC.
 STATE OF ILLINOIS - PROFESSIONAL DESIGN FIRM
 LICENSE NO. 184-0027 - EXPIRES 4/30/2011
 1100 Westfall Lane, Suite 200, Country Club Hills, IL 60130