

NOTE:
 TRAFFIC CONTROL AND PROTECTION STANDARD 701422, SHALL BE USED IN CONJUNCTION WITH THIS DETAIL SHEET ON THE NORTHBOUND LANES.
 TRAFFIC CONTROL AND PROTECTION STANDARD 701101, SHALL BE USED IN CONJUNCTION WITH THIS DETAIL SHEET ON THE SOUTHBOUND LANES.

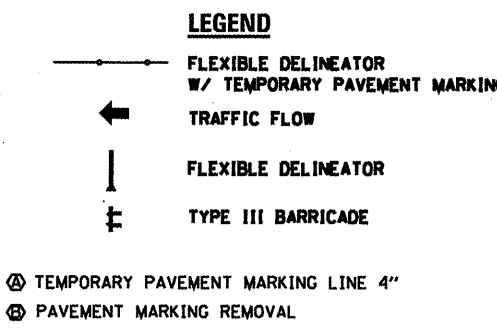

NOTE:
 TRAFFIC CONTROL AND PROTECTION STANDARD 701422, SHALL BE USED IN CONJUNCTION WITH THIS DETAIL SHEET ON THE NORTHBOUND LANES.
 TRAFFIC CONTROL AND PROTECTION STANDARD 701101, SHALL BE USED IN CONJUNCTION WITH THIS DETAIL SHEET ON THE SOUTHBOUND LANES.

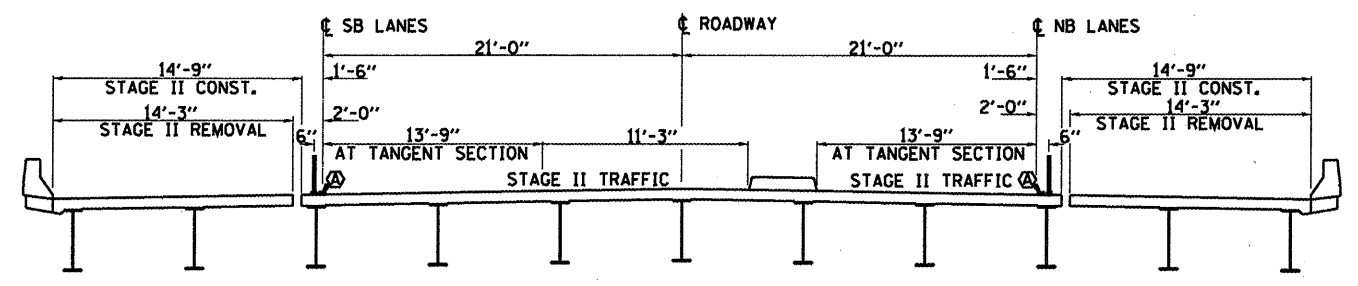
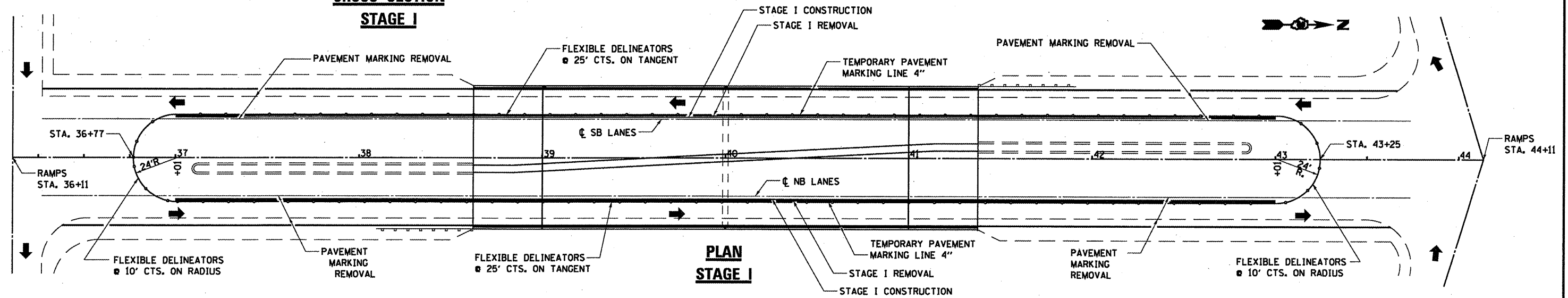
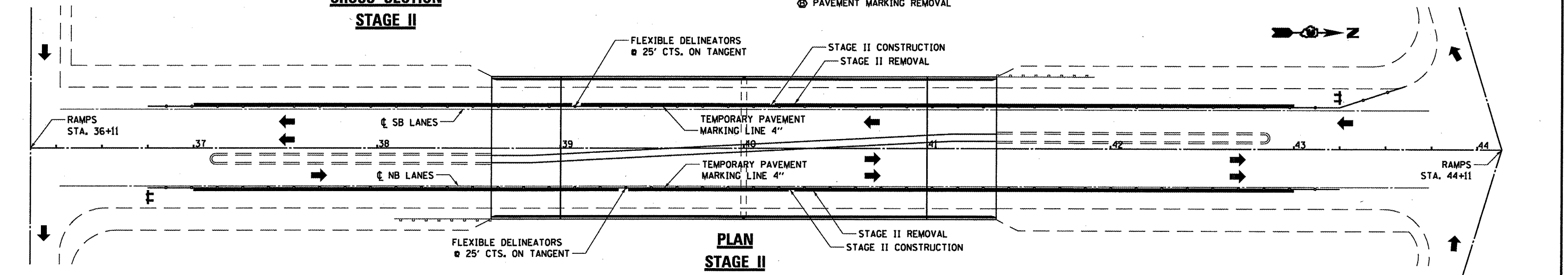

FILE NAME =	USER NAME = woodshankr1	DESIGNED - RLW	REVISED -	STATE OF ILLINOIS DEPARTMENT OF TRANSPORTATION	TRAFFIC CONTROL & PROTECTION (SPECIAL)	F.A.S. RTE. 2370	SECTION (78-1HB-1)	COUNTY PUTNAM	TOTAL SHEETS 18	SHEET NO. 6		
CONTRACT NO. 66A27	SCALE: _____	DRAWN - RLW	REVISED -			SHEET NO. 1 OF 1 SHEETS	STA. _____ TO STA. _____	ILLINOIS FED. AID PROJECT				
PLOT SCALE = 100,0000' / IN.	CHECKED -	DATE -	REVISED -									
PLOT DATE = Dec 15, 2010 - 11:07:03 AM												