

**SOUTH ABUTMENT**

**ELEVATION**

**NORTH ABUTMENT**

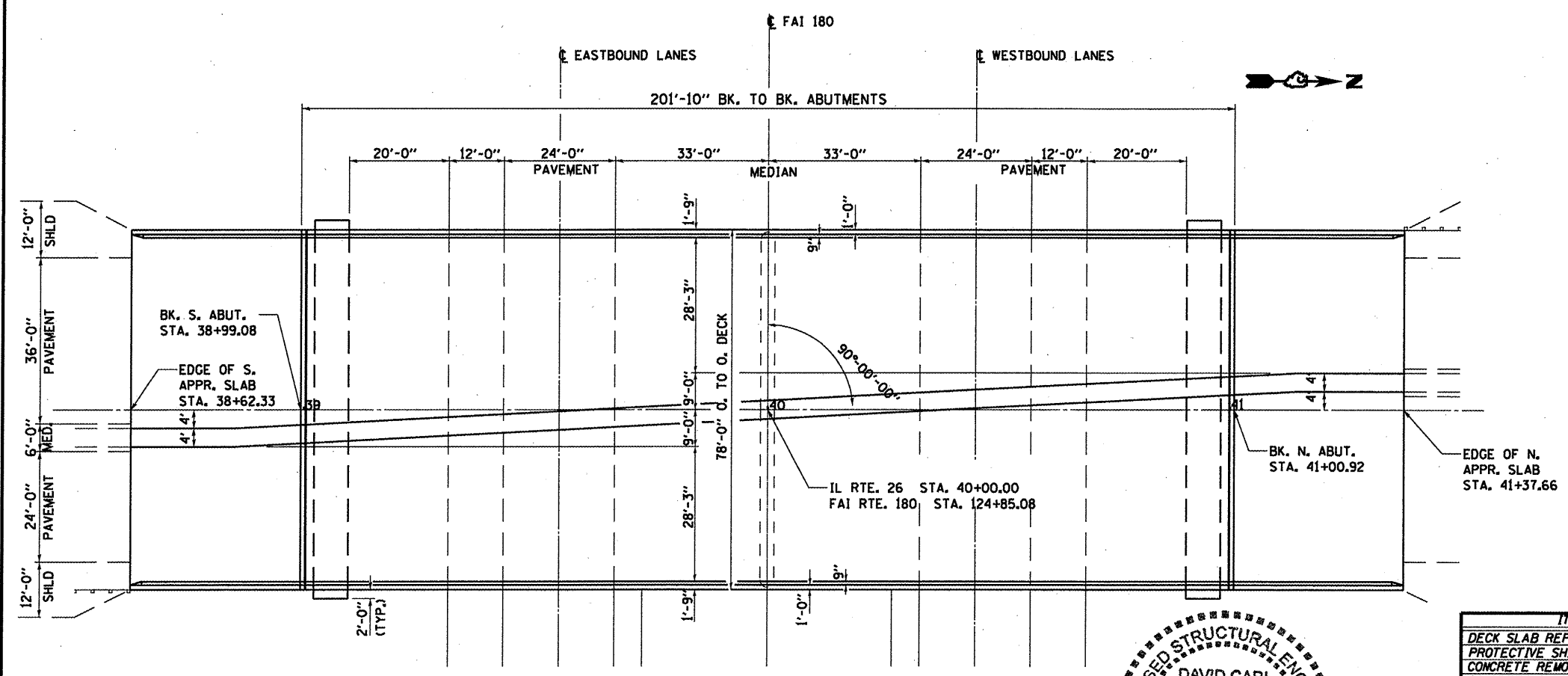

**PLAN**

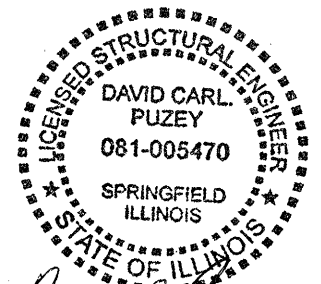

*David Carl Puzey 2/7/11*  
Expires 11/30/2012

**GENERAL NOTES**

PRIOR TO POURING THE NEW CONCRETE DECK, ALL HEAVY OR LOOSE RUST, LOOSE MILL SCALE, AND OTHER LOOSE OR POTENTIALLY DETRIMENTAL FOREIGN MATERIAL SHALL BE REMOVED FROM THE SURFACES IN CONTACT WITH CONCRETE. TIGHTLY ADHERED PAINT MAY REMAIN UNLESS OTHERWISE NOTED. REMOVAL SHALL BE ACCOMPLISHED BY METHODS THAT WILL NOT DAMAGE THE STEEL AND THE COST WILL BE INCLUDED IN THE PAY ITEM COVERING REMOVAL OF THE EXISTING CONCRETE.

PLAN DIMENSIONS AND DETAILS RELATIVE TO EXISTING PLANS ARE SUBJECT TO NOMINAL CONSTRUCTION VARIATIONS. THE CONTRACTOR SHALL FIELD VERIFY EXISTING DIMENSIONS AND DETAILS AFFECTING NEW CONSTRUCTION AND MAKE NECESSARY APPROVED ADJUSTMENTS PRIOR TO CONSTRUCTION OR ORDERING OF MATERIALS. SUCH VARIATIONS SHALL NOT BE CAUSE FOR ADDITIONAL COMPENSATION FOR A CHANGE IN SCOPE OF WORK; HOWEVER, THE CONTRACTOR WILL BE PAID FOR THE QUANTITY ACTUALLY FURNISHED AT THE UNIT PRICE BID FOR THE WORK.

CONCRETE SEALER SHALL BE APPLIED TO THE DESIGNATED AREAS OF THE ENTIRE DECK SURFACE INCLUDING APPROACH SPANS, THE VERTICAL FACE OF THE MEDIAN CURB, MEDIAN SURFACE, TOP AND VERTICAL FACES OF PARAPETS.

AS DIRECTED BY THE ENGINEER, EXISTING CONSTRUCTION ACCESSORIES WELDED TO THE TOP FLANGE OF BEAMS AND GIRDERS SHALL BE REMOVED. THE WELD AREAS SHALL BE GROUND FLUSH AND INSPECTED FOR CRACKS USING MAGNETIC PARTICLE TESTING (MT) OR DYE PENETRANT TESTING (PT) BY QUALIFIED PERSONNEL APPROVED BY THE ENGINEER. ANY CRACKS THAT CANNOT BE REMOVED BY GRINDING 1/4" DEEP SHALL BE IDENTIFIED AND REPORTED TO THE BUREAU OF BRIDGES AND STRUCTURES FOR FURTHER DISPOSITION. THE COST OF REMOVING WELDED ACCESSORIES, GRINDING AND INSPECTING WELD AREAS AND GRINDING CRACKS WILL BE PAID FOR ACCORDING TO ARTICLE 109.04 OF THE STANDARD SPECIFICATIONS.

ALL STRUCTURAL STEEL SHALL CONFORM TO AASHTO CLASSIFICATION M-270 GR 36, UNLESS OTHERWISE NOTED.

THE EXISTING STRUCTURAL STEEL COATING CONTAINS LEAD. THE CONTRACTOR SHALL TAKE APPROPRIATE PRECAUTIONS TO DEAL WITH THE PRESENCE OF LEAD ON THIS PROJECT.

EXISTING STRUCTURAL STEEL THAT WILL BE IN CONTACT WITH NEW STRUCTURAL STEEL SHALL BE CLEANED AND PAINTED PRIOR TO ERECTION AS REQUIRED BY THE SPECIAL PROVISION, "CLEANING AND PAINTING CONTACT SURFACE AREAS OF EXISTING STEEL STRUCTURES".

ALL STRUCTURAL STEEL SHALL BE SHOP PAINTED WITH THE INORGANIC ZINC RICH PRIMER PER AASHTO M300, TYPE 1, COST INCLUDED WITH FURNISHING AND ERECTING STRUCTURAL STEEL.

THE DECK SURFACE SHALL HAVE ITS FINAL FINISH TINED ACCORDING TO ARTICLE 420.09(a)(1) OF THE STANDARD SPECIFICATIONS. COST INCLUDED WITH CONCRETE SUPERSTRUCTURES.

IF THE ANALYSIS SUBMITTED TO THE CONTRACTOR FOR THE JACKING/TEMPORARY SUPPORT SYSTEM TO BE USED SHOWS TEMPORARY STIFFENERS ARE REQUIRED TO PREVENT WEB CRIPPLING OR BUCKLING, THE STIFFENERS SHALL BE STEEL AND BOLTED TO THE WEB. IF STIFFENERS ARE NOT REQUIRED, THE HARDWOOD TIMBERS SHALL BE INSTALLED TIGHTLY BETWEEN THE TOP AND BOTTOM FLANGE TO PREVENT FLANGE ROTATION.

REINFORCEMENT BARS SHALL CONFORM TO THE REQUIREMENTS OF ASTM A 705 GR. 60.

REINFORCEMENT BARS DESIGNATED (E) SHALL BE EPOXY COATED.

JOINT OPENING SHALL BE ADJUSTED ACCORDING TO ARTICLE 520.04 OF THE STANDARD SPECIFICATIONS WHEN THE DECK IS POURED AT AN AMBIENT TEMPERATURE OTHER THAN 50 DEGREES F.

NO FIELD WELDING IS PERMITTED EXCEPT AS SPECIFIED IN CONTRACT DOCUMENTS.

**TOTAL BILL OF MATERIAL**

ITEM	UNIT	SUPER	SUB	TOTAL
DECK SLAB REPAIR (PARTIAL)	SQ YD	32		32
PROTECTIVE SHIELD	SQ YD	1075		1075
CONCRETE REMOVAL	CU YD	14.4		14.4
CONCRETE SUPERSTRUCTURE	CU YD	14.4		14.4
REINFORCEMENT BARS	POUNDS	3090		3090
EPOXY COATED				
BAR SPLICER	EACH	24		24
PREFORMED JOINT STRIP SEAL	FOOT	156		156
ELASTOMERIC BEARING ASSEMBLY, TYPE I	EACH	22		22
JACK AND REMOVE	EACH	22		22
EXISTING BEARINGS				
FURNISHING AND ERECTING	POUND	4010		4010
STRUCTURAL STEEL				
ANCHOR BOLTS 1" #	EACH		44	44
STRUCTURAL REPAIR OF CONCRETE (DEPTH EQUAL TO OR LESS THAN 5")	SQ FT		124	124
CONCRETE SEALER	SQ FT	22,212		22,212

**GENERAL PLAN AND ELEVATION**  
FAS 2370 (IL 26) SECTION (78-1HB-11)  
**PUTNAM COUNTY**  
STA. 40+00.00  
S.N. 078-0010

FILE NAME =	USER NAME = woodshankr1	DESIGNED - RLW	REVISED -	STATE OF ILLINOIS DEPARTMENT OF TRANSPORTATION	GENERAL PLAN AND ELEVATION S.N. 078-0010	F.A.S. RTE. 2370	SECTION (78-1HB-11)	COUNTY PUTNAM	TOTAL SHEETS 18	SHEET NO. 7
MAIN1-0366A27-details.dgn	DRAWN - RLW	REVISED -	CONTRACT NO. 66A27							
PLOT SCALE = 1/8" = 1' IN.	CHECKED -	REVISED -	ILLINOIS FED. AID PROJECT							
PLOT DATE = Dec 15, 2010 - 11:07:15 AM	DATE -	REVISED -								