

**CROSS SECTION
STAGE I
LOOKING SOUTH**

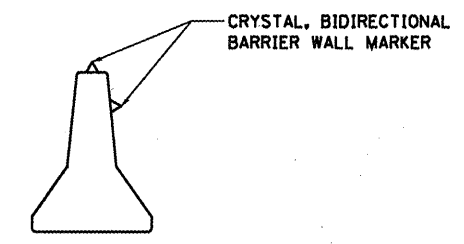

TEMPORARY CONCRETE BARRIER

NOTE: WIDTH RESTRICTION SIGNING REQUIRED FOR STAGE II CONSTRUCTION

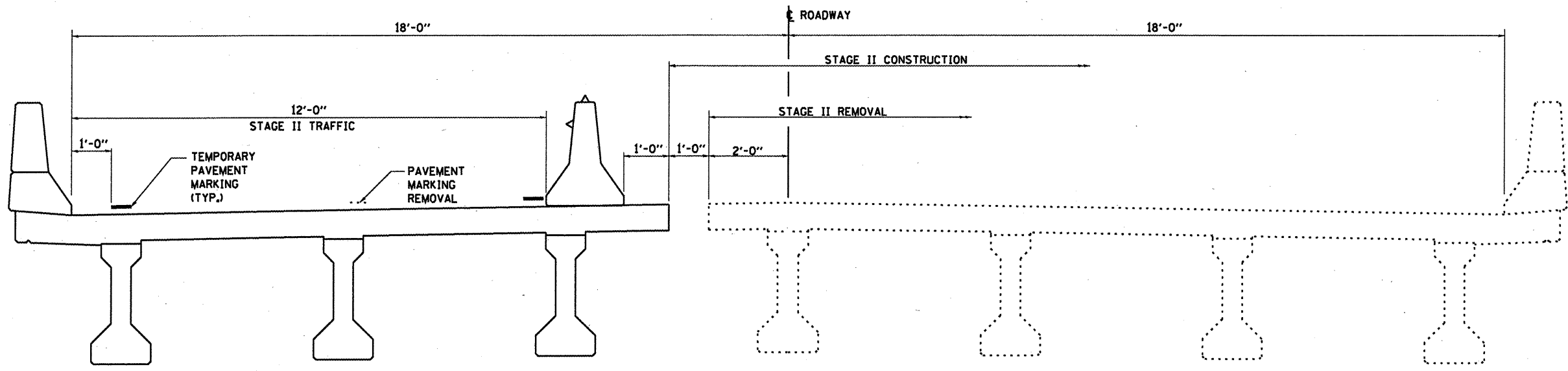

**CROSS SECTION
STAGE II
LOOKING SOUTH**

FILE NAME = c:\pw_work\psidot\woodshankr1\d0143168\	USER NAME = woodshankr1	DESIGNED - RON WOODSHANK	REVISED -	STATE OF ILLINOIS DEPARTMENT OF TRANSPORTATION	STAGING DETAILS	F.A.P. RTE. 332	SECTION 01-X-BN-1	COUNTY IROQUOIS	TOTAL SHEETS 14	SHEET NO. 5		
	MAIN11-0368A28-details.dgn	DRAWN - RON WOODSHANK	REVISED -			SCALE: _____	SHEET NO. 1 OF 1 SHEETS	STA. _____	TO STA. _____	CONTRACT NO. 66A28		
	PLOT SCALE = 1/8" = 1'-0" / IN.	CHECKED -	REVISED -			ILLINOIS FED. AID PROJECT						
	PLOT DATE = Dec 21, 2010 - 11:02:41 AM	DATE -	REVISED -									