

F.A.I. RTE.	SECTION	COUNTY	TOTAL SHEETS	SHEET NO.
55	(53-5)L	LIVINGSTON	9	1
		ILLINOIS	CONTRACT NO. 66A64	

STATE OF ILLINOIS
DEPARTMENT OF TRANSPORTATION
DIVISION OF HIGHWAYS
**PROPOSED
HIGHWAY PLANS**

**FAI ROUTE 55 (I55)
SECTION (53-5)L**

**TYPE OF IMPROVEMENT-LIGHTING
LIVINGSTON COUNTY**

C-93-006-11

**SPOT IMPROVEMENT
IL 23 / I-55 INTERCHANGE**

**SPOT IMPROVEMENT
IL 116 / I-55 INTERCHANGE**

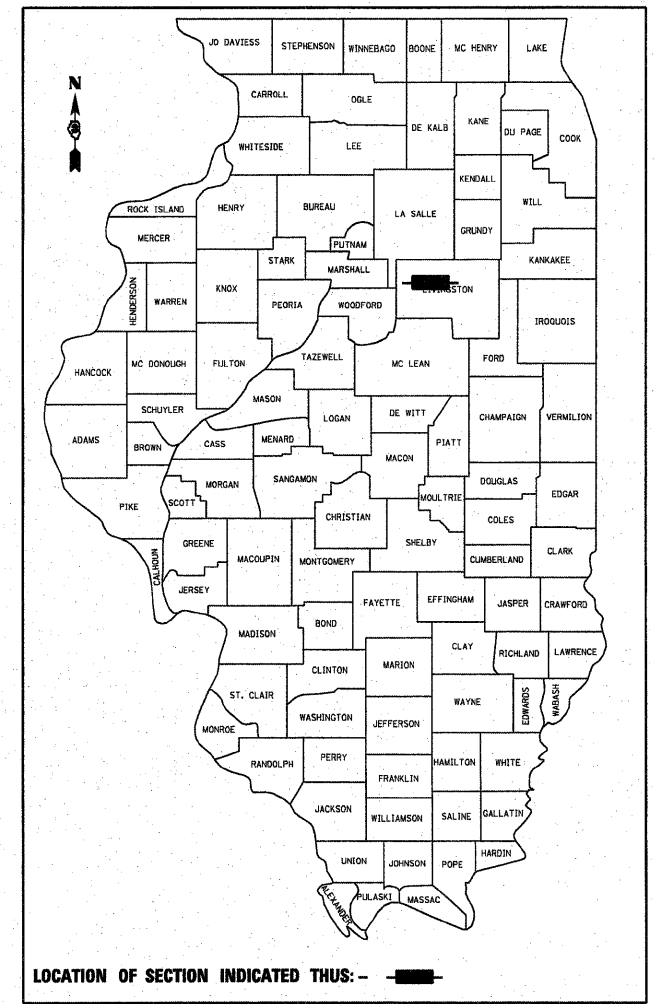
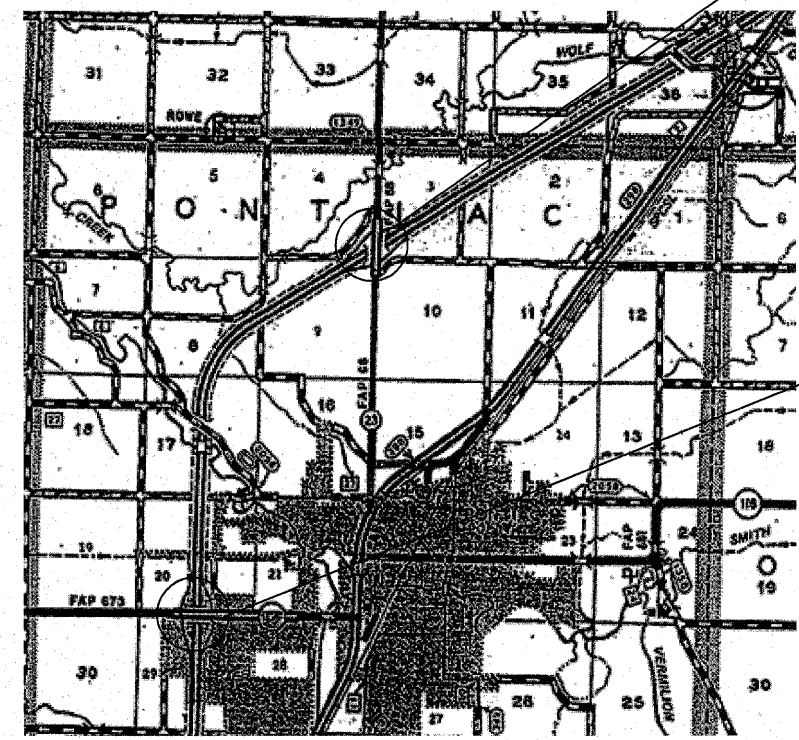

FUNCTIONAL CLASSIFICATION - INTERSTATE
2009 ADT = 14400 VPD
PV = 82.1% SU = 2.3% MU = 15.6%

STATE OF ILLINOIS
DEPARTMENT OF TRANSPORTATION
DIVISION OF HIGHWAYS

SUBMITTED November 09 2011
George Beynon
DEPUTY DIRECTOR OF HIGHWAYS, REGION ENGINEER

February 4 2011
Scott E. Stett P.E.
acting ENGINEER OF DESIGN AND ENVIRONMENT

February 4 2011
Christine M. Reed
DIRECTOR OF HIGHWAYS, CHIEF ENGINEER

**PRINTED BY THE AUTHORITY
OF THE STATE OF ILLINOIS**

INDEX OF SHEETS

- 1 COVER SHEET
- 2 GENERAL NOTES
- 3 SUMMARY OF QUANTITIES
- 4 TYPICAL SECTION
- 5 SCHEDULE OF QUANTITIES
- 6-7 PLAN SHEETS
- 8-9 DETAILS

STANDARDS

- 001006 DECIMAL OF AN INCH AND OF A FOOT
- 701001-02 OFF-ROAD OPERATIONS 2L, 2W, MORE THAN 15' (4.5 m) AWAY
- 701011-02 OFF-ROAD MOVING OPERATIONS 2L, 2W, DAY ONLY
- 701401-06 LANE CLOSURE, FREEWAY/EXPRESSWAY
- 835001 LIGHT TOWER

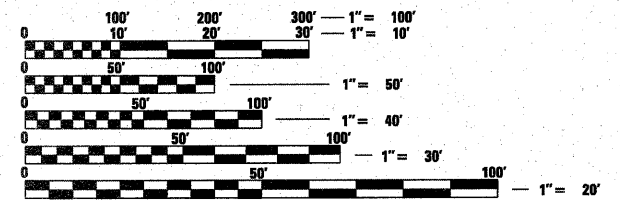

FULL SIZE PLANS HAVE BEEN PREPARED USING STANDARD ENGINEERING SCALES. REDUCED SIZED PLANS WILL NOT CONFORM TO STANDARD SCALES. IN MAKING MEASUREMENTS ON REDUCED PLANS, THE ABOVE SCALES MAY BE USED.

J.U.L.I.E.
JOINT UTILITY LOCATION INFORMATION FOR EXCAVATION
1-800-892-0123
OR 811

PROJECT ENGINEER - JOE KANNEL, P.E.
SQUAD LEADER - PAT BRABOY
TOWNSHIP - PONTIAC
CONTRACT NO. 66A64

GROSS LENGTH = 23,637 FT. = 4.48 MI.
NET LENGTH = 520 FT. = 0.1 MILE