

F.A.I. RTE.	SECTION	COUNTY	TOTAL SHEETS	SHEET NO.
55	(53-5)L	LIVINGSTON	9	1
		ILLINOIS	CONTRACT NO. 66A64	

STATE OF ILLINOIS
DEPARTMENT OF TRANSPORTATION
DIVISION OF HIGHWAYS
PROPOSED
HIGHWAY PLANS

D-93-013-11

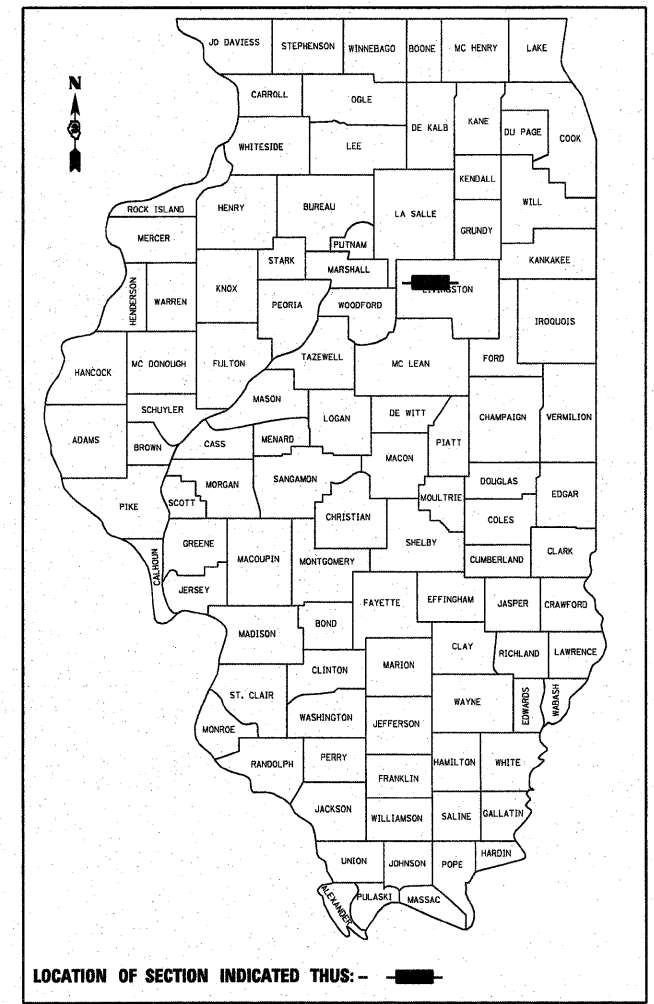

FUNCTIONAL CLASSIFICATION - INTERSTATE
 2009 ADT = 14400 VPD
 PV = 82.1% SU = 2.3% MU = 15.6%

INDEX OF SHEETS

1	COVER SHEET
2	GENERAL NOTES
3	SUMMARY OF QUANTITIES
4	TYPICAL SECTION
5	SCHEDULE OF QUANTITIES
6-7	PLAN SHEETS
8-9	DETAILS

STANDARDS

001006	DECIMAL OF AN INCH AND OF A FOOT
701001-02	OFF-ROAD OPERATIONS 2L, 2W, MORE THAN 15' (4.5 m) AWAY
701011-02	OFF-ROAD MOVING OPERATIONS 2L, 2W, DAY ONLY
701401-06	LANE CLOSURE, FREEWAY/EXPRESSWAY
835001	LIGHT TOWER

FAI ROUTE 55 (I55)
SECTION (53-5)L

TYPE OF IMPROVEMENT-LIGHTING
LIVINGSTON COUNTY

C-93-006-11

SPOT IMPROVEMENT
IL 23 / I-55 INTERCHANGE

SPOT IMPROVEMENT
IL 116 / I-55 INTERCHANGE

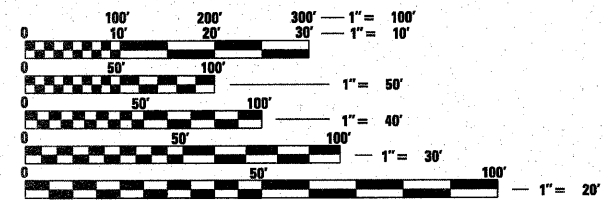
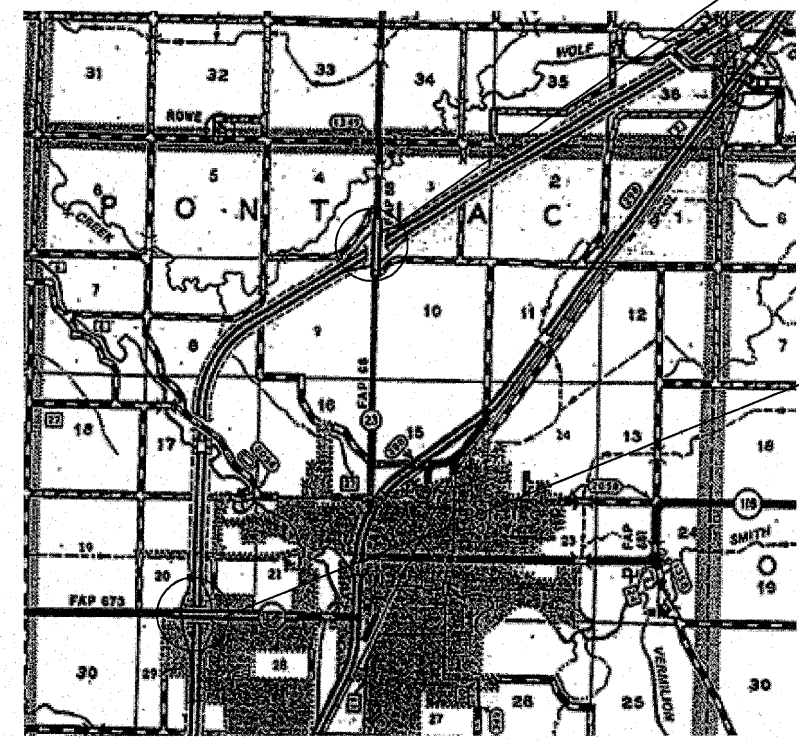

FULL SIZE PLANS HAVE BEEN PREPARED USING STANDARD
 ENGINEERING SCALES. REDUCED SIZED PLANS WILL NOT
 CONFORM TO STANDARD SCALES. IN MAKING MEASUREMENTS
 ON REDUCED PLANS, THE ABOVE SCALES MAY BE USED.

J.U.L.I.E.
JOINT UTILITY LOCATION INFORMATION FOR EXCAVATION
 1-800-892-0123
 OR 811

PROJECT ENGINEER - JOE KANNEL, P.E.
SQUAD LEADER - PAT BRABOY
TOWNSHIP - PONTIAC
CONTRACT NO. 66A64

GROSS LENGTH = 23,637 FT. = 4.48 MI.
 NET LENGTH = 520 FT. = 0.1 MILE

STATE OF ILLINOIS
 DEPARTMENT OF TRANSPORTATION
 DIVISION OF HIGHWAYS

SUBMITTED November 09 2011
George Beynon
 DEPUTY DIRECTOR OF HIGHWAYS, REGION ENGINEER

February 4 2011
Scott E. Stett P.E.
 acting ENGINEER OF DESIGN AND ENVIRONMENT

February 4 2011
Christine M. Reed
 DIRECTOR OF HIGHWAYS, CHIEF ENGINEER

PRINTED BY THE AUTHORITY
OF THE STATE OF ILLINOIS

GENERAL NOTES
(Revised May 13, 2009)

FOR STABILIZATION, ALL TYPE III BARRICADES SHALL REQUIRE A MINIMUM OF FOUR SAND BAGS PER BARRICADE.
SEEDING SHALL NOT BE PERMITTED AT ANY TIME WHEN THE GROUND IS FROZEN, WET, OR IN AN UNTILLABLE CONDITION. LOCATIONS TO BE SEEDED WILL BE DETERMINED BY THE ENGINEER.

ABANDONED UNDERGROUND UTILITIES THAT CONFLICT WITH CONSTRUCTION SHALL BE DISPOSED OF OUTSIDE THE LIMITS OF THE RIGHT OF WAY ACCORDING TO ARTICLE 202.03 OF THE STANDARD SPECIFICATIONS AND AS DIRECTED BY THE ENGINEER. THIS WORK WILL NOT BE PAID FOR SEPARATELY, BUT SHALL BE INCLUDED IN THE COST OF EARTH EXCAVATION.

ANY REFERENCE TO A STANDARD IN THESE PLANS SHALL BE INTERPRETED TO MEAN THE EDITION AS INDICATED BY THE SUBNUMBER SHOWN IN THE LIST OF STANDARDS OR THE COPY INCLUDED IN THESE PLANS.

THE CONTRACTOR'S ATTENTION IS DIRECTED TO THE PRESENCE OF DEPARTMENT-OWNED UNDERGROUND ELECTRICAL CABLE WITHIN THE LIMITS OF THE PROPOSED IMPROVEMENT. THE CONTRACTOR SHALL REQUEST THE ILLINOIS DEPARTMENT OF TRANSPORTATION IN OTTAWA (815-434-8417) TO LOCATE THE UNDERGROUND FACILITIES, PROVIDING A MINIMUM OF 72 HOURS NOTICE. THE DEPARTMENT IS NOT A MEMBER OF THE JOINT UTILITY LOCATING INFORMATION FOR EXCAVATORS (JULIE) SYSTEM.

ALL DAMAGE TO DEPARTMENT OWNED UNDERGROUND FACILITIES, CAUSED BY THE CONTRACTOR SHALL BE REPAIRED TO THE SATISFACTION OF THE DEPARTMENT AT THE CONTRACTOR'S EXPENSE. THIS SHALL INCLUDE ALL TEMPORARY REPAIRS REQUIRED TO KEEP THE FACILITY OPERATIONAL WHILE MATERIAL IS BEING OBTAINED TO MAKE PERMANENT REPAIRS. SPlicing OF ELECTRIC CABLE SHALL NOT BE ALLOWED. ELECTRIC CABLE SHALL BE REPLACED FROM POLE TO POLE OR CONTROLLER.

THE CONTRACTOR SHALL CONTACT JULIE AT LEAST 48 HOURS PRIOR TO EXCAVATION TO DETERMINE WHICH UTILITIES ARE IN THE AREA.

AREAS DISTURBED BY PLACEMENT OF ATTENUATOR BASES SHALL BE SEEDED, FERTILIZED, AND MULCHED. COST INCLUDED IN EARTH EXCAVATION. ALL EARTH EXCAVATION QUANTITY MUST BE DISTRIBUTED ON-SITE. THE CONTRACTOR IS NOT ALLOWED TO HAUL ANY MATERIAL AWAY

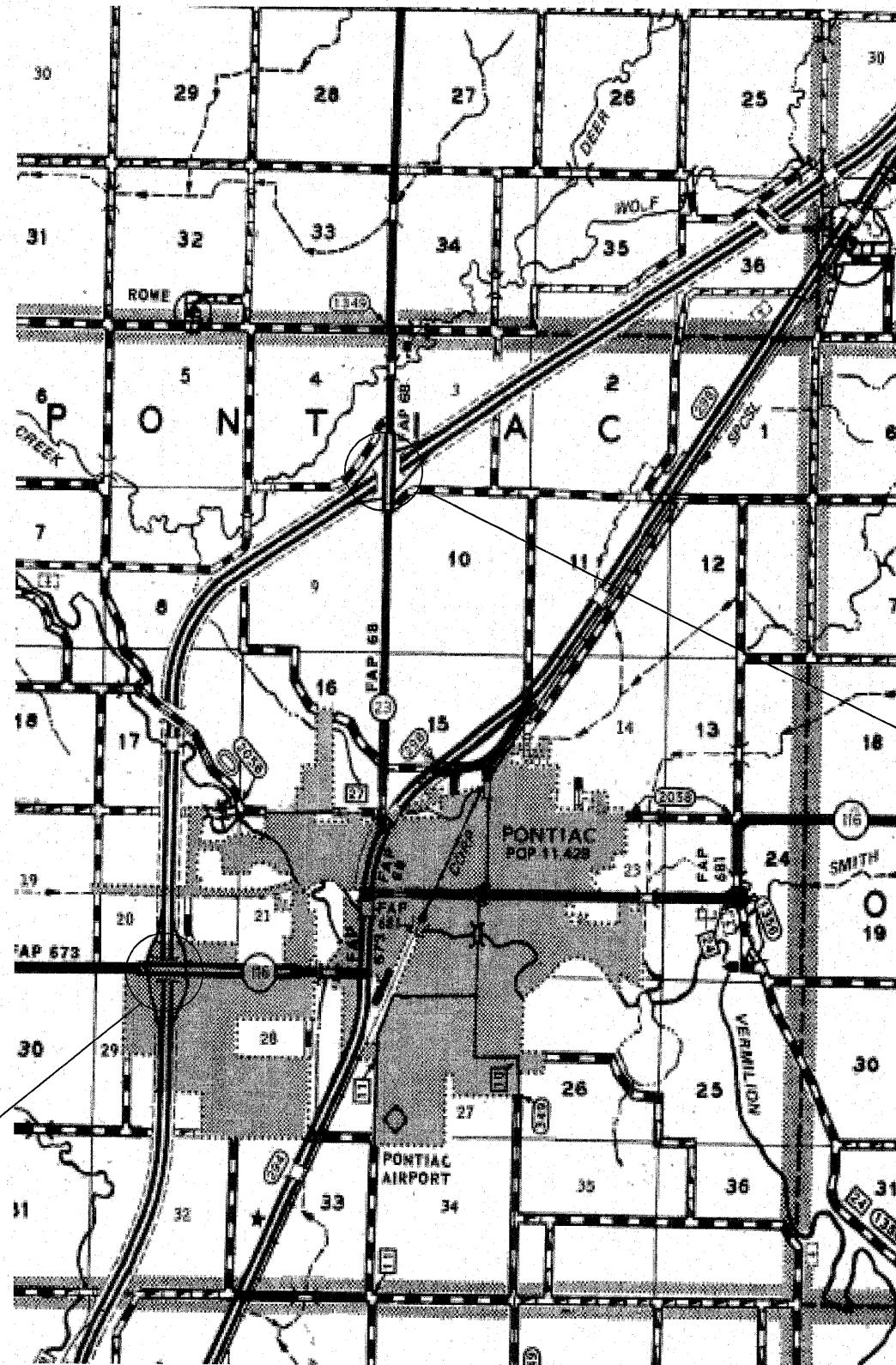

**SPOT IMPROVEMENT
IL 23 /I-55 INTERCHANGE**

**SPOT IMPROVEMENT
IL 23 /I-55 INTERCHANGE**

STATE OF ILLINOIS
DEPARTMENT OF TRANSPORTATION
DISTRICT THREE

PREPARED BY: Diane Brancian
DISTRICT STUDIES & PLANS ENGINEER

DATE: _____

EXAMINED BY: Robert J. [Signature]
DISTRICT CONSTRUCTION ENGINEER

W. J. [Signature]
DISTRICT MATERIALS ENGINEER

Eric A. [Signature]
DISTRICT OPERATIONS ENGINEER

FILE NAME =	USER NAME = braboypc	DESIGNED -	REVISED -	STATE OF ILLINOIS DEPARTMENT OF TRANSPORTATION	GENERAL NOTES, LOCATION MAP			F.A.I. RTE.	SECTION	COUNTY	TOTAL SHEETS	SHEET NO.
c:\pwork\pwork\braboypc\d0230396\0366A64-ah-cover.dgn		DRAWN -	REVISED -		55	(53-5)L	LIVINGSTON	9	2			
PLOT SCALE = 50.0000' / IN.		CHECKED -	REVISED -		CONTRACT NO. 66A64							
PLOT DATE = Nov 24, 2010 09:14:23 AM		DATE -	REVISED -		[ILLINOIS] FED. AID PROJECT							
				SCALE:	SHEET NO.	OF SHEETS	STA.	TO STA.				

CODE No.	SUMMARY OF QUANTITIES	UNIT	100% STATE	
			TOTAL QUANTITY	CONSTR CODE 0021 ROADWAY QUANTITY
20200100	EARTH EXCAVATION	CU YD	84	84
67100100	MOBILIZATION	L SUM	1	1
82105600	LUMINAIRE, SODIUM VAPOR, ^{HIGH MAST} HORIZONTAL MOUNT, 400 WATT	EACH	24	24
83503400	LIGHT TOWER, 110 FT. MOUNTING HEIGHT, LUMINAIRE MT. - 6	EACH	4	4
X7010805	TRAFFIC CONTROL AND PROTECTION, STANDARD 701401 (SPECIAL)	L SUM	1	1
Z0030150	IMPACT ATTENUATORS (NON-REDIRECTIVE), TEST LEVEL 3	EACH	12	12
Z0002005	ATTENUATOR BASE	SQ YD	480	480
X8420502	REMOVAL OF LIGHT TOWER, NO SALVAGE	EACH	1	1

FILE NAME =	USER NAME = braboypc	DESIGNED -	REVISED -	STATE OF ILLINOIS DEPARTMENT OF TRANSPORTATION	SUMMARY OF QUANTITIES	F.A.I. RTE.	SECTION	COUNTY	TOTAL SHEETS	SHEET NO.	
ca:\pwork\pwork\braboypc\02230396\036664-ent-details.DGN	PLOT SCALE = 50.0000' / IN.	DRAWN -	REVISED -			55	(53-5)L	LIVINGSTON	9	3	
	PLOT DATE = Nov 24, 2010 - 08:29:44 AM	CHECKED -	REVISED -			SCALE: SHEET NO. OF SHEETS STA. TO STA.		CONTRACT NO. 66A64		ILLINOIS FED. AID PROJECT	
		DATE	REVISED -			Rev.					

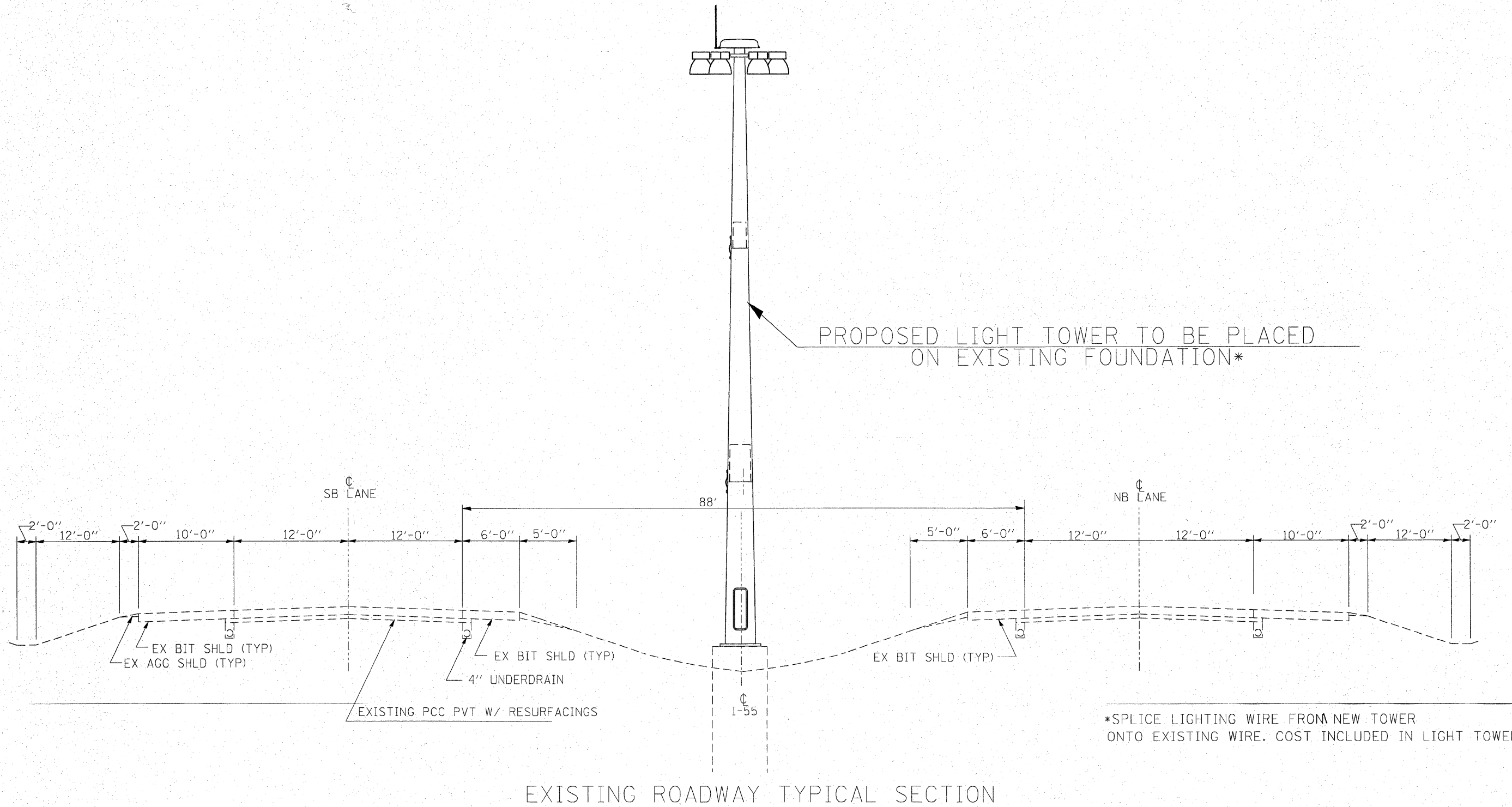

*SPlice LIGHTING WIRE FROM NEW TOWER ONTO EXISTING WIRE. COST INCLUDED IN LIGHT TOWER

FILE NAME =	USER NAME = braboypc	DESIGNED -	REVISED -	STATE OF ILLINOIS DEPARTMENT OF TRANSPORTATION	TYPICAL SECTION			F.A.I. RTE.	SECTION	COUNTY	TOTAL SHEETS	SHEET NO.			
cr\pwork\pwork\dot\braboypc\0230396\03666464-shr-detail.dgn		DRAWN -	REVISED -		SCALE:	SHEET NO.	OF	SHEETS	STA.	TO STA.	55	(53-5)L	LIVINGSTON	9	4
		CHECKED -	REVISED -										CONTRACT NO. 66A64		
		DATE -	REVISED -										ILLINOIS FED. AID PROJECT		

SCHEDULES					
LOCATION	LIGHT TOWER	LIGHT TOWER REMOVAL	IMPACT ATTENUATOR	ATTENUATOR BASE	EARTH EXCAVATION
STATION	UNIT	UNIT	UNIT	SQ YD	CU YD
96+00	1	1	2	80	14
110+24.56			2	80	14
126+00	1		2	80	14
297+33	1		2	80	14
313+41.64			2	80	14
332+37	1		2	80	14
TOTAL	4	1	12	480	84

FILE NAME =	USER NAME = braboyco	DESIGNED -	REVISED -	STATE OF ILLINOIS DEPARTMENT OF TRANSPORTATION	SCHEDULES OF QUANTITIES	F.A.I. RTE.	SECTION	COUNTY	TOTAL SHEETS	SHEET NO.	
ar\pwork\pwork\braboyco\0230396\03666664-ht-details.DGN	DRAWN -	REVISED -	55			(53-5)L	LIVINGSTON	9	5		
PLOT SCALE = 50.0000' / IN.	CHECKED -	REVISED -	CONTRACT NO. 66A64								
PLOT DATE = Nov 24, 2010 - 08:29:36 AM	DATE -	REVISED -	ILLINOIS FED. AID PROJECT								
						SCALE:	SHEET NO.	OF	SHEETS	STA.	TO STA.



IMPACT ATTENUATORS (NON-REDIRECTIVE),
TEST LEVEL 3

REMOVAL OF LIGHT TOWER, NO SALVAGE
REPLACED W/ LIGHT TOWER, 110 FT.
MOUNTING HEIGHT, LUMINAIRE MT. - 6
110 FT MAST HEIGHT
STA. 96+00, *NOTE 1*.

IMPACT ATTENUATORS
(NON-REDIRECTIVE),
TEST LEVEL 3

STA. 110+24.56 F.A.I. 55
STA. 50+00 IL. 116
SN 053-0116

LIGHT TOWER, 110 FT. MOUNTING HEIGHT, LUMINAIRE MT. - 6
STA. 126+00, *NOTE 1*.

IMPACT ATTENUATORS (NON-REDIRECTIVE),
TEST LEVEL 3

CONTROLLER BOX

NOTES:

1. PROPOSED HIGH MAST LUMINAIRES SHALL BE AIMED AS FOLLOWS:

- THREE (3) LUMINAIRES PERPENDICULAR TO NORTHBOUND LANE EDGE OF PAVEMENT
- THREE (3) LUMINAIRES PERPENDICULAR TO SOUTHBOUND LANE EDGE OF PAVEMENT

FILE NAME = c:\piv_work\pivdot\braboype\d0230396\036664-sht-details.DGN	USER NAME = braboype	DESIGNED -	REVISED -	STATE OF ILLINOIS DEPARTMENT OF TRANSPORTATION	DETAILS				F.A.I. RTE.	SECTION	COUNTY	TOTAL SHEETS	SHEET NO.
	PLOT SCALE = 50.0000' / IN.	CHECKED -	REVISED -		55	(53-5)L	LIVINGSTON	9	6				
PLOT DATE = Nov 24, 2010 - 09:30:24 AM	DATE -	REVISED -	REVISED -		SCALE:	SHEET NO.	OF	SHEETS	STA.	TO STA.	CONTRACT NO. 66A64 ILLINOIS FED. AID PROJECT		

Rev.

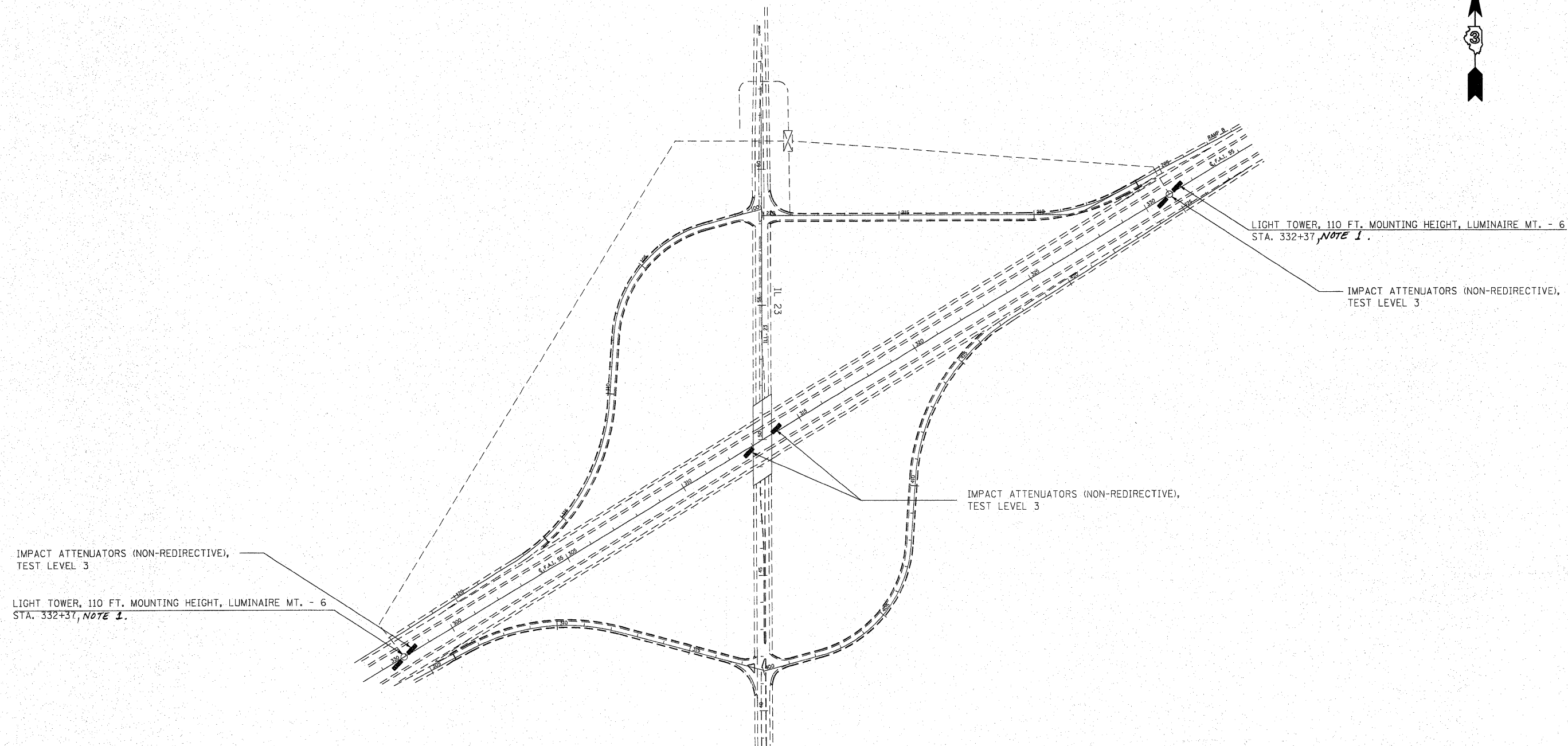

- NOTES:
- 1. PROPOSED HIGH MAST LUMINAIRES SHALL BE AIMED AS FOLLOWS:
 - THREE (3) LUMINAIRES PERPENDICULAR TO NORTHBOUND LANE EDGE OF PAVEMENT
 - THREE (3) LUMINAIRES PERPENDICULAR TO SOUTHBOUND LANE EDGE OF PAVEMENT

FILE NAME =	USER NAME = braboyga	DESIGNED -	REVISED -	STATE OF ILLINOIS DEPARTMENT OF TRANSPORTATION	DETAILS			F.A.I. RTE.	SECTION	COUNTY	TOTAL SHEETS	SHEET NO.
ca\pwwork\pwwork\braboyga\d0238396\0368	664-ehd-detailed.DGN	DRAWN -	REVISED -		55	(53-5)L	LIVINGSTON	9	7			
	PLOT SCALE = 50.0000' / IN.	CHECKED -	REVISED -		SCALE: SHEET NO. OF SHEETS STA. TO STA.			CONTRACT NO. 66A64				
	PLOT DATE = Nov 24, 2010 - 08:30:16 AM	DATE -	REVISED -		ILLINOIS FED. AID PROJECT							

Rev.

GENERAL NOTES

1. THE 10:1 SLOPE CONTROLS NOSE OF ATTENUATOR BASE ELEVATION.
2. ATTENUATOR BASE GRADE PARALLELS EDGE OF PAVEMENT GRADE.
3. SLOPE ADJACENT TO ATTENUATOR BASE SHALL BE 10:1 OR FLATTER.

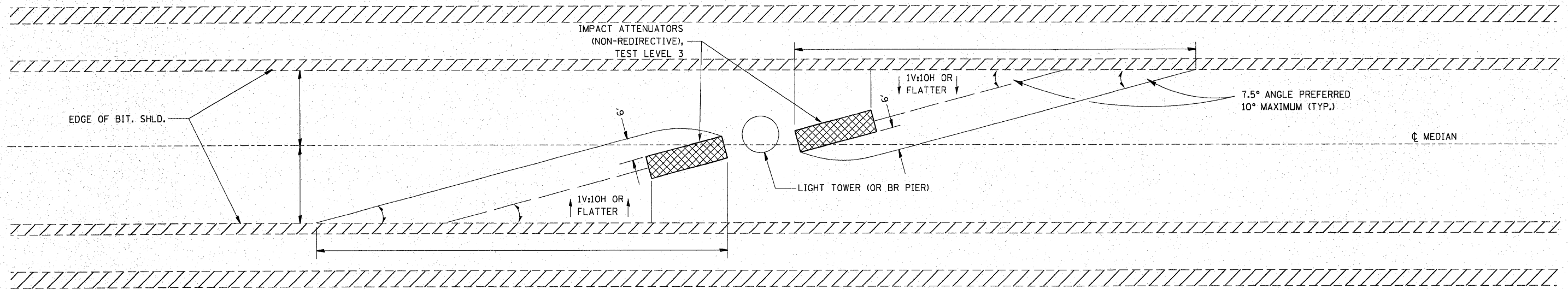

IMPACT ATTENUATOR LAYOUT AND GRADING PLAN

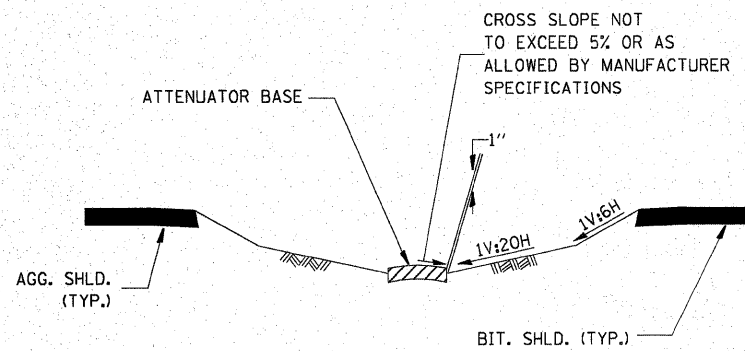

SECTION A - A

NOTE:

ATTENUATOR BASE SHALL BE PER MANUFACTURER SPECIFICATIONS EXCEPT SAND MODULE SYSTEMS SHALL HAVE THE FOLLOWING ADDITIONAL REQUIREMENTS:

1. ATTENUATOR BASE SHALL PROVIDE A 1' BUFFER ALONG THE SIDES AND FRONT OF THE ARRAY.
2. SAND MODULE SYSTEMS SHALL BE PLACED ON A HMA OR CONCRETE BASE
3. ALL EARTH EXCAVATION MATERIAL MUST BE DISTRIBUTED ON-SITE. THE CONTRACTOR IS NOT ALLOWED TO HAUL ANY MATERIAL AWAY.

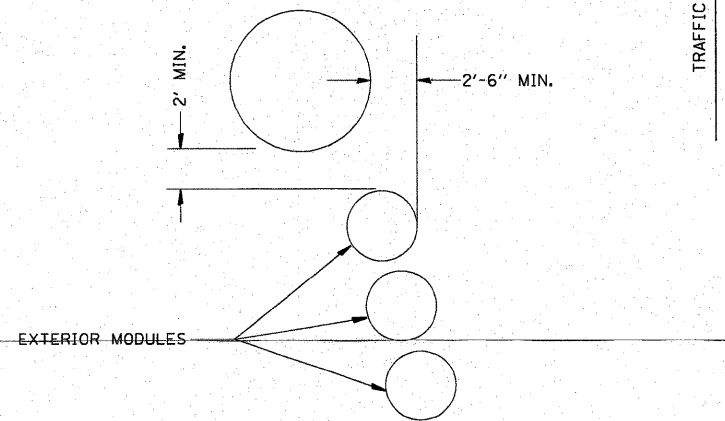

TYPICAL EXTERIOR MODULE LAYOUT

FILE NAME =	USER NAME = braboypc	DESIGNED -	REVISED -	STATE OF ILLINOIS DEPARTMENT OF TRANSPORTATION	DETAILS			F.A.I. RTE.	SECTION	COUNTY	TOTAL SHEETS	SHEET NO.
ca:\pwork\pwork\braboypc\0230396\03666664\shd-detailed.DGN	PLLOT SCALE = 50.0000' / IN.	DRAWN -	REVISED -					55	(53-5)L	LIVINGSTON	9	8
	PLLOT DATE = Nov 24, 2010 - 08:30:06 AM	CHECKED -	REVISED -		SCALE: SHEET NO. OF SHEETS STA. TO STA.			CONTRACT NO. 66A64				
		DATE -	REVISED -					ILLINOIS FED. AID PROJECT				

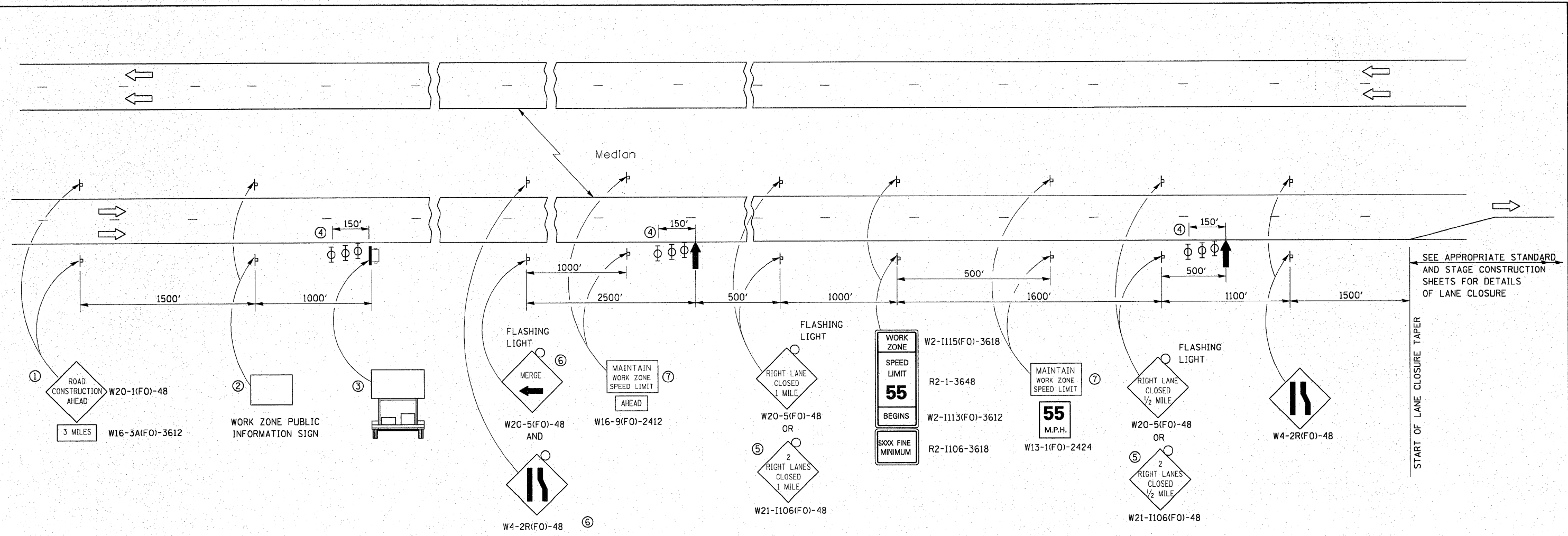

- ① THE ROAD CONSTRUCTION AHEAD SIGN SHALL BE LOCATED 3 MILES IN ADVANCE OF THE PROJECT LIMITS.
- ② THE MESSAGE AND SIZE OF THE WORK ZONE PUBLIC INFORMATION SIGN SHALL BE AS SPECIFIED BY THE DEPARTMENT.
- ③ TO BE PLACED IN THE MEDIAN WHEN FEASIBLE. THE MESSAGE BOARD SHALL BE USED TO DISPLAY STATUS OF LANES WITHIN THE PROJECT. THE PRIMARY MESSAGES SHALL BE:
"RIGHT LANE CLOSED" / " x MILES AHEAD"
"LEFT LANE CLOSED" / " x MILES AHEAD"
"ALL LANES OPEN"
- ④ THREE, TYPE II BARRICADES, DRUMS, OR VERTICAL BARRICADES AT 50' CENTERS.
- ⑤ THIS SIGN SHALL BE USED WHEN 2 LANES ARE CLOSED.
- ⑥ WHEN THE LEFT LANE IS CLOSED, SWITCH THESE TWO SIGNS AND THE DIRECTION OF THE MERGE ARROW.

⑦ 48"x36" FLUORESCENT ORANGE SIGN WITH BLACK LETTERS.

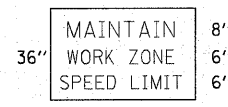

- ↑ ARROW BOARD
- ☐ PORTABLE CHANGEABLE MESSAGE SIGN
- ⊥ SIGN
- ⊕ TYPE II BARRICADE, DRUM, OR VERTICAL BARRICADE WITH MONODIRECTIONAL FLASHING LIGHT

GENERAL NOTE:

THIS STANDARD IS USED WHERE AT ANY TIME A LANE IS CLOSED ON A FREEWAY/EXPRESSWAY.

WHEN THE LEFT LANE IS CLOSED, LEFT LANE CLOSED SIGNS SHALL BE SUBSTITUTED FOR THE RIGHT LANE CLOSED SIGNS.

THE FIRST TWO SIGNS AND THE MESSAGE BOARD ARE STATIONARY. THE OTHER SIGNS AND ARROWBOARDS SHALL BE MOVED AS NECESSARY TO MAINTAIN THE REQUIRED DISTANCE FROM THE START OF THE LANE CLOSURE TAPER(S).

SEE SPECIAL PROVISIONS.

ALL DIMENSIONS ARE IN INCHES UNLESS OTHERWISE SHOWN.

FILE NAME =	USER NAME = braboygo	DESIGNED -	REVISED -	STATE OF ILLINOIS DEPARTMENT OF TRANSPORTATION	STANDARD 701400 (SPECIAL)	F.A. RTE.	SECTION	COUNTY	TOTAL SHEETS	SHEET NO.
0:\pwork\pwork\braboygo\08230396\036664-ht-details.DGN	08230396\036664-ht-details.DGN	DRAWN -	REVISED -			55	(53-5)L	LIVINGSTON	9	9
PLOT SCALE = 50.0000' / IN.		CHECKED -	REVISED -			CONTRACT NO. 66A64				
PLOT DATE = Nov 24, 2010 - 08:29:58 AM		DATE -	REVISED -			FED. ROAD DIST. NO.	ILLINOIS FED. AID PROJECT			