

STA. 425+98 TO STA. 430+12
 PCC BASE CSE 12" = 1153.1 SQ. YD.
 PAVEMENT FABRIC = 1153.1 SQ. YD.
 TIE BARS, 3/4" = 166 EACH
 DOWEL BARS, 1" = 48 EACH
 SUB-BASE GRAN. MAT'L TYPE A 12" = 1842.8 SQ. YD.
 GEOTECH. FAB. FOR GRND. STAB. = 1842.8 SQ. YD.

EXIST. S.N. 048-0048 CARRYING
 CRAIG SCHOOL RD. (TR90) OVER I-74

LT. STA. 424+82 TO STA. 433+06
 TEMP. SHOULDERS = 365.7 SQ. YD.
 (TO BE PLACED BEFORE STAGING
 FOR PAVEMENT REMOVAL IN DRIVING LANE.
 SHOULDER WILL BE PLACED AT A THICKNESS OF 10".
 SEE MIXTURES TABLE FOR MIX DESIGN FOR TEMP. SHLDS.)

RT. STA. 425+09 TO STA. 432+81
 HMA SHOULDER, 10.5" = 857.6 SQ. YD.
 SUB-BASE MAT'L TYPE C = 489.2 TONS

LT. STA. 424+82 TO STA. 433+06
 HMA SHOULDER, 8" = 365.7 SQ. YD.
 SUB-BASE MAT'L TYPE C = 246.8 TONS

NOTE:
 1. FOR HMA, GUARDRAIL, AGG. SHOULDERS,
 SEE SCHEDULES FOR QUANTITIES.
 2. INSTALL UNDERDRAINS ACCORDING TO STD. 601001
 SEE SCHEDULES FOR LOCATIONS AND QUANTITIES
 3. GRADING AND SHAPING DITCHES WILL REQUIRE 208 CU.YD.
 OF FILL. THIS WILL BE INCLUDED IN THE COST OF GRADING
 AND SHAPING OF THE DITCHES.

RT. STA. 425+09 TO 432+81
 PROP. GRADING AND SHAPING = 772 FT.

STA. 424+39 TO STA.433+06 (MEDIAN DITCH)
 PROP. GRADING AND SHAPING = 867 FT.

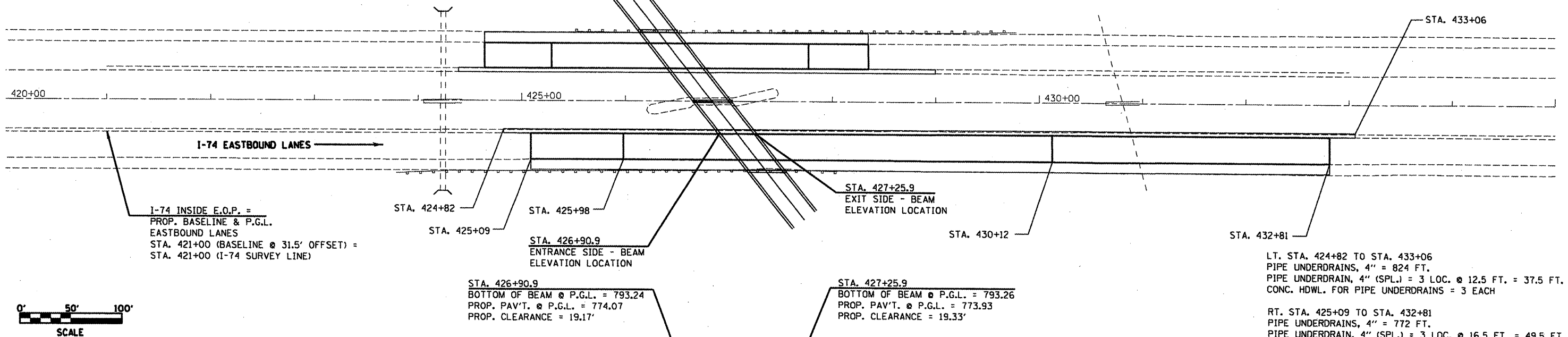

I-74 INSIDE E.O.P. =
 PROP. BASELINE & P.G.L.
 EASTBOUND LANES
 STA. 421+00 (BASELINE @ 31.5' OFFSET) =
 STA. 421+00 (I-74 SURVEY LINE)

STA. 424+82
 STA. 425+09
 STA. 426+90.9
 ENTRANCE SIDE - BEAM
 ELEVATION LOCATION

STA. 427+25.9
 EXIT SIDE - BEAM
 ELEVATION LOCATION

STA. 426+90.9
 BOTTOM OF BEAM @ P.G.L. = 793.24
 PROP. PAV'T. @ P.G.L. = 774.07
 PROP. CLEARANCE = 19.17'

STA. 427+25.9
 BOTTOM OF BEAM @ P.G.L. = 793.26
 PROP. PAV'T. @ P.G.L. = 773.93
 PROP. CLEARANCE = 19.33'

LT. STA. 424+82 TO STA. 433+06
 PIPE UNDERDRAINS, 4" = 824 FT.
 PIPE UNDERDRAIN, 4" (SPL.) = 3 LOC. @ 12.5 FT. = 37.5 FT.
 CONC. HDWL. FOR PIPE UNDERDRAINS = 3 EACH

RT. STA. 425+09 TO STA. 432+81
 PIPE UNDERDRAINS, 4" = 772 FT.
 PIPE UNDERDRAIN, 4" (SPL.) = 3 LOC. @ 16.5 FT. = 49.5 FT.
 CONC. HDWL. FOR PIPE UNDERDRAINS = 3 EACH

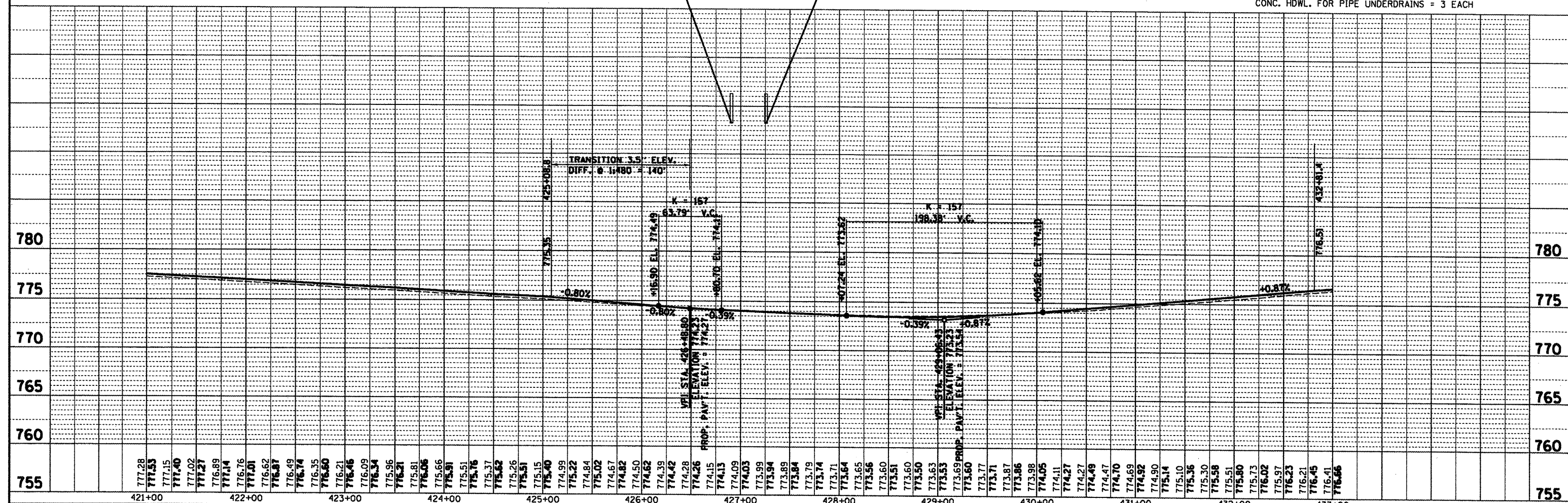

FILE NAME = D468506-prof-brIDGE.dgn	USER NAME = bergstokorae	DESIGNED -	REVISED -	STATE OF ILLINOIS DEPARTMENT OF TRANSPORTATION	PROPOSED PLAN & PROFILE DETAIL UNDER SN 048-0048 I-74 EASTBOUND LANES			F.A.J. RTE. 74	SECTION (48-27)RS-4	COUNTY KNOX	TOTAL SHEETS 103	SHEET NO. 41
PLOT SCALE = 100.0000' / IN.		CHECKED -	REVISED -		SCALE:	SHEET NO. OF SHEETS	STA. TO STA.	CONTRACT NO. 68506				
PLOT DATE = 12/28/2018		DATE -	REVISED -		ILLINOIS FED. AID PROJECT							

DATE	
BY	
PLAN	
SURVEYED	
ADJUSTED	
NOTED	
CHECKED	
NO. OF WAY CHECKED	
DATE FILE NAME	

DATE	
BY	
PROFILE	
SURVEYED	
ADJUSTED	
NOTED	
CHECKED	
NO. OF WAY CHECKED	
DATE FILE NAME	