

DATE	
BY	
SAVED	
FINAL SURVEY	
NOTE BOOK	
NO.	

DATE	
BY	
SAVED	
ORIGINAL SURVEY	
NOTE BOOK	
NO.	

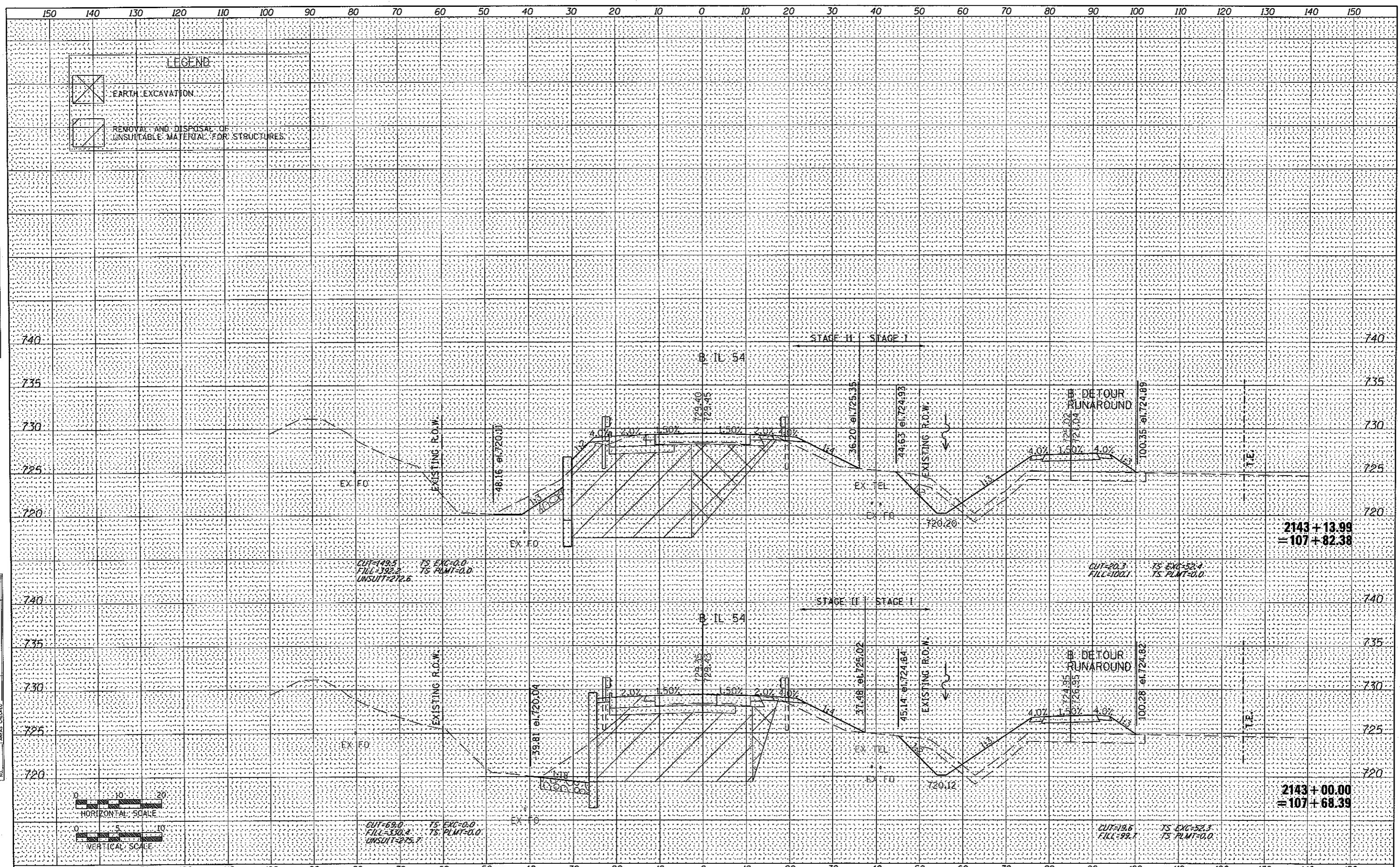

2143 + 13.99
= 107 + 82.38

2143 + 00.00
= 107 + 68.39

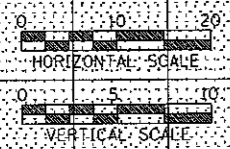

CUT=149.5 TS EXC=0.0
FILL=392.2 TS PLMT=0.0
UNSUIT=272.6

CUT=20.3 TS EXC=52.4
FILL=100.1 TS PLMT=0.0

CUT=69.0 TS EXC=0.0
FILL=330.2 TS PLMT=0.0
UNSUIT=275.7

CUT=19.6 TS EXC=52.3
FILL=99.7 TS PLMT=0.0

FILE NAME =	USER NAME = willis	DESIGNED -	REVISED -	STATE OF ILLINOIS DEPARTMENT OF TRANSPORTATION	IL 54 OVER COON CREEK CONSTRUCTION CROSS SECTIONS	F.A.P. RTE.	SECTION	COUNTY	TOTAL SHEETS	SHEET NO.	
D570271-sht-ssht-construction.dgn		DRAWN -	REVISED -			71	(158-1)BR-1	DEWITT	76	44	
		CHECKED -	REVISED -			CONTRACT NO. 70271					
		DATE -	REVISED -			[ILLINOIS] FED. AID PROJECT					
PLOT SCALE = 28.0000" / IN.		PLOT DATE = 12/1/2010		SCALE:		SHEET NO. OF SHEETS		STA. 2143+00.00 TO STA. 2143+13.99			