

DRAINAGE STRUCTURE IMPROVEMENT DETAIL

LOCATIONS #15 A. STA. 967+38 (I-74) S.N. 057-8562 & #15 B. STA. 966+70.1 (FRONTAGE RD.) S.N. 057-8582



LOC. #15A STA.967+38		
ITEM # AND DESCRIPTION	UNIT	QUANTITY
21400100 Grading and Shaping Ditches	FOOT	40
25000210 Seeding, Class 2A	ACRE	0.006
25000400 Nitrogen Fert. Nutr.	POUND	0.54
25000500 Phosphorous Fert. Nutr.	POUND	0.54
25000600 Potassium Fert. Nutr.	POUND	0.54
25100115 Mulch Method 2	ACRE	0.006
28000250 Temp. Eros. Contr. Seeding	POUND	0.6
28100107 Stone Rip Rap Class A4	SQ YD	61.5
28200200 Filter Fabric	SQ YD	61.5
54002010 Expansion Bolts 1/2	EACH	4
54248510 Concrete Collar	CU YD	0.60
550B0070 Storm Sewer Class B Ty 15"	FOOT	33
55100700 Storm Sewer Remove 15"	FOOT	33

LOC. #15B STA.966+70.1 (FRONTAGE RD.)		
ITEM # AND DESCRIPTION	UNIT	QUANTITY
21400100 Grading and Shaping Ditches	FOOT	33
25000210 Seeding, Class 2A	ACRE	0.009
25000400 Nitrogen Fert. Nutr.	POUND	0.81
25000500 Phosphorous Fert. Nutr.	POUND	0.81
25000600 Potassium Fert. Nutr.	POUND	0.81
25100115 Mulch Method 2	ACRE	0.009
28000250 Temp. Eros. Contr. Seeding	POUND	0.9
28000305 Ditch Check Temporary	FOOT	20
28000500 Inlet and Pipe Protection	EACH	1
28100107 Stone Rip Rap Class A4	SQ YD	58.3
28200200 Filter Fabric	SQ YD	58.3
X2010350 Tree Removal Acres, Special	ACRE	0.016

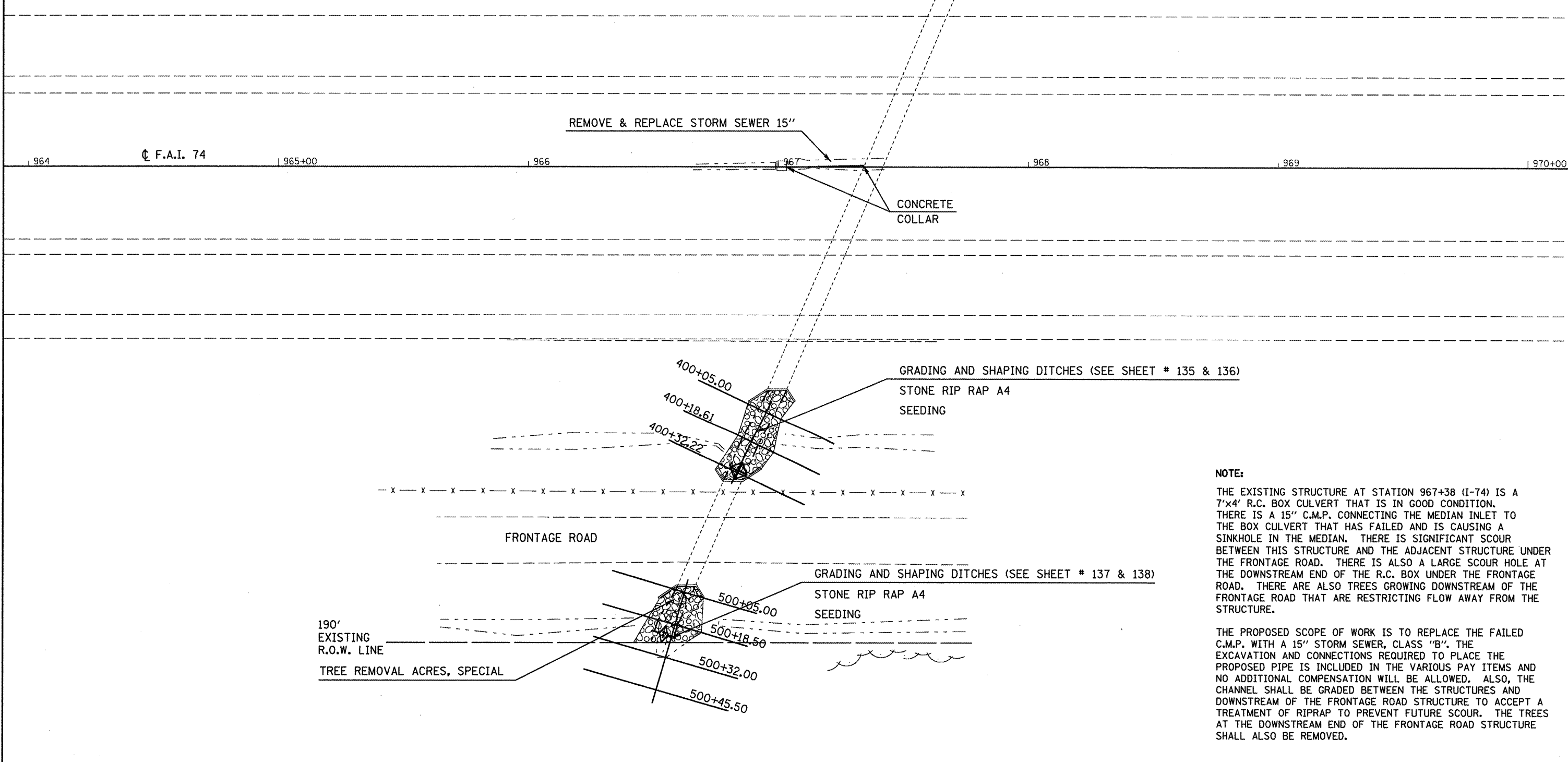

NOTE:

THE EXISTING STRUCTURE AT STATION 967+38 (I-74) IS A 7'x4' R.C. BOX CULVERT THAT IS IN GOOD CONDITION. THERE IS A 15" C.M.P. CONNECTING THE MEDIAN INLET TO THE BOX CULVERT THAT HAS FAILED AND IS CAUSING A SINKHOLE IN THE MEDIAN. THERE IS SIGNIFICANT SCOUR BETWEEN THIS STRUCTURE AND THE ADJACENT STRUCTURE UNDER THE FRONTAGE ROAD. THERE IS ALSO A LARGE SCOUR HOLE AT THE DOWNSTREAM END OF THE R.C. BOX UNDER THE FRONTAGE ROAD. THERE ARE ALSO TREES GROWING DOWNSTREAM OF THE FRONTAGE ROAD THAT ARE RESTRICTING FLOW AWAY FROM THE STRUCTURE.

THE PROPOSED SCOPE OF WORK IS TO REPLACE THE FAILED C.M.P. WITH A 15" STORM SEWER, CLASS "B". THE EXCAVATION AND CONNECTIONS REQUIRED TO PLACE THE PROPOSED PIPE IS INCLUDED IN THE VARIOUS PAY ITEMS AND NO ADDITIONAL COMPENSATION WILL BE ALLOWED. ALSO, THE CHANNEL SHALL BE GRADED BETWEEN THE STRUCTURES AND DOWNSTREAM OF THE FRONTAGE ROAD STRUCTURE TO ACCEPT A TREATMENT OF RIPRAP TO PREVENT FUTURE SCOUR. THE TREES AT THE DOWNSTREAM END OF THE FRONTAGE ROAD STRUCTURE SHALL ALSO BE REMOVED.

FILE NAME =	USER NAME = hogenbj	DESIGNED - BJM	REVISED -	STATE OF ILLINOIS DEPARTMENT OF TRANSPORTATION	DRAINAGE STRUCTURE IMPROVEMENT DETAIL LOCATION #15 A & #15 B STA. 967+38	F.A.I. RTE. =	SECTION	COUNTY	TOTAL SHEETS	SHEET NO.
ca:\pwork\pwork\hogenbj\0158340\0572	58-shr-am struct det.dgn	DRAWN -	REVISED -			74	(57-201),21,22)RS-3	McLean	150	65
PLOT SCALE = 40.0000' / IN.	CHECKED -	REVISED -	REVISED -			CONTRACT NO. 70550				
PLOT DATE = 10/21/2010	DATE - 09/23/10	REVISED -	REVISED -			ILLINOIS FED. AID PROJECT				