

# AS-BUILT PLANS FOR INFORMATION ONLY

B.M. Chiseled "X" in North Handrail, End Post W. End Bridge  
Sta. 120+30, Elev 645.02.  
Existing Structure: 4 Spans R.C. Deck Girder, Open Abuts. &  
Solid Concrete Piers to be removed by Bridge Contractor

STATE OF ILLINOIS  
DEPARTMENT OF PUBLIC WORKS & BUILDINGS

SHEET NO. 1	DATE	SCALE	PROJECT

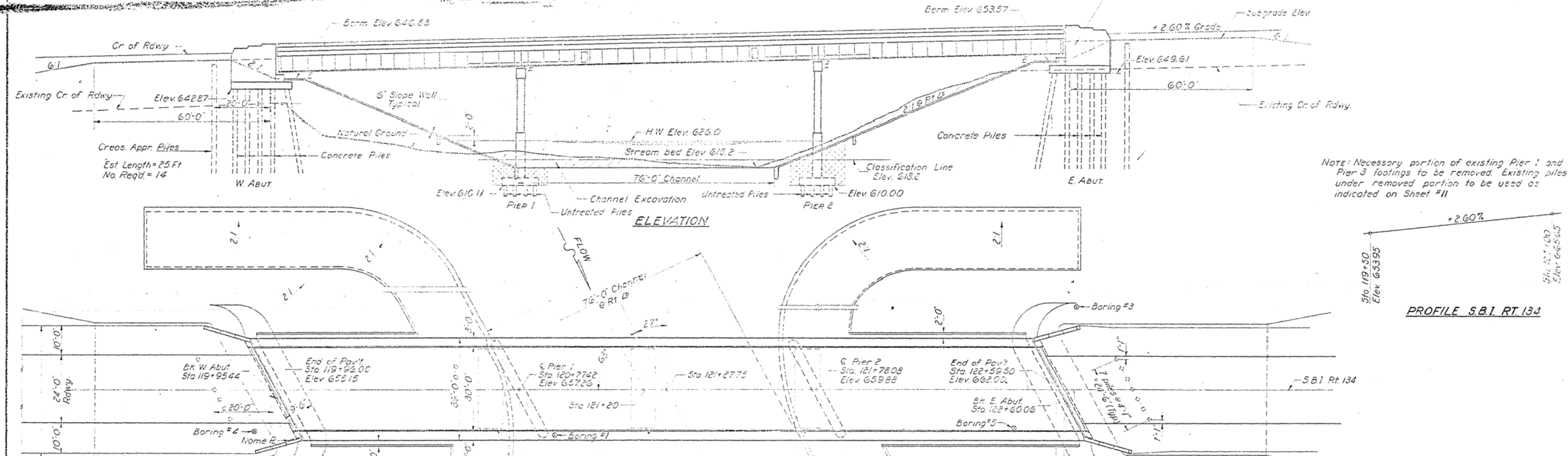

NOTE: Necessary portion of existing Pier 1 and Pier 3 footings to be removed. Existing piles under removed portion to be used as indicated on Sheet #11

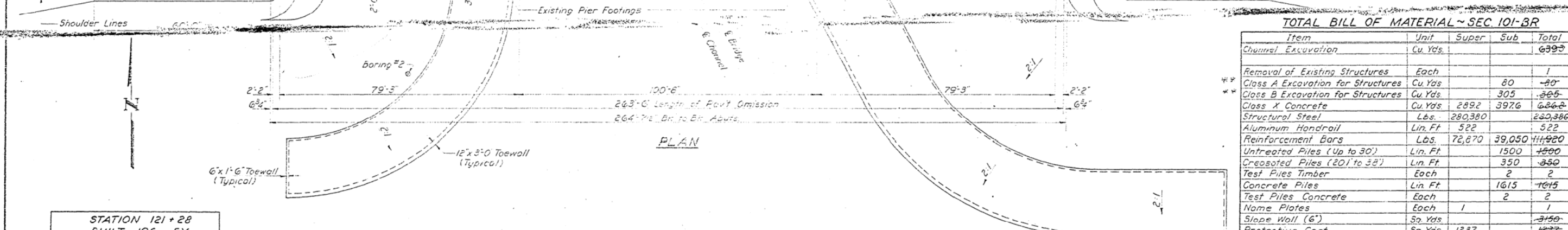
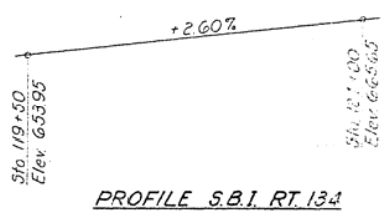

**TOTAL BILL OF MATERIAL - SEC. 101-BR**

Item	Unit	Super	Sub	Total
Channel Excavation	Cu. Yds.			6393
Removal of Existing Structures	Each			1
Class A Excavation for Structures	Cu. Yds.		80	80
Class B Excavation for Structures	Cu. Yds.		305	305
Class X Concrete	Cu. Yds.	2892	3976	6868
Structural Steel	Lbs.	280,380		280,380
Aluminum Handrail	Lin. Ft.	522		522
Reinforcement Bars	Lbs.	72,870	39,050	111,920
Untreated Piles (Up to 30')	Lin. Ft.		1500	1500
Creosoted Piles (20' to 32')	Lin. Ft.		350	350
Test Piles Timber	Each		2	2
Concrete Piles	Lin. Ft.		1615	1615
Test Piles Concrete	Each		2	2
Name Plates	Each	1		1
Slope Wall (6')	Sq. Yds.			2450
Protective Coat	Sq. Yds.	1237		1237
Bridge Seat Sealant	L. Sum			L. Sum

\*To be used on the east of the Abutment only.  
\*\*Includes excavation for Slope Wall.

**STATION 121+28**  
BUILT 196 BY  
STATE OF ILLINOIS  
S.B.I. RT. 134 SEC. 101 BR  
F.A. PROJ. F-177(7)  
LOADING HS-20

**NAME PLATE LETTERING**  
See Standard 2113-1  
See Sheet #9 for location

DESIGNED: <i>Robb S. Clark</i>	EXAMINED: <i>W.F. Dammann</i>
CHECKED: <i>W. J. Camachus</i>	PASSED: <i>W.F. Dammann</i>
DRAWN: <i>J.L. Armstrong</i>	APPROVED: <i>V.E. Hagg</i>
CHECKED: <i>W.F. Dammann</i>	

Dec. 12 1962

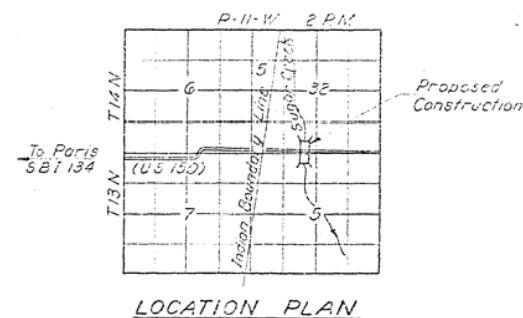

**WATERWAY INFORMATION**  
Drainage Area ----- 17,000 Acres  
Character ----- rolling wooded & cultivated  
Required Opening (30 Yr. Fl.) ----- 991 Sq. Ft.  
Present Opening ----- 826 Sq. Ft.  
Proposed Opening ----- 1000 Sq. Ft.  
Ordinary Water Elev. 618.2  
Low Water Elev. 617.2

**DESIGN STRESSES**  
fc = 1400 psi, Super & Sub  
fv = 75 psi, Frps  
fs = 20,000 psi, Reinf  
fs = 20,000 psi, Struc  
LOADING HS-20

**PROJ. F-177(7)**  
**GENERAL PLAN & ELEVATION**  
**SUGAR CREEK BRIDGE**  
**S.B.I. RT. 134 SEC. 101 BR**  
**EDGAR COUNTY**  
**STA. 121+28**