

STATE OF ILLINOIS
DEPARTMENT OF TRANSPORTATION
DIVISION OF HIGHWAYS

**PROPOSED
CONTRACT MAINTENANCE**

FAP 315 (US 136)
SECTION 123 RS-7

MASON COUNTY

F.A.P. RTE.	SECTION	COUNTY	TOTAL SHEETS	SHEET NO.
315	123 RS-7	MASON	9	1
FED. ROAD DIST. NO.	ILLINOIS	CONTRACT NO. 72D85		

FOR INDEX OF SHEETS, SEE SHEET NO. 2

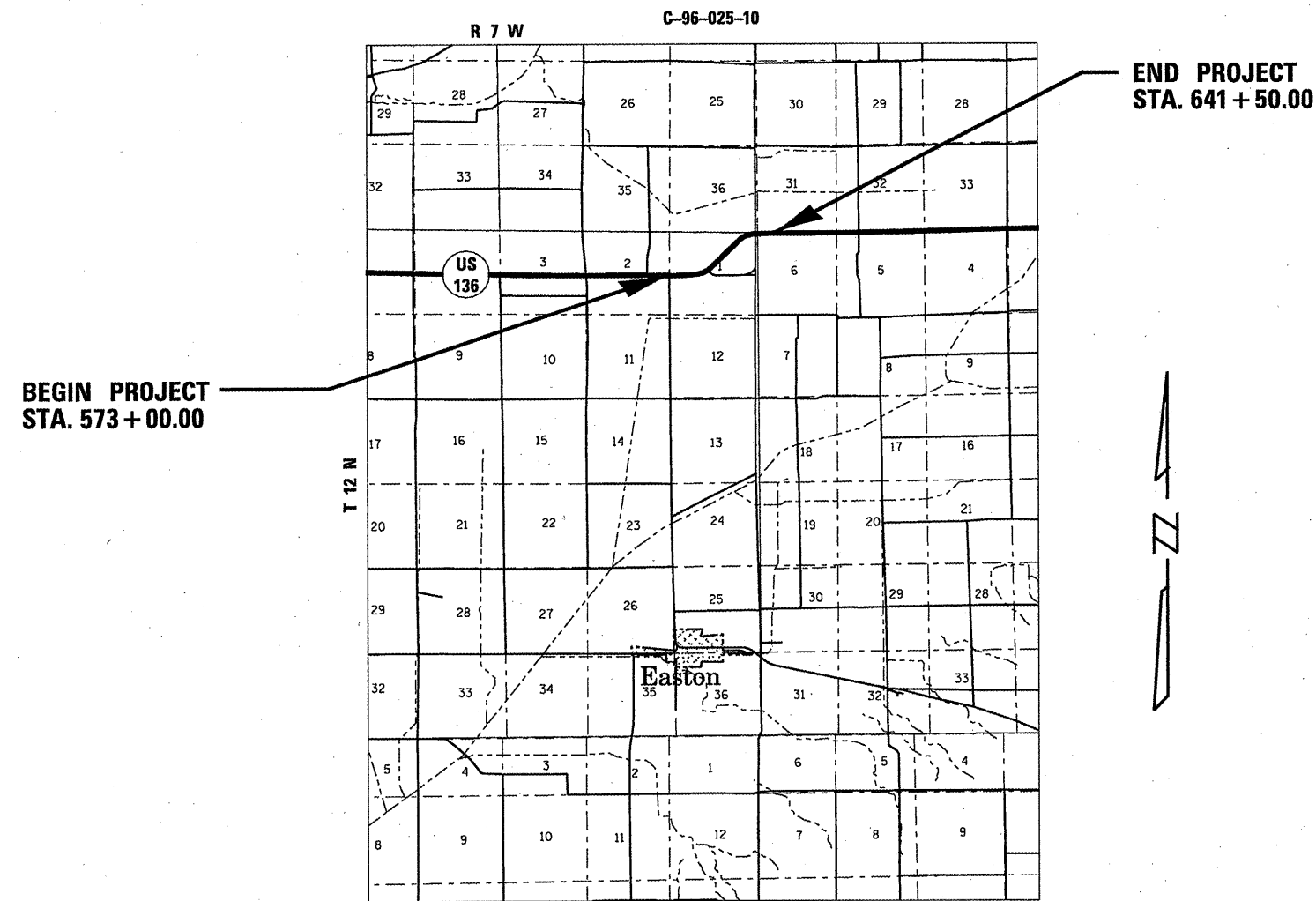
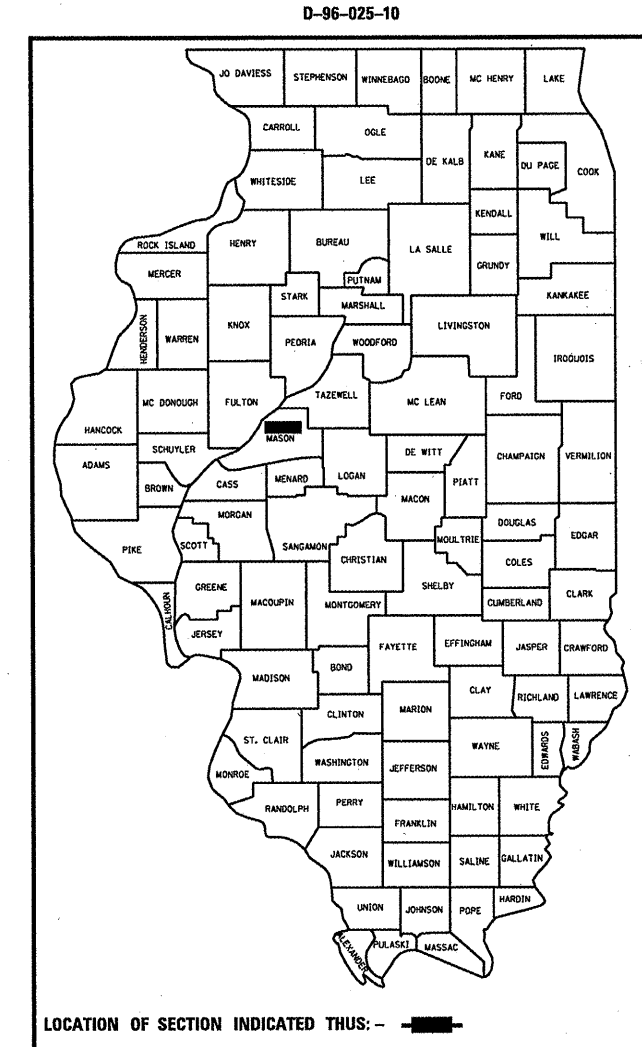

A.D.T. = 3,450 (375)

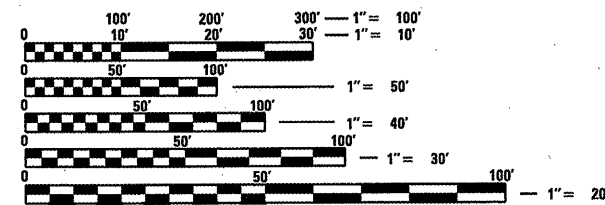

FULL SIZE PLANS HAVE BEEN PREPARED USING STANDARD ENGINEERING SCALES. REDUCED SIZED PLANS WILL NOT CONFORM TO STANDARD SCALES. IN MAKING MEASUREMENTS ON REDUCED PLANS, THE ABOVE SCALES MAY BE USED.

J.U.L.I.E.
JOINT UTILITY LOCATION INFORMATION FOR EXCAVATION
1-800-892-0123
OR 811

PLAN AND CONTRACT TECHNICIAN
TIMOTHY SHARP (217)782-7743

CONTRACT NO. 72D85

GROSS LENGTH = 6,850.00 FT. = 1.297 MILES

STATE OF ILLINOIS
DEPARTMENT OF TRANSPORTATION
DIVISION OF HIGHWAYS

SUBMITTED January 5 20 11
Roger Z. Smith
DEPUTY DIRECTOR OF HIGHWAYS, REGION ENGINEER

Feb 4 20 11
Scott E. Stitt, P.E., PE
ENGINEER OF DESIGN AND ENVIRONMENT

Feb 4 20 11
Christine M. Reed
DIRECTOR OF HIGHWAYS, CHIEF ENGINEER

PRINTED BY THE AUTHORITY
OF THE STATE OF ILLINOIS