

EXIST. CURVE 107
 PI STA. = 268+97.01
 $\Delta = 33^\circ 06' 46''$ (LT)
 $D = 3^\circ 00' 37''$
 $R = 1,903.36'$
 $T = 565.84'$
 $L = 1,100.00'$
 $E = 82.33'$
 $e = \text{-----}$
 T.R. = -----
 S.E. RUN = -----
 P.C. STA. = 263+31.17
 P.T. STA. = 274+31.17

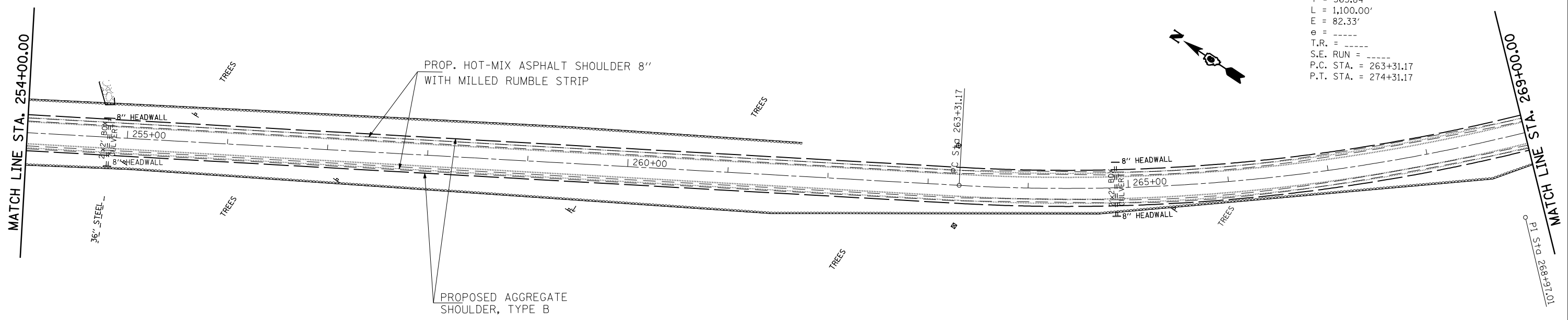

EXIST. CURVE 108
 PI STA. = 283+39.39
 $\Delta = 27^\circ 38' 46''$ (LT)
 $D = 2^\circ 59' 32''$
 $R = 1,914.77'$
 $T = 471.13'$
 $L = 923.90'$
 $E = 57.11'$
 $e = \text{-----}$
 T.R. = -----
 S.E. RUN = -----
 P.C. STA. = 278+68.27
 P.T. STA. = 287+92.17

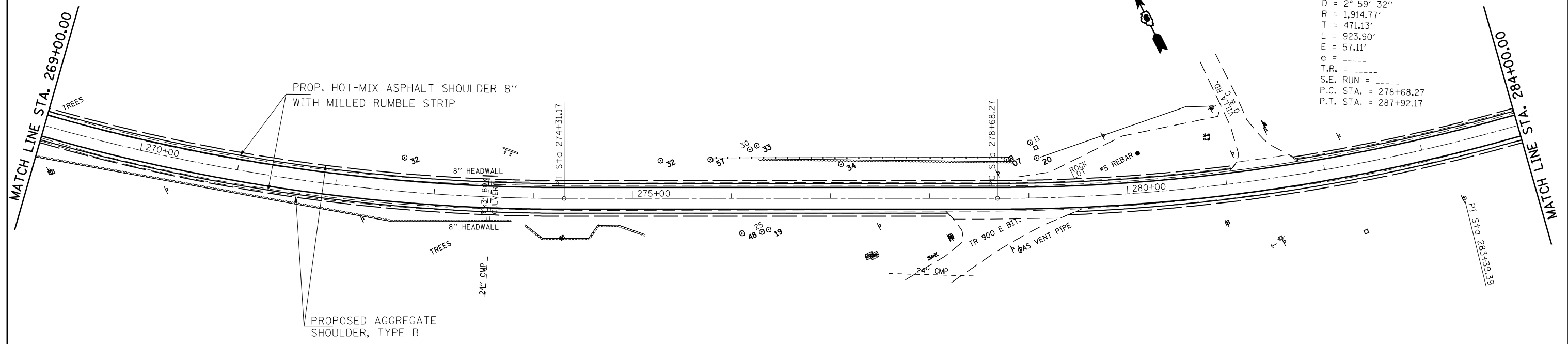

FILE NAME =	USER NAME = coxte	DESIGNED -	REVISED -	STATE OF ILLINOIS DEPARTMENT OF TRANSPORTATION	PLAN			F.A.P. RTE.	SECTION	COUNTY	TOTAL SHEETS	SHEET NO.
ei:\pw\work\p\dot\coxte\d0230048\067205-sh1-plan2.dgn		DRAWN -	REVISED -		753	143 I	CHRISTIAN	19	14			
PLOT SCALE = 100.0000' / IN.		CHECKED -	REVISED -		CONTRACT NO. 72D95							
PLOT DATE = Dec-28-2010 02:26:18PM		DATE -	REVISED -		ILLINOIS FED. AID PROJECT							
				SCALE:	SHEET NO.	OF	SHEETS	STA.	TO STA.			