

F.A.P. RTE.	SECTION	COUNTY	TOTAL SHEETS	SHEET NO.
753	143 I	CHRISTIAN	19	1
		ILLINOIS	CONTRACT NO. 72D95	

INDEX OF SHEETS

- 1 COVER SHEET
- 2 GENERAL NOTES
- 3 SUMMARY OF QUANTITIES
- 4-6 TYPICAL SECTIONS
- 7 SHOULDER & RUMBLE STRIP DETAILS
- 8 DETAILS FOR RURAL /URBAN ENT., MAILBOX TURNOUT & SIDEROADS
- 9-10 SCHEDULE OF QUANTITIES
- 11-19 PLAN SHEETS

STANDARDS

000001-06	701301-04
280001-05	701306-03
482011-03	701311-03
606101-04	701326-04
701001-02	701901-01
701006-03	780001-02
701011-02	

CLASSIFICATION:
MINOR-ARTERIAL

TRAFFIC COUNT
ADT = 2647(2009)

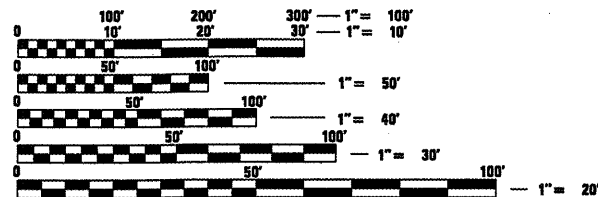

FULL SIZE PLANS HAVE BEEN PREPARED USING STANDARD ENGINEERING SCALES. REDUCED SIZED PLANS WILL NOT CONFORM TO STANDARD SCALES. IN MAKING MEASUREMENTS ON REDUCED PLANS, THE ABOVE SCALES MAY BE USED.

J.U.L.I.E.
JOINT UTILITY LOCATION INFORMATION FOR EXCAVATION
1-811-892-0123

PROJECT ENGINEER: JEFF MYERS 217-782-4761
PROJECT MANAGER: KEN ANDERSON 217-524-7546
CONTRACT NO. 72D95

STATE OF ILLINOIS DEPARTMENT OF TRANSPORTATION DIVISION OF HIGHWAYS

PROPOSED HIGHWAY PLANS

FAP 753 ROUTE (IL 104)
SECTION 143 I
PROJECT HSIP-0753(039)
SHOULDER RECONSTRUCTION,
MILLED RUMBLE STRIPS
CHRISTIAN COUNTY
C-96-014-11

D-96-014-11

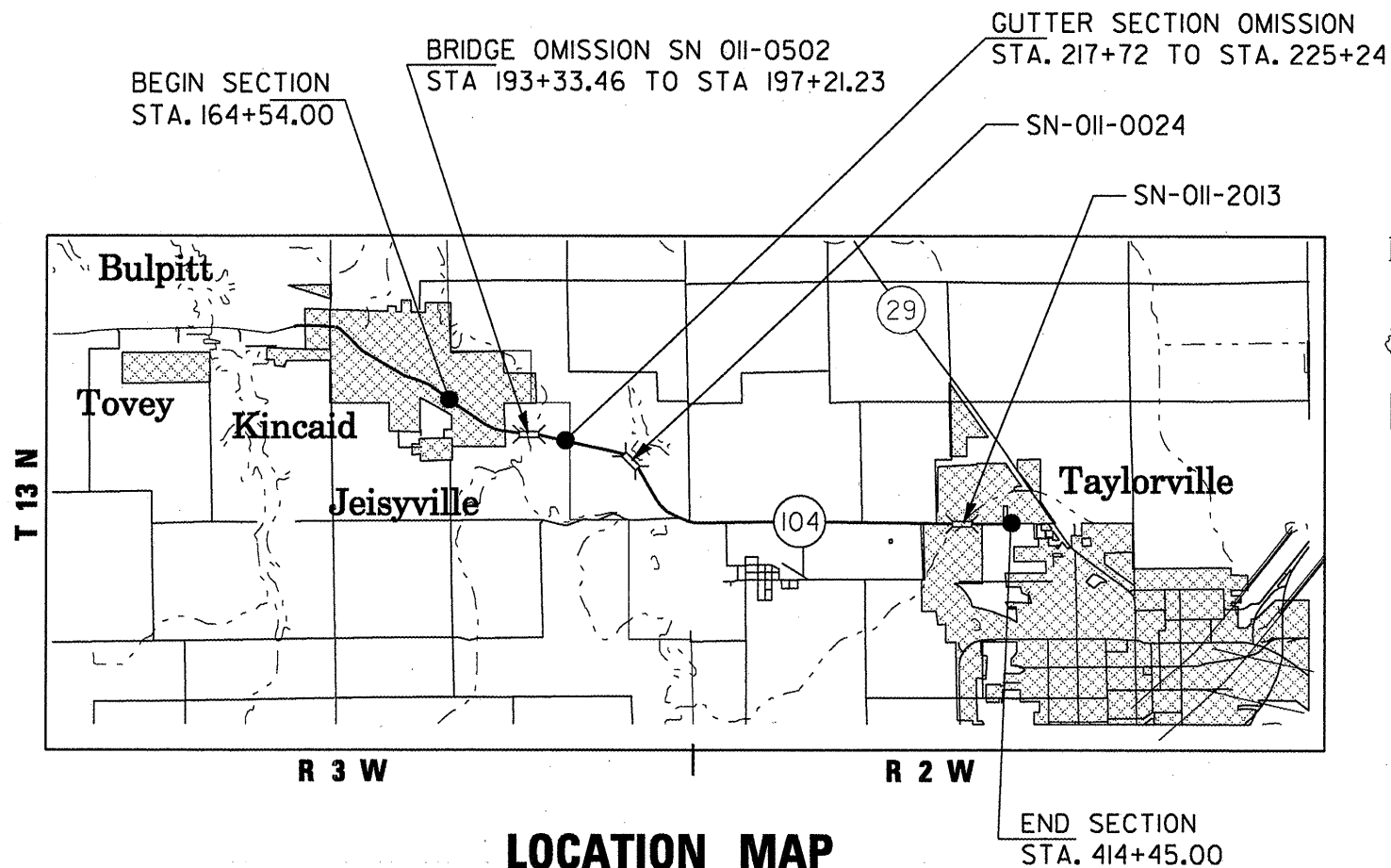
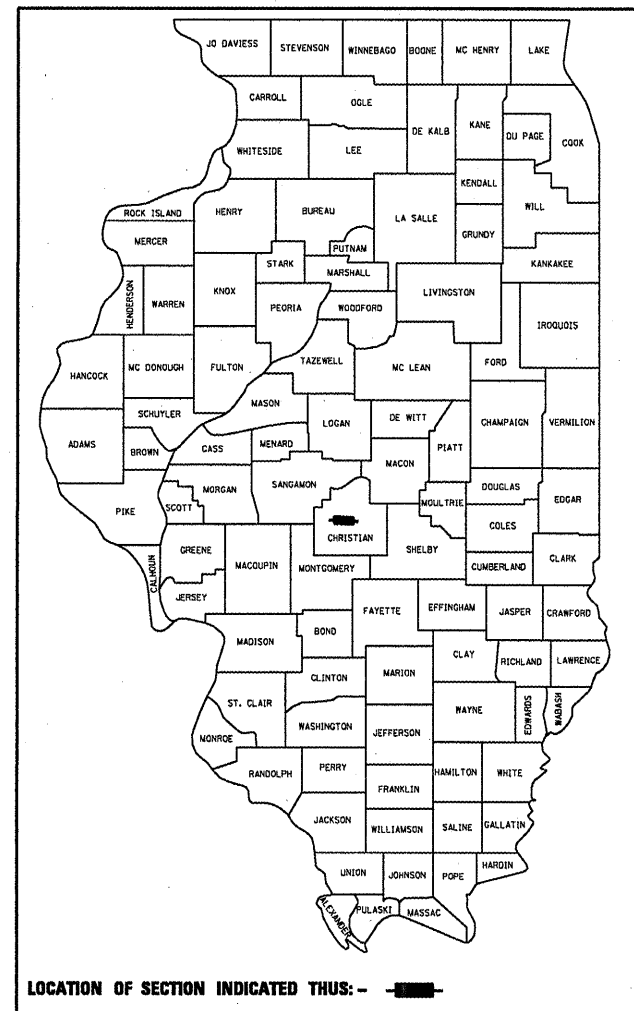

LOCATION MAP

GROSS LENGTH = 24,991 FT. = 4.733 MILES
NET LENGTH = 23,851.23 FT. = 4.517 MILES

NOTE:

STA. 164+54.00 TO STA. 225+24.00 MILLED RUMBLE STRIP IN EXISTING HMA SHOULDER
STA. 225+24.00 TO STA. 414+45.00 SHOULDER RECONSTRUCTION WITH MILLED RUMBLE STRIP

STATE OF ILLINOIS
DEPARTMENT OF TRANSPORTATION
DIVISION OF HIGHWAYS

SUBMITTED *December 27, 2010*

Ray D. [Signature] DISTRICT ENGINEER

Feb 4 2011

Scott E. Stitt P.E. acting ENGINEER OF DESIGN AND ENVIRONMENT

Feb 4 2011

Christine M. Reed DIRECTOR, DIVISION OF HIGHWAYS

PRINTED BY THE AUTHORITY
OF THE STATE OF ILLINOIS

GENERAL NOTES

1. ANY REFERENCE TO A STANDARD IN THESE PLANS SHALL BE INTERPRETED TO MEAN THE EDITION AS INDICATED BY THE SUB NUMBER LISTED IN THE INDEX OF SHEETS OR THE COPY OF THE STANDARD INCLUDED IN THESE PLANS.
2. IN ADDITION TO FIELD SURVEYS, PLAN DIMENSIONS AND DETAILS RELATIVE TO THE EXISTING FACILITIES HAVE BEEN TAKEN FROM EXISTING PLANS AND ARE SUBJECT TO CONSTRUCTION VARIATIONS. IT SHALL BE THE CONTRACTOR'S RESPONSIBILITY TO VERIFY SUCH DIMENSIONS AND DETAILS IN THE FIELD. SUCH VARIATIONS SHALL NOT BE A CAUSE FOR ADDITIONAL COMPENSATION DUE TO A CHANGE IN THE SCOPE OF WORK; HOWEVER, THE CONTRACTOR WILL BE PAID FOR THE QUANTITY ACTUALLY FURNISHED AT THE UNIT PRICE BID FOR THE WORK.
3. ACCESS TO ALL ENTRANCES AND SIDE ROADS SHALL BE MAINTAINED AT ALL TIMES.
4. THE CONTRACTOR SHALL BE RESPONSIBLE FOR PROTECTING UTILITY PROPERTY FROM CONSTRUCTION OPERATIONS, AS OUTLINED IN ARTICLE 107.31 OF THE STANDARD SPECIFICATIONS. THE J.U.L.I.E. NUMBER IS 1-800-892-0123. A MINIMUM OF 48 HOURS ADVANCE NOTICE IS REQUIRED.
5. UNLESS DIRECTED BY THE ENGINEER, PAVEMENT MARKING LINES SHALL NOT BE LAID DIRECTLY OVER A LONGITUDINAL CRACK OR JOINT NOR OVER A TAR OR ASPHALT PAINTED LINE. THE EDGE OF A CENTERLINE OR LANE LINE SHALL BE OFFSET A MINIMUM DISTANCE OF 2" FROM A LONGITUDINAL CRACK OR JOINT. EDGE LINES SHALL BE APPROXIMATELY 2" FROM THE EDGE LINE OF PAVEMENT. SEE SECTION 780 OF THE STANDARD SPECIFICATIONS FOR TRAFFIC CONTROL ITEMS.
6. THE EXISTING ROAD SIGNS THAT INTERFERE WITH CONSTRUCTION WILL BE REMOVED OR RELOCATED AS DIRECTED BY THE ENGINEER. AFTER THE CONSTRUCTION IS COMPLETED, THE CONTRACTOR WILL REPLACE THE SIGNS AS DIRECTED BY THE ENGINEER. THIS WORK WILL NOT BE PAID SEPARATELY BUT SHALL BE CONSIDERED INCLUDED IN THE CONTRACT, AND NO COMPENSATION WILL BE ALLOWED.
7. THE CONTRACTOR WILL BE REQUIRED TO TO REPAIR ANY AREAS OF TURF THAT ARE DAMAGED DURING THE EXECUTION OF THIS CONTRACT. THIS WORK WILL NOT BE PAID SEPARATELY BUT SHALL BE CONSIDERED INCLUDED IN THE CONTRACT, AND NO COMPENSATION WILL BE ALLOWED.
8. ALL SAW CUTS NECESSARY TO COMPLETE THE WORK DETAILED IN THESE PLANS, SHALL BE INCLUDED IN THE COST FOR THE VARIOUS PAY ITEMS INVOLVED. THE MINIMUM SAW CUT DEPTH SHALL BE 2 1/4" UNLESS OTHERWISE SPECIFIED IN A DETAIL SHOWN IN THE PLANS.
9. THE FOLLOWING RATES OF APPLICATION HAVE BEEN USED TO CALCULATE THE PLAN QUANTITIES:

BITUMINOUS MATERIALS (PRIME COAT)	0.00038 TON/SQ. YD. (ON PAVEMENT)
BITUMINOUS MATERIALS (PRIME COAT)	0.001425 TON/SQ. YD. (ON AGG.)
HOT-MIX ASPHALT SURFACE / BINDER	0.056 TON/SQ. YD. PER 1"
AGGREGATE MATERIAL	2.05 TON/CU. YD.

THE FOLLOWING MIXTURE REQUIREMENTS ARE APPLICABLE FOR THIS PROJECT:

MIXTURE USE(S):	HMA SHLDRS	INCIDENTAL SURFACING	HMA SURFACE COURSE	HMA BASE COURSE WIDENING
AC/PG:	PG 58-22	PG 64-22	PG 64-22	PG 64-22
DESIGN AIR VOIDS:	2.0% @ N 30	4.0% @ N 50	4.0% @ N 50	4.0% @ N 50
MIXTURE COMPOSITION:	BAM	IL 9.5 OR IL 12.5	IL 9.5 OR IL 12.5	IL 19.0
(GRADATION MIXTURE)	NA	MIX "C"	MIX "C"	NA
FRICITION AGREGATE:				

DISTRICT SIX	
EXAMINED <u>DECEMBER 16</u> 20 <u>10</u>	<i>Chris Wall</i>
OPERATIONS ENGINEER	
EXAMINED <u>DEC 14</u> 20 <u>10</u>	<i>Jimmy [Signature]</i>
PROGRAM IMPLEMENTATION ENGINEER	
EXAMINED <u>12/13</u> 20 <u>10</u>	<i>ARM [Signature]</i>
PROGRAM DEVELOPMENT ENGINEER	

ILLINOIS DEPARTMENT OF TRANSPORTATION
SUMMARY OF QUANTITIES

CODE NO.	ITEM	UNIT	TOTAL QUANTITY	90% FEDERAL 10% STATE	RURAL ROADWAY	CONSTRUCTION CODE TYPE	
20200600	EXCAVATING AND GRADING EXISTING SHOULDER	UNIT	373		0021		
40200800	AGGREGATE SURFACE COURSE, TYPE B	TON	29				
40600200	BITUMINOUS MATERIALS (PRIME COAT)	TON	0.15				
40600982	HOT-MIX ASPHALT SURFACE REMOVAL-BUTT JOINT	SQ YD	280				
40603310	HOT-MIX ASPHALT SURFACE COURSE, MIX "C", N50	TON	1732				
40800050	INCIDENTAL HOT-MIX ASPHALT SURFACING	TON	32				
44000200	DRIVEWAY PAVEMENT REMOVAL	SQ YD	86				
44000400	GUTTER REMOVAL	FOOT	559				
44004250	PAVED SHOULDER REMOVAL	SQ YD	6095				
48101200	AGGREGATE SHOULDERS, TYPE B	TON	2096				
48203023	HOT-MIX ASPHALT SHOULDERS, 6 1/2"	SQ YD	433				
60600095	CLASS SI CONCRETE (OUTLET)	CU YD	25.5				
64200105	SHOULDER RUMBLE STRIPS	FOOT	46,180				
67000400	ENGINEER'S FIELD OFFICE, TYPE A	CAL MO	4				
67100100	MOBILIZATION	L SUM	1				
70100460	TRAFFIC CONTROL AND PROTECTION, STANDARD 701306	L SUM	1				
70100500	TRAFFIC CONTROL AND PROTECTION, STANDARD 701326	L SUM	1				
70103815	TRAFFIC CONTROL SURVEILLANCE	CAL DA	6				
* 78001120	PAINT PAVEMENT MARKING-LINE 5"	FOOT	36,586				
X6062700	CONCRETE GUTTER, TYPE A (SPECIAL)	FOOT	439				
35600702	HOT-MIX ASPHALT BASE COURSE WIDENING, 6 1/2"	SQ YD	20181				

*SPECIALTY ITEM

LEGEND

- ① EXIST. PCC PAV'T (9-6-9)
- ② EXIST. PCC PAV'T - 22' WIDTH
- ③ EXIST. PCC WIDENING, 8"
- ④ EXIST. BIT SURF. CSE. MIX D, CLASS I, TYPE 2, (1 1/2")
- ⑤ EXIST. BIT SURF. CSE. & BINDER (± 6 1/2")
- ⑥ EXIST. AGGREGATE SHOULDER, TYPE B
- ⑦ EXIST. AGGREGATE SHOULDER, TYPE A, (6"-8")
- ⑧ EXIST. LEVELING BINDER (MACHINE METHOD) N50 3/4"
- ⑨ EXIST. HOT-MIX ASPHALT SURFACE COURSE CLASS "D", N50 1 1/2"
- ⑩ EXIST. HOT-MIX ASPHALT SHOULDERS, 8 1/4" TO BE REMOVED
- ⑪ EXIST. HOT - MIX ASPHALT SHOULDER, 8
- ⑫ EXIST. HOT - MIX ASPHALT SHOULDER
- ⑬ EXIST. PAVEMENT MARKING - LINE 5"
- ⑭ EXIST. PCC GUTTER
- ⑮ PROP. EXCAVATING AND GRADING EXISTING SHOULDERS
- ⑯ PROP. HOT - MIX ASPHALT SHOULDERS, 6 1/2"
- ⑰ PROP. RUMBLE STRIP
- ⑱ PROP. AGGREGATE SHOULDER (TYPE B)
- ⑲ PROP. PAVEMENT MARKING - LINE 5"
- ⑳ PROP. HOT - MIX ASPHALT SURFACE COURSE, MIX "C", N50
- ㉑ PROP. HOT - MIX ASPHALT BASE COURSE WIDENING, 6 1/2"

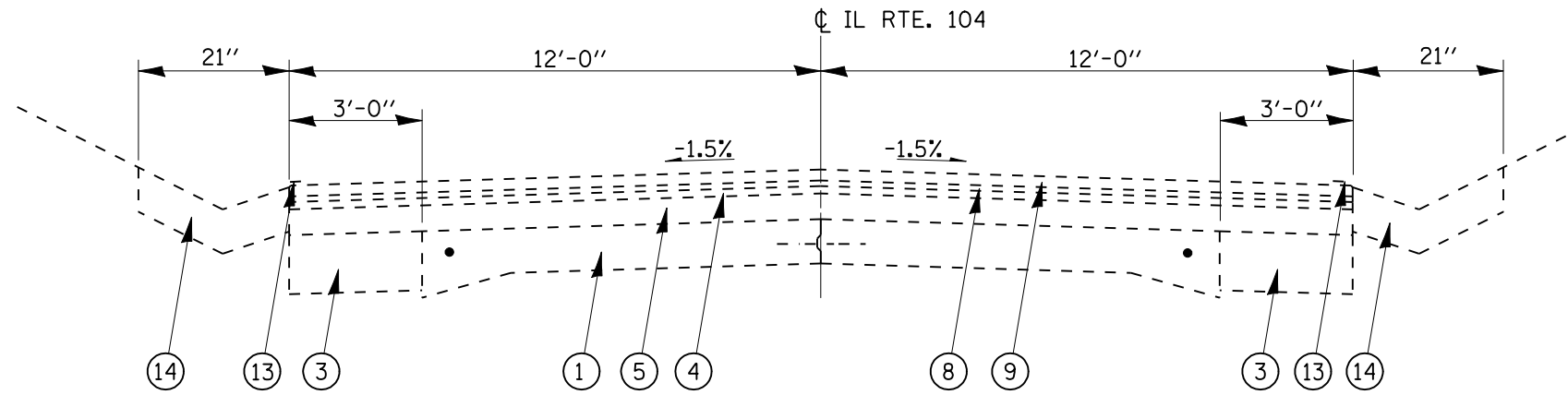

TYPICAL #2

**OMISSION STA 217+43 LT TO STA 225+24 LT
OMISSION STA 217+72 RT TO STA 225+24 RT**

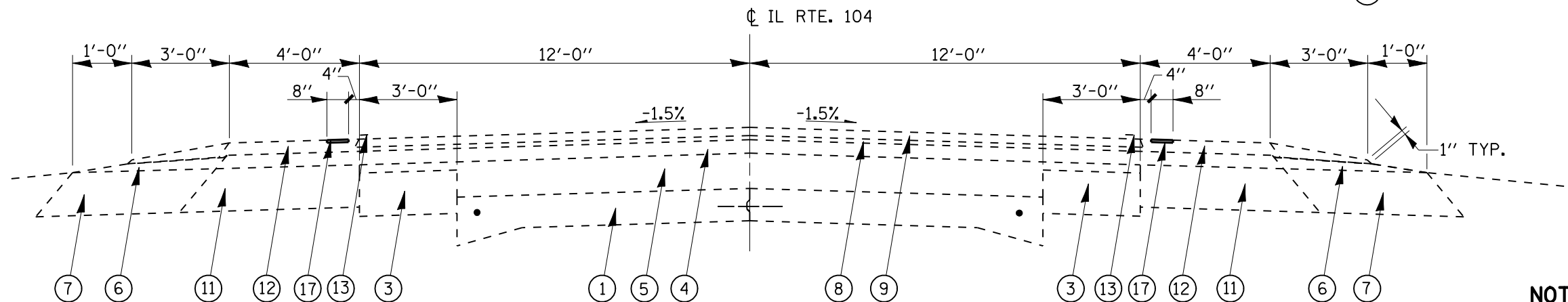

TYPICAL #1

**STA 164+54 TO STA 193+33.46
BRIDGE OMISSION STA 193+33.46 TO STA 197+21.23
STA 197+21.23 RT TO 217+72 RT
STA 197+21.23 LT TO STA 217+43 LT**

NOTES:

- 1 EXISTING SLOPES AND SUPERELEVATION DATA TAKEN FROM EXISTING PLANS.
- 2 IF SUPERELEVATION EXIST THE SHOULDER SLOPES ON THE HIGH SIDE MAXIMUM BREAK - OVER SHOULD BE NO GREATER THAN 8% AND ON THE LOW SIDE SAME AS S.E. IF OVER 4%

FILE NAME =	USER NAME = coxte	DESIGNED -	REVISED -	STATE OF ILLINOIS DEPARTMENT OF TRANSPORTATION	TYPICAL CROSS SECTIONS			F.A.P. RTE.	SECTION	COUNTY	TOTAL SHEETS	SHEET NO.
et:\pw\work\p\dot\coxte\d0230048\0672095-Typicals.dgn		DRAWN -	REVISED -		753	143 RS-6	CHRISTIAN	19	4			
PLOT SCALE = 40.0000' / IN.		CHECKED -	REVISED -		CONTRACT NO. 72D95			ILLINOIS FED. AID PROJECT				
PLOT DATE = Dec-28-2010 02:25:09PM		DATE -	REVISED -		SCALE:	SHEET NO.	OF SHEETS	STA.	TO STA.			

LEGEND

- ① EXIST. PCC PAV'T (9-6-9)
- ② EXIST. PCC PAV'T - 22' WIDTH
- ③ EXIST. PCC WIDENING, 8"
- ④ EXIST. BIT SURF. CSE. MIX D, CLASS I, TYPE 2, (1 1/2")
- ⑤ EXIST. BIT SURF. CSE. & BINDER (± 6 1/2")
- ⑥ EXIST. AGGREGATE SHOULDER, TYPE B
- ⑦ EXIST. AGGREGATE SHOULDER, TYPE A, (6"-8")
- ⑧ EXIST. LEVELING BINDER (MACHINE METHOD) N50 3/4"
- ⑨ EXIST. HOT-MIX ASPHALT SURFACE COURSE CLASS "D", N50 1 1/2"
- ⑩ EXIST. HOT-MIX ASPHALT SHOULDERS, 8 1/4" TO BE REMOVED
- ⑪ EXIST. HOT - MIX ASPHALT SHOULDER, 8
- ⑫ EXIST. HOT - MIX ASPHALT SHOULDER
- ⑬ EXIST. PAVEMENT MARKING - LINE 5"
- ⑭ EXIST. PCC GUTTER
- ⑮ PROP. EXCAVATING AND GRADING EXISTING SHOULDERS
- ⑯ PROP. HOT - MIX ASPHALT SHOULDERS, 6 1/2"
- ⑰ PROP. RUMBLE STRIP
- ⑱ PROP. AGGREGATE SHOULDER (TYPE B)
- ⑲ PROP. PAVEMENT MARKING - LINE 5"
- ⑳ PROP. HOT - MIX ASPHALT SURFACE COURSE, MIX "C", N50
- ㉑ PROP. HOT - MIX ASPHALT BASE COURSE WIDENING, 6 1/2"

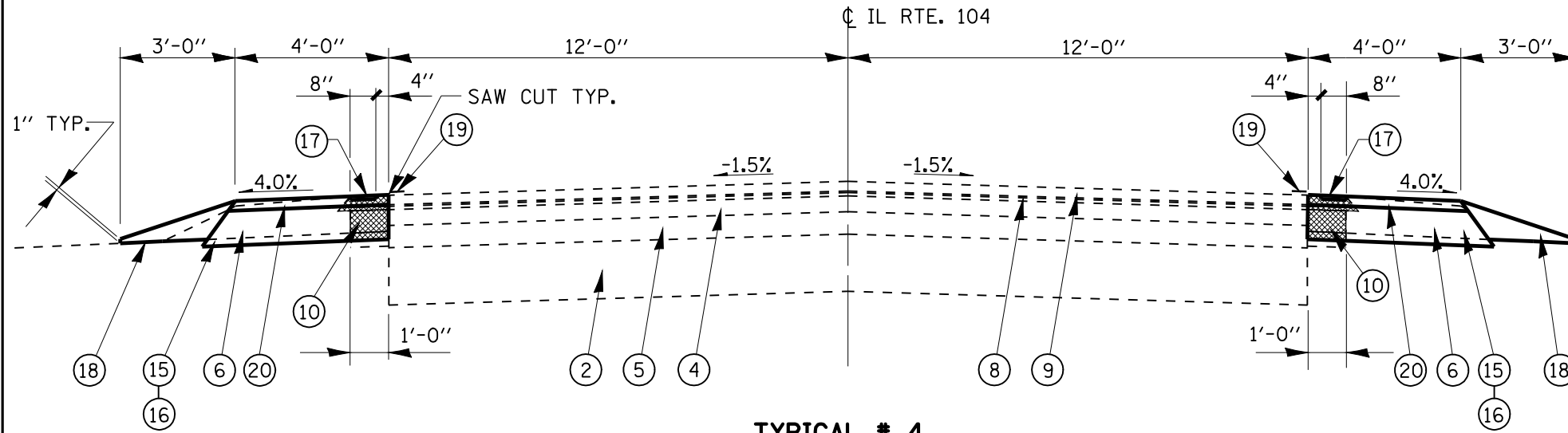

TYPICAL # 4
STA 227+49.00 TO STA 230+11.00

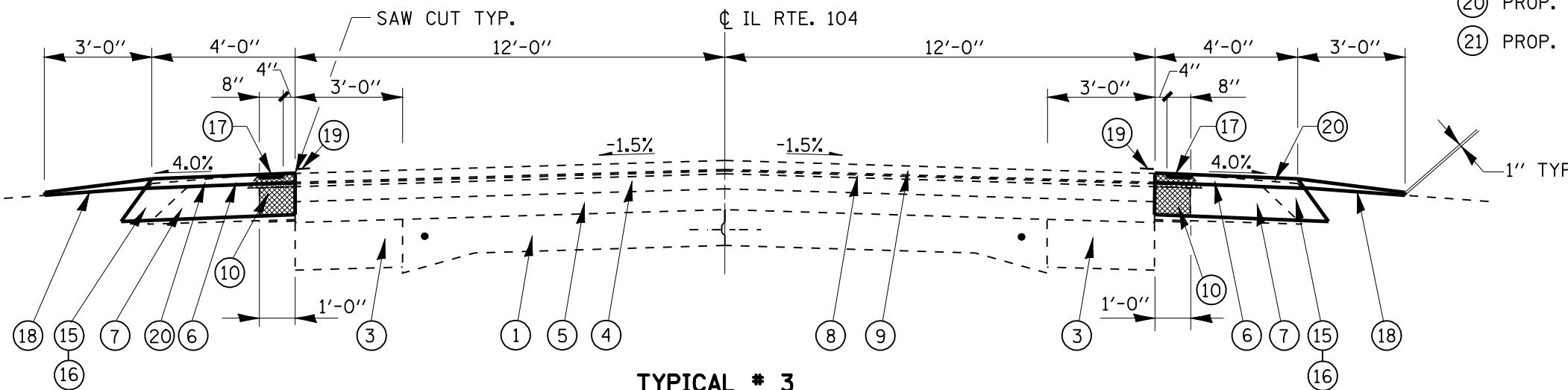

TYPICAL # 3
STA 225+24.00 TO STA 227+49.00

NOTES:

- 1 EXISTING SLOPES AND SUPERELEVATION DATA TAKEN FROM EXISTING PLANS.
- 2 IF SUPERELEVATION EXIST THE SHOULDER SLOPES ON THE HIGH SIDE MAXIMUM BREAK - OVER SHOULD BE NO GREATER THAN 8% AND ON THE LOW SIDE SAME AS S.E. IF OVER 4%

FILE NAME =	USER NAME = coxte	DESIGNED -	REVISED -	STATE OF ILLINOIS DEPARTMENT OF TRANSPORTATION	TYPICAL CROSS SECTIONS	F.A.P. RTE. 753	SECTION 143 RS-6	COUNTY CHRISTIAN	TOTAL SHEETS 19	SHEET NO. 5
et:\pw_work\p\dot\coxte\d0230048\0672095-Typicals.dgn	PLOT SCALE = 40.0000' / IN.	DRAWN -	REVISED -		SCALE:					
PLOT DATE = Dec-28-2010 02:25:11PM		CHECKED -	REVISED -		SHEET NO. OF SHEETS	STA. TO STA.				CONTRACT NO. 72D95
		DATE -	REVISED -							ILLINOIS FED. AID PROJECT

LEGEND

- ① EXIST. PCC PAV'T (9-6-9)
- ② EXIST. PCC PAV'T - 22' WIDTH
- ③ EXIST. PCC WIDENING, 8"
- ④ EXIST. BIT SURF. CSE. MIX D, CLASS I, TYPE 2, (1 1/2")
- ⑤ EXIST. BIT SURF. CSE. & BINDER (± 6 1/2")
- ⑥ EXIST. AGGREGATE SHOULDER, TYPE B
- ⑦ EXIST. AGGREGATE SHOULDER, TYPE A, (6"-8")
- ⑧ EXIST. LEVELING BINDER (MACHINE METHOD) N50 3/4"
- ⑨ EXIST. HOT-MIX ASPHALT SURFACE COURSE CLASS "D", N50 1 1/2"
- ⑩ EXIST. HOT-MIX ASPHALT SHOULDERS, 8 1/4" TO BE REMOVED
- ⑪ EXIST. HOT - MIX ASPHALT SHOULDER, 8
- ⑫ EXIST. HOT - MIX ASPHALT SHOULDER
- ⑬ EXIST. PAVEMENT MARKING - LINE 5"
- ⑭ EXIST. PCC GUTTER
- ⑮ PROP. EXCAVATING AND GRADING EXISTING SHOULDERS
- ⑯ PROP. HOT - MIX ASPHALT SHOULDERS, 6 1/2"
- ⑰ PROP. RUMBLE STRIP
- ⑱ PROP. AGGREGATE SHOULDER (TYPE B)
- ⑲ PROP. PAVEMENT MARKING - LINE 5"
- ⑳ PROP. HOT - MIX ASPHALT SURFACE COURSE, MIX "C", N50
- ㉑ PROP. HOT - MIX ASPHALT BASE COURSE WIDENING, 6 1/2"

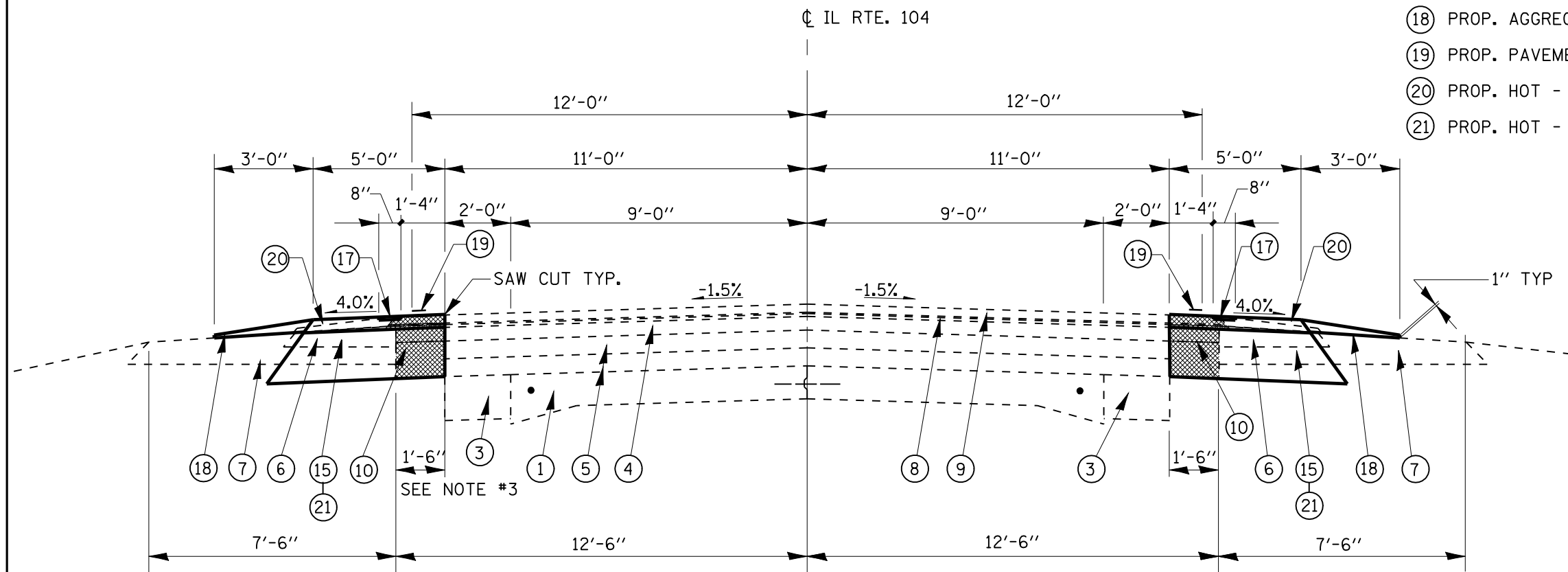

TYPICAL # 5
STA 230+11.00 TO 414+45.00

NOTES:

- 1 EXISTING SLOPES AND SUPERELEVATION DATA TAKEN FROM EXISTING PLANS.
- 2 IF SUPERELEVATION EXIST THE SHOULDER SLOPES ON THE HIGH SIDE MAXIMUM BREAK - OVER SHOULD BE NO GREATER THAN 8% AND ON THE LOW SIDE SAME AS S.E. IF OVER 4%.
3. LIMITS OF EXISTING GUTTER LT. STA. 407+43.00 TO LT. STA. 403+02.00 TO BE REMOVED AND RELOCATED SEE PLAN SHEET #19 FOR DETAILS.

FILE NAME =	USER NAME = coxte	DESIGNED -	REVISED -	STATE OF ILLINOIS DEPARTMENT OF TRANSPORTATION	TYPICAL CROSS SECTIONS				F.A.P RTE.	SECTION	COUNTY	TOTAL SHEETS	SHEET NO.		
		DRAWN -	REVISED -		SCALE:	SHEET NO.	OF	SHEETS	STA.	TO STA.	753	143 I	CHRISTIAN	19	6
		CHECKED -	REVISED -								CONTRACT NO. 72D95				
		DATE -	REVISED -		ILLINOIS FED. AID PROJECT										

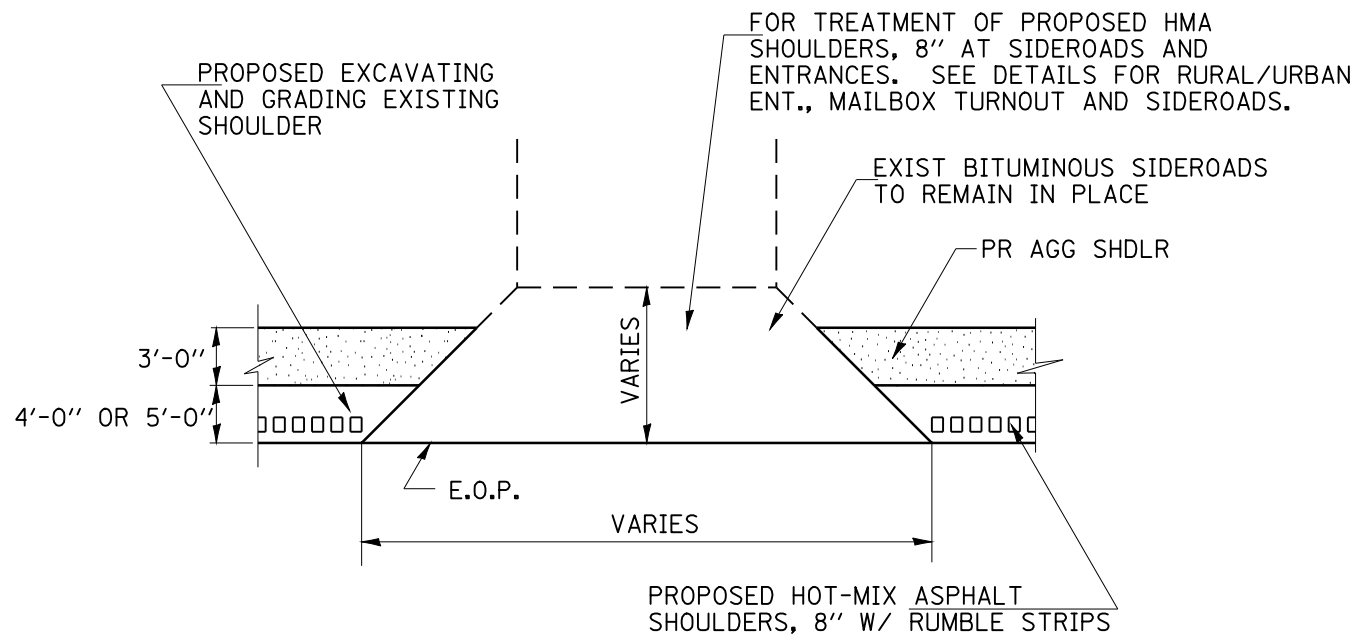

PLAN VIEW
TYPICAL APPLICATION AT INTERSECTION & ENTRANCE

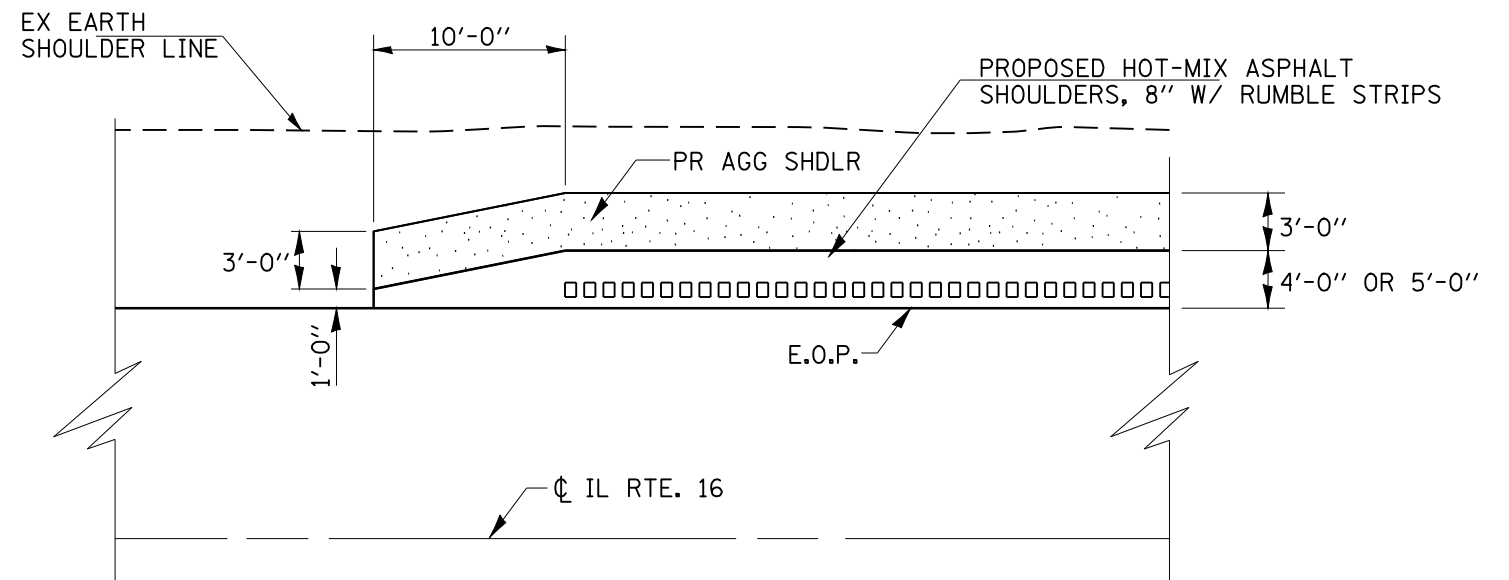

TAPER DETAIL FOR PROPOSED AGGREGATE & HOT-MIX ASPHALT SHOULDERS

(TRANSITION WIDTH FOR PROPOSED HOT-MIX ASPHALT SHOULDERS FROM 1'-0" TO 3'-0" WITHIN 10'-0")

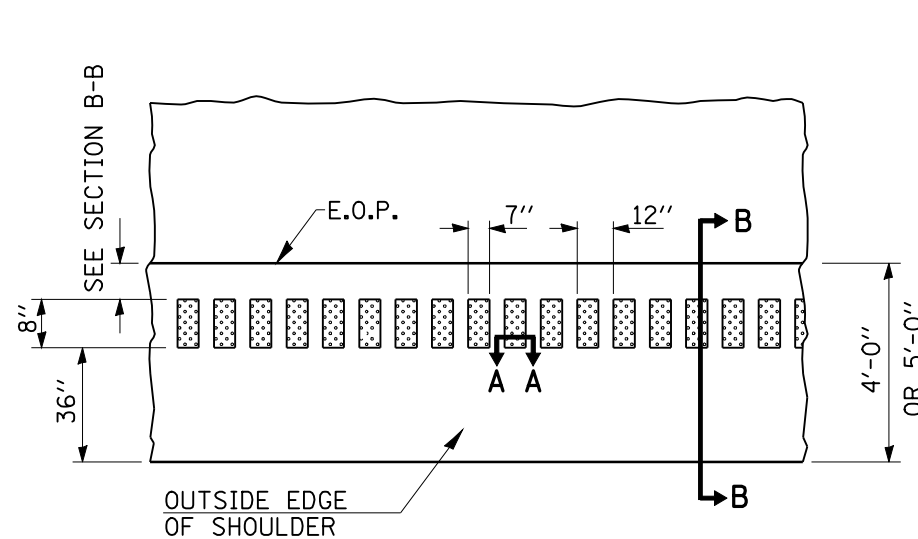

PLAN VIEW

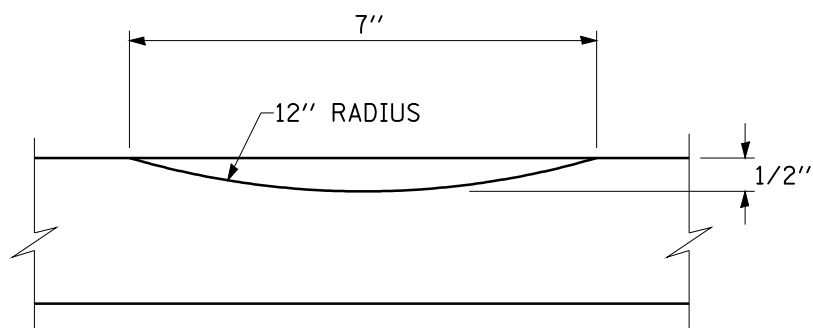

SECTION A-A

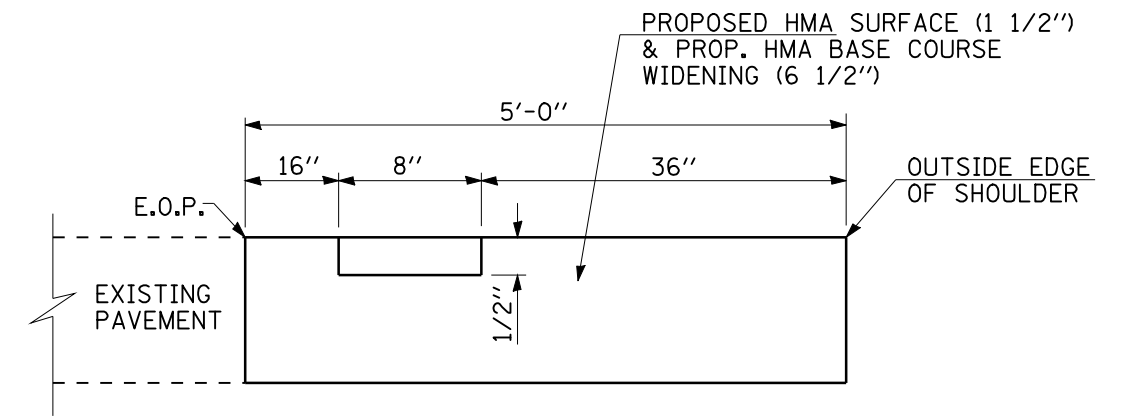

SECTION B-B

STA. 230+11.00 TO STA. 414+45.00

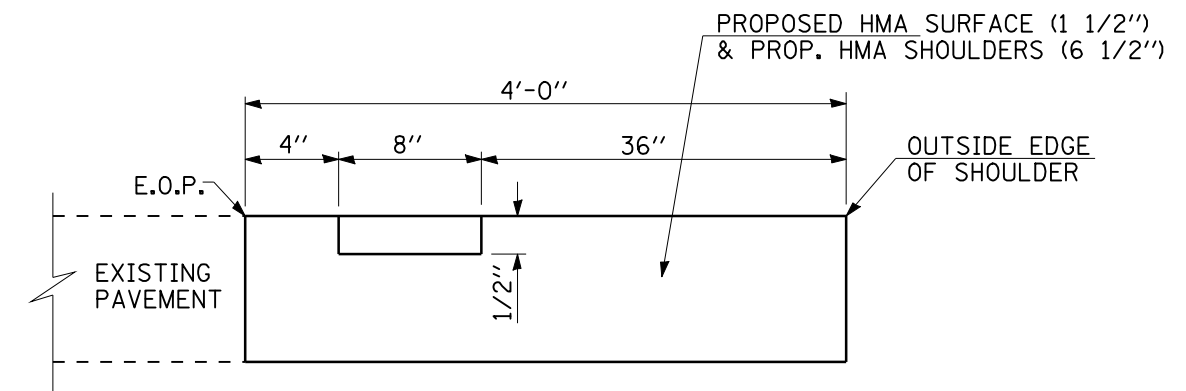

SECTION B-B

STA. 225+24.00 TO STA. 230+11.00

FILE NAME =	USER NAME = coxte	DESIGNED -	REVISED -	STATE OF ILLINOIS DEPARTMENT OF TRANSPORTATION	SHOULDER & RUMBLE STRIP DETAILS			F.A.P. RTE.	SECTION	COUNTY	TOTAL SHEETS	SHEET NO.
ci:\pw_work\p\dot\coxte\d0230048\067205-shd-dtals.dgn		DRAWN -	REVISED -		753	143 I	CHRISTIAN	19	7			
PLOT SCALE = 100.0000' / IN.		CHECKED -	REVISED -		SCALE: SHEET NO. OF SHEETS STA. TO STA.			CONTRACT NO. 72095				
PLOT DATE = Dec-28-2010 02:25:16PM		DATE -	REVISED -		ILLINOIS FED. AID PROJECT							

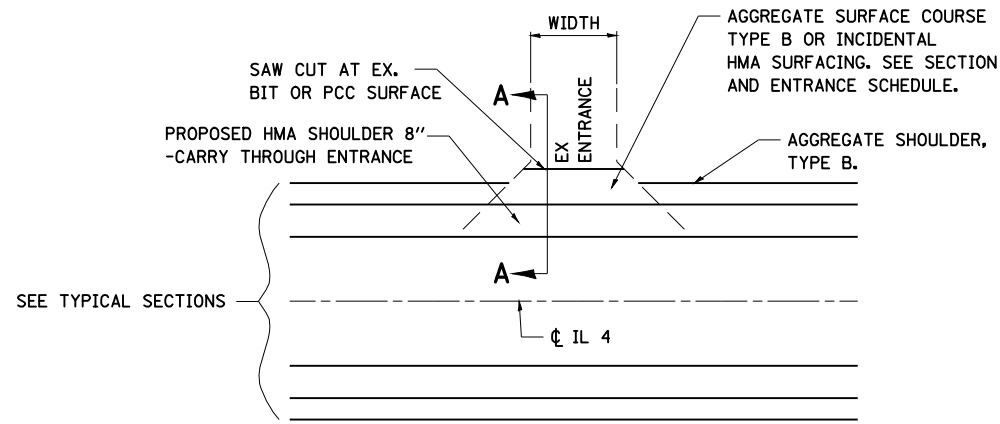

ENTRANCE DETAIL PLAN VIEW

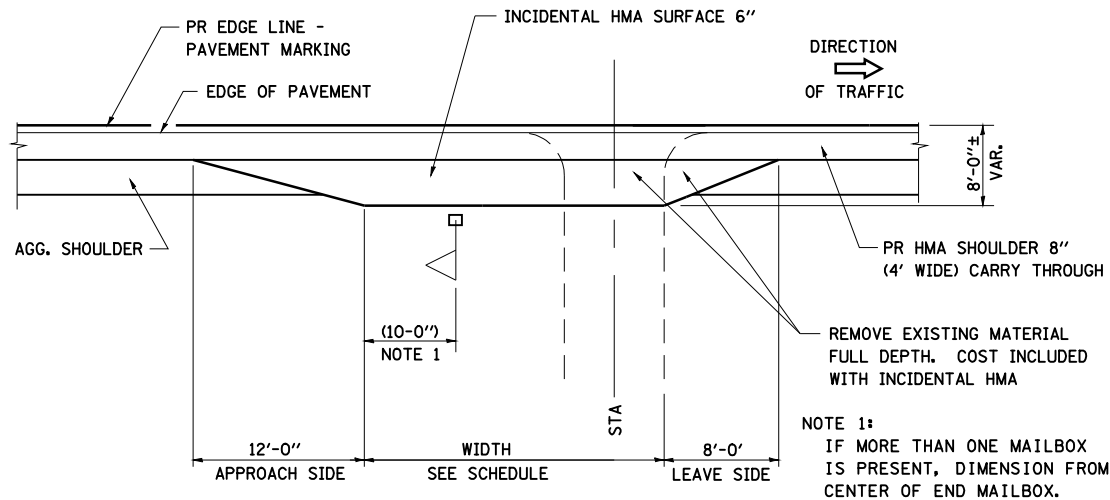

PLAN - MAILBOX TURNOUT (WITH OR WITHOUT ENTRANCE)

GENERAL NOTES:

THE RESIDENT ENGINEER WILL DETERMINE THE EXACT TYPE OF IMPROVEMENT TO BE COMPLETED FOR ALL ENTRANCES, SIDEROADS AND MAILBOX TURNOUTS ON THIS PROJECT.

THE PLAN DETAILS AND SCHEDULES SHOULD BE USED AS A GUIDE FOR THE ENGINEER TO IMPLEMENT THE FINAL DESIGN. THE ENGINEER MAY DECIDE TO SALVAGE PORTIONS OF THE EXISTING ENTRANCE PAVEMENT STRUCTURE; THEREFORE, REDUCING PAY ITEM QUANTITIES. NO ADDITIONAL PAYMENT WILL BE ALLOWED FOR THIS REDUCTION IN QUANTITIES.

ANY WORK THE ENGINEER REQUIRES WHICH IS NOT COVERED BY A PAY ITEM CONTAINED IN THE PLANS WILL BE PAID FOR IN ACCORDANCE WITH ARTICLE 109.04 OF THE STANDARD SPECIFICATIONS.

BITUMINOUS CONCRETE REQUIRED TO CONSTRUCT THE ENTRANCES SHALL BE IN ACCORDANCE WITH THE APPLICABLE PORTIONS OF SECTION 406 AND 408 OF THE STANDARD SPECIFICATIONS AND AS DIRECTED BY THE ENGINEER.

WHEN THE BITUMINOUS CONCRETE PROPOSED FOR THE IMPROVEMENT IS THICKER THAN 75 mm (3 INCHES) AND REQUIRE PLACEMENT IN MORE THAN ONE LIFT. THE BOTTOM LIFT(S) SHALL MEET THE REQUIREMENTS OF BITUMINOUS BASE COURSE IN SECTION 406 OF THE STANDARD SPECIFICATIONS AND THE TOP LIFT OF 50 mm (2 INCHES) SHALL MEET THE REQUIREMENTS OF BITUMINOUS CONCRETE SURFACE COURSE, SUPERPAVE.

THIS WORK WILL BE PAID FOR IN ACCORDANCE WITH SECTIONS 351, 406, 408, AND 440 OF THE STANDARD SPECIFICATIONS.

PREPARATION OF BASE SHALL BE INCLUDED IN THE COST OF INCIDENTAL HMA SURFACE.

ALL DIMENSIONS ARE IN FEET-INCHES UNLESS OTHERWISE SHOWN.

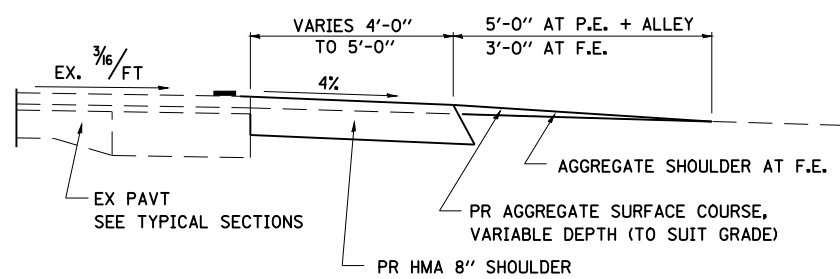

SECTION A-A FOR EX AGGREGATE ENTRANCES

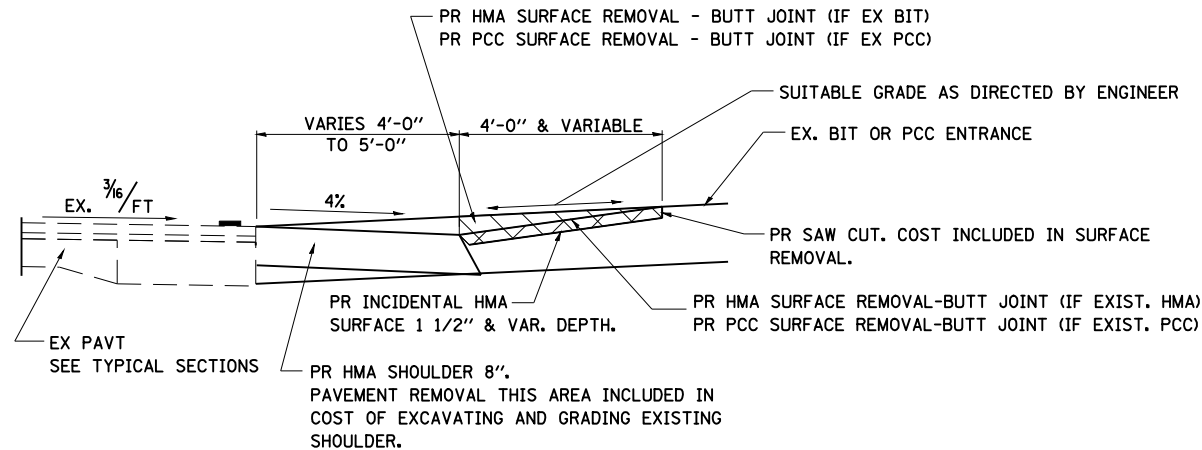

SECTION A-A AT EX BIT OR PCC ENTRANCE

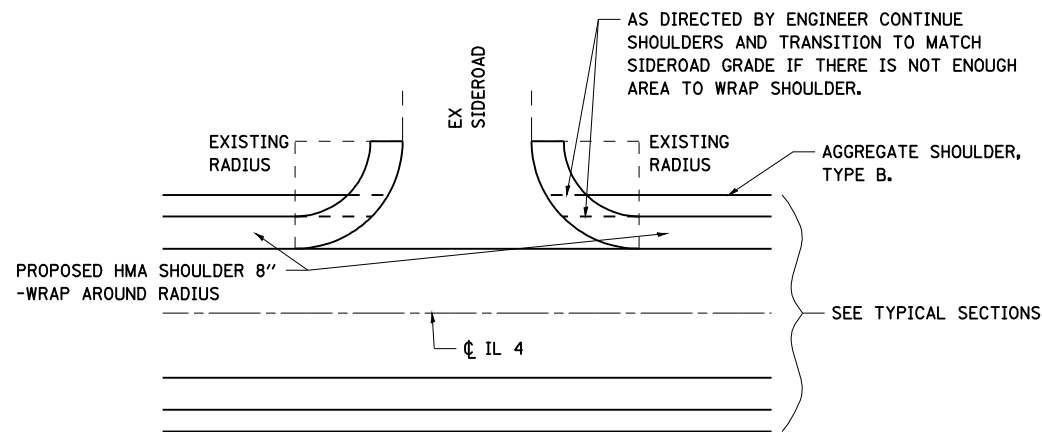

SIDEROAD DETAIL PLAN VIEW

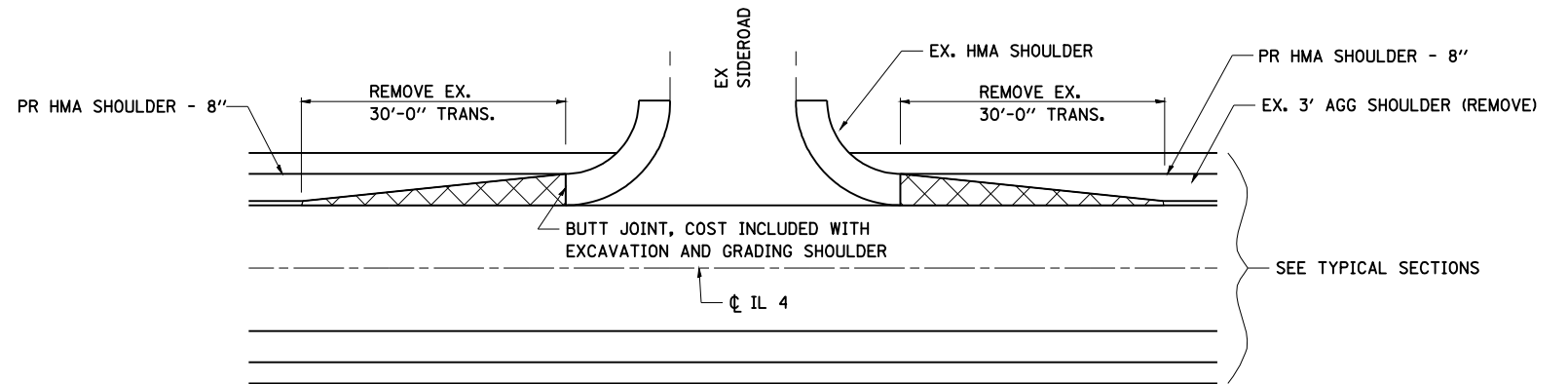

SIDEROADS WITH EXISTING SHOULDER RADII

FILE NAME =	USER NAME = coxte	DESIGNED -	REVISED -	STATE OF ILLINOIS DEPARTMENT OF TRANSPORTATION	DETAILS FOR RURAL/URBAN ENT., MAILBOX TURNOUT & SIDEROADS			F.A.P. RTE.	SECTION	COUNTY	TOTAL SHEETS	SHEET NO.
et:\pw\work\p\dot\coxte\d0230048\067209-shd-details.dgn	PLOT SCALE = 100.0000' / IN.	DRAWN -	REVISED -					753	143 I	CHRISTIAN	19	8
PLOT DATE = Dec-28-2010 02:25:19PM	DATE -	CHECKED -	REVISED -		SCALE: SHEET NO. OF SHEETS STA. TO STA.			CONTRACT NO. 72D95		ILLINOIS FED. AID PROJECT		
		DATE -	REVISED -									

ENTRANCE SCHEDULE								
LOCATION	EXIST. SURF.	WIDTH	WIDTH	LENGTH OF	HOT-MIX ASPH.	INCIDENTAL	BITUMINOUS	AGGREGATE
FAP 753 (IL 104)	TYPE	ACROSS FRONT	ACROSS BACK	IMPROVEMENT FROM EOP	SURF. REMOVAL BUTT-JOINT	HOT-MIX ASPH. SURF.	MATERIAL (PRIME COAT)	SURF. CSE. TYPE B
		(FT)	(FT)	(FT)	(SQ YD)	(TON)	(TON)	(TON)
CE LT. STA. 227+40.00	HMA / AGG	32	23	6	18.3	2.1	0.01	2.3
PE LT. STA. 231+00.00	HMA / AGG	71	63	4	29.8	3.5	0.01	6.0
PE LT. STA. 236+40.00	HMA	38	26	4	14.4	1.7	0.01	2.5
PE W/MBT RT. STA. 312+50.00	HMA / AGG	67	42	4	24.4	2.8	0.01	4.0
PE RT. STA. 319+80.00	HMA	27	15	4	9.4	1.1	0.01	1.5
PE W/MBT RT. STA. 320+30.00	HMA	56	16	11	44.0	5.0	0.02	1.5
PE RT. STA. 321+40.00	HMA	23	9	11	19.6	2.2	0.01	1.0
PE W/MBT RT. STA. 322+30.00	HMA / AGG	48	17	11	39.8	4.5	0.02	1.7
PE LT. STA. 332+00.00	HMA	26	21	11	28.8	3.3	0.01	2.0
PE RT. STA. 333+30.00	HMA / AGG	26	21	11	28.8	3.3	0.01	2.0
PE LT. STA. 385+30.00	BIT / AGG	32	26	4	12.9	1.5	0.01	2.5
PE LT. STA. 386+10.00	BIT / AGG	25	19	4	9.8	1.1	0.01	2.0
TOTAL					280.0	32.0	0.15	29.0

SHOULDER RUMBLE STRIP SCHEDULE					
LOCATION		SHOULDERS	TOTAL LENGTH (FT)	LENGTH (FT)	
STATION TO STATION					
FAP 753 (IL 104)					
LT. STA. 164+54.00	TO LT. STA. 193+33.46	EXIST.	2,879.5	2,823.5	
RT. STA. 164+54.00	TO RT. STA. 193+33.46	EXIST.	2,879.5	2,879.5	
BRIDGE OMISSION STA. 193+33.46 TO STA. 197+21.23					
LT. STA. 197+21.23	TO LT. STA. 217+43.00	EXIST.	2,022.0	1,959.0	
RT. STA. 197+21.23	TO RT. STA. 217+72.00	EXIST.	2,051.0	2,004.0	
OMISSION LT. STA. 217+43.00 TO LT. STA. 225+24.00					
OMISSION RT. STA. 217+72.00 TO RT. STA. 225+24.00					
LT. STA. 225+24.00	TO LT. STA. 227+49.00	PROP.	225.0	194.0	
RT. STA. 225+24.00	TO RT. STA. 227+49.00	PROP.	225.0	225.0	
LT. STA. 227+49.00	TO LT. STA. 230+11.00	PROP.	262.0	262.0	
RT. STA. 227+49.00	TO RT. STA. 230+11.00	PROP.	262.0	262.0	
LT. STA. 230+11.00	TO LT. STA. 413+02.00	PROP.	18,291.0	17,737.0	
LT. STA. 413+02.00	TO LT. STA. 414+45.00	PROP.	143.0	143.0	
RT. STA. 230+11.00	TO RT. STA. 414+45.00	PROP.	18,434.0	17,691.0	
TOTAL			47,674.0	46,180.0	

AGGREGATE SHOULDERS, TYPE B SCHEDULE				
LOCATION	AGGREGATE SHOULDERS, WIDTH (FT)	TOTAL LENGTH (FT)	LENGTH (FT)	AGGREGATE SHOULDERS, TYPE B (TON)
STATION TO STATION				
FAP 753 (IL 104)				
LT. STA. 225+24.00	TO LT. STA. 227+49.00	3	225	225.0
RT. STA. 225+24.00	TO RT. STA. 227+49.00	3	225	225.0
LT. STA. 227+49.00	TO LT. STA. 230+11.00	3	262	262.0
RT. STA. 227+49.00	TO RT. STA. 230+11.00	3	262	262.0
LT. STA. 230+11.00	TO LT. STA. 408+00.00	3	17,789.0	17,600.0
LT. STA. 413+02.00	TO LT. STA. 414+45.00	3	143.0	143.0
RT. STA. 230+11.00	TO RT. STA. 414+45.00	3	18,434.0	18,080.0
TOTAL		37,340.0	36,797.0	2,096.0

FILE NAME =	USER NAME = coxte	DESIGNED -	REVISED -	STATE OF ILLINOIS DEPARTMENT OF TRANSPORTATION	SCHEDULE OF QUANTITIES					F.A.P. RTE.	SECTION	COUNTY	TOTAL SHEETS	SHEET NO.
et:\pw\work\p1dot\coxte\d0230048\067205-sht-schedule.dgn	PLOT SCALE = 40.0000 ' / IN.	DRAWN -	REVISED -							753	143 I	CHRISTIAN	19	9
	PLOT DATE = Dec-28-2010 02:25:22PM	CHECKED -	REVISED -		SCALE:	SHEET NO.	OF SHEETS	STA.	TO STA.	CONTRACT NO. 72D95				
		DATE -	REVISED -							ILLINOIS FED. AID PROJECT				

HOT-MIX ASPHALT SHOULDERS SCHEDULE

LOCATION STATION TO STATION	PROP. BIT. SHOULDERS WIDTH (FT)	TOTAL LENGTH (FT)	LENGTH (FT)	HMA SHOULDERS, 6 1/2" (SQ YD)	HMA BASE COURSE WIDENING, 6 1/2" (SQ YD)	HMA SURF. CSE., MIX "C", N50 (TON)
FAP 753 (IL 104)						
LT.STA. 225+24.00 TO LT.STA. 227+49.00	4	225	225.0	100.0		8.5
RT.STA. 225+24.00 TO RT.STA. 227+49.00	4	225	225.0	100.0		8.5
LT.STA. 227+49.00 TO LT.STA. 230+11.00	4	262	262.0	116.5		9.9
RT.STA. 227+49.00 TO RT.STA. 230+11.00	4	262	262.0	116.5		9.9
LT.STA. 230+11.00 TO LT.STA. 408+00.00	5	17,789	17,600.0		9778.0	821.4
LT.STA. 408+00.00 TO LT.STA. 414+45.00	5	645	645.0		358.5	30.1
RT.STA. 230+11.00 TO RT.STA. 414+45.00	5	18,434	18,080.0		10044.5	843.7
TOTAL		37,842.0	37,299.0	433.0	20181.0	1732.0

PAINT PAVEMENT MARKING LINE - 5" SCHEDULE

LOCATION STATION TO STATION	LOCATION	TOTAL LENGTH (FT)	LINE 5" (FT)
FAP 753 (IL 104)			
LT.STA. 225+24.00 TO LT.STA. 227+49.00	EDGE LINE	225.0	194.0
RT.STA. 225+24.00 TO RT.STA. 227+49.00	EDGE LINE	225.0	225.0
LT.STA. 227+49.00 TO LT.STA. 230+11.00	EDGE LINE	262.0	262.0
RT.STA. 227+49.00 TO RT.STA. 230+11.00	EDGE LINE	262.0	262.0
LT.STA. 230+11.00 TO LT.STA. 414+45.00	EDGE LINE	18,434.0	17,952.0
RT.STA. 230+11.00 TO RT.STA. 414+45.00	EDGE LINE	18,434.0	17,691.0
TOTAL		37,842.0	36,586.0

EXCAVATING AND GRADING EXISTING SHOULDER SCHEDULE

LOCATION STATION TO STATION	TOTAL LENGTH (FT)	LENGTH (FT)	LENGTH (UNIT)
FAP 753 (IL 104)			
LT.STA. 225+24.00 TO LT.STA. 227+49.00	225.0	225.0	2.3
RT.STA. 225+24.00 TO RT.STA. 227+49.00	225.0	225.0	2.3
LT.STA. 227+49.00 TO LT.STA. 230+11.00	262.0	262.0	2.6
RT.STA. 227+49.00 TO RT.STA. 230+11.00	262.0	262.0	2.6
LT.STA. 230+11.00 TO LT.STA. 408+00.00	17,789.0	17,600.0	176.0
LT.STA. 408+00.00 TO LT.STA. 414+45.00	645.0	143.0	6.4
RT.STA. 230+11.00 TO RT.STA. 414+45.00	18,434.0	18,080.0	180.8
TOTAL	37,842.00	36,797.0	373.0

PAVED SHOULDER REMOVAL

LOCATION STATION TO STATION	PROP. BIT. SHOULDERS WIDTH (FT)	TOTAL LENGTH (FT)	LENGTH (FT)	PAVED SHOULDER REMOVAL (SQ YD)
FAP 753 (IL 104)				
LT.STA. 225+24.00 TO LT.STA. 227+49.00	1	225	199.0	22.3
RT.STA. 225+24.00 TO RT.STA. 227+49.00	1	225	225.0	25.0
LT.STA. 227+49.00 TO LT.STA. 230+11.00	1	262	262.0	29.3
RT.STA. 227+49.00 TO RT.STA. 230+11.00	1	262	262.0	29.3
LT.STA. 230+11.00 TO LT.STA. 400+43.00	1.5	17,032	16,574.0	2762.3
LT.STA. 400+43.00 TO LT.STA. 404+77.00	3	434	434.0	144.7
LT.STA. 404+77.00 TO LT.STA. 408+00.00	1.5	323	323.0	53.8
LT.STA. 413+02.00 TO LT.STA. 414+45.00	1.5	143	143.0	23.8
RT.STA. 230+11.00 TO RT.STA. 400+49.00	1.5	17,038	16,328.0	2721.4
RT.STA. 400+49.00 TO RT.STA. 405+02.00	2.5	453	453.0	125.8
RT.STA. 405+02.00 TO RT.STA. 414+45.00	1.5	943	943.0	157.3
TOTAL		37,340.0	36,146.0	6,095.0

EXIST. CURVE 102
 PI STA. = 178+57.42
 $\Delta = 14^\circ 45' 07''$ (LT)
 D = $2^\circ 11' 15''$
 R = 2,619.25'
 T = 339.07'
 L = 674.38'
 E = 21.86'
 e = -----
 T.R. = -----
 S.E. RUN = -----
 P.C. STA. = 175+18.36
 P.T. STA. = 181+92.74

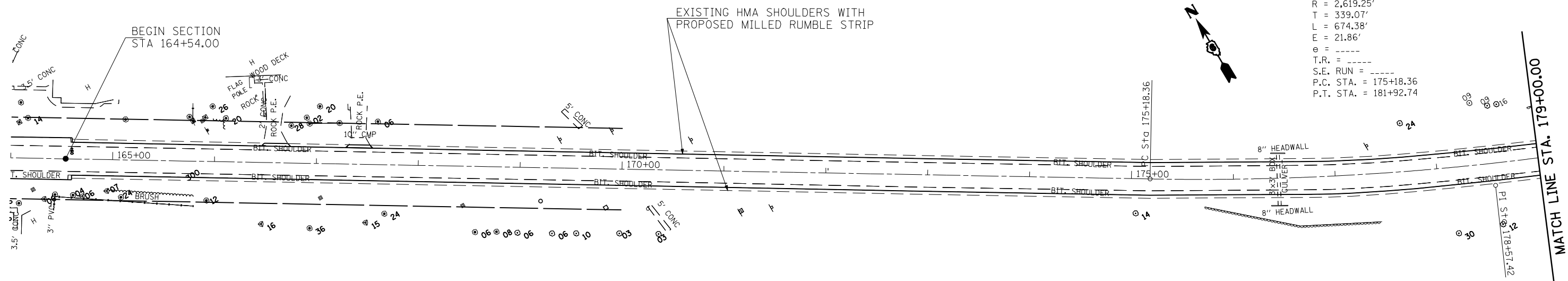

EXIST. CURVE 104
 PI STA. = 189+47.52
 $\Delta = 1^\circ 55' 21''$ (RT)
 D = $0^\circ 19' 23''$
 R = 17,735.24'
 T = 297.57'
 L = 595.09'
 E = 2.50'
 e = -----
 T.R. = -----
 S.E. RUN = -----
 P.C. STA. = 186+49.95
 P.T. STA. = 192+45.04

EXIST. CURVE 103
 PI STA. = 184+22.35
 $\Delta = 13^\circ 08' 04''$ (LT)
 D = $2^\circ 52' 22''$
 R = 1,994.49'
 T = 229.61'
 L = 457.21'
 E = 13.17'
 e = -----
 T.R. = -----
 S.E. RUN = -----
 P.C. STA. = 181+92.74
 P.T. STA. = 186+49.95

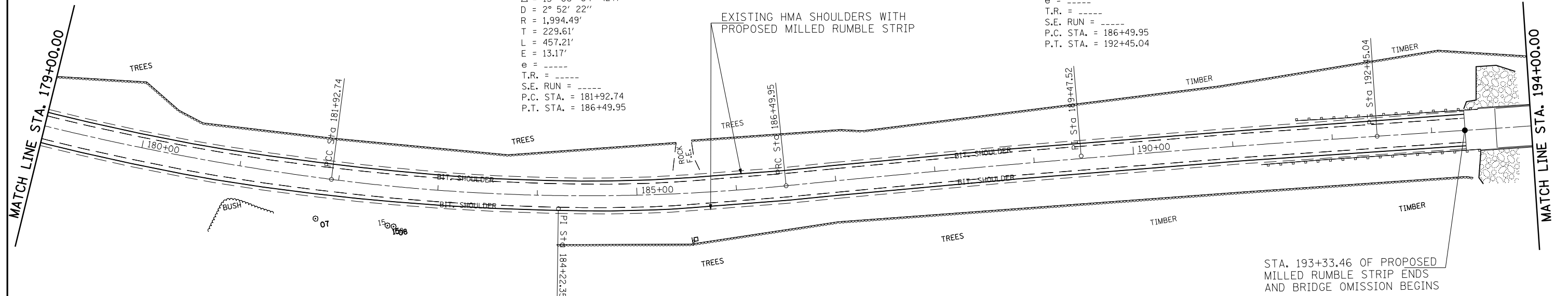

FILE NAME =	USER NAME = coxte	DESIGNED -	REVISED -	STATE OF ILLINOIS DEPARTMENT OF TRANSPORTATION	PLAN			F.A.P. RTE.	SECTION	COUNTY	TOTAL SHEETS	SHEET NO.
ei:\pw\work\p1\dot\coxte\d0230048\0672095-sh1-plan2.dgn		DRAWN -	REVISED -		753	143 I	CHRISTIAN	19	11			
PLOT SCALE = 100.0000' / IN.		CHECKED -	REVISED -		CONTRACT NO. 72D95							
PLOT DATE = Dec-28-2010 02:25:58PM		DATE -	REVISED -		ILLINOIS FED. AID PROJECT							
				SCALE:	SHEET NO.	OF SHEETS	STA.	TO STA.				

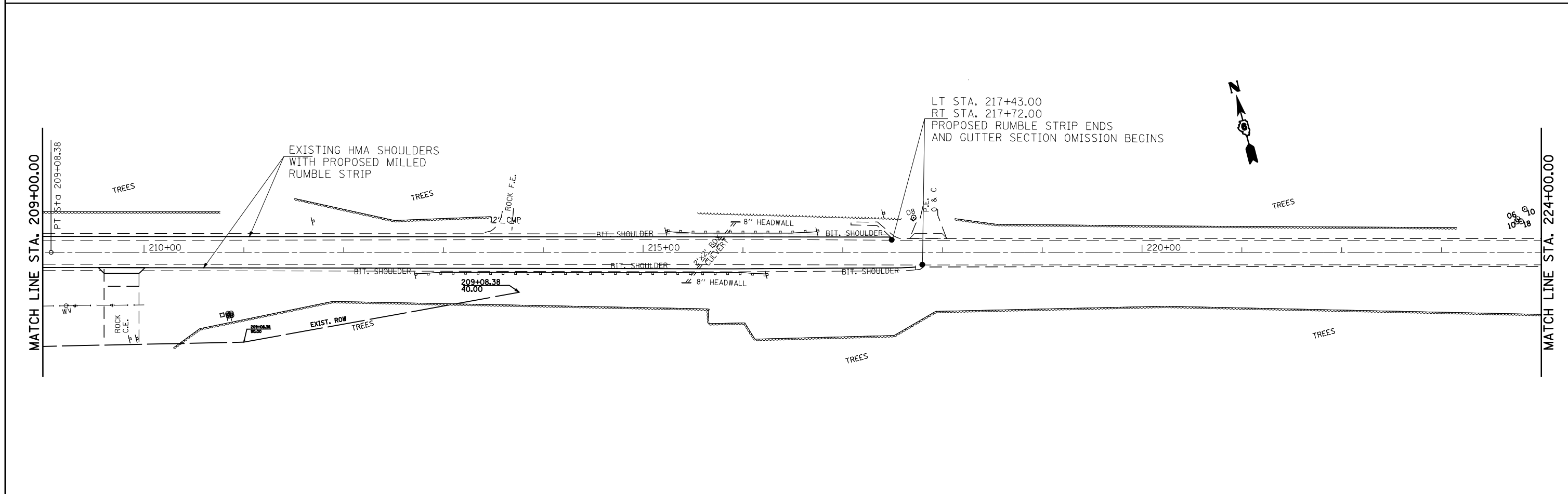
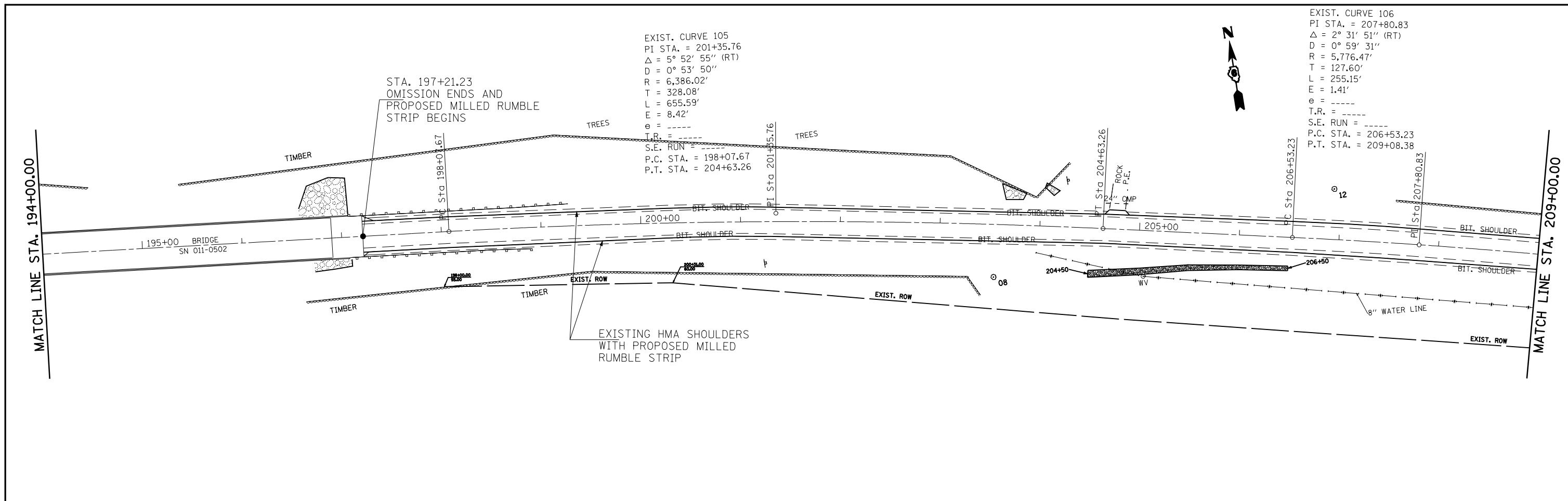

FILE NAME =	USER NAME = coxte	DESIGNED -	REVISED -	STATE OF ILLINOIS DEPARTMENT OF TRANSPORTATION	PLAN			F.A.P. RTE.	SECTION	COUNTY	TOTAL SHEETS	SHEET NO.
et:\pw\work\p\dot\coxte\d0230048\067209-shr-plan2.dgn		DRAWN -	REVISED -		753	143 I	CHRISTIAN	19	12			
PLOT SCALE = 100.0000' / IN.		CHECKED -	REVISED -		CONTRACT NO. 72D95							
PLOT DATE = Dec-28-2010 02:26:05PM		DATE -	REVISED -		ILLINOIS FED. AID PROJECT							

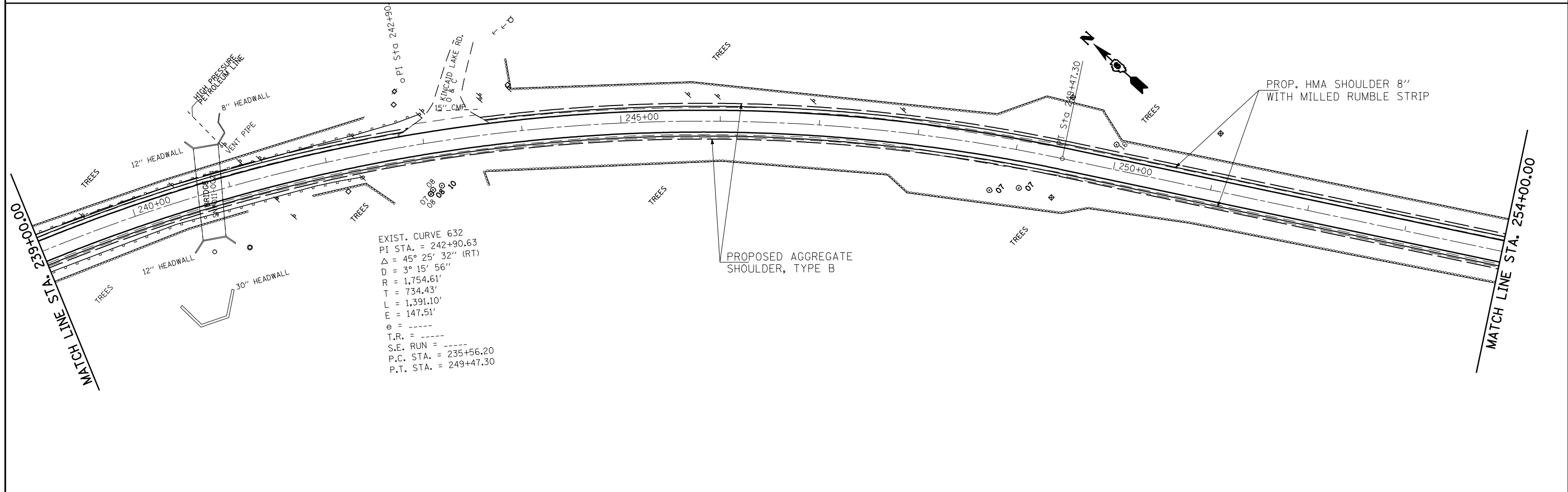
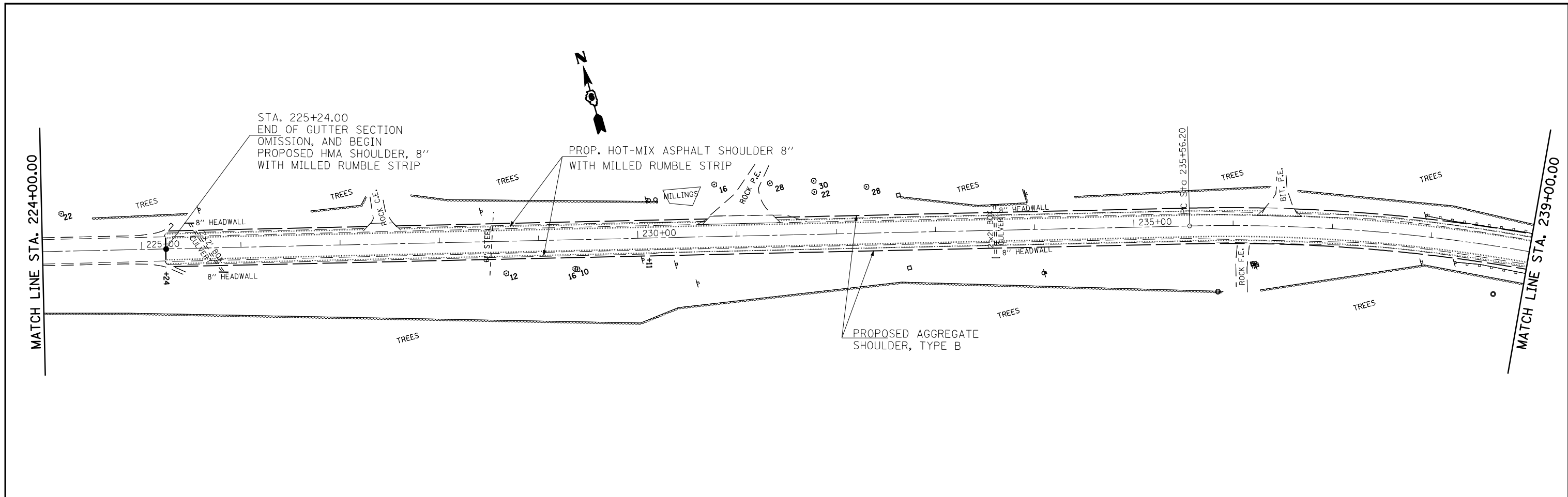

EXIST. CURVE 632
 PI STA. = 242+90.63
 $\Delta = 45^\circ 25' 32''$ (RT)
 $D = 3^\circ 15' 56''$
 $R = 1,754.61'$
 $T = 734.43'$
 $L = 1,391.10'$
 $E = 147.51'$
 $\theta = \text{---}$
 $T.R. = \text{---}$
 $S.E. \text{ RUN} = \text{---}$
 $P.C. \text{ STA.} = 235+56.20$
 $P.T. \text{ STA.} = 249+47.30$

FILE NAME =	USER NAME = coxte	DESIGNED -	REVISED -
et:\pw\work\p1dot\coxte\d0230048\067205-sh1-plan2.dgn		DRAWN -	REVISED -
PLOT SCALE = 100.0000' / IN.		CHECKED -	REVISED -
PLOT DATE = Dec-28-2010 02:26:11PM		DATE -	REVISED -

STATE OF ILLINOIS
DEPARTMENT OF TRANSPORTATION

PLAN				
SCALE:	SHEET NO.	OF	SHEETS	STA. TO STA.

F.A.P. RTE.	SECTION	COUNTY	TOTAL SHEETS	SHEET NO.
753	143 I	CHRISTIAN	19	13
CONTRACT NO. 72D95			ILLINOIS FED. AID PROJECT	

EXIST. CURVE 107
 PI STA. = 268+97.01
 $\Delta = 33^\circ 06' 46''$ (LT)
 $D = 3^\circ 00' 37''$
 $R = 1,903.36'$
 $T = 565.84'$
 $L = 1,100.00'$
 $E = 82.33'$
 $e = \text{-----}$
 T.R. = -----
 S.E. RUN = -----
 P.C. STA. = 263+31.17
 P.T. STA. = 274+31.17

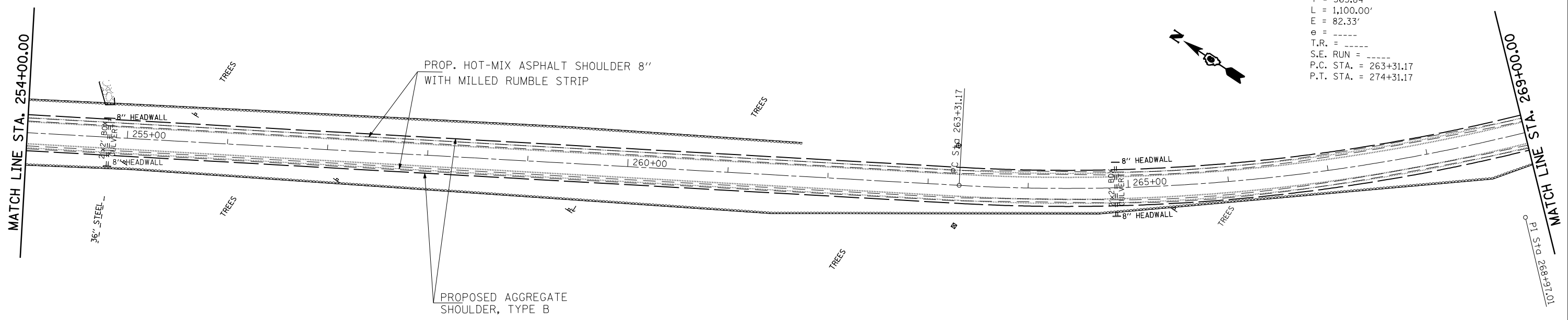

EXIST. CURVE 108
 PI STA. = 283+39.39
 $\Delta = 27^\circ 38' 46''$ (LT)
 $D = 2^\circ 59' 32''$
 $R = 1,914.77'$
 $T = 471.13'$
 $L = 923.90'$
 $E = 57.11'$
 $e = \text{-----}$
 T.R. = -----
 S.E. RUN = -----
 P.C. STA. = 278+68.27
 P.T. STA. = 287+92.17

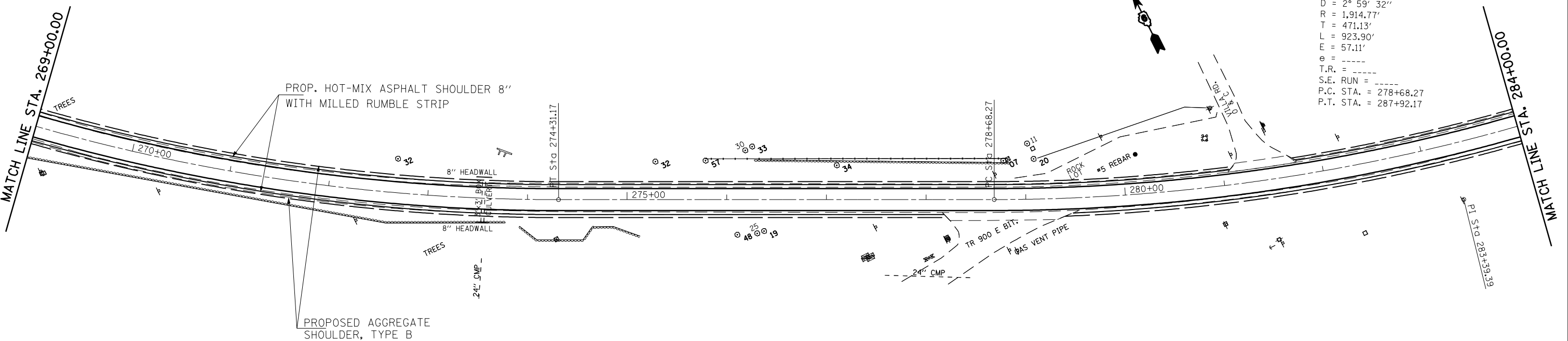

FILE NAME =	USER NAME = coxte	DESIGNED -	REVISED -	STATE OF ILLINOIS DEPARTMENT OF TRANSPORTATION	PLAN			F.A.P. RTE.	SECTION	COUNTY	TOTAL SHEETS	SHEET NO.
ei:\pw\work\p\dot\coxte\d0230048\067205-sh1-plan2.dgn		DRAWN -	REVISED -		753	143 I	CHRISTIAN	19	14			
PLOT SCALE = 100.0000' / IN.		CHECKED -	REVISED -		CONTRACT NO. 72D95							
PLOT DATE = Dec-28-2010 02:26:18PM		DATE -	REVISED -		ILLINOIS FED. AID PROJECT							
				SCALE:	SHEET NO.	OF	SHEETS	STA.	TO STA.			

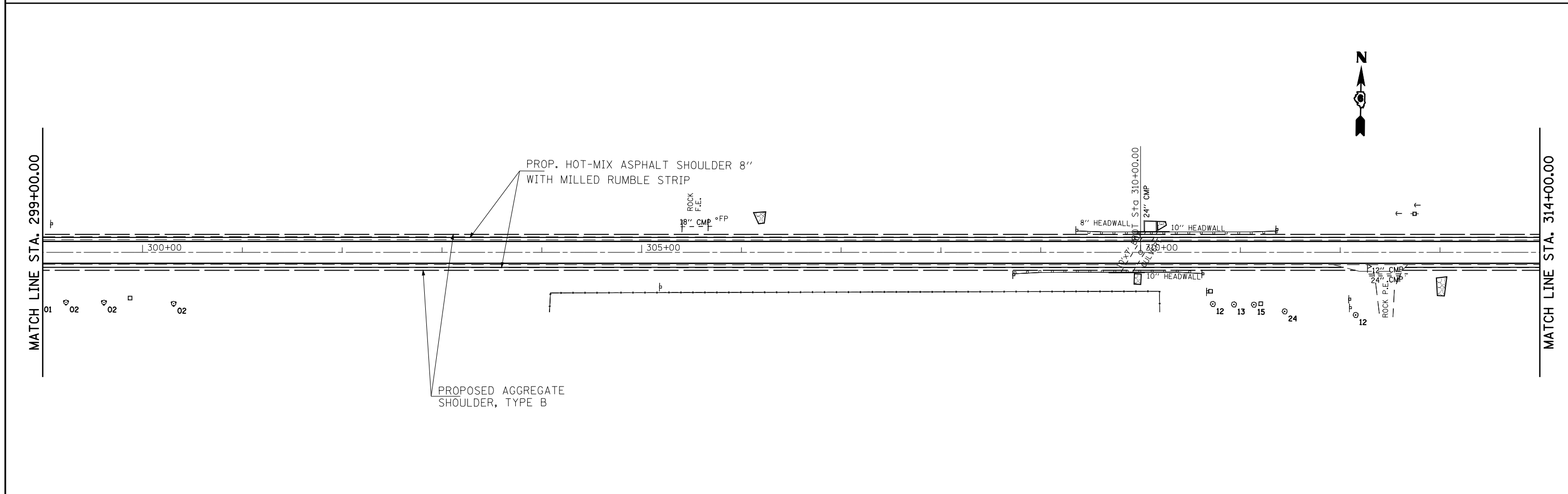
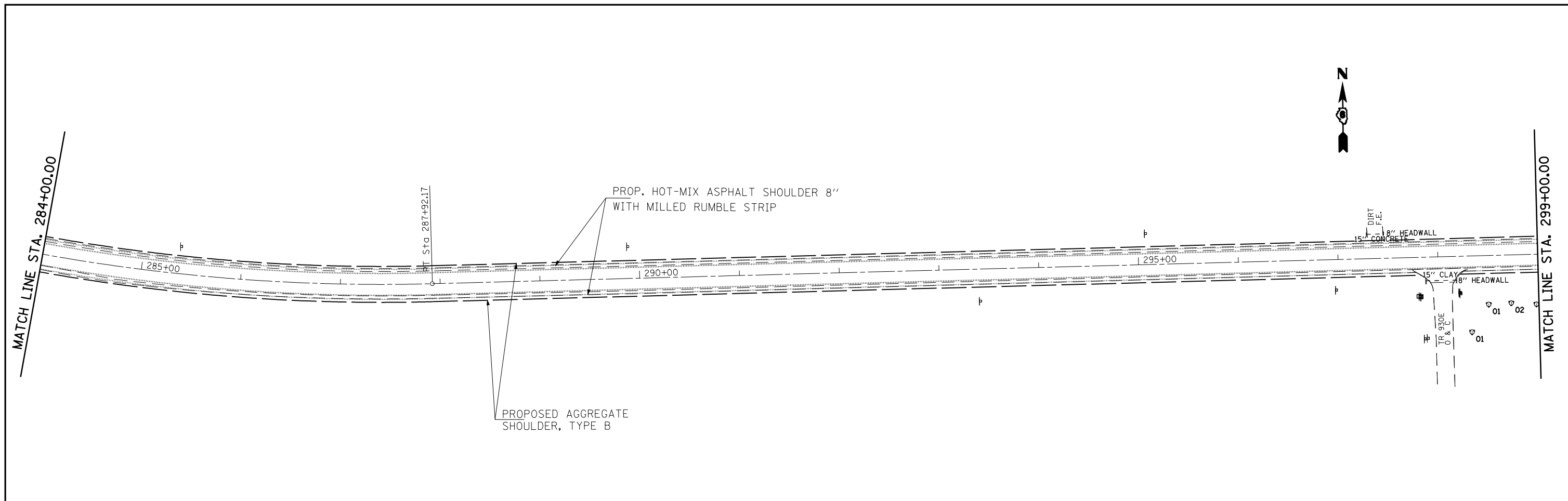

FILE NAME =	USER NAME = coxte	DESIGNED -	REVISED -	STATE OF ILLINOIS DEPARTMENT OF TRANSPORTATION	PLAN			F.A.P. RTE.	SECTION	COUNTY	TOTAL SHEETS	SHEET NO.			
ei:\pw\work\p\dot\coxte\d0230048\D67205-sh1-plan2.dgn		DRAWN -	REVISED -		SCALE:	SHEET NO.	OF	SHEETS	STA.	TO STA.	753	143 I	CHRISTIAN	19	15
	PLOT SCALE = 100.0000' / IN.	CHECKED -	REVISED -										CONTRACT NO. 72D95		
	PLOT DATE = Dec-28-2010 02:26:25PM	DATE -	REVISED -										ILLINOIS FED. AID PROJECT		

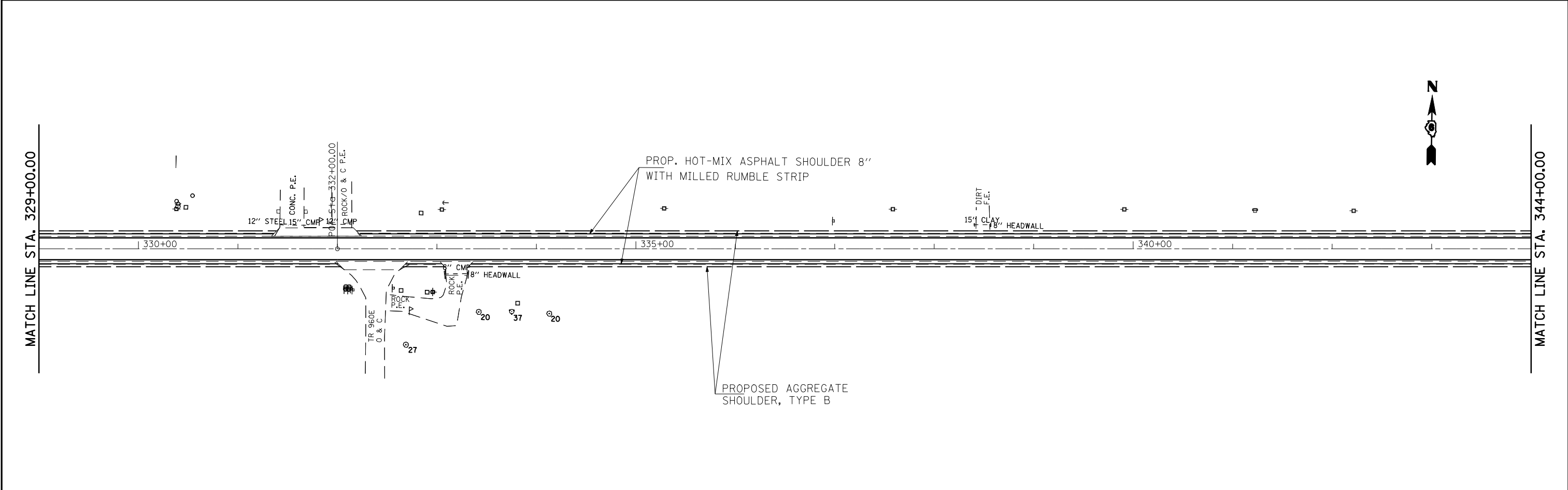
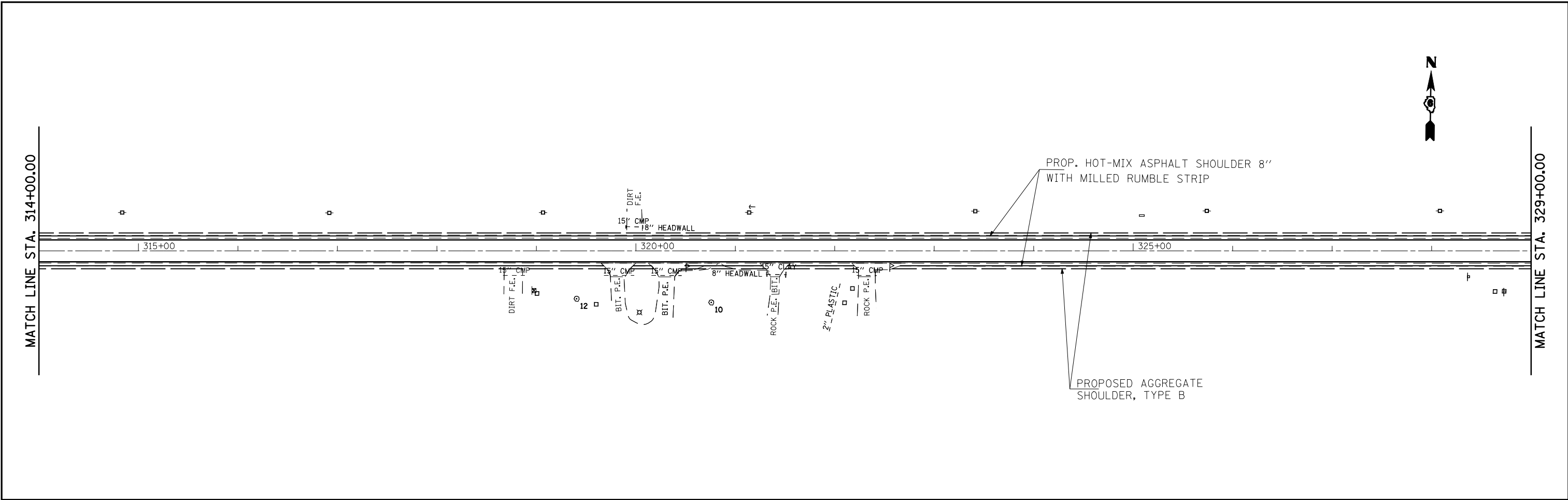

FILE NAME = c:\pwwork\pwwork\coaxte\d0230048\067205-sh1-plan2.dgn	USER NAME = coaxte	DESIGNED -	REVISED -	STATE OF ILLINOIS DEPARTMENT OF TRANSPORTATION	PLAN			F.A.P. RTE.	SECTION	COUNTY	TOTAL SHEETS	SHEET NO.
	PLOT SCALE = 100.0000' / IN.	CHECKED -	REVISED -					753	143 I	CHRISTIAN	19	16
PLOT DATE = Dec-28-2010 02:26:31PM	DATE -	REVISED -	REVISED -		SCALE:	SHEET NO.	OF SHEETS	STA.	TO STA.	ILLINOIS FED. AID PROJECT		
CONTRACT NO. 72D95												

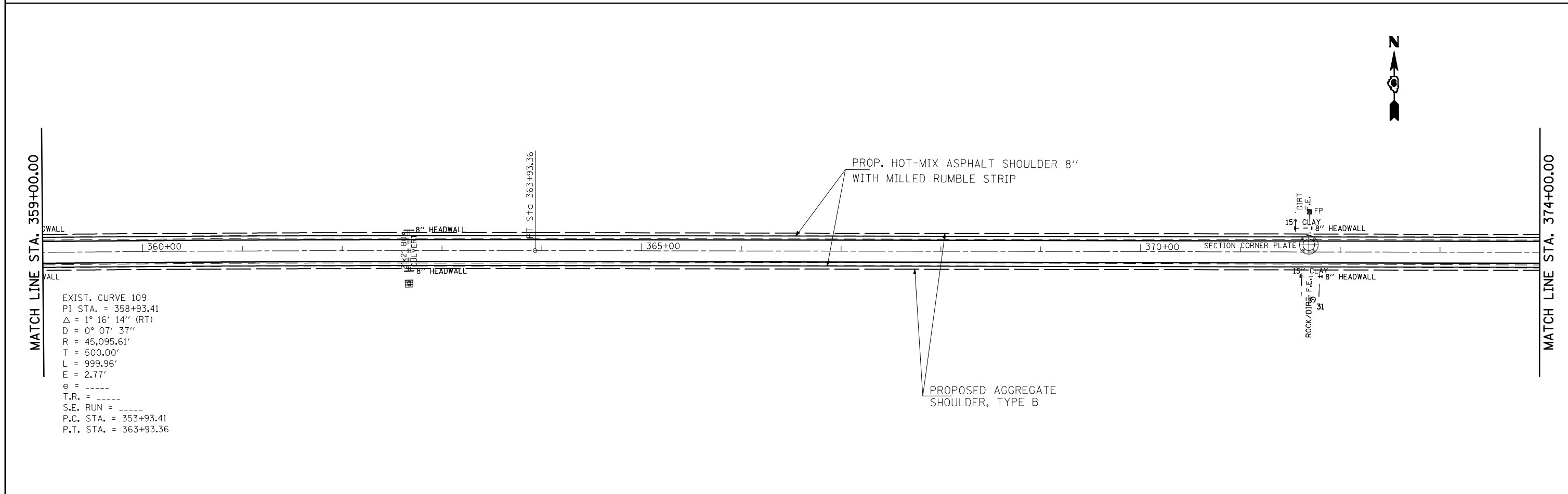
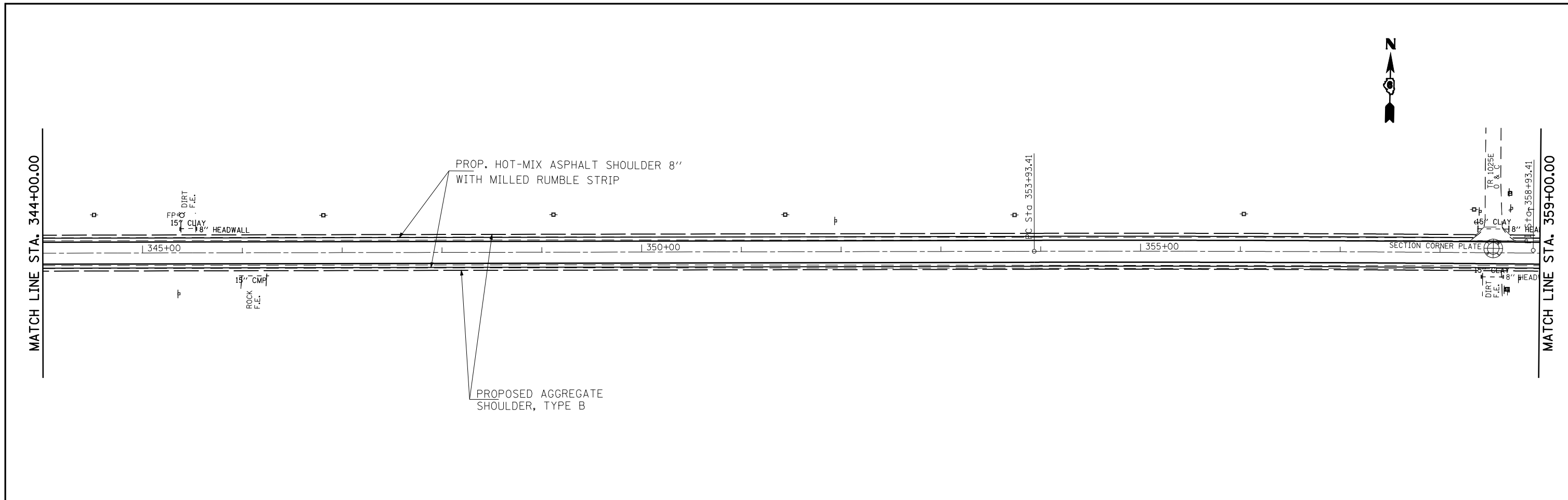

EXIST. CURVE 109
 P.I. STA. = 358+93.41
 $\Delta = 1^\circ 16' 14''$ (RT)
 $D = 0^\circ 07' 37''$
 $R = 45,095.61'$
 $T = 500.00'$
 $L = 999.96'$
 $E = 2.77'$
 $e = \text{-----}$
 $T.R. = \text{-----}$
 $S.E. \text{ RUN} = \text{-----}$
 P.C. STA. = 353+93.41
 P.T. STA. = 363+93.36

FILE NAME =	USER NAME = coxte	DESIGNED -	REVISED -	STATE OF ILLINOIS DEPARTMENT OF TRANSPORTATION	PLAN				F.A.P. RTE.	SECTION	COUNTY	TOTAL SHEETS	SHEET NO.
ei:\pw\work\p\dot\coxte\d0230048\067205-sh1-plan2.dgn		DRAWN -	REVISED -						753	143 I	CHRISTIAN	19	17
	PLOT SCALE = 100.0000' / IN.	CHECKED -	REVISED -		SCALE: SHEET NO. OF SHEETS STA. TO STA.				CONTRACT NO. 72D95				
	PLOT DATE = Dec-28-2010 02:26:37PM	DATE -	REVISED -		ILLINOIS FED. AID PROJECT								

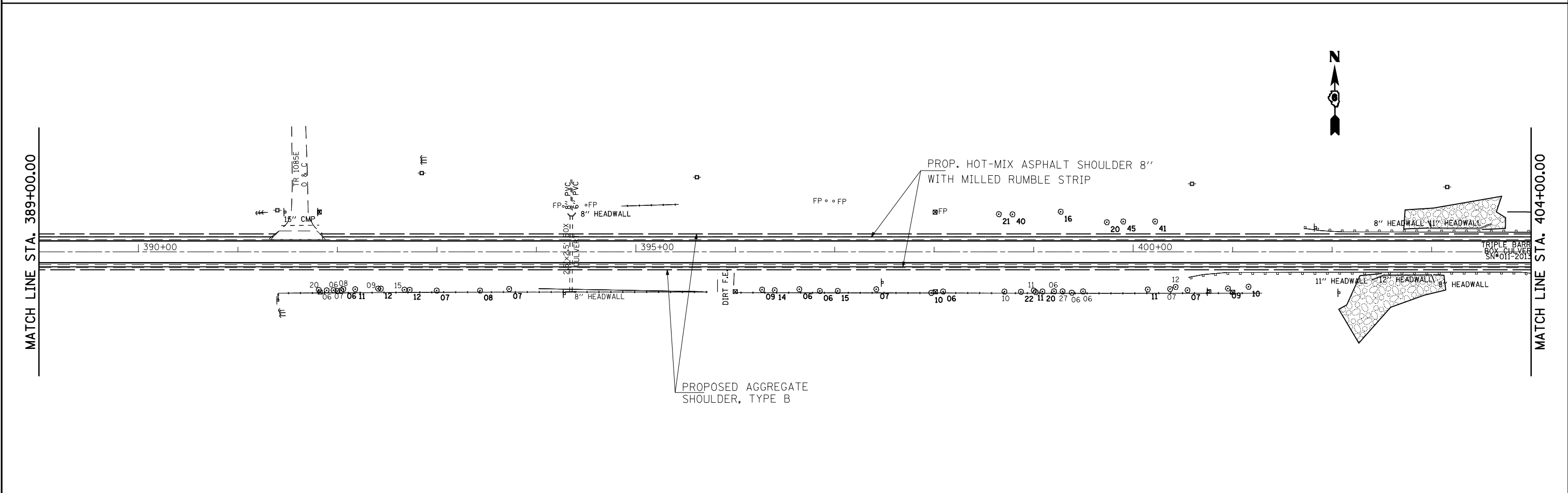
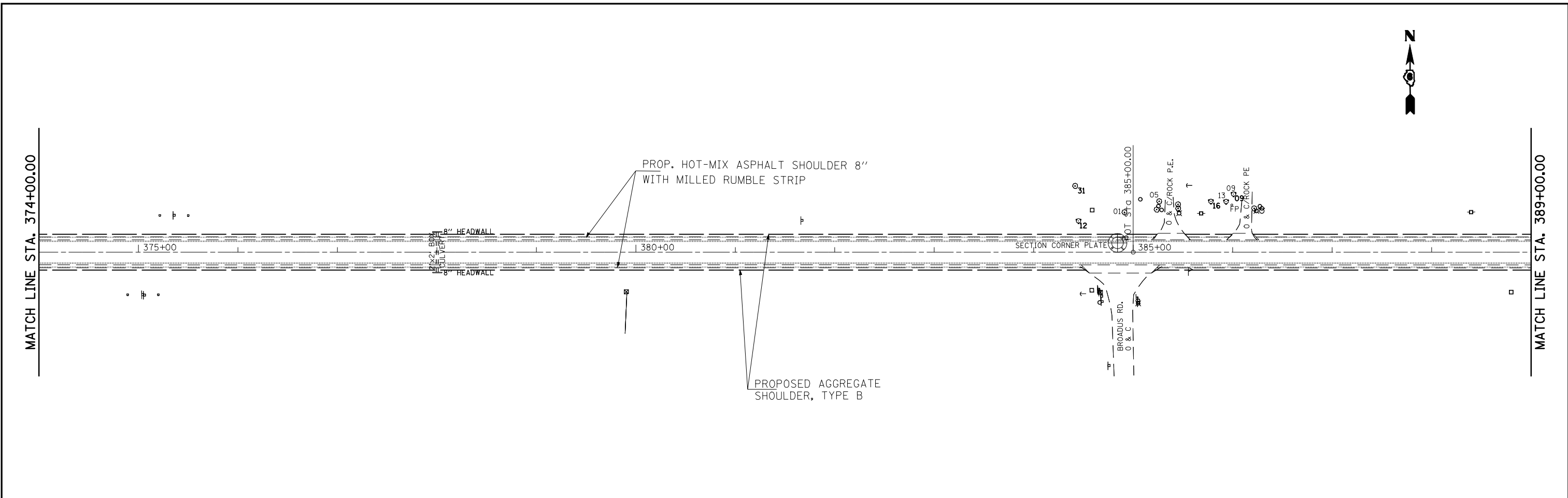

FILE NAME =	USER NAME = coxte	DESIGNED -	REVISED -	STATE OF ILLINOIS DEPARTMENT OF TRANSPORTATION	PLAN				F.A.P. RTE.	SECTION	COUNTY	TOTAL SHEETS	SHEET NO.	
ei:\pw\work\p\dot\coxte\d0230048\D67205-sh1-plan2.dgn		DRAWN -	REVISED -		SCALE:	SHEET NO.	OF SHEETS	STA.	TO STA.	753	143 I	CHRISTIAN	19	18
		CHECKED -	REVISED -									CONTRACT NO. 72D95		
		DATE -	REVISED -									ILLINOIS FED. AID PROJECT		

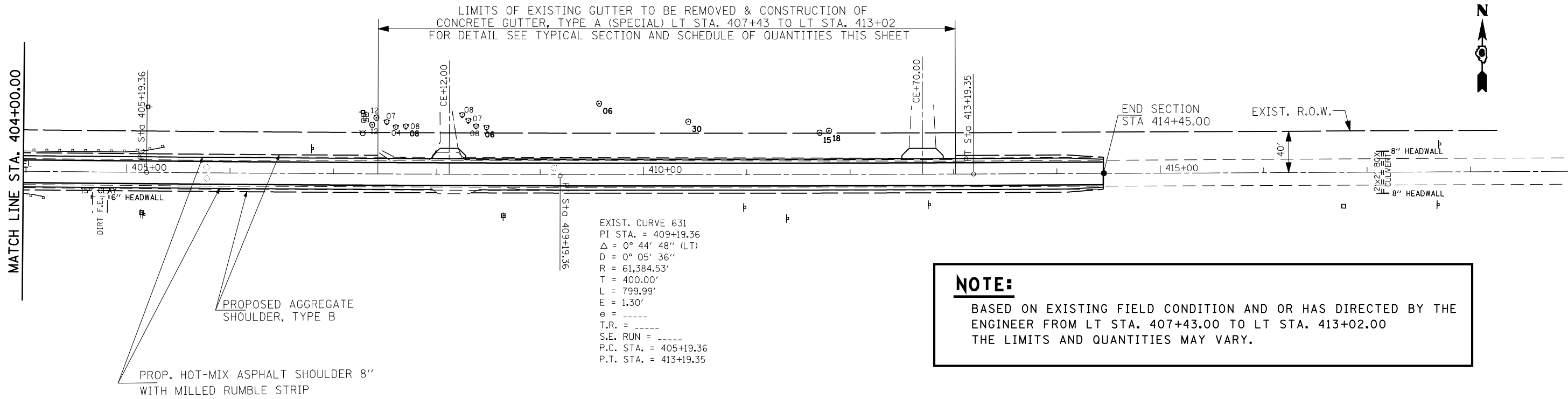

EXIST. CURVE 631
 PI STA. = 409+19.36
 $\Delta = 0^\circ 44' 48''$ (LT)
 $D = 0^\circ 05' 36''$
 $R = 61,384.53'$
 $T = 400.00'$
 $L = 799.99'$
 $E = 1.30'$
 $e = \text{----}$
 $T.R. = \text{----}$
 $S.E. \text{ RUN} = \text{----}$
 $P.C. \text{ STA.} = 405+19.36$
 $P.T. \text{ STA.} = 413+19.35$

NOTE:
 BASED ON EXISTING FIELD CONDITION AND OR HAS DIRECTED BY THE ENGINEER FROM LT STA. 407+43.00 TO LT STA. 413+02.00 THE LIMITS AND QUANTITIES MAY VARY.

GUTTER REMOVAL

LT STA. 407+43 TO LT STA. 413+02 = 559 FT

DRIVEWAY PAVEMENT REMOVAL

CE. LT STA. 408+12 = 26 SQ YD
 CE. LT STA. 412+70 = 60 SQ YD
 TOTAL = 86 SQ YD

CONCRETE GUTTER, TYPE A (SPECIAL)

LT STA. 407+79 TO LT STA. 407+96 = 17 FT
 LT STA. 408+28 TO LT STA. 412+50 = 422 FT
 TOTAL = 439 FT

CLASS S1 CONCRETE (OUTLET)

GUTTER OUTLET LT STA. 407+43 TO LT STA. 407+79 = 4.6 CU YD
 CE. LT STA. 408+12 = 8.7 CU YD
 CE. LT STA. 412+70 = 11.3 CU YD
 GUTTER INLET STA. 412+90 TO STA. 413+02 = 0.9 CU YD
 TOTAL = 25.5 CU YD

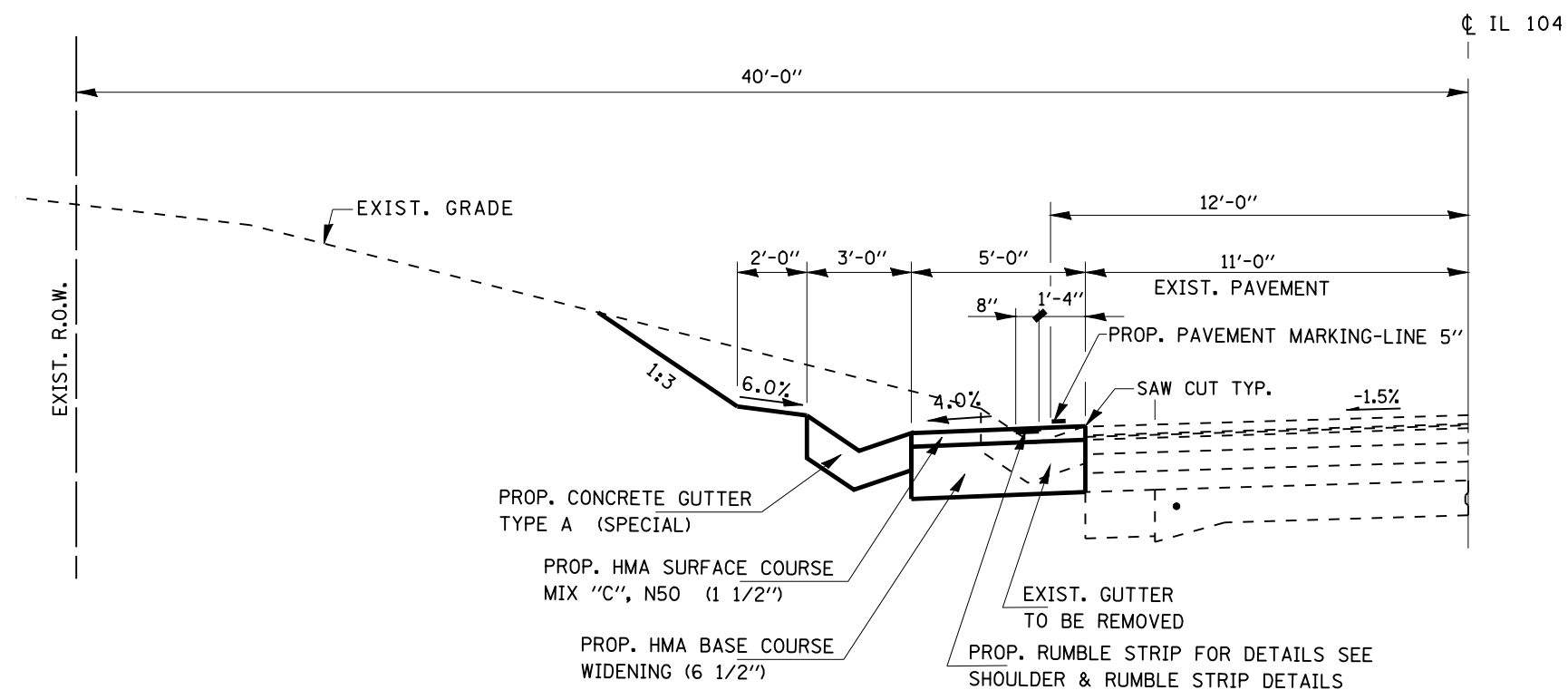

TYPICAL SECTION

LT STA. 407+43.00 TO LT STA. 413+02.00

FILE NAME =	USER NAME = coxte	DESIGNED -	REVISED -	STATE OF ILLINOIS DEPARTMENT OF TRANSPORTATION	PLAN	F.A.P. RTE.	SECTION	COUNTY	TOTAL SHEETS	SHEET NO.
et:\pw\work\p\dot\coxte\d0230048\0672095-shr-plan2.dgn	DRAWN -	REVISED -	753			143 I	CHRISTIAN	19	19	
PLOT SCALE = 100.0000' / IN.	CHECKED -	REVISED -	CONTRACT NO. 72D95							
PLOT DATE = Dec-28-2010 02:26:49PM	DATE -	REVISED -	ILLINOIS FED. AID PROJECT							
SCALE:						SHEET NO.	OF SHEETS	STA.	TO STA.	