

EXIST. CURVE C2  
 PI STA. = 264+43.17  
 $\Delta$  = 49° 29' 55" (RT)  
 D = 5° 38' 33"  
 R = 1,015.43'  
 T = 468.11'  
 L = 877.25'  
 E = 102.70'  
 $\theta$  = -----  
 T.R. = -----  
 S.E. RUN = -----  
 P.C. STA. = 259+75.07  
 P.T. STA. = 268+52.31

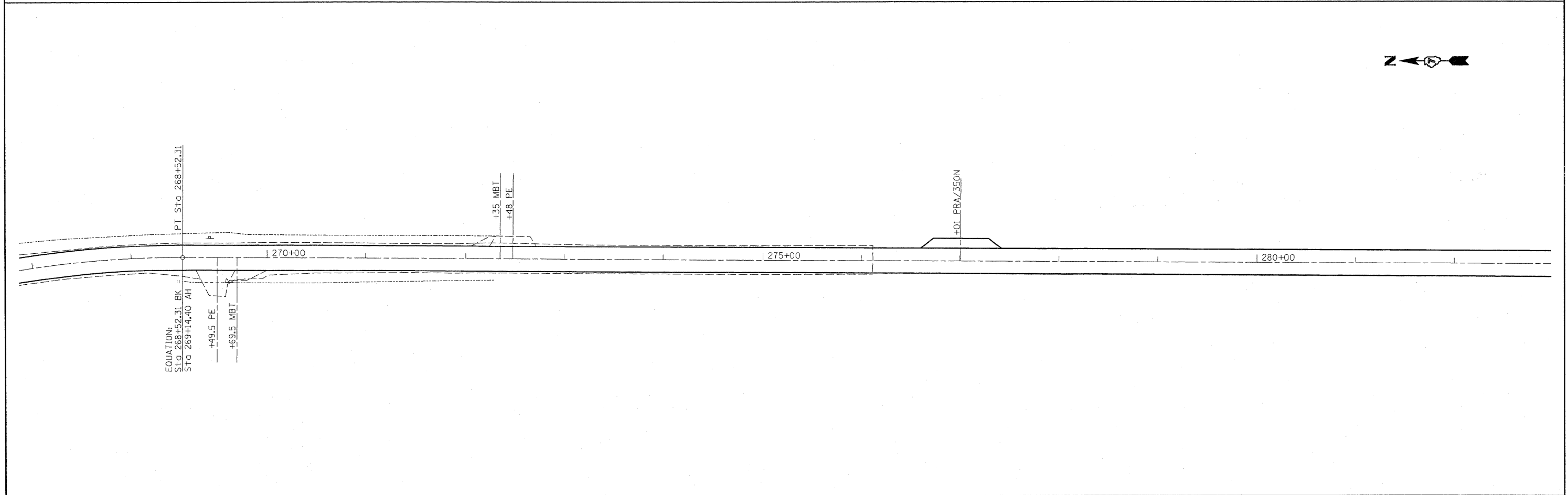

EQUATION:  
 STA 268+52.31 BK =  
 STA 269+14.40 AH  
 +49.5 PE  
 +69.5 MBT

FILE NAME =	USER NAME = swartzw	DESIGNED -	REVISED -	<b>STATE OF ILLINOIS DEPARTMENT OF TRANSPORTATION</b>	<b>PLAN SHEET</b>		F.A.P. RTE.	SECTION	COUNTY	TOTAL SHEETS	SHEET NO.	
c:\pwork\pwork\swartzw\d0177935\d77448-sht-plan.dgn		DRAWN -	REVISED -		328	104 RS-2	WAYNE	77	34			
PLOT SCALE = 50.0000' / IN.		CHECKED -	REVISED -		SCALE: 50		SHEET NO. 15 OF 20 SHEETS		STA. 252+00 TO STA. 282+00		CONTRACT NO. 74448	
PLOT DATE = 12/27/2010		DATE -	REVISED -		ILLINOIS FED. AID PROJECT							