

EXIST. CURVE FAY8
 PI STA. = 131+02.30
 $\Delta = 2^\circ 55' 55''$ (RT)
 $D = 1^\circ 00' 00''$
 $R = 5,729.57'$
 $T = 146.63'$
 $L = 293.19'$
 $E = 1.88'$
 $e = \text{-----}$
 T.R. = -----
 S.E. RUN = -----
 P.C. STA. = 129+55.68
 P.T. STA. = 132+48.87

EXIST. CURVE FAY9
 PI STA. = 133+10.68
 $\Delta = 1^\circ 51' 15''$ (LT)
 $D = 1^\circ 30' 00''$
 $R = 3,819.66'$
 $T = 61.81'$
 $L = 123.61'$
 $E = 0.50'$
 $e = \text{-----}$
 T.R. = -----
 S.E. RUN = -----
 P.C. STA. = 132+48.87
 P.T. STA. = 133+72.48

EXIST. CURVE FAY10
 PI STA. = 134+34.29
 $\Delta = 1^\circ 51' 09''$ (RT)
 $D = 1^\circ 29' 55''$
 $R = 3,823.20'$
 $T = 61.81'$
 $L = 123.61'$
 $E = 0.50'$
 $e = \text{-----}$
 T.R. = -----
 S.E. RUN = -----
 P.C. STA. = 133+72.48
 P.T. STA. = 134+96.09

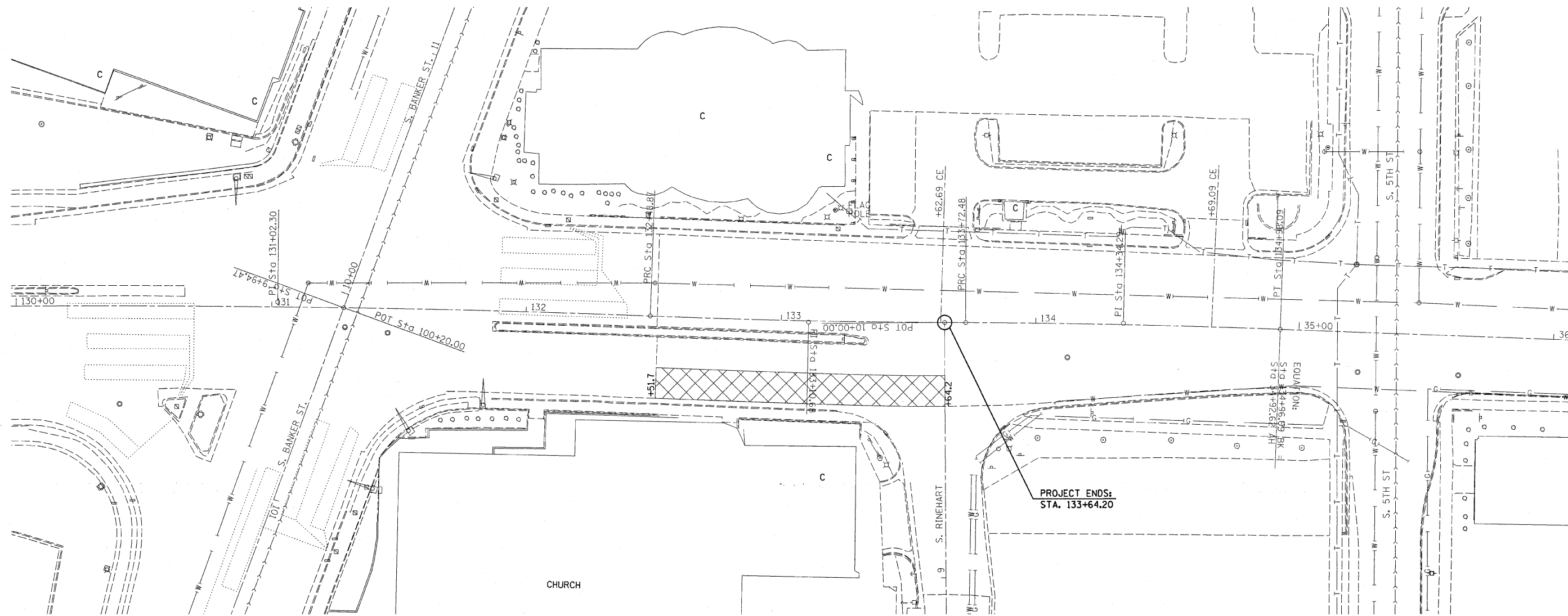

 HOT-MIX ASPHALT SURFACE REMOVAL, 3'

PROJECT ENDS:
 STA. 133+64.20

FILE NAME =	USER NAME = swartzw	DESIGNED -	REVISED -	STATE OF ILLINOIS DEPARTMENT OF TRANSPORTATION	PLAN SHEETS			F.A.P. RTE.	SECTION	COUNTY	TOTAL SHEETS	SHEET NO.
c:\pw_work\pwwork\swartzw\d0185396\d77454-shr-plan.dgn		DRAWN -	REVISED -		95	18-Z RS-2	EFFINGHAM	32	16			
PLOT SCALE = 20,0000' / IN.		CHECKED -	REVISED -		CONTRACT NO. 74454							
PLOT DATE = 12/13/2010		DATE -	REVISED -		ILLINOIS FED. AID PROJECT							
				SCALE: 20	SHEET NO. 6 OF 6 SHEETS	STA. 130+00	TO STA. 36+00					