

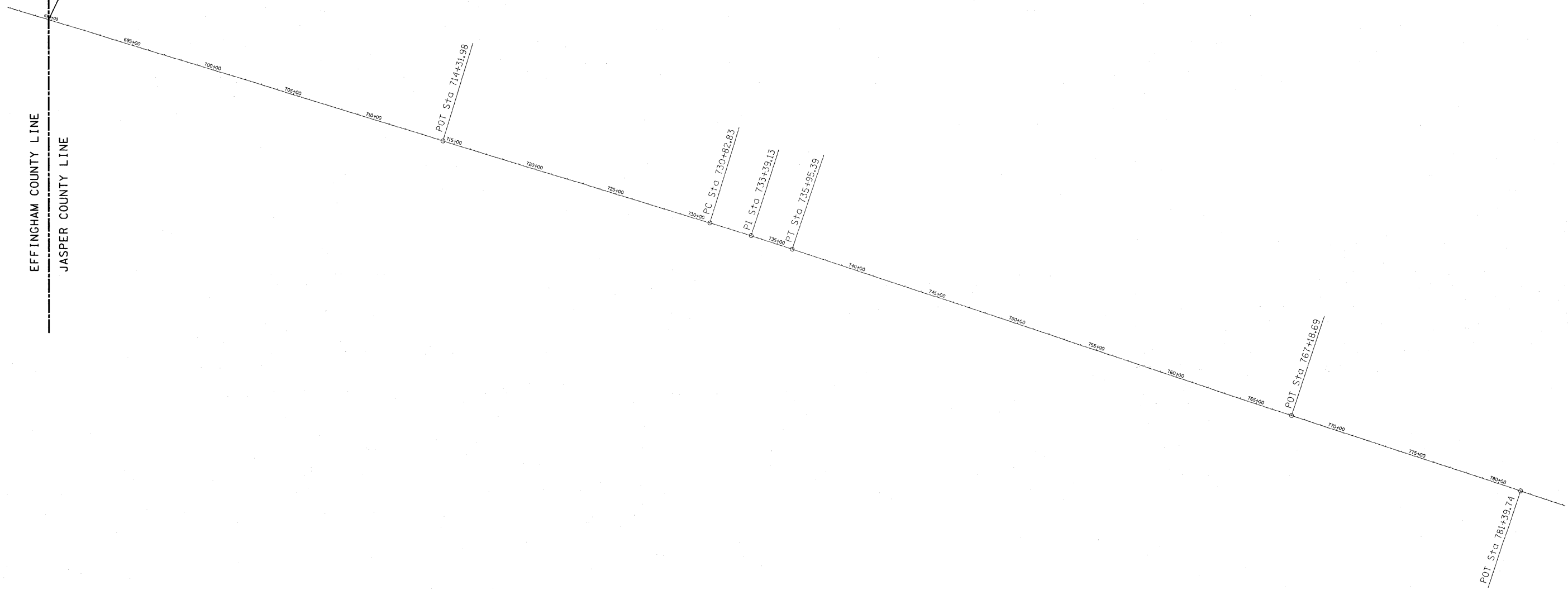

PROJECT BEGINS:
STATION 689+81.63

EXIST. CURVE 33C1A
 PI STA. = 733+39.13
 Δ = 1° 17' 23" (RT)
 D = 0° 15' 06"
 R = 22,768.37'
 T = 256.29'
 L = 512.56'
 E = 1.44'
 e = -----
 T.R. = -----
 S.E. RUN = -----
 P.C. STA. = 730+82.83
 P.T. STA. = 735+95.39

EFFINGHAM COUNTY LINE
 JASPER COUNTY LINE



FILE NAME =	USER NAME = swartzw	DESIGNED -	REVISED -	STATE OF ILLINOIS DEPARTMENT OF TRANSPORTATION	PLAN ALIGNMENT			F.A.P. RTE.	SECTION	COUNTY	TOTAL SHEETS	SHEET NO.
c:\pw_work\p\dot\swartzw\d0241838\d77	606-shr-plan.dgn	DRAWN -	REVISED -		SCALE: NA	SHEET NO. 1 OF 6 SHEETS	STA. 689+81.63 TO STA. 784+00.00	95	(5,6)RS-2A	JASPER	19	9
	PLOT SCALE = 300.0000 ' / IN.	CHECKED -	REVISED -		CONTRACT NO. 74506							
	PLOT DATE = 12/18/2010	DATE -	REVISED -		ILLINOIS FED. AID PROJECT							