

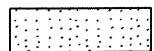



-  PAVED SHOULDER REMOVAL
-  PAVEMENT REMOVAL
-  MEDIAN REMOVAL
-  DRIVEWAY PAVEMENT REMOVAL
-  GUTTER REMOVAL

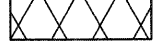
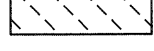

FILE NAME =
0876015-sh1-rem3.dgn

USER NAME = dwoznarski
PLOT SCALE = 48.00' / IN.
PLOT DATE = 9/14/2010

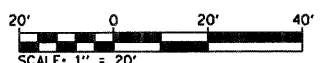
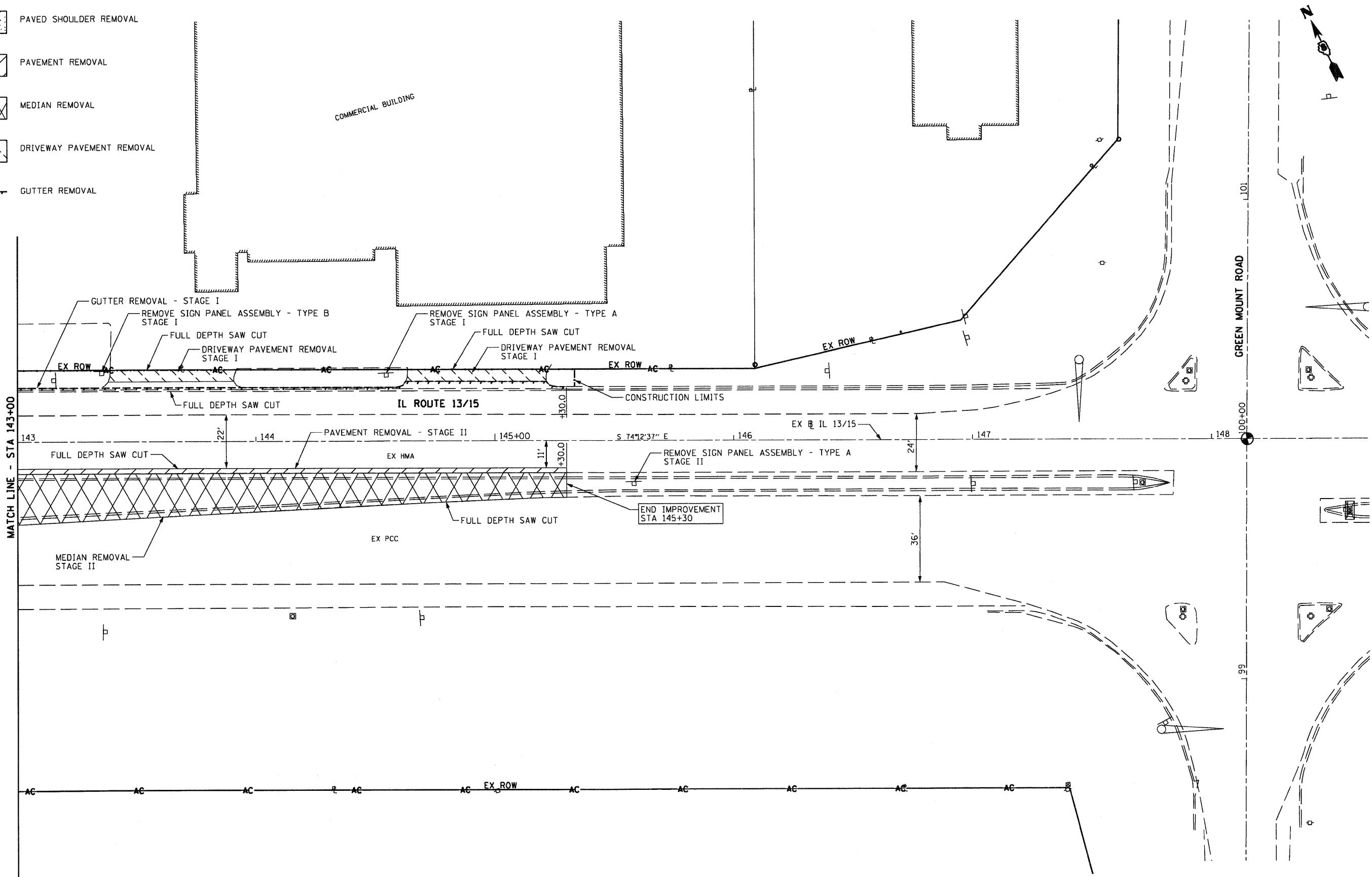
DESIGNED -
DRAWN - DMW
CHECKED -
DATE - 7/9/2010

REVISED -
REVISED -
REVISED -
REVISED -

**STATE OF ILLINOIS
DEPARTMENT OF TRANSPORTATION**

REMOVAL PLAN

SCALE: 1" = 20' SHEET NO. 3 OF 4 SHEETS STA. 143+00 TO STA. 148+00

F.A.P. RTE.	SECTION	COUNTY	TOTAL SHEETS	SHEET NO.
103	27-1-N	ST. CLAIR	50	15
CONTRACT NO. 76015				
FED. ROAD DIST. NO. [ILLINOIS] FED. AID PROJECT				