

- ① PIPE UNDERDRAIN REMOVAL - 12 LF
- ② PIPE UNDERDRAIN 4" (SPECIAL) - 15 LF
- ③ REMOVE AND REINSTALL CONCRETE HEADWALL FOR PIPE UNDERDRAIN STA 138+89, 84.5' RT (BACK OF HEADWALL)

ADJ INLETS TO BE ADJUSTED

CONTRACTOR SHALL USE CAUTION TO INSURE CONSTRUCTION OF THE ACCESS RD & CITY ST WILL NOT DAMAGE EXISTING UNDERDRAIN. REPLACING DAMAGED UNDERDRAIN SHALL BE AT CONTRACTOR'S EXPENSE.

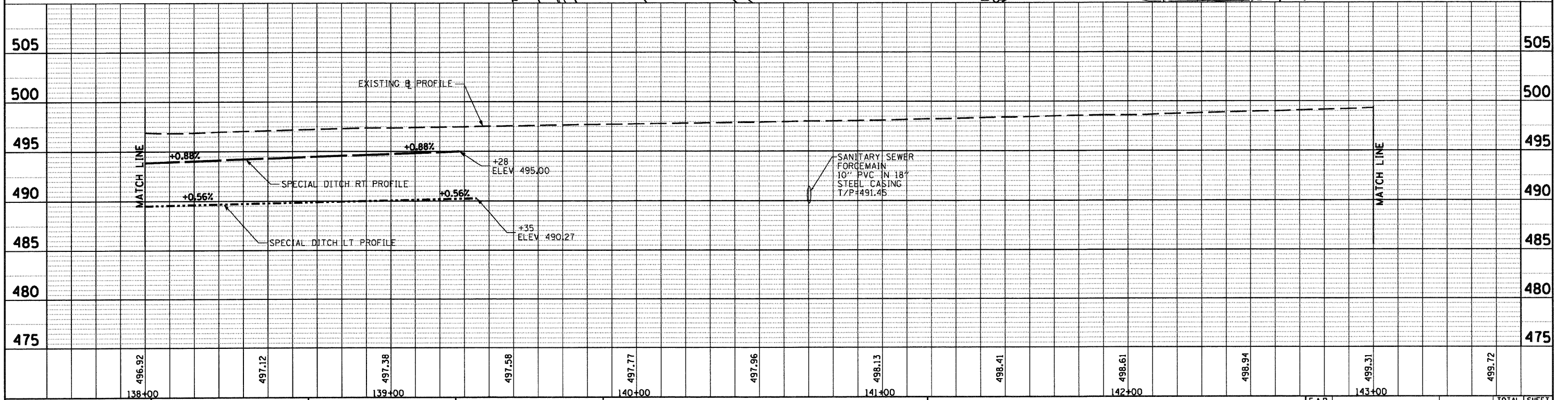
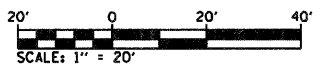

FILE NAME = D876015-sh1-drain2.dgn	USER NAME = dvozmbrski	DESIGNED - DRAWN - DMW	REVISED - REVISED -	STATE OF ILLINOIS DEPARTMENT OF TRANSPORTATION		IL ROUTE 1315 DRAINAGE AND UTILITIES		F.A.P. RTE. 103	SECTION 27-1-N	COUNTY ST. CLAIR	TOTAL SHEETS 50	SHEET NO. 29
PLOT SCALE = 40.0000' / IN. PLOT DATE = 9/14/2010		CHECKED - DATE - 7/9/2010	REVISED - REVISED -					SCALE: 1"=20'	SHEET NO. 2 OF 5 SHEETS	STA. 138+00 TO STA. 143+00	FED. ROAD DIST. NO.	(ILLINOIS) FED. AID PROJECT