

PROP. CURVE C10  
 PI STA. = 990+60.76  
 $\Delta = 5^{\circ} 44' 00''$  (LT)  
 $D = 0^{\circ} 34' 00''$   
 $R = 10,111.10'$   
 $T = 506.30'$   
 $L = 1,011.76'$   
 $E = 12.67'$   
 $\circ =$   
 T.R. =  
 S.E. RUN =  
 P.C. STA. = 985+54.46  
 P.T. STA. = 995+66.22

**LEGEND**

////// MILLING AND RESURFACING LIMITS  
 X REMOVAL ITEMS

MATCHLINE STA. 990+00

MATCHLINE STA. 1005+00

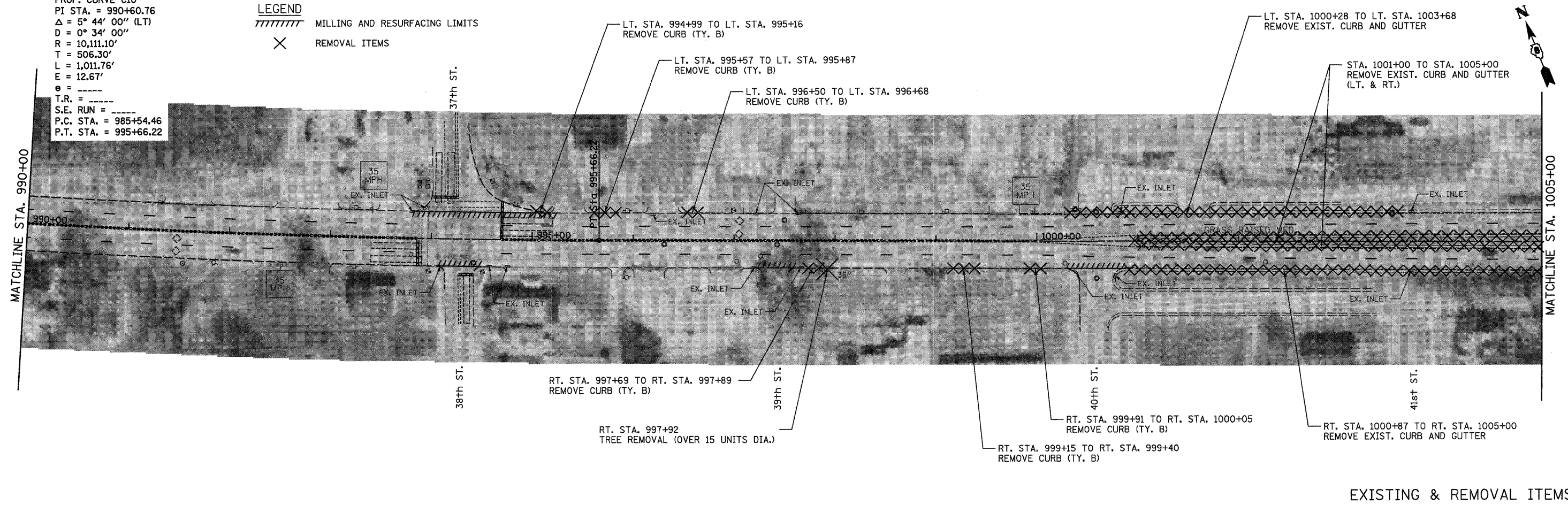

EXISTING & REMOVAL ITEMS

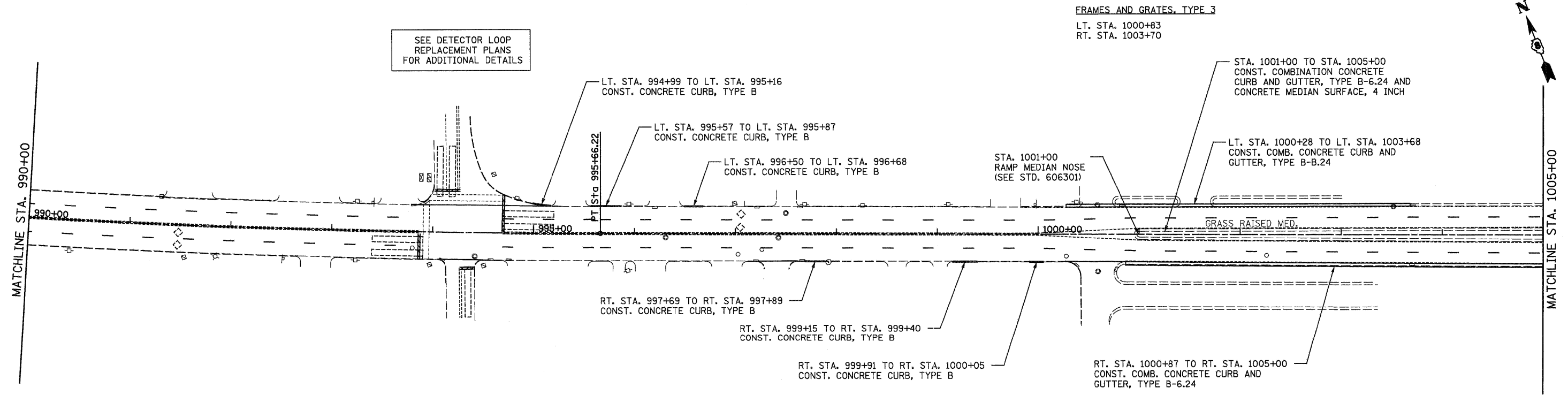

SEE DETECTOR LOOP REPLACEMENT PLANS FOR ADDITIONAL DETAILS

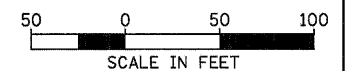

SCALE IN FEET

PROPOSED IMPROVEMENTS

|  |                 |            |           |
|--|-----------------|------------|-----------|
| FILE NAME =<br>...\\cadd\087609b-ah-1-plan02.dgn               | USER NAME = SJS | DESIGNED - | REVISED - |
|  |                 | DRAWN -    | REVISED - |
|  |                 | CHECKED -  | REVISED - |
|  |                 | DATE -     | REVISED - |
| PLOT SCALE = 50.0000' / IN.<br>PLOT DATE = 12/15/2010 09:35:52 |                 |            |           |

**STATE OF ILLINOIS  
 DEPARTMENT OF TRANSPORTATION**

**ST. CLAIR AVE./LINCOLN TRAIL PLAN SHEET**

SCALE: SHEET NO. OF SHEETS STA. 990+00.00 TO STA. 1005+00.00

|                           |                     |                     |                    |                 |
|---------------------------|---------------------|---------------------|--------------------|-----------------|
| F.A.U. RTE.<br>9166       | SECTION<br>34-1RS-3 | COUNTY<br>ST. CLAIR | TOTAL SHEETS<br>87 | SHEET NO.<br>29 |
| CONTRACT NO. 76D96        |                     |                     |                    |                 |
| ILLINOIS FED. AID PROJECT |                     |                     |                    |                 |

