

LEGEND

-  MILLING AND RESURFACING LIMITS
-  REMOVAL ITEMS

PROP. CURVE C14
 PI STA. = 1096+97.85
 $\Delta = 26^\circ 44' 00''$ (LT)
 $D = 0^\circ 48' 00''$
 $R = 7,161.98'$
 $T = 1,701.82'$
 $L = 3,341.67'$
 $E = 199.42'$
 $e = \text{-----}$
 $T.R. = \text{-----}$
 $S.E. RUN = \text{-----}$
 P.C. STA. = 1079+96.03
 P.T. STA. = 1113+37.70

REMOVE EXISTING OUTLETS
 (COST INCLUDED WITH GUTTER REMOVAL)
 LT. STA. 1097+05
 LT. STA. 1106+75
 LT. STA. 1108+15

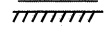
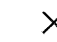
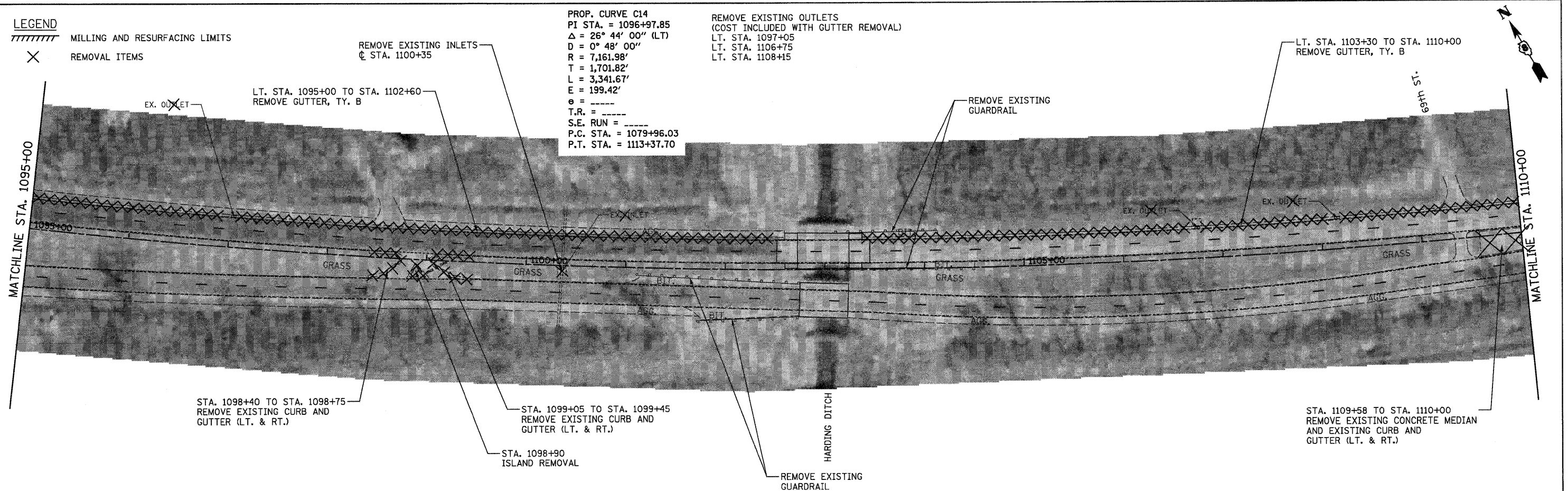

EXISTING & REMOVAL ITEMS

RESURFACING OMISSION
 STA. 1102+72 TO STA. 1103+24

PROPOSED GUARDRAIL
 (MEDIAN WB) (OFFSET 6')
 LT. STA. 1103+24 TO LT. STA. 1103+67 (T.B.T. TY. 6)
 LT. STA. 1103+67 TO LT. STA. 1104+67 (SPBGR. TY. A)
 LT. STA. 1104+67 TO LT. STA. 1105+17 (T.B.T. TY. 1 SPL. TANG.)

(OUTSIDE WB) (OFFSET 8')
 LT. STA. 1103+24 TO LT. STA. 1103+67 (T.B.T. TY. 6)
 LT. STA. 1103+67 TO LT. STA. 1104+67 (SPBGR. TY. A)
 LT. STA. 1104+67 TO LT. STA. 1105+17 (T.B.T. TY. 1 SPL. TANG.)

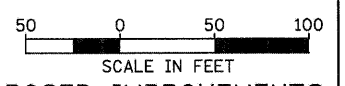
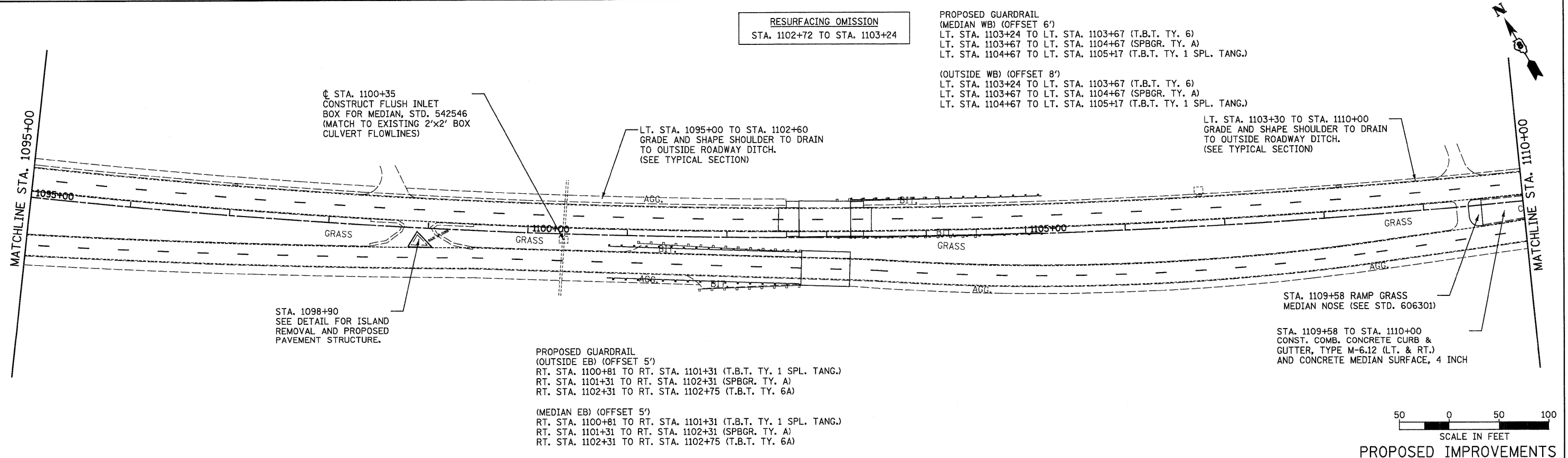

PROPOSED IMPROVEMENTS

FILE NAME = ...dadd\0876D96-ahh-plen09.dgn	USER NAME = SJS	DESIGNED -	REVISED -	STATE OF ILLINOIS DEPARTMENT OF TRANSPORTATION	ST. CLAIR AVE./LINCOLN TRAIL PLAN SHEET			F.A.U. RTE. 9166	SECTION 34-IRS-3	COUNTY ST. CLAIR	TOTAL SHEETS 87	SHEET NO. 36
PLT SCALE = 50.0000' / IN.	CHECKED -	REVISED -	REVISED -		SCALE:	SHEET NO.	OF	SHEETS	STA. 1095+00.00 TO STA. 1110+00.00	CONTRACT NO. 76D96		
PLT DATE = 12/15/2010 09:36:44	DATE -	REVISED -	REVISED -		ILLINOIS FED. AID PROJECT							
