

STATE OF ILLINOIS
DEPARTMENT OF TRANSPORTATION

GENERAL NOTES

A Concrete Sealer shall be applied to the surfaces of the deck and parapets. See Special Provisions for Bridge Deck Concrete Sealer.

Existing pavement markings shall be temporarily covered prior to application of the deck surface treatment, to prevent the material from being applied over the markings. The temporary covering shall be removed after the application of the deck surface treatment and prior to opening to traffic. Cost included with Concrete Sealer.

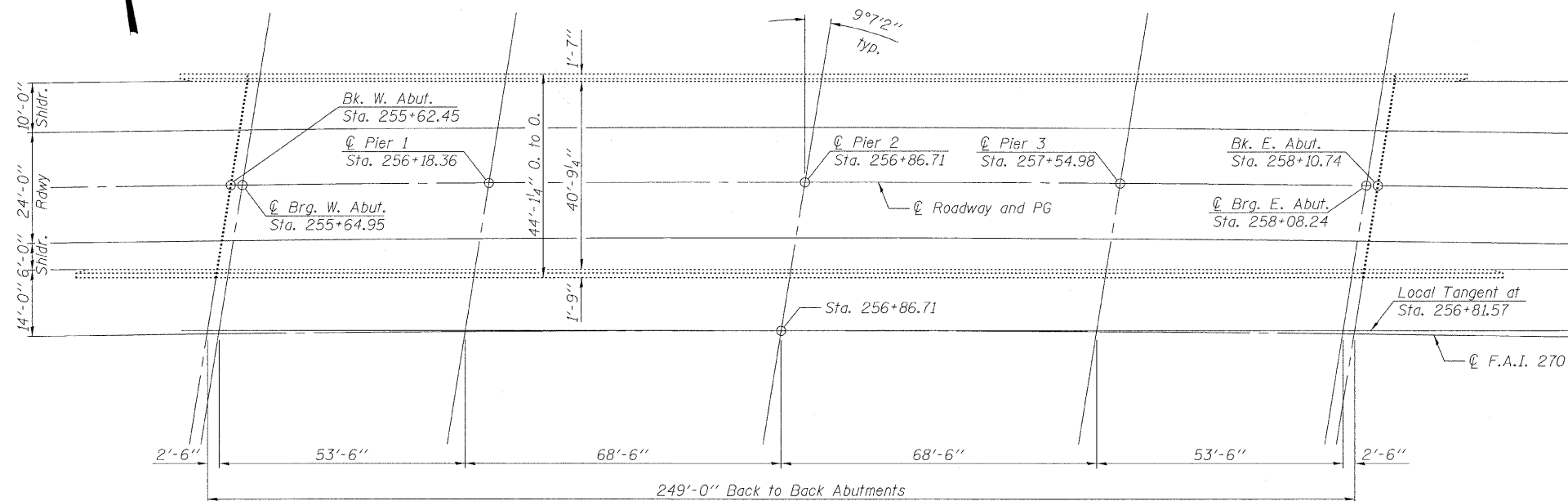

PLAN

* Varies 10'-9 1/4" max., 10'-0" min., Shoulder.
** Varies 6'-9 1/4" max., 6'-0" min., Shoulder.

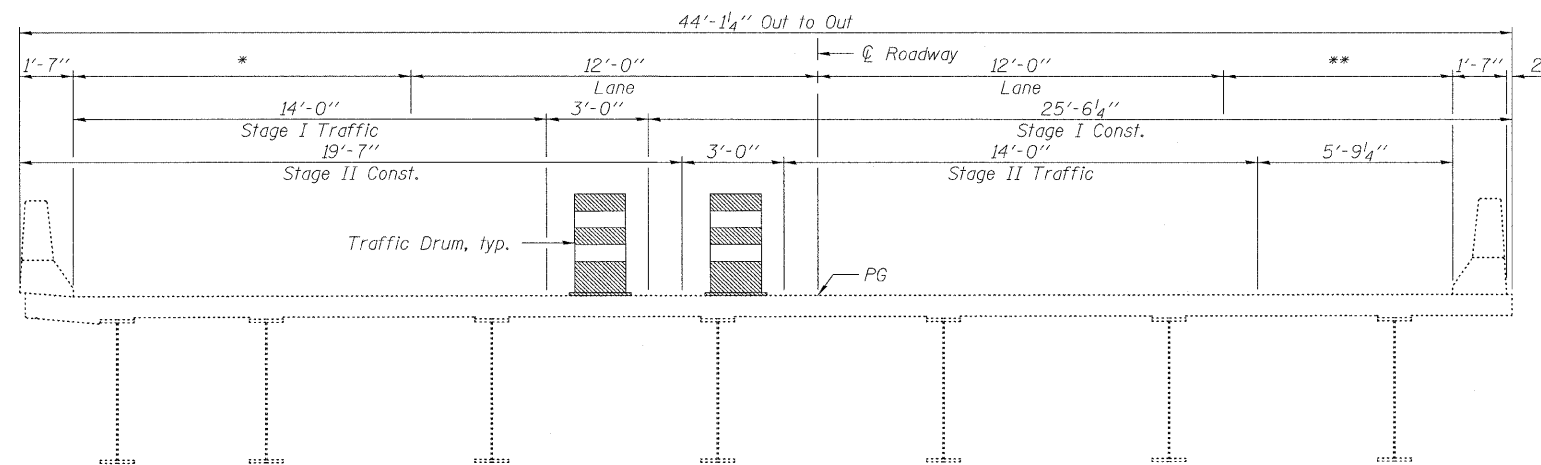

CROSS SECTION

(Looking East)

TOTAL BILL OF MATERIAL

ITEM	UNIT	SUPER	SUB	TOTAL
Concrete Sealer	Sq. Ft.	12,253		12,253

DESIGNED	---
CHECKED	---
DRAWN	WVK
CHECKED	EML

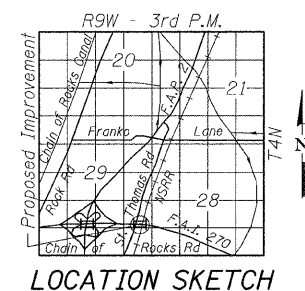

LOCATION SKETCH

HORNER & SHIFRIN, INC. ENGINEERS

GENERAL PLAN
I-270 OVER ST. THOMAS ROAD AND NSRR
F.A.I. RTE. 270
SEC. DIST. 8 BRIDGE DECK 2011-3
MADISON COUNTY
STATION 256+81.57
STRUCTURE NO. 060-0041 (W.B.)

SHEET NO. 1 1 SHEETS	F.A.I. RTE.	SECTION	COUNTY	TOTAL SHEETS	SHEET NO.
	VAR.	DIST 8 BRIDGE DECK 2011-3	MADISON	29	9
			CONTRACT NO. 76E43		
ILLINOIS FED. AID PROJECT					