

STATE OF ILLINOIS  
JO DAVIESS COUNTY  
PLANS FOR PROPOSED  
LOCAL AGENCY IMPROVEMENTS  
FEDERAL-AID PROJECT  
SECTION 09-00133-00-BR  
SCOUT CAMP ROAD  
FAS 73  
PROJECT NO. BRS-0073 (105)  
JOB NO. C-92-109-10  
CONTRACT NO. 85514  
2010

INDEX OF SHEETS

1	COVER SHEET AND INDEX OF SHEETS
2	SUMMARY OF QUANTITIES
3-6	TYPICAL SECTIONS, GENERAL NOTES, AND CONTROL POINTS
7-10	SCHEDULES OF QUANTITIES
11-13	PLAN AND PROFILE - SCOUT CAMP ROAD
14	PLAN AND PROFILE - WELCH ROAD
15	INTERSECTION DETAILS; ROAD CLOSURE PLAN
16-20	STORM WATER POLLUTION PREVENTION PLAN
21-32	STRUCTURAL DETAILS
33-45	CROSS SECTIONS - SCOUT CAMP ROAD
46-47	CROSS SECTIONS - WELCH ROAD
48	40.1 TYPICAL APPLICATION FOR ROAD CLOSURE

STANDARDS

000001-06	STANDARD SYMBOLS, ABBREVIATIONS, AND PATTERNS
280001-05	TEMPORARY EROSION CONTROL SYSTEMS
515001-03	NAME PLATE FOR BRIDGES
542301-03	PRECAST REINFORCED CONCRETE FLARED END SECTION
630301-05	SHOULDER WIDENING FOR TYPE 1 (SPECIAL) GUARDRAIL TERMINALS
631032-06	TRAFFIC BARRIER TERMINAL, TYPE 6A
635006-03	REFLECTOR AND TERMINAL MARKER PLACEMENT
665001-02	WOVEN WIRE FENCE
635011-02	REFLECTOR MARKER AND MOUNTING DETAILS
701006-03	OFF-ROAD OPERATIONS, 2L, 2W, 15' TO 24" FROM PAVEMENT EDGE
701301-04	LANE CLOSURE, 2L, 2W, SHORT TIME OPERATIONS
701901-01	TRAFFIC CONTROL DEVICES
720011-01	METAL POSTS FOR SIGNS, MARKERS, & DELINEATORS
728001-01	TELESCOPING STEEL SIGN SUPPORT
729001-01	APPLICATIONS OF TYPES A & B METAL (FOR SIGNS & MARKERS)
780001-02	TYPICAL PAVEMENT MARKINGS

NAME AND ADDRESS OF UTILITIES	TYPE
VERIZON ATTN: PAULO JAVIER 2239 NEWBURG ROAD BELVIDERE, IL 61008 815-547-0395	TELEPHONE

WELCH ROAD  
PROJECT ENDS  
STA 83+39

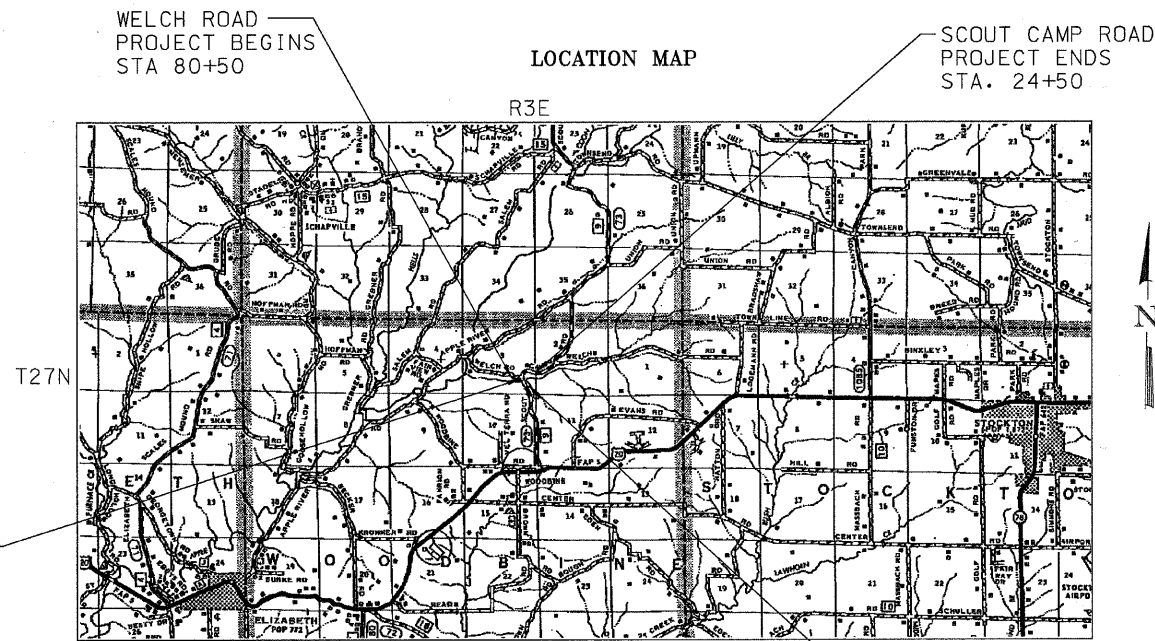

PROPOSED STRUCTURE  
S.N. 043-3276 STA.  
13+18.37 TO 14+01.63

PROJECT LENGTH  
S. SCOUT CAMP ROAD = 1,400' = 0.27 MILES  
WELCH ROAD = 289' = 0.06 MILES  
NET LENGTH = 1,689' = 0.33 MILES

DESIGN CRITERIA				
FUNCTIONAL CLASSIFICATION	HIGHWAY	ADT (2030)	% TRUCKS	DESIGN SPEED
MINOR COLLECTOR	SCOUT CAMP ROAD	287	3%	30 MPH
LOCAL	WELCH ROAD	123	3%	30 MPH

CLOSED ROAD ADT = 10

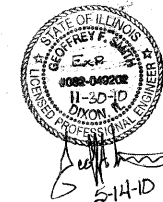
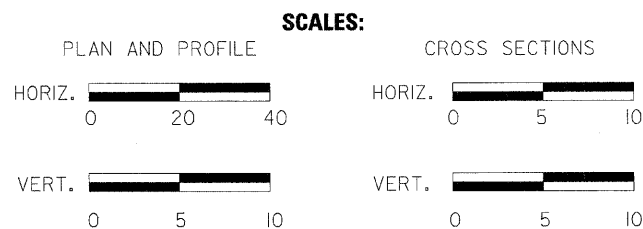

5-14-10

JO DAVIESS COUNTY	
APPROVED	5/27/2010 DATE <i>[Signature]</i> COUNTY ENGINEER
PASSED	July 6, 2010 DATE <i>[Signature]</i> DISTRICT 2 ENGINEER OF LOCAL ROADS & STREETS
RELEASING FOR BID BASED ON LIMITED REVIEW	July 6, 2010 DATE <i>[Signature]</i> DEPUTY DIRECTOR OF HIGHWAYS, REGION 2 ENGINEER



**WILLETT, HOFMANN & ASSOCIATES, INC.**  
CONSULTING ENGINEERS  
Land Surveying - Transportation - Structural  
Environmental - Architecture

809 East Second Street Dixon, Illinois 61021  
Phone 815.284.3381 Fax 815.284.3385  
Design Firm #184-000918  
www.willetthofmann.com