

5'
SCALE 5'

Proposed Roadway

85514

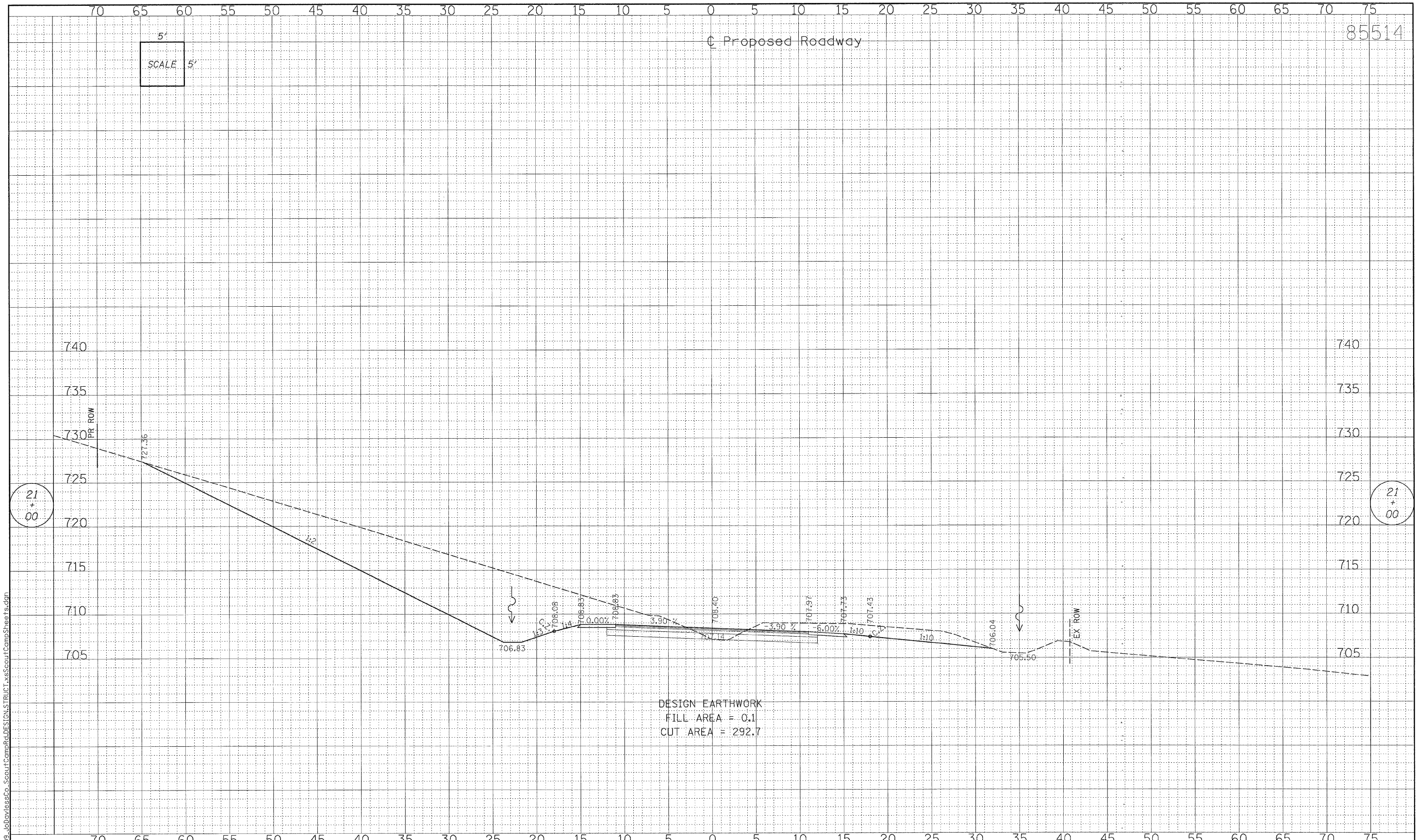

DESIGN EARTHWORK
FILL AREA = 0.1
CUT AREA = 292.7

REV.	DATE	BY	REMARKS

DRAWN	X.X.X.
CHECKED	X.X.X.
APPROVED	X.X.X.

**JO DAVIESS COUNTY
SCOUT CAMP ROAD AND
WELCH ROAD IMPROVEMENTS**

**WILLETT,
HOFMANN &
ASSOCIATES, INC.**
CONSULTING ENGINEERS
Land Surveying - Transportation - Structural
Environmental - Architecture
809 East Second Street Dixon, Illinois 61021
Phone 815.284.3381 Fax 815.284.3385
Design Firm #184-000918
www.willett-hofmann.com

F.A.S. 73
FED. AID PROJECT -
FED. ROAD DIST. NO. 7 ILLINOIS

**SCOUT CAMP ROAD
CROSS SECTIONS**

STA. 21+00.00 - STA. 21+00.00

SECTION	COUNTY	TOTAL SHEETS	SHEET NO.
09-00133-00-BR	JO DAVIESS	48	41
STA. 21+00.00 - STA. 21+00.00			
WHA PROJECT: 1169D09		DATE: XX/XX/XXXX	

FILE = S:\PROJECTS\1169D09\JO Daviess Co. Scout Camp Rd\DESIGN\STRUCT\XSScoutCampSheet18.dgn