

PLANS FOR PROPOSED FEDERAL-AID BRIDGE REPLACEMENT & REHABILITATION PROGRAM

PLAN 1 INCH = 50 FEET
 PROFILE (HOR.) 1 INCH = 50 FEET
 PROFILE (VERT.) 1 INCH = 5 FEET
 CROSS SECTIONS 1 INCH = 5/10 FEET

SUMMARY OF QUANTITIES

ITEM	UNIT	QUANTITY
20200100	EARTH EXCAVATION	CU YD 352
20300100	CHANNEL EXCAVATION	CU YD 171
20700220	POROUS GRANULAR EMBANKMENT	CU YD 53
21001000	GEOTECHNICAL FABRIC FOR GROUND STAB.	SQ. YD. 1,530
20400800	FURNISHED EXCAVATION	CU YD 140
X2501000	SEEDING CLASS 2. SPECIAL	ACRE 0.25
28100709	STONE DUMPED RIPRAP, CLASS A5	SQ. YD. 292
28200200	FILTER FABRIC	SQ. YD. 292
35101400	AGGREGATE BASE CSE, TY B	TON 1,005
50100100	REMOVAL OF EXISTING STRUCTURE	EA. 1
50200100	STRUCTURE EXCAVATION	CU. YD. 93
50300225	CONCRETE STRUCTURES	CU. YD. 27.7
50300300	PROTECTIVE COAT	SQ. YD. 265
50400505	PRECAST PRESTRESSED CONC. DECK BEAMS, 27"	SO. FT. 2,073
50800205	REINFORCEMENT BARS, EPOXY COATED	LB. 3,600
* 50901050	STEEL RAIL, TY SM	FT. 142
51201400	FURNISHING STEEL PILES, HP 10 X 42	FT. 468
51202305	DRIVING PILE	FT. 468
51203400	TEST PILE, STEEL HP 10 X 42	EACH 2
51204650	PILE SHOES	EACH 10
51500100	NAME PLATES	EACH 1
54200220	PIPE CULVERTS, CLASS D, TY-1, 15"	FOOT 50
* 63000001	SPBGR TYA 6FT POSTS	FOOT 100
* 63100075	TRAF BAR TERM T5A	EACH 2
* 63100167	TR BAR TRM T1 SPL TAN	EACH 2
67100100	MOBILIZATION	L SUM 1
X7010216	TRAFFIC CONTROL & PROTECTION, SPL	L SUM 1

INDEX OF SHEETS

- INDEX OF SHEETS, SUMMARY OF QUANTITIES
- TYPICAL SECTIONS
- PLAN AND PROFILE
- CROSS SECTIONS
- GENERAL PLAN AND ELEVATION
- SUPERSTRUCTURE
- SUBSTRUCTURE
- STEEL BRIDGE RAIL, TY SM
- PILE SHEET

STANDARDS:

- 280001-05 TEMPORARY EROSION CONTROL SYSTEMS
- 515001-03 NAME PLATE FOR BRIDGE
- 630301-05 SHLDR WIDENING FOR TY-1 GR TERM.
- 701006-03 OFF-RD OPERATIONS, 2L, 2W 15' TO 24"
- 701301-04 LANE CLOSURE, 2L, 2W, SHORT TIME OPERATIONS
- 701901-01 TRAFFIC CONTROL DEVICES
- 728001-01 TELESCOPING STEEL SIGN SUPPORT
- 729001-01 APPLS. OF TYPES A & B METAL POSTS
- BLR 21-8 TYP. APPLICATION OF TRAFFIC CONTROL DEVICES
- BLR 22-6 TYP. APPLICATION OF TRAFFIC CONTROL DEVICES FOR CONSTRUCTION ON RURAL LOCAL HIGHWAYS
- BLR 26-2 STEEL PLATE BEAM GUARDRAIL 27 1/2" HEIGHT
- BLR 27-1 TRAFFIC BARRIER TERMINAL TYPE 5A

COUNTY HIGHWAY #11
 OIL VALLEY SCHOOL ROAD
 SECTION 09-00088-00-BR
 CARROLL COUNTY

PROJECT NO. BROS - 0015(043)
 CONTRACT NO. 85527
 JOB NO. C - 92-108-10

SECTION 09-00088-00-BR
 BEGINS AT STA. 0+00

SECTION 09-00088-00-BR
 ENDS AT STA. 6+00

R 4 E OF THE 4TH P.M.

SECTION 09-00088-00-BR

INCLUDES THE REMOVAL OF A 2 SPAN BRIDGE AND CONSTRUCTION OF A NEW SINGLE SPAN PCDB BRIDGE ON PILE BENT SPILL THRU ABUTMENTS. ALSO INCLUDED IS APPROACH ROADWAY CONSTRUCTION.

(70' - 6" BK - BK ABUTMENTS, 20° SKEW RT. AHD.)

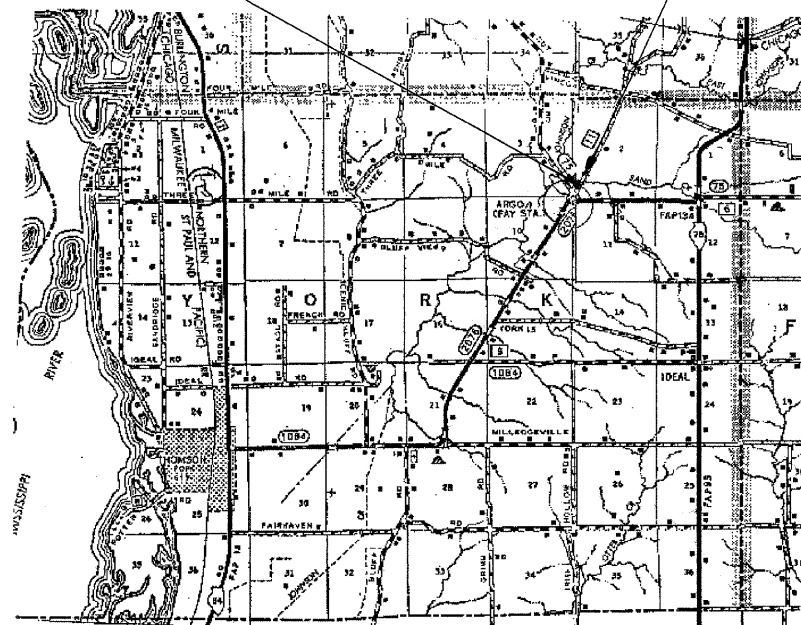
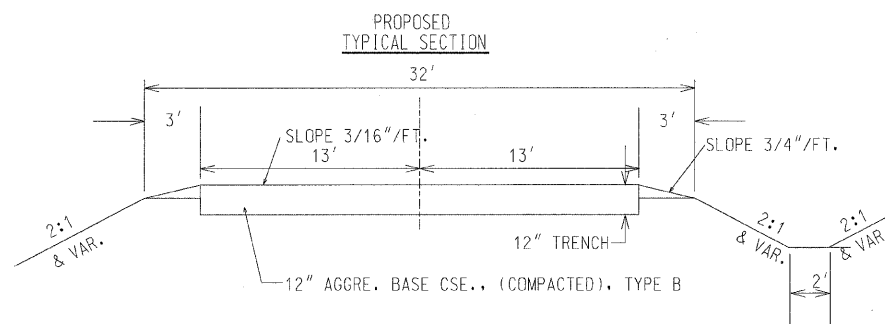

LOCATION MAP

NET LENGTH OF SECTION = 600 FT. = 0.114 MILE



Kevin E. Boudreau
 12/16/2010
 EXP. 11/30/2011

CONSTRUCTION TYPE CODE 0011

* SPECIALTY ITEMS

STATE OF ILLINOIS
 DEPARTMENT OF TRANSPORTATION

APPROVED Dec 16 20 10
 Kevin E. Boudreau
 CARROLL COUNTY ENGINEER

PASSED January 4 20 11
 District 2 Engineer of Local Roads and Streets

Releasing for Bid
 Based on Limited Review January 4 20 11
 Deputy Director of Highways, Region 2 Engineer

"CALL J.U.L.I.E. BEFORE YOU DIG"
 JOINT UTILITY LOCATION INFORMATION FOR EXCAVATION
 1-800-892-0123

DESIGN: LOCAL ROAD, ADT 350 (20 YEAR), 3% TRUCKS, 50 MPH DESIGN SPEED, 3R GUIDELINES