

ENGINEERING DIVISION
CITY OF GALESBURG, ILLINOIS
**PLANS FOR PROPOSED
WEST NORTH STREET SIDEWALK**

CONTRACT #	SECTION #	TOTAL SHEETS	SHEET NO.
89574	09-02201-24-SW	13	1

CALL J.U.L.I.E.
BEFORE DIGGING
800-892-0123

PROJECT LIMITS: W. NORTH STREET FROM JUST EAST OF KINGS CANYON BLVD. TO COLUMBUS AVE.
TOWNSHIP 11 NORTH, RANGE 1 EAST, SW QUADRANT OF SECTION 9

FEDERAL SAFE ROUTES TO SCHOOL PROJECT
SECTION NUMBER 09-02201-24-SW

CONTRACT NO. 89574
PROJECT # SRTS 4009(001)
JOB # C-40-073-09

INDEX OF SHEETS

SHEET 1	TITLE SHEET
SHEET 2	SCHEDULE OF QUANTITIES
SHEET 3	TYPICAL SECTIONS
SHEET 4	DETAILS
SHEET 5-8	PLAN AND PROFILE
SHEET 9-13	CROSS SECTIONS

SUMMARY OF QUANTITIES

PAY CODE	PAY ITEM	UNITS	TOTAL QUANTITY
20200100	EARTH EXCAVATION	CU YD	163.0
25100630	EROSION CONTROL BLANKET	SQ YD	710.0
25200200	SUPPLEMENTAL WATERING	UNIT	21.0
35101400	AGGREGATE BASE COURSE, TYPE B	TON	69.0
40200800	AGGREGATE SURFACE COURSE, TYPE B	TON	11.0
42900200	PORTLAND CEMENT CONCRETE DRIVEWAY PAVEMENT 6 INCH	SQ YD	16.0
42400100	PORTLAND CEMENT CONCRETE SIDEWALK 4 INCH	SQ FT	2,803.0
42400300	PORTLAND CEMENT CONCRETE SIDEWALK 6 INCH	SQ FT	554.0
42400410	PORTLAND CEMENT CONCRETE SIDEWALK 8 INCH	SQ FT	115.0
42400800	DETECTABLE WARNINGS	SQ FT	40.0
44000200	DRIVEWAY PAVEMENT REMOVAL	SQ YD	135.0
44000600	SIDEWALK REMOVAL	SQ FT	102.0
50105220	PIPE CULVERT REMOVAL	FOOT	122.0
50300225	CONCRETE STRUCTURES	CU YD	7.0
60900205	REINFORCEMENT BARS EPOXY COATED	POUND	879.0
542D0211	PIPE CULVERTS, CLASS D, TYPE 1, 6"	FOOT	12.0
542D0215	PIPE CULVERTS, CLASS D, TYPE 1, 10"	FOOT	286.0
550A0050	STORM SEWERS, CLASS A, TYPE 1, 12"	FOOT	74.0
55100500	STORM SEWER REMOVAL 12"	FOOT	48.0
60238800	INLETS, TYPE A	EACH	2.0
60500060	REMOVING INLETS	EACH	3.0
87100100	MOBILIZATION	L.SUM	1.0
Z0004610	HOT-MIX ASPHALT DRIVEWAY PAVEMENT, 3"	SQ YD	68.0
Z0007120	WELDED WIRE FABRIC 6X6	SQ YD	17.0
Z0013798	CONSTRUCTION LAYOUT	L.SUM	1.0
X2500900	SEEDING CLASS 1 SPECIAL	ACRE	0.15
X4240460	PORTLAND CEMENT CONCRETE SIDEWALK 8 INCH SPECIAL	SQ FT	1,089.0
X6023508	INLET TYPE A WITH SPECIAL FRAME AND GRATE	EACH	2.0
X9062400	CONCRETE GUTTER SPECIAL	FOOT	164.0
X7010216	TRAFFIC CONTROL AND PROTECTION (SPECIAL)	L.SUM	1.0

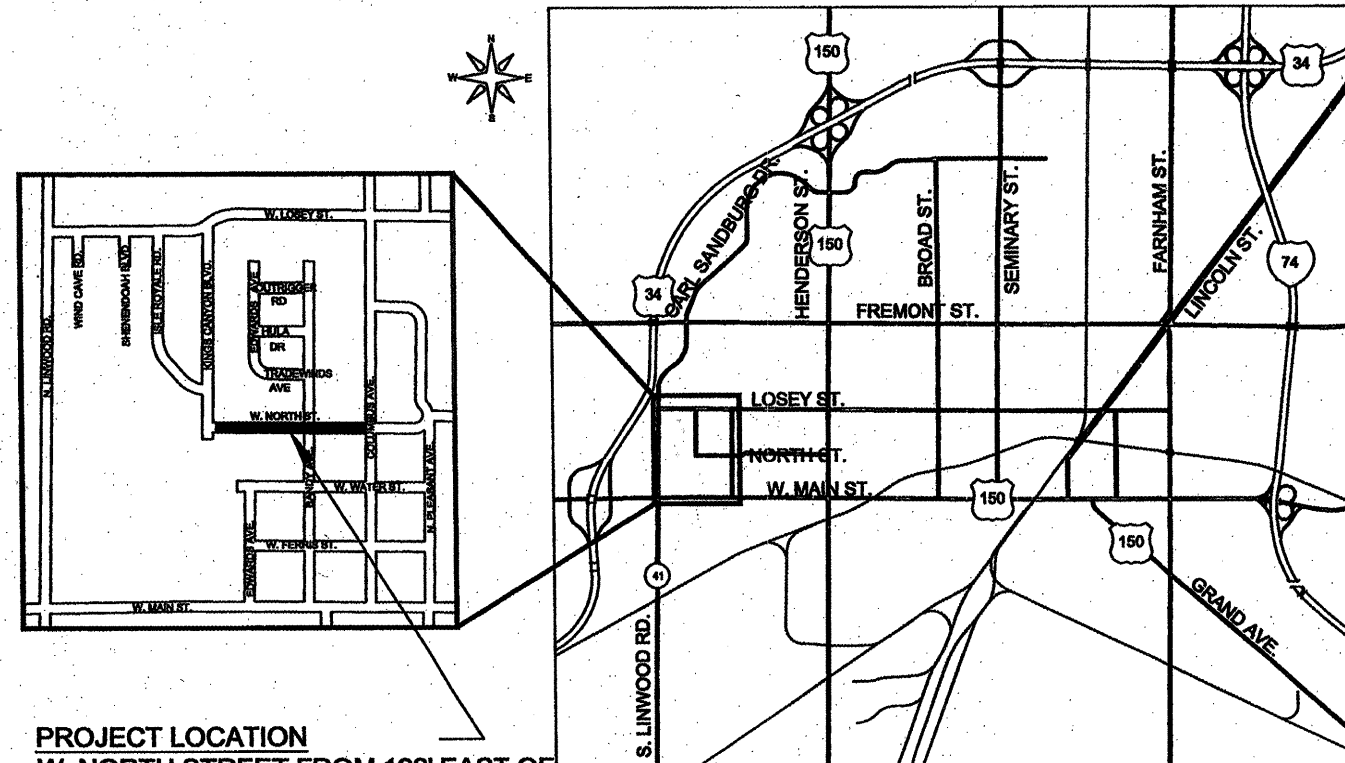

PROJECT LOCATION
W. NORTH STREET FROM 192' EAST OF
THE CENTERLINE OF KINGS CANYON BLVD.
TO THE WEST SIDE OF COLUMBUS AVE.

GENERAL LOCATION MAP
NOT TO SCALE

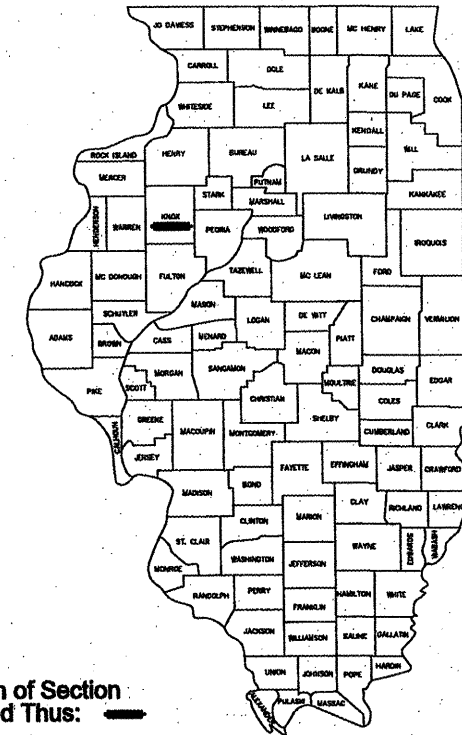

Location of Section Indicated Thus: —

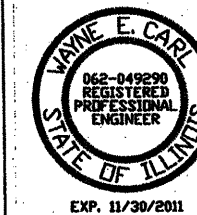

ENGINEERING DIVISION
CITY OF GALESBURG ILLINOIS
APPROVED 1/27 2011
Wayne E. Carl
LOCAL AGENCY OFFICIAL

PASSED 01/27 2011
[Signature]
DISTRICT ENGINEER OF LOCAL ROADS & STREETS

RELEASING FOR BID
BASED ON LIMITED
REVIEW 01/27 2011
Joseph E. Crowe
DEPUTY DIRECTOR OF HIGHWAYS, REGION 3 ENGINEER
STATE OF ILLINOIS
DEPARTMENT OF TRANSPORTATION

TITLE SHEET
SAFE ROUTES TO SCHOOL
NORTH STREET SIDEWALK
SECTION 09-02201-24-SW
CONTRACT 89574
PROJECT # SRTS 4009(001)
JOB # C-40-073-09

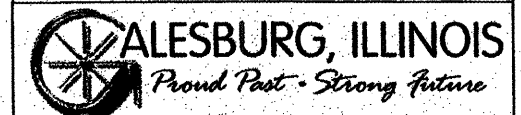

HIGHWAY STANDARDS

STD. NO.	DESCRIPTION
000001-06	STANDARD SYMBOLS, ABBREVIATIONS, AND PATTERNS
001001-02	AREAS OF REINFORCEMENT BARS
001006	DECIMAL OF AN INCH AND OF A FOOT
424001-05	CURB RAMPS FOR SIDEWALKS
602301-03	INLET - TYPE A
604036-02	GRATE TYPE 8
701501-06	URBAN LANE CLOSURE, 2L, 2W, UNDIVIDED
701901-01	TRAFFIC CONTROL DEVICES

Catalog # 034409-00

THIS PROJECT INCLUDES THE CONSTRUCTION OF A CONCRETE SIDEWALK ON THE SOUTH SIDE OF NORTH ST. THE SIDEWALK WILL BE 5' WIDE WITH ADA COMPLIANT RAMPS AND SLOPES. ALSO INCLUDED WILL BE CONSTRUCTION OF A CONCRETE CURB WALL FOR 198', DRIVEWAY PAVEMENT, EARTH EXCAVATION, PIPE CULVERT REMOVAL AND REPLACEMENT, AND MINOR STORM SEWER WORK INCLUDING INLETS.

SCHEDULE OF QUANTITIES

CONTRACT #	SECTION #	TOTAL SHEETS	SHEET NO.
89574	09-02201-24-SW	13	2

20200100	
EARTH EXCAVATION	
ENTIRE PROJECT	163.0 CU YD
TOTAL 163.0 CU YD	
25100630	
EROSION CONTR BLANKET	
STA. 20+14 - 25+22	428.4 SQ YD
STA. 25+65 - 29+20	281.2 SQ YD
TOTAL 710.0 SQ YD	
25200200	
SUPPLEMENTAL WATERING	
ENTIRE PROJECT (10 WATERINGS)	21.3 UNITS
TOTAL 21.0 UNITS	
35101400	
AGG BASE CSE B	
STA. 20+14 RT	352.0 SQ FT
STA. 20+82 RT	118.0 SQ FT
STA. 21+05 RT	538.0 SQ FT
STA. 22+12 RT	104.5 SQ FT
STA. 22+33 RT	78.0 SQ FT
STA. 22+49 RT	155.5 SQ FT
STA. 22+80 RT	1,158.0 SQ FT
STA. 25+12 RT	25.0 SQ FT
STA. 25+68 RT	287.5 SQ FT
STA. 26+20 RT	104.5 SQ FT
STA. 26+40 RT	154.5 SQ FT
STA. 26+71 RT	71.0 SQ FT
STA. 26+86 RT	197.5 SQ FT
STA. 27+25 RT	1,089.0 SQ FT
STA. 29+22 RT	57.0 SQ FT
STA. 29+22 LT	69.6 SQ FT
STA. 22+65 RT	21.6 SQ YD
STA. 26+30 RT	25.7 SQ YD
STA. 26+75 RT	20.4 SQ YD
TOTAL 69.0 TONS	
40200800	
AGG SURF CSE B	
STA. 20+94 RT	6.1 TON
STA. 22+25 RT	4.8 TON
TOTAL 11.0 TON	
42300200	
PCC DRIVEWAY PAVT 6	
STA. 20+95 RT	11.5 SQ YD
STA. 22+25 RT	4.0 SQ YD
TOTAL 16.0 SQ YD	
42400100	
PC CONC SIDEWALK 4	
STA. 20+14 RT	334.5 SQ FT
STA. 21+05 RT	538.0 SQ FT
STA. 22+33 RT	78.0 SQ FT
STA. 22+80 RT	1,158.0 SQ FT
STA. 25+68 RT	260.5 SQ FT
STA. 26+40 RT	154.5 SQ FT
STA. 26+88 RT	197.5 SQ FT
STA. 29+22 RT	32.0 SQ FT
STA. 29+22 LT	49.6 SQ FT
TOTAL 2,803.0 SQ FT	
42400300	
PC CONC SIDEWALK 6	
STA. 20+82 RT	118.0 SQ FT
STA. 22+12 RT	104.5 SQ FT
STA. 22+49 RT	155.5 SQ FT
STA. 26+20 RT	104.5 SQ FT
STA. 26+71 RT	71.0 SQ FT
TOTAL 554.0 SQ FT	

42400410	
PC CONC SIDEWALK 8	
STA. 20+14 RT	17.5 SQ FT
STA. 25+12 RT	25.0 SQ FT
STA. 25+68 RT	27.0 SQ FT
STA. 29+22 RT	25.0 SQ FT
STA. 29+22 LT	20.0 SQ FT
TOTAL 115.0 SQ FT	
42400800	
DETECTABLE WARNINGS	
STA. 20+14 RT	8.0 SQ FT
STA. 25+12 RT	8.0 SQ FT
STA. 25+68 RT	8.0 SQ FT
STA. 29+22 RT	8.0 SQ FT
STA. 29+22 LT	8.0 SQ FT
TOTAL 40.0 SQ FT	
44000200	
DRIVE PAVEMENT REM	
STA. 20+95 RT	23.0 SQ YD
STA. 22+25 RT	10.5 SQ YD
STA. 22+65 RT	36.4 SQ YD
STA. 26+30 RT	36.5 SQ YD
STA. 26+75 RT	29.0 SQ YD
TOTAL 135.0 SQ YD	
44000600	
SIDEWALK REM	
STA. 29+22 LT	69.6 SQ FT
STA. 29+22 RT	32.0 SQ FT
TOTAL 102.0 SQ FT	
50105220	
PIPE CULVERT REMOV	
STA. 20+81 RT	26.1 FT
STA. 21+43 RT	12.0 FT
STA. 22+12 RT	21.3 FT
STA. 22+49 RT	23.0 FT
STA. 26+19 RT	20.0 FT
STA. 26+70 RT	20.0 FT
TOTAL 122.0 FT	
50300225	
CONC STRUCT	
STA. 27+25 - 27+50 RT	0.5 CU YD
STA. 27+50 - 27+75 RT	0.7 CU YD
STA. 27+75 - 28+50 RT	2.7 CU YD
STA. 28+50 - 29+00 RT	2.2 CU YD
STA. 29+00 - 29+23 RT	0.6 CU YD
TOTAL 7.0 CU YD	
50800205	
REINFORCEMENT BARS EPOXY COATED	
STA. 27+25 RT	879.0 POUNDS
TOTAL 879.0 POUNDS	
542D0211	
P CUL CL D 1 6	
STA. 26+50 RT	12.0 FT
TOTAL 12.0 FT	
542D0215	
P CUL CL D 1 10	
STA. 22+09 RT	242.0 FT
STA. 26+18 RT	22.0 FT
STA. 26+70 RT	22.0 FT
TOTAL 286.0 FT	
550A0050	
STORM SEW CL A 1 12	
STA. 24+50 RT	50.0 FT
STA. 25+00 RT	16.0 FT
STA. 26+00 RT	8.0 FT
TOTAL 74.0 FT	

55100500	
STORM SEWER REM 12	
STA. 24+52 RT	48.0 FT
TOTAL 48.0 FT	
60238800	
INLETS TA	
STA. 25+56 RT	1.0 EACH
STA. 26+00 RT	1.0 EACH
TOTAL 2.0 EACH	
60500060	
REMOV INLETS	
STA. 24+52 RT	1.0 EACH
STA. 25+00 RT	1.0 EACH
STA. 25+96 RT	1.0 EACH
TOTAL 3.0 EACH	
67100100	
MOBILIZATION	
ENTIRE PROJECT	1.0 L.SUM
TOTAL 1.0 L.SUM	
Z0004510	
HMA DRIVEWAY PAVT 3	
STA. 22+65 RT	21.6 SQ YD
STA. 26+30 RT	25.7 SQ YD
STA. 26+75 RT	20.4 SQ YD
TOTAL 68.0 SQ YD	
Z0007120	
WELDED WIRE FABRIC 6X6	
STA. 22+49 RT	17.3 SQ YD
TOTAL 17.0 SQ YD	
Z0013798	
CONSTRUCTION LAYOUT	
ENTIRE PROJECT	1.0 L.SUM
TOTAL 1.0 L.SUM	
X2500900	
SEEDING CLASS 1 SPECIAL	
ENTIRE PROJECT	0.15 ACRES
TOTAL 0.15 ACRES	
X4240460	
PC CONC SIDEWALK 8 SP	
STA. 27+25 - 29+23 RT	1,089.0 SQ FT
TOTAL 1,089.0 SQ FT	
X6023508	
INLET TA W/ SPL F&G	
STA. 24+50 RT	1.0 EACH
STA. 25+00 RT	1.0 EACH
TOTAL 2.0 EACH	
X6062400	
CONCRETE GUTTER SPECIAL	
STA. 23+50 RT	164.2 FT
TOTAL 164.0 FT	
X7010216	
TRAF CONT & PROT SPL	
ENTIRE PROJECT	1.0 L.SUM
TOTAL 1.0 L.SUM	

SCHEDULE OF QUANTITIES

SAFE ROUTES TO SCHOOL
NORTH STREET SIDEWALK
SECTION 09-02201-24-SW
CONTRACT 89574
PROJECT # SRTS 4009(001)
JOB # C-40-073-09



ALESBURG, ILLINOIS
Proud Past • Strong Future

Proposed Typical Sections

North Street from 192' east of Kings Canyon Blvd. to Columbus Ave.

Not to Scale

CONTRACT #	SECTION #	TOTAL SHEETS	SHEET NO.
89574	09-02201-24-SW	13	3

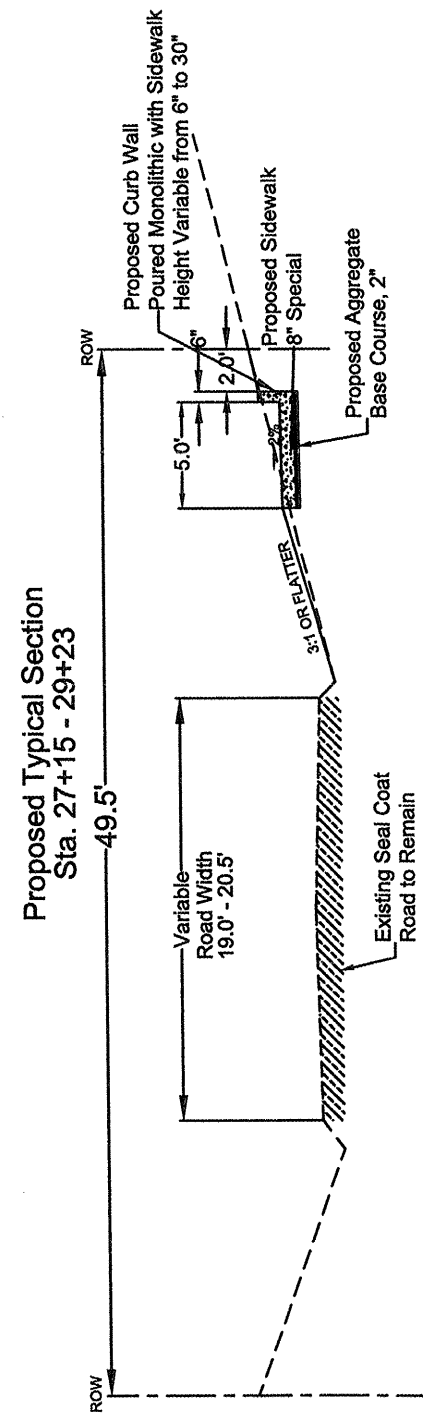
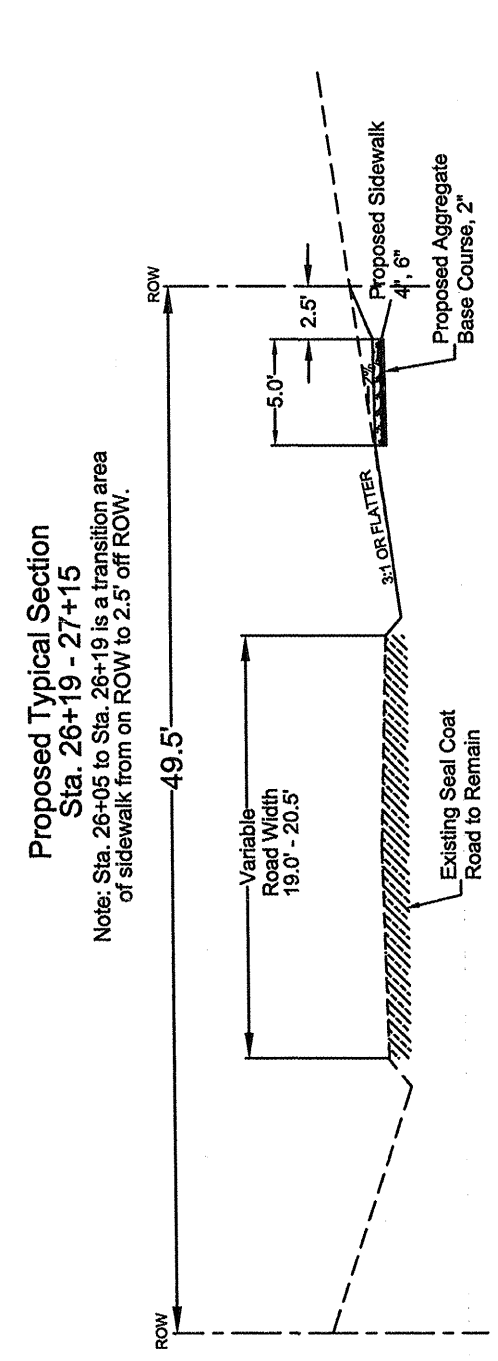
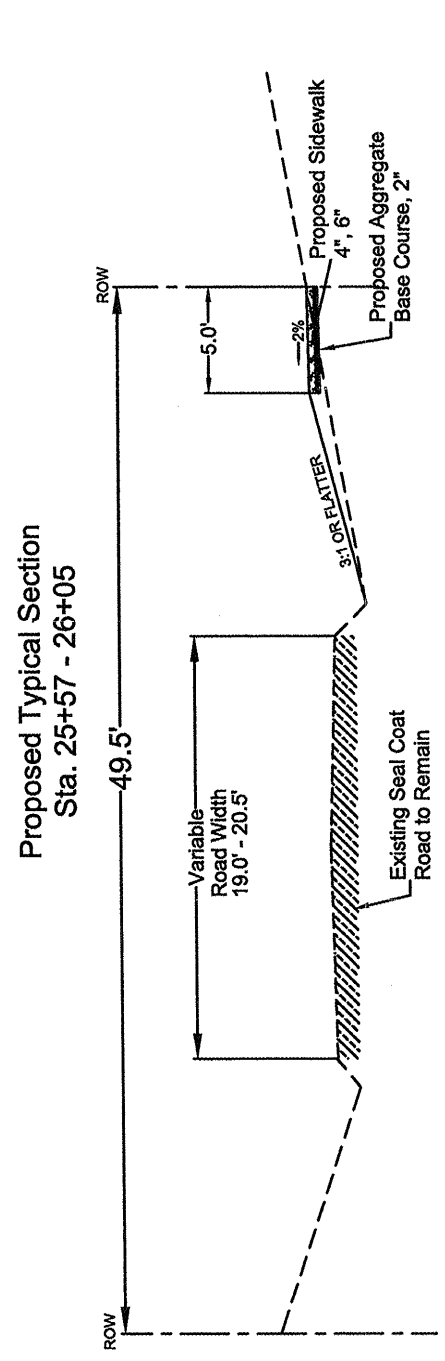
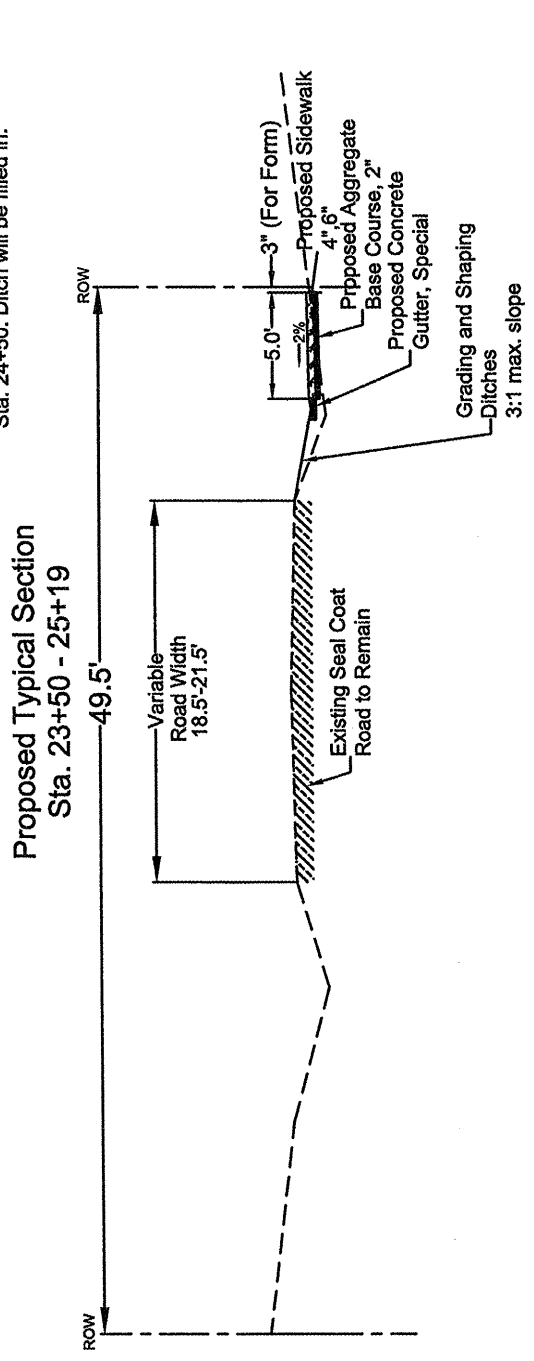
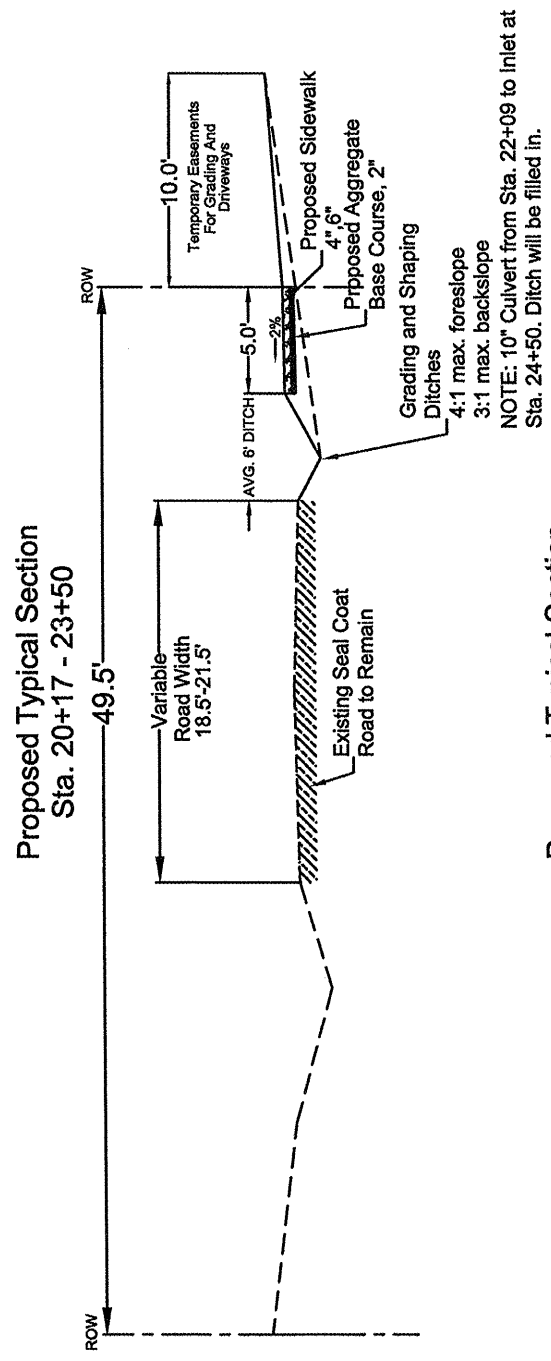

Safe Routes to School

North Street Typical Sections
SECTION # 09-02201-24-SW
PROJECT # SRTS 4009 (001)
CONTRACT 89574
JOB # C-40-073-09



ALESBURG, ILLINOIS
Proud Past • Strong Future

CONTRACT #	SECTION #	TOTAL SHEETS	SHEET NO.
89574	09-02201-24-SW	13	4

Curb Wall Height Detail

Start at Sta. 27+25

NOT TO SCALE

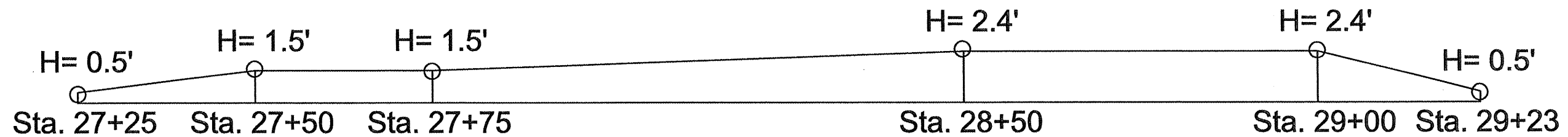

1. All curb wall heights are from the top of sidewalk.
2. All curb wall is to be paid for as "Concrete Structures" and is to be paid for by the Cubic Yard.
3. See the "PCC Sidewalk 8" (Special) Detail for more information.

PCC Sidewalk 8" (Special) Detail

NOT TO SCALE

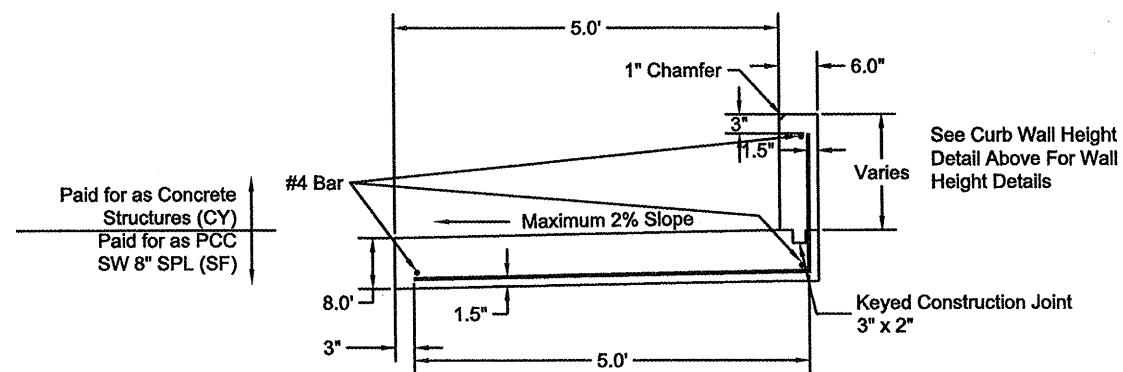

- Proposed PCC Curb Wall Detail**
1. All reinforcement bars shall be #4 and L Bars and shall be placed 24" on center.
 2. A keyed construction joint shall be required if the curb and the sidewalk are not poured monolithically.
 3. All reinforcement bars shall be epoxy coated.

Concrete Gutter Special

NOT TO SCALE

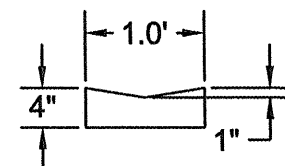

See Special Provisions for More Information

Safe Routes to School

North Street Details
SECTION # 09-02201-24-SW
PROJECT # SRTS 4009 (001)
CONTRACT 89574
JOB # C-40-073-09



CONTRACT #	SECTION #	TOTAL SHEETS	SHEET NO.
89574	09-02201-24-SW	13	5

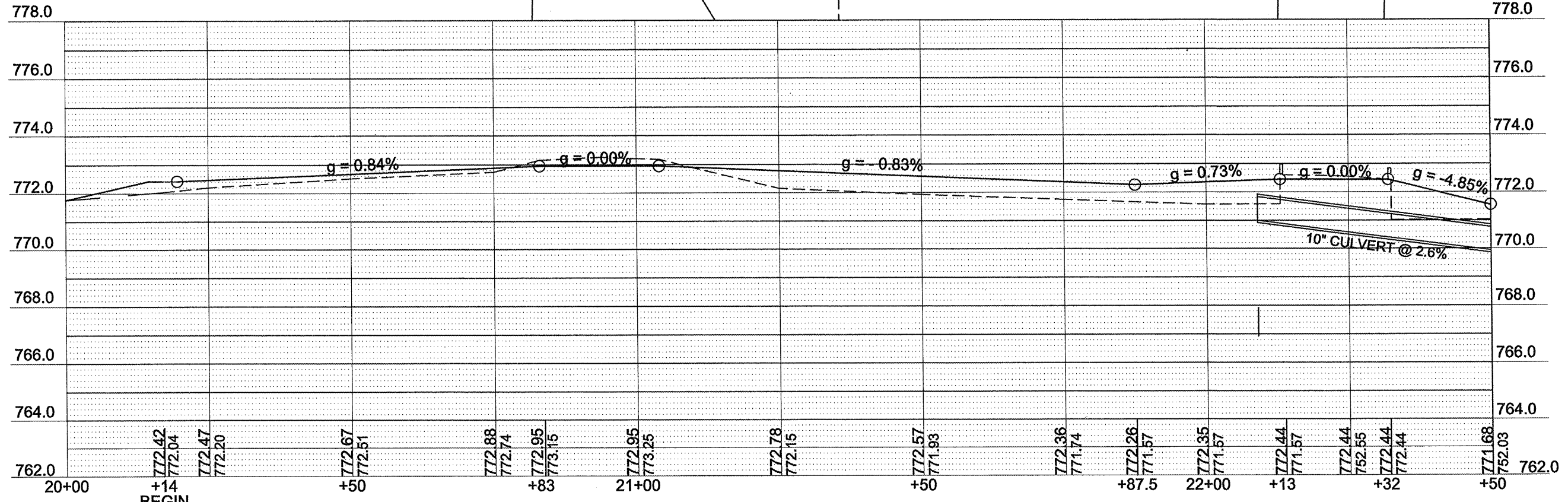
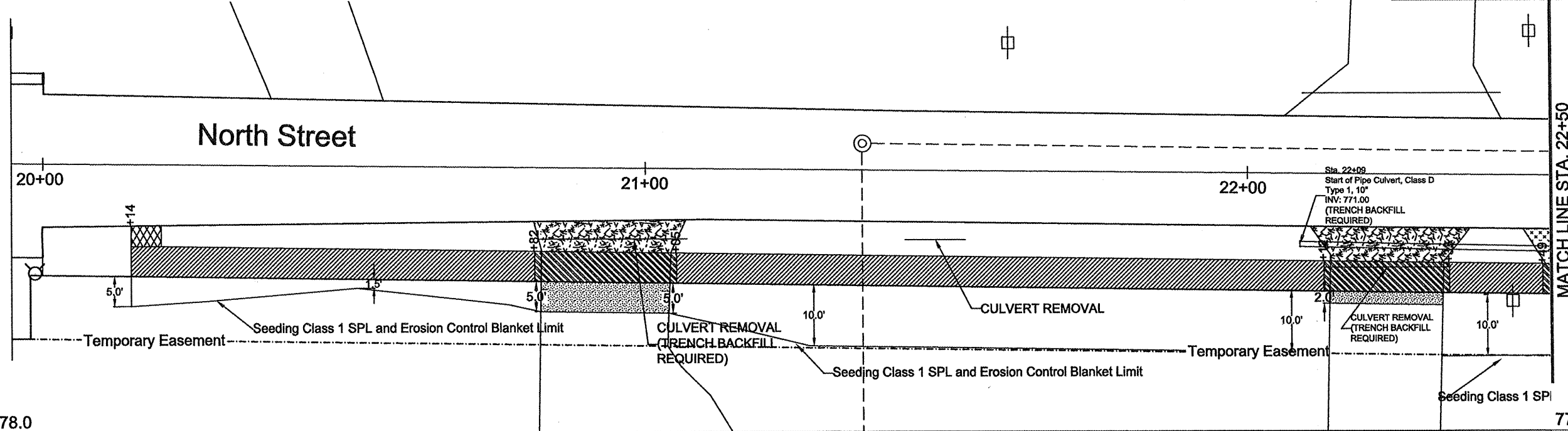

LEGEND

	PCC SIDEWALK 4'		PCC SIDEWALK 8'		DRIVEWAY PVT REMOVAL & PCC DRIVEWAY PVT, 6'		AGG SURFACE COURSE		CONCRETE GUTTER
	DRIVEWAY PVT REMOVAL & PCC SIDEWALK		PCC SIDEWALK 8' (SPL)		DRIVEWAY PVT REMOVAL & HMA DRIVEWAY PVT, 8'		CONCRETE STRUCTURES		

PLAN & PROFILE SHEET - STA.20+00 - 22+50

SAFE ROUTES TO SCHOOL
 SECTION # 09-02201-24-SW
 PROJECT # SRTS 4009 (001)
 CONTRACT 89574
 JOB # C-40-073-09



CONTRACT #	SECTION #	TOTAL SHEETS	SHEET NO.
89574	09-02201-24-SW	13	6

MATCH LINE STA. 22+50

MATCH LINE STA. 25+25

North Street

NOTE: CONCRETE COLLARS WILL BE REQUIRED TO CONNECT EXISTING STORM SEWER TO A PROPOSED INLET AND TO CONNECT PROPOSED STORM SEWER TO EXISTING STORM SEWER. THESE CONNECTIONS SHALL BE TO THE SATISFACTION OF THE ENGINEER, AND INCIDENTAL TO STORM SEWER CONSTRUCTION.

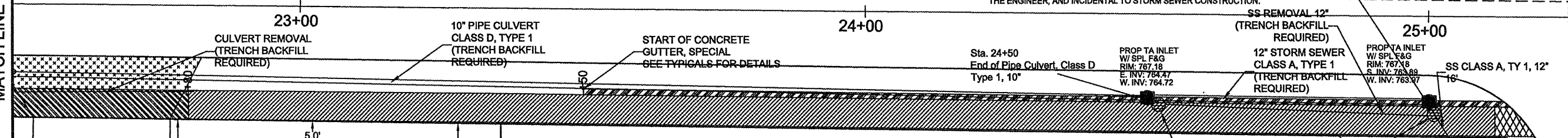

Seeding Class 1 SPL and Erosion Control Blanket Limit is at ROW. Contractor shall not work off ROW.

INLET REMOVAL (TRENCH BACKFILL REQUIRED)

Existing Easement

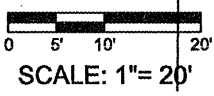

LEGEND

- PCC SIDEWALK
- PCC SIDEWALK
- DRIVEWAY PVT REMOVAL & PVT DRIVEWAY
- AGG SURFACE COURSE
- CONCRETE GUTTER
- DRIVEWAY PVT REMOVAL & PCC SIDEWALK
- PCC SIDEWALK w/ (SPL)
- DRIVEWAY PVT REMOVAL & PCC SIDEWALK
- CONCRETE STRUCTURES

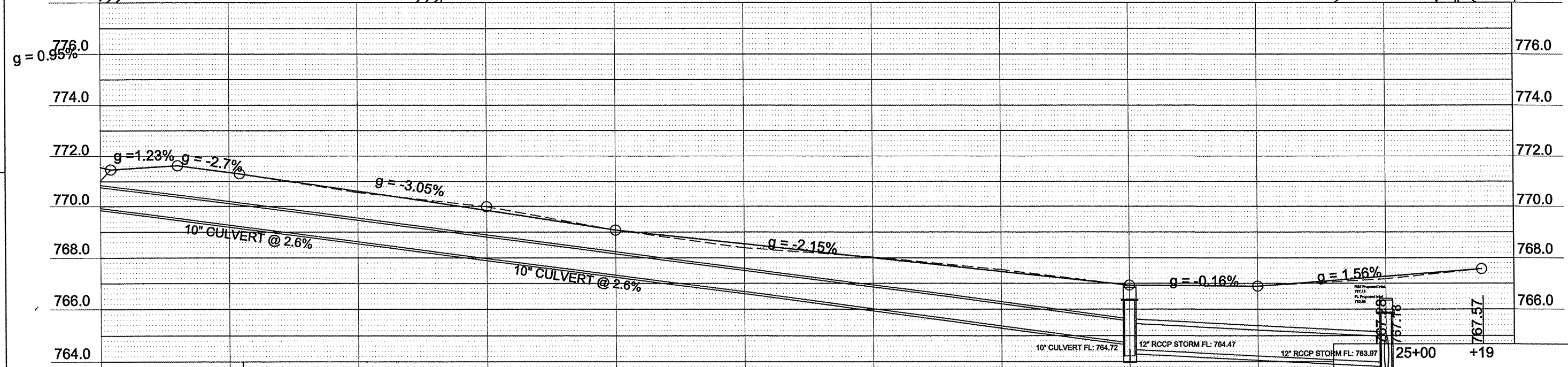

PLAN & PROFILE SHEET - STA. 22+50 - 25+25
 SAFE ROUTES TO SCHOOL
 SECTION # 09-02201-24-SW
 PROJECT # SRTS 4009 (001)
 CONTRACT 89574
 JOB # C-40-073-09



CONTRACT #	SECTION #	TOTAL SHEETS	SHEET NO.
89574	09-02201-24-SW	13	7

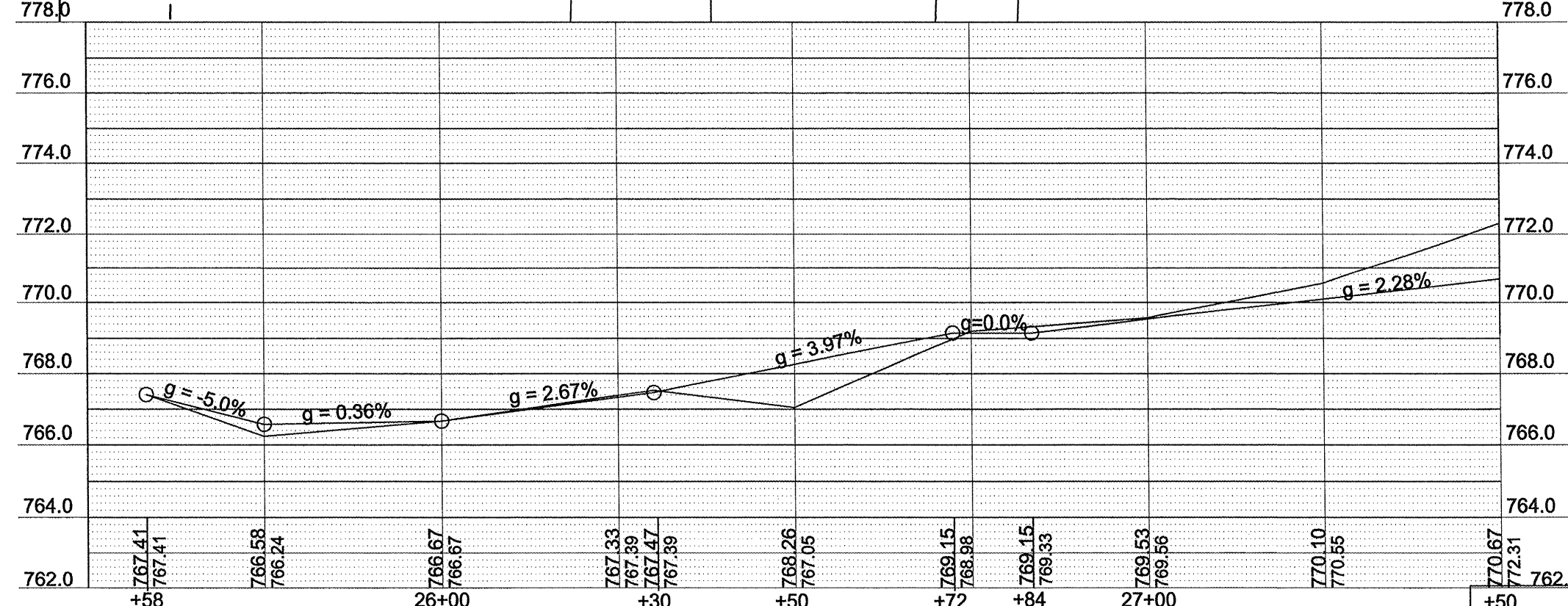
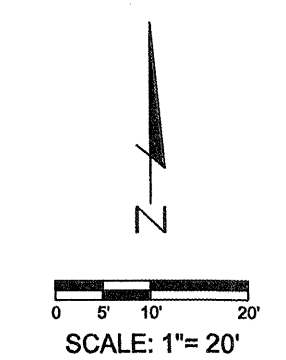
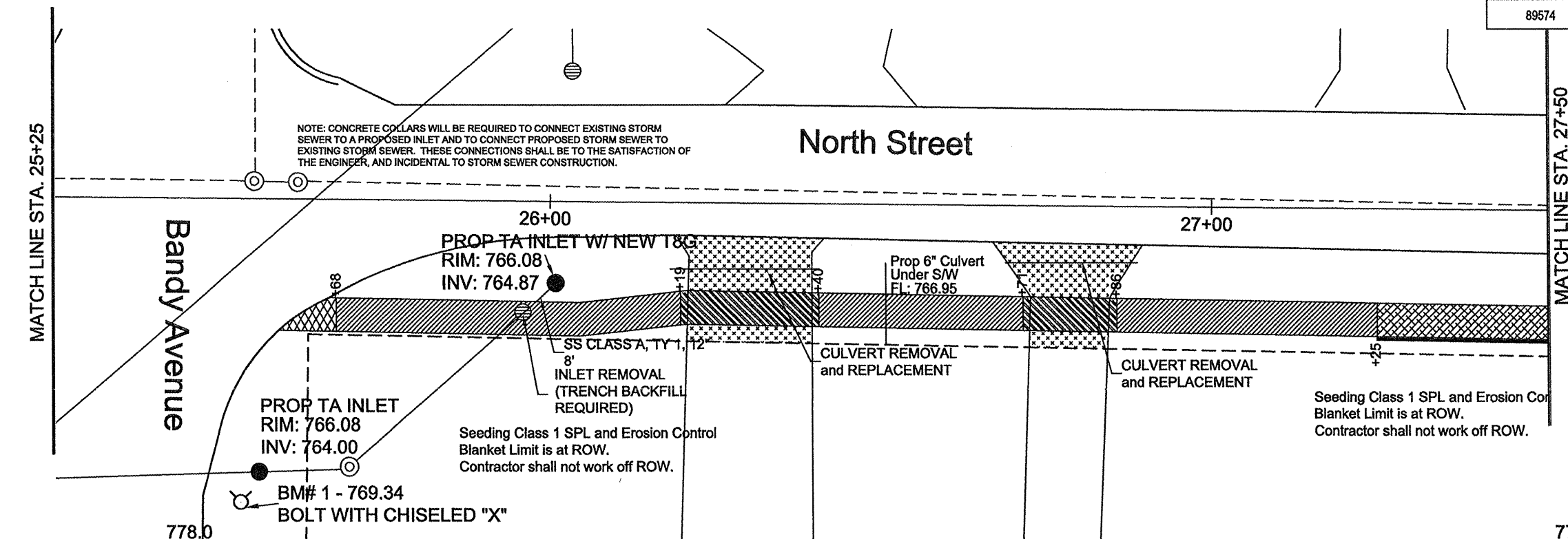

LEGEND

PCC SIDEWALK 4"	PCC SIDEWALK 8"	DRIVEWAY PVT REMOVAL & PCC DRIVEWAY PVT, 8"	AGG SURFACE COURSE	CONCRETE GUTTER
DRIVEWAY PVT REMOVAL & PCC SIDEWALK, 6"	PCC SIDEWALK 8" (SPL)	DRIVEWAY PVT REMOVAL & PCC DRIVEWAY PVT, 6"	CONCRETE STRUCTURES	

+50
PLAN & PROFILE SHEET - STA. 25+25 - 27+50

SAFE ROUTES TO SCHOOL
SECTION # 09-02201-24-SW
PROJECT # SRTS 4009 (001)
CONTRACT 89574
JOB # C-40-073-09

ALESBURG, ILLINOIS
Proud Past • Strong Future

CONTRACT #	SECTION #	TOTAL SHEETS	SHEET NO.
89574	09-02201-24-SW	13	8

MATCH LINE STA. 27+50

North Street

Columbus Avenue

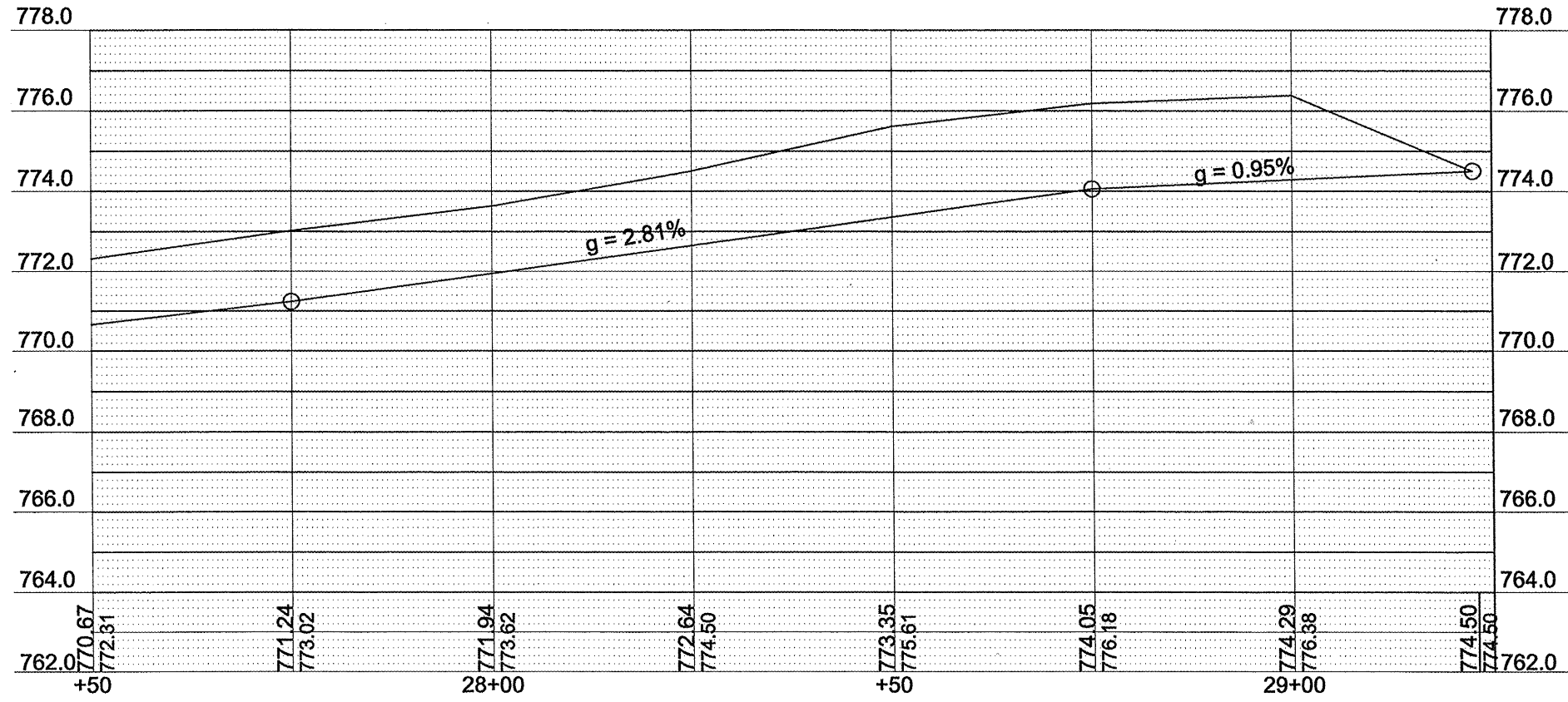
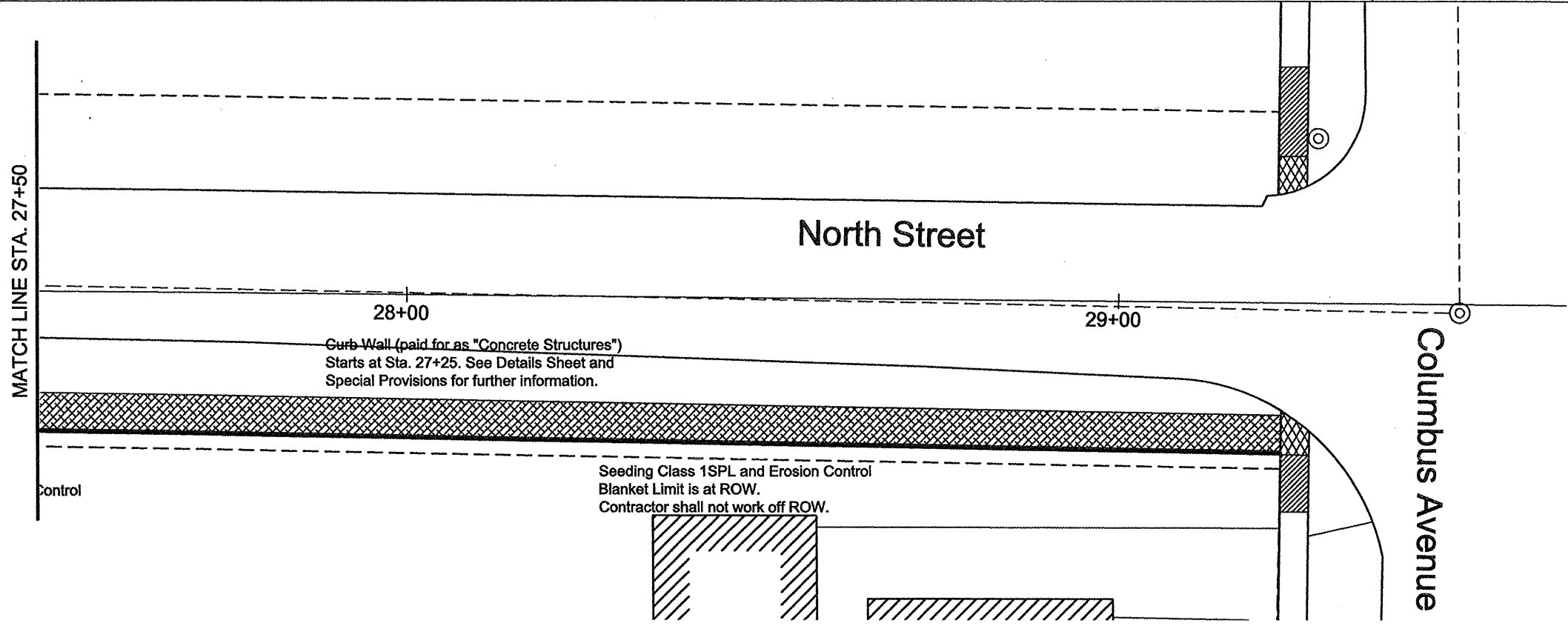

LEGEND

PCC SIDEWALK 4"	PCC SIDEWALK 8"	DRIVEWAY PVT REMOVAL & PCC DRIVEWAY PVT, 6"	AGG SURFACE COURSE	CONCRETE GUTTER
DRIVEWAY PVT REMOVAL & PCC SIDEWALK	PCC SIDEWALK 8" (SPL)	DRIVEWAY PVT REMOVAL & HMA DRIVEWAY PVT, 3"	CONCRETE STRUCTURES	

PLAN & PROFILE SHEET - 27+50 - 29+23

SAFE ROUTES TO SCHOOL
SECTION # 09-02201-24-SW
PROJECT # SRTS 4009 (001)
CONTRACT 89574
JOB # C-40-073-09



CONTRACT #	SECTION #	TOTAL SHEETS	SHEET NO.
89574	09-02201-24-SW	13	9

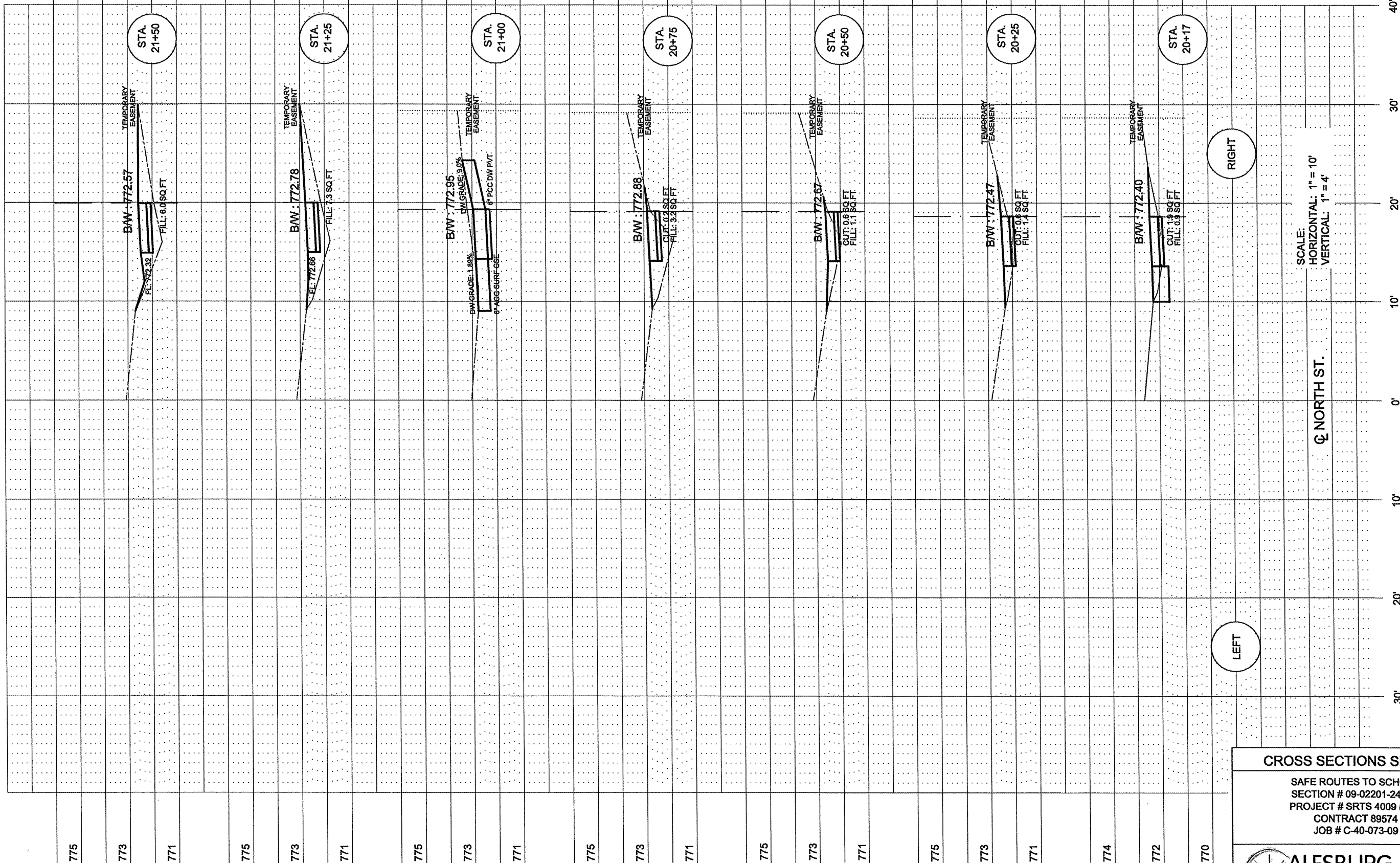

SCALE:
 HORIZONTAL: 1" = 10'
 VERTICAL: 1" = 4'

⊕ NORTH ST.

CROSS SECTIONS SHEET 1

SAFE ROUTES TO SCHOOL
 SECTION # 09-02201-24-SW
 PROJECT # SRTS 4009 (001)
 CONTRACT 89574
 JOB # C-40-073-09



CONTRACT #	SECTION #	TOTAL SHEETS	SHEET NO.
89574	09-02201-24-SW	13	10

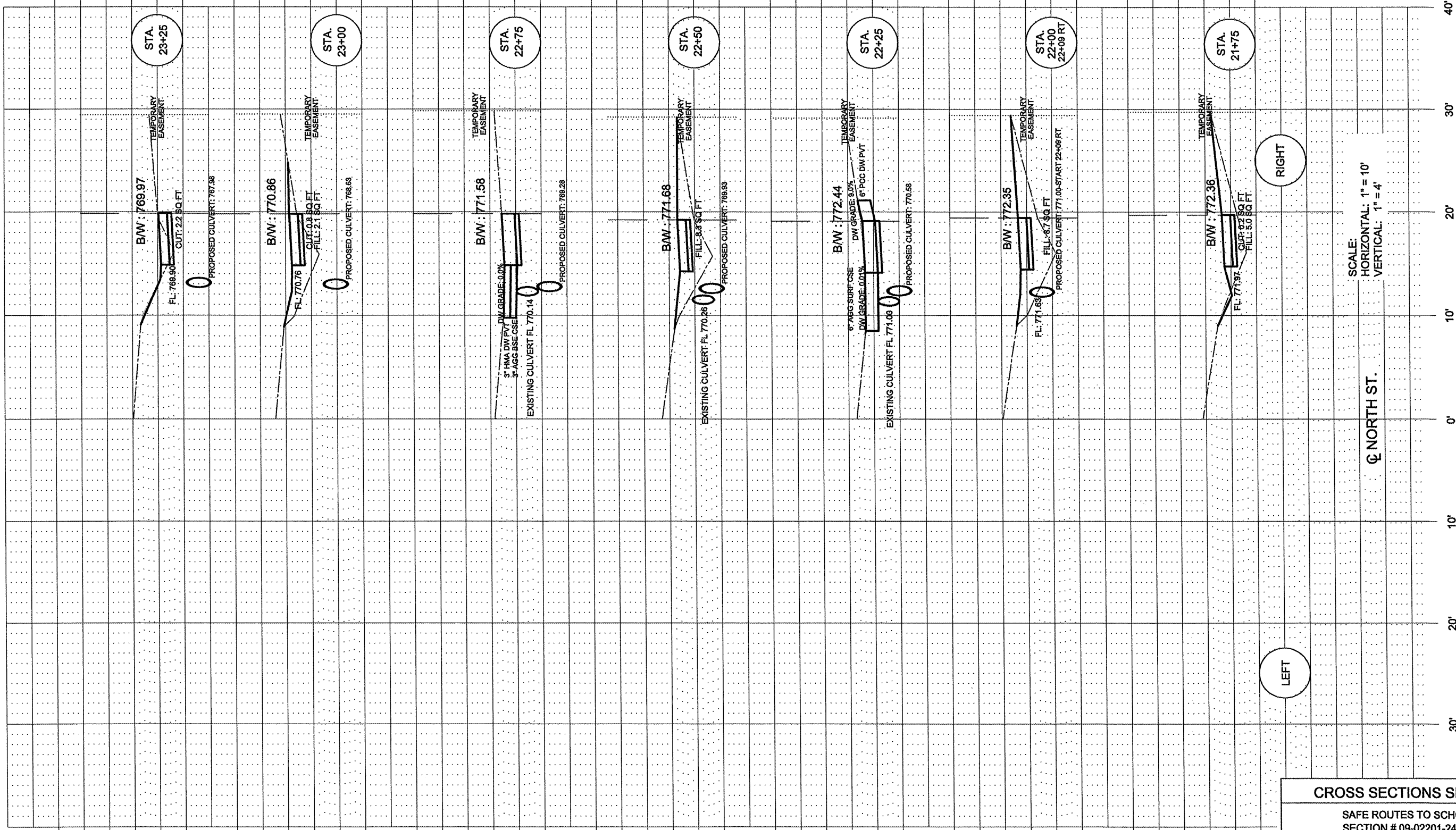

SCALE:
HORIZONTAL: 1" = 10'
VERTICAL: 1" = 4'

CROSS SECTIONS SHEET 2

SAFE ROUTES TO SCHOOL
SECTION # 09-02201-24-SW
PROJECT # SRTS 4009 (001)
CONTRACT 89574
JOB # C-40-073-09



CONTRACT #	SECTION #	TOTAL SHEETS	SHEET NO.
89574	09-02201-24-SW	13	11

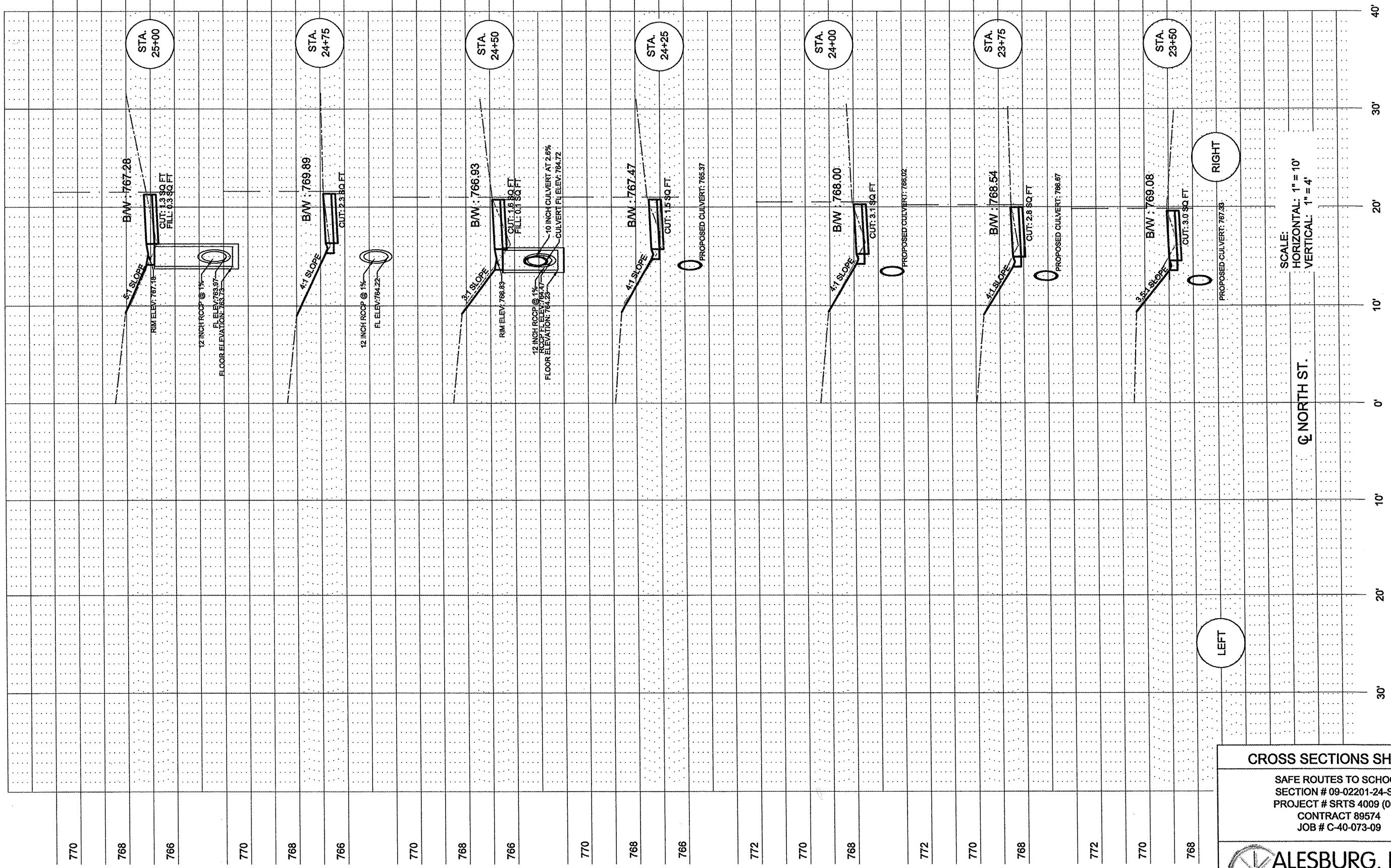

SCALE:
HORIZONTAL: 1" = 10'
VERTICAL: 1" = 4'

Q NORTH ST.

LEFT

RIGHT

CROSS SECTIONS SHEET 3

SAFE ROUTES TO SCHOOL
SECTION # 09-02201-24-SW
PROJECT # SRTS 4009 (001)
CONTRACT 89574
JOB # C-40-073-09



CONTRACT #	SECTION #	TOTAL SHEETS	SHEET NO.
89574	09-02201-24-SW	13	12

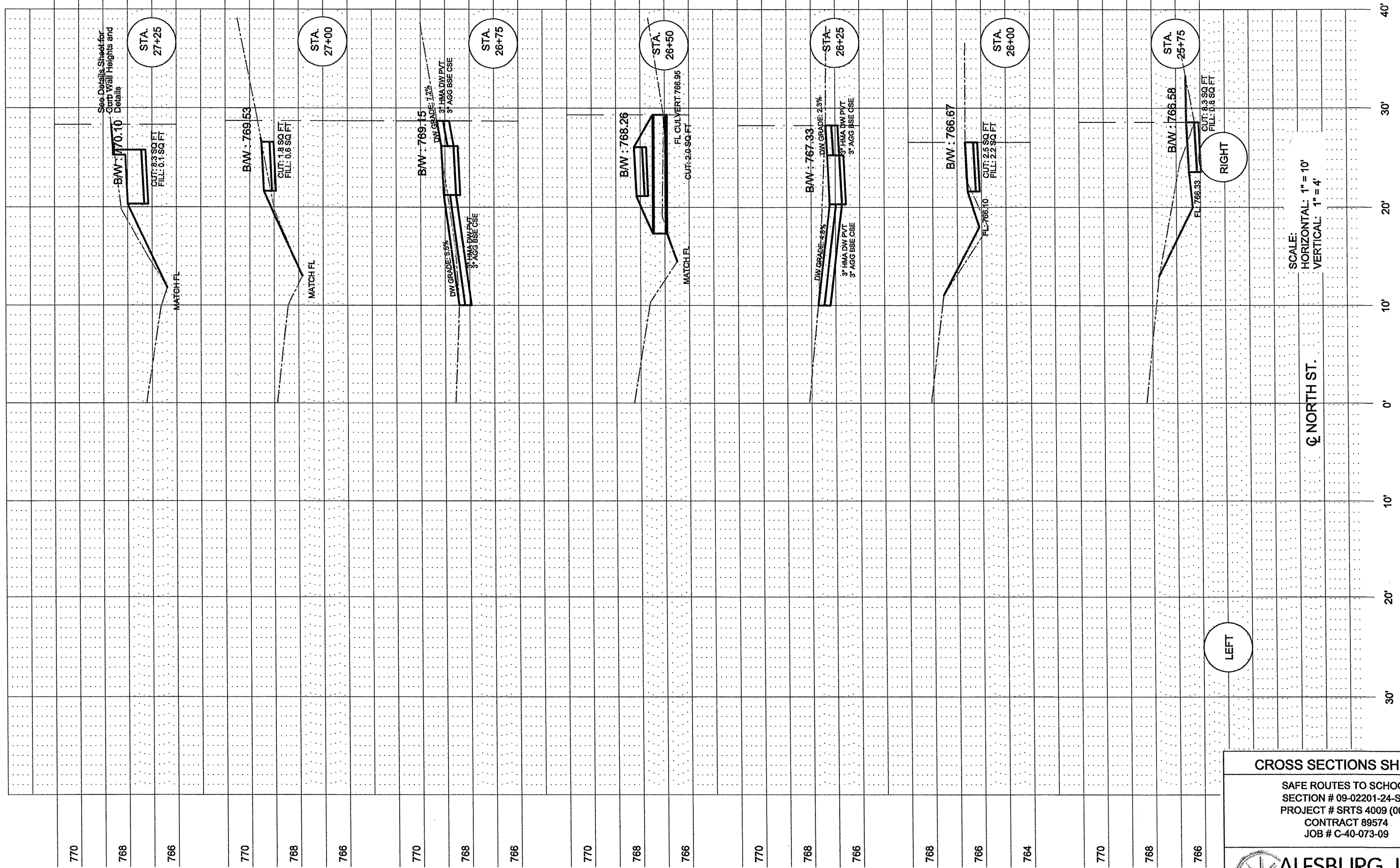

SCALE:
HORIZONTAL: 1" = 10'
VERTICAL: 1" = 4'

CROSS SECTIONS SHEET 4

SAFE ROUTES TO SCHOOL
SECTION # 09-02201-24-SW
PROJECT # SRTS 4009 (001)
CONTRACT 89574
JOB # C-40-073-09

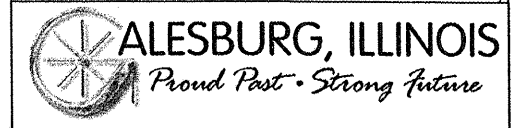

CONTRACT #	SECTION #	TOTAL SHEETS	SHEET NO.
89574	09-02201-24-SW	13	13

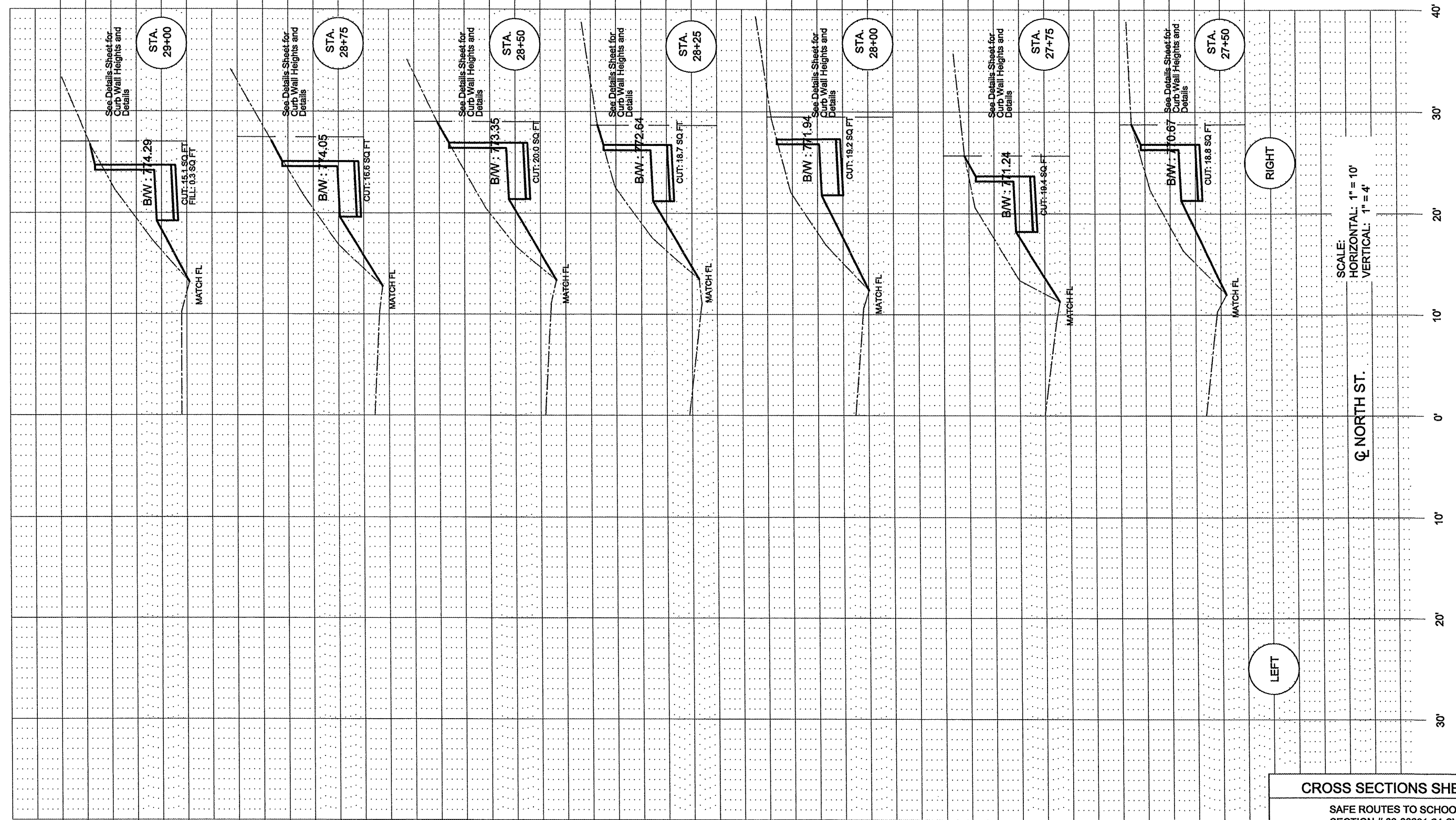

SCALE:
HORIZONTAL: 1" = 10'
VERTICAL: 1" = 4'

CROSS SECTIONS SHEET 5

SAFE ROUTES TO SCHOOL
SECTION # 09-02201-24-SW
PROJECT # SRTS 4009 (001)
CONTRACT 89574
JOB # C-40-073-09



777
775
773
777
775
773
776
774
772
774
772
770
773
771
769
773
771
769
772
770
768
766

40'
30'
20'
10'
0'
10'
20'
30'

RIGHT

LEFT

CL NORTH ST.