

**GENERAL NOTES**

1. RAISED AND CORRUGATED MEDIANS SHALL BE OUTLINED WITH [2] IF PRESENT.
  2. SOME OF THE INFORMATION INCLUDED WITH THIS DETAIL MAY NOT BE APPLICABLE TO THIS IMPROVEMENT.
  3. PAVEMENT MARKINGS ARE TO BE EXTENDED THROUGH OMISSIONS WHEN APPLICABLE.
  4. FINAL PAVEMENT MARKINGS SHALL BE IN PLACE PRIOR TO PLACING ANY RAISED REFLECTIVE PAVEMENT MARKERS.
  5. THE FOLLOWING CRITERIA SHALL BE USED FOR SELECTING THE DIAGONAL PAVEMENT MARKING SPACING:
- |                        |             |
|------------------------|-------------|
| < 30 MPH (< 50 km/h)   | 15' (4.5 m) |
| 30-45 MPH (50-75 km/h) | 20' (6.0 m) |
| > 45 MPH (> 75 km/h)   | 30' (9.0 m) |

**PAVEMENT MARKING LEGEND**

- |                                     |  |
|-------------------------------------|--|
| [1] 4" (100) SKIP-DASH (YELLOW)     |  |
| [2] 4" (100) SOLID (YELLOW)         |  |
| [3] 12" (300) DIAGONAL (YELLOW)     |  |
| [4] 4" (100) DOUBLE YELLOW (NARROW) |  |
| [5] RESERVED                        |  |
| [6] RESERVED                        |  |
| [7] 6" (150) SKIP-DASH (WHITE)      |  |
| [8] 4" (100) SOLID (WHITE)          |  |
| [9] 12" (300) DIAGONAL (WHITE)      |  |
| [10] 6" (150) SOLID (WHITE)         |  |
| [11] 24" (600) STOP BAR (WHITE)     |  |
| [12] 8" (200) SOLID (WHITE)         |  |
| [13] 6" (100) LANE LINE EXTENSIONS  |  |
| [14] 4" (100) PARKING WHITE         |  |

**RURAL LEFT TURN STRIPING**

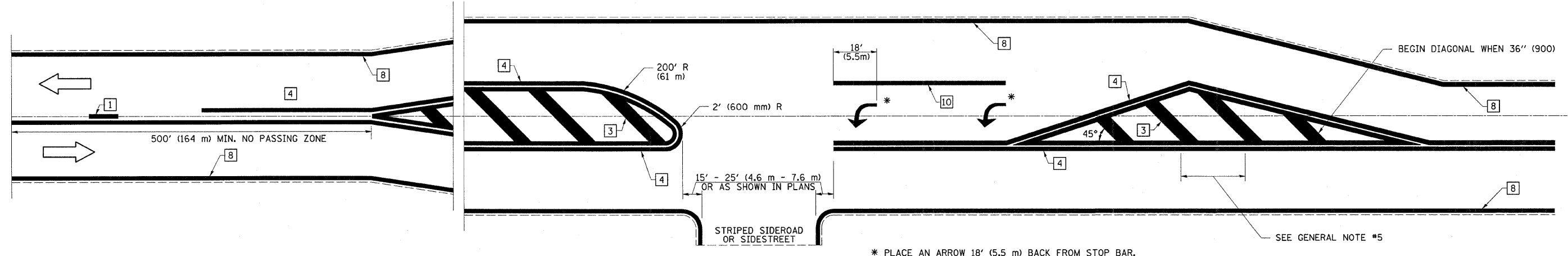

\* PLACE AN ARROW 18' (5.5 m) BACK FROM STOP BAR. PLACE ANOTHER ARROW EVEN WITH THE BEGINNING OF THE SOLID WHITE LINE. SPACE ADDITIONAL ARROWS EVENLY UP TO 80' (24.4 m) MAXIMUM SPACING. USE MINIMUM OF 2 ARROWS.

SEE GENERAL NOTE #5

NOT TO SCALE

Note: All dimensions are in INCHES (millimeters) unless otherwise shown.

**DISTRICT 7 DETAIL NO. 7800001**

FILE NAME =	USER NAME = swartzw	DESIGNED -	REVISED -	<b>STATE OF ILLINOIS DEPARTMENT OF TRANSPORTATION</b>	<b>PAVEMENT MARKING AND RAISED REFLECTIVE PAVEMENT MARKERS (RURAL &amp; URBAN APPLICATIONS)</b>	F.A.P. RTE.	SECTION	COUNTY	TOTAL SHEETS	SHEET NO.
c:\pwwork\pwwork\swartzw\dms56917\d79	978-shd-detail.dgn	DRAWN -	REVISED -			327	(2-2,3-2,51-23)RS-1	LAWRENCE	40	37
PLOT SCALE = 50.0000' / IN.	CHECKED -	REVISED -	CONTRACT NO. 94978							
PLOT DATE = 12/9/2010	DATE -	REVISED -	ILLINOIS FED. AID PROJECT							

SCALE: NA SHEET NO. 3 OF 4 SHEETS STA. TO STA.