

ROUTE	SECTION	COUNTY	TOTAL SHEETS	SHEET NO.
FAS 2818	01-00107-00-RS	WAYNE	8	6
CONTRACT NO. 95647		ILLINOIS		

PIPE CULVERT REMOVAL RT. STA. 533+43 TO 533+56	FOOT 16	EARTH EXCAVATION WIDENING STA. 532+91 TO 533+91	CU YD 36	PAVED DITCH REMOVAL RT. STA. 533+65	FOOT 14
CONCRETE HEADWALL REMOVAL RT. STA. 533+51	EACH 1	H.M.A. BASE CSE. WIDENING, 8" STA. 532+91 TO 533+91	SQ YD 144	H.M.A. SURF. REM., BUTT JOINT STA. 532+91 TO 533+91	SQ YD 386
TEMPORARY RAMP STA. 533+91	SQ YD 100	REM. & RE-ERECT EXIST. SIGN RT. STA. 533+55	EACH 1		

LOCATION	TY-1,12"	TY-1,18"	TR.B'FILL
1 TO 2			2.1
2 TO 3	5		2.1
4 TO 5		8	5.2
5 TO 7			2.6
7 TO 10			1.9
8 TO 9	3		2.1
TOTALS	8	8	16.0

NO.	DIST.	STA.	ITEM	GR.	INV.
1	47' RT.	533+66	EXISTING 18" PIPE CULVERT		500.75
2	41' RT.	533+66	R.C. PIPE TEE 18 P. 12 R.	503.45	500.35
3	42' RT.	533+59	INLET, TY-A W/TY-B GR.		500.65
4	35' RT.	533+65	R.C. PIPE ELBOW 45'		500.19
5	26' RT.	533+57	CONCRETE COLLAR		500.06
6	25' RT.	533+53	PIPE ELBOW 18" - 40'		500.03
7	24' RT.	533+51	CONCRETE COLLAR		500.00
8	30' RT.	533+47	INLET, TY-A W/TY-B GR.	503.10	500.27
9	24' RT.	533+47	R.C. PIPE TEE 18 P. 12 R.		499.97
10	24' RT.	533+43	EXISTING 18" PIPE CULVERT		499.95

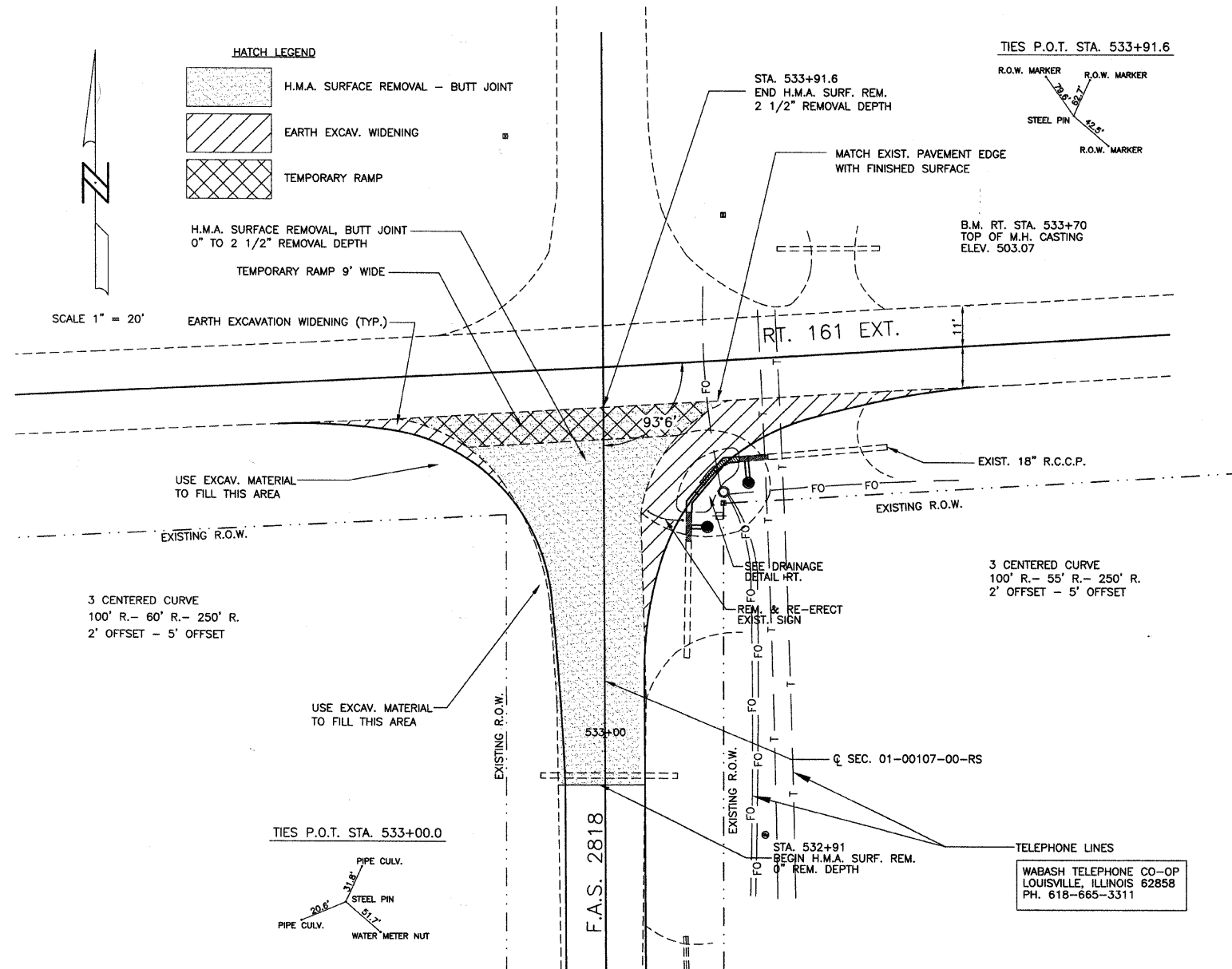

INTERSECTION DETAIL - RT. 161 EXT.

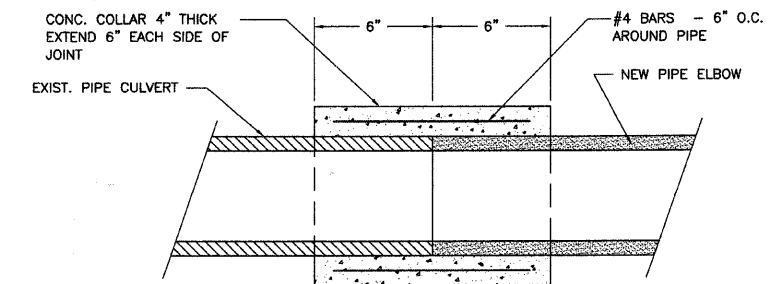

CONCRETE COLLAR DETAIL

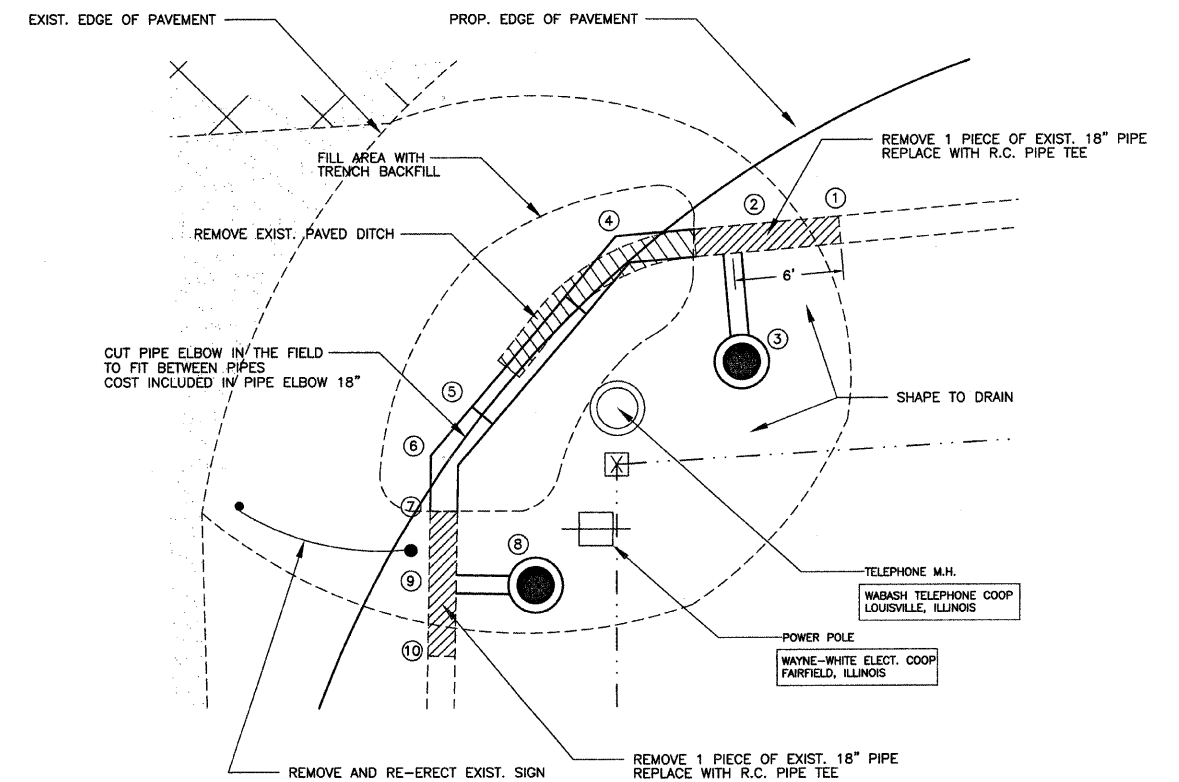

DRAINAGE DETAIL