

PROP. CURVE DTRRD-1
 PI STA. = 0+82.17
 $\Delta = 15^\circ 35' 48''$ (LT)
 $D = 9^\circ 32' 57''$
 $R = 600.00'$
 $T = 82.17'$
 $L = 163.33'$
 $E = 5.60'$
 P.C. STA. = 0+00.00
 P.T. STA. = 1+63.33

$L = 7112.32'$
 $E = 1,129.20'$
 P.C. STA. = 196+53.93
 P.T. STA. = 243+66.26

PROP. CURVE DTRRD-4
 PI STA. = 6+26.60
 $\Delta = 13^\circ 38' 20''$ (LT)
 $D = 9^\circ 32' 57''$
 $R = 600.00'$
 $T = 71.75'$
 $L = 142.83'$
 $E = 4.28'$
 P.C. STA. = 5+54.84
 P.T. STA. = 6+97.67

RUNAROUND SUPERELEVATION RATES	
STA. - STA.	S.E. (FT/FT)
0+00 - 1+10	0.030
2+36 - 2+51	0.030
2+87 - 4+39	0.015
4+75 - 4+83	0.030
6+15 - 6+97.67	0.030

- * TEMPORARY TBT, TYPE 6A
- ** ATTACH TEMPORARY SPBGR TO EXISTING SPBGR
- *** TEMPORARY TBT, TYPE 1 SPECIAL (FLARED)

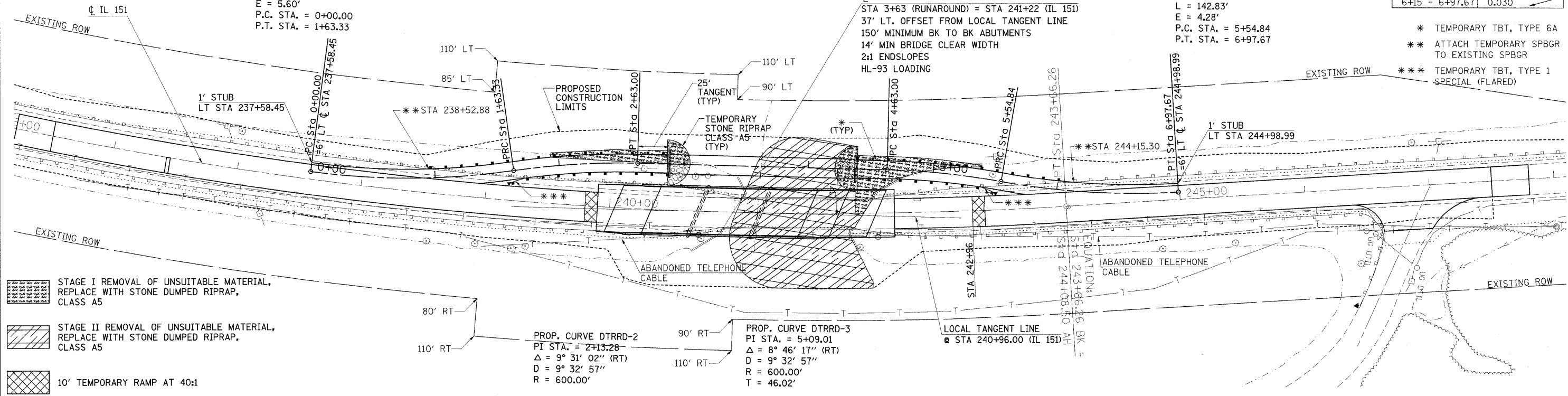

- STAGE I REMOVAL OF UNSUITABLE MATERIAL, REPLACE WITH STONE DUMPED RIPRAP, CLASS A5
- STAGE II REMOVAL OF UNSUITABLE MATERIAL, REPLACE WITH STONE DUMPED RIPRAP, CLASS A5
- 10' TEMPORARY RAMP AT 40:1

PLAN	SURVEYED	DATE
	PLOTTED	
	NOTED	
	CHECKED	
	NO.	

PROFI	SURVEYED	DATE
	PLOTTED	
	NOTED	
	CHECKED	
	NO.	

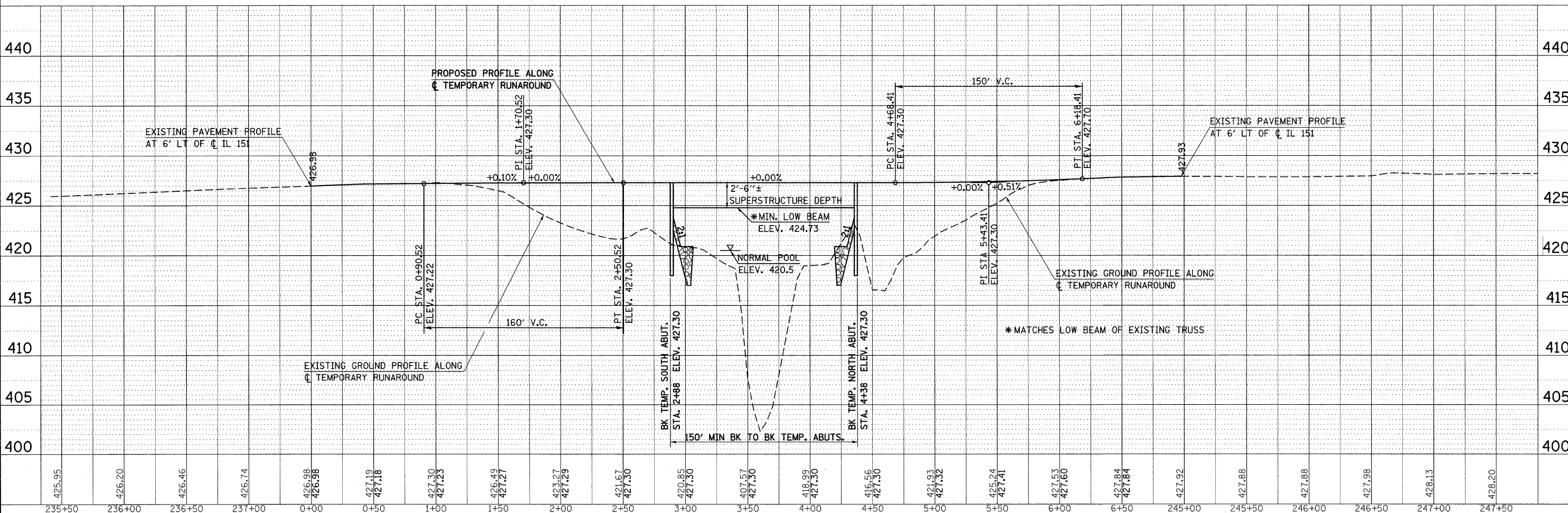

FILE NAME = c:\pwork\pwork\dickerson\m\dmr71840\020805_sht.sp\prpf.dgn

USER NAME = dickersonlm	DESIGNED -	REVISED -
PLOT SCALE = 48,0000' / IN.	DRAWN -	REVISED -
PLOT DATE = 12/15/2010	CHECKED -	REVISED -
	DATE -	REVISED -

**STATE OF ILLINOIS
 DEPARTMENT OF TRANSPORTATION**

TEMPORARY RUNAROUND PLAN AND PROFILE

SCALE: 1"=40'	SHEET NO.	OF SHEETS	STA.	TO STA.
---------------	-----------	-----------	------	---------

F.A.S. RTE. 1908	SECTION (13B)-2	COUNTY JACKSON	TOTAL SHEETS 71	SHEET NO. 8
FED. ROAD DIST. NO. ILLINOIS FED. AID PROJECT			CONTRACT NO. 98898	