

\* THE LAST 2 SECTIONS (25') OF THE PROPOSED GUARDRAIL SHALL BE FLARED TO MATCH INTO THE EXISTING TERMINAL.

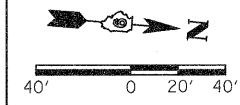
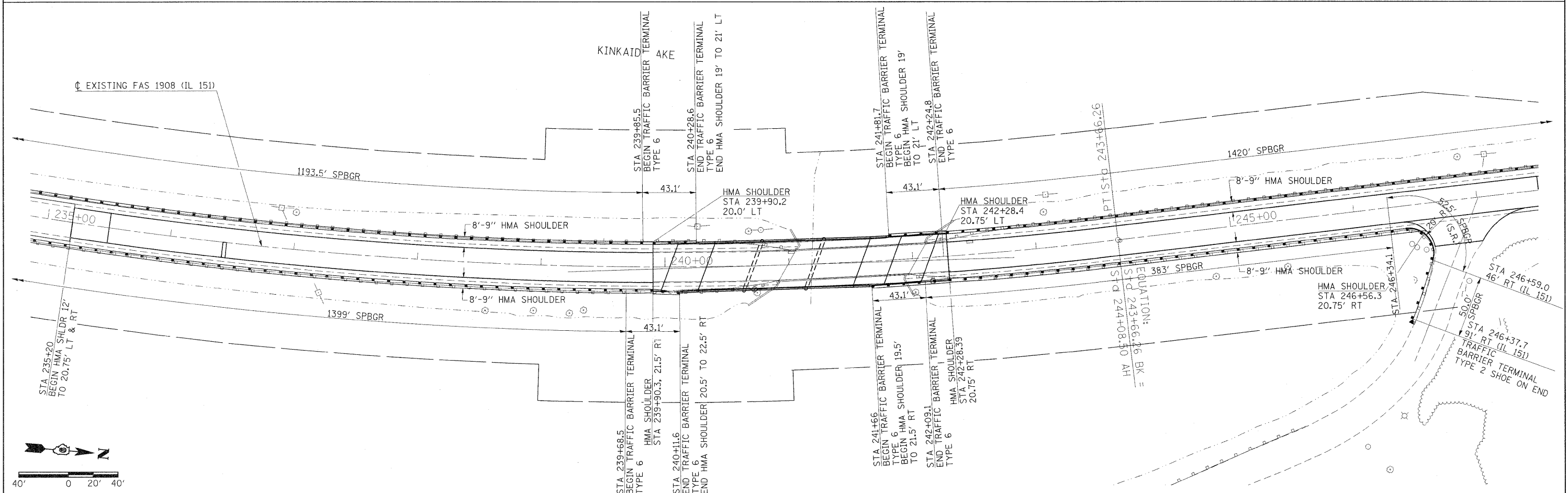
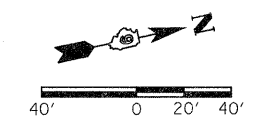

FILE NAME =	USER NAME = halsteadtw	DESIGNED -	REVISED -	<b>STATE OF ILLINOIS DEPARTMENT OF TRANSPORTATION</b>	<b>HMA SHOULDER AND GUARDRAIL LAYOUT</b>			F.A.S. RTE.	SECTION	COUNTY	TOTAL SHEETS	SHEET NO.
ci:\pw\work\p\wdot\halsteadtw\dms71840\98898-shr-misc.dgn		DRAWN -	REVISED -		1908	(13B1-2	JACKSON	71	11			
PLOT SCALE = 40,0000 ' / IN.		CHECKED -	REVISED -		SCALE: 1"=40'			CONTRACT NO. 98898				
PLOT DATE = 12/10/2010		DATE -	REVISED -		SHEET NO. OF SHEETS		STA. TO STA.		ILLINOIS FED. AID PROJECT			