

STATE OF ILLINOIS
DEPARTMENT OF TRANSPORTATION

FINAL

| F.A.P. RTE. | SECTION | COUNTY | TOTAL SHEETS | SHEET NO. |
|-------------|-------------|----------|--------------------|-----------|
| 311 | 2021-029-R5 | COOK | 42 | 1 |
| | | ILLINOIS | CONTRACT NO. 62N78 | |

THIS PROJECT IS LOCATED
IN THE CITY OF BERWYN
AND TOWN OF CICERO

FOR INDEX OF SHEETS AND STANDARDS, SEE SHEET NO. 2

PROPOSED
HIGHWAY PLANS

F.A.P. ROUTE 311 (OGDEN AVENUE)
IL 43 (HARLEM AVENUE) TO 50TH AVENUE
SECTION 2021-029-RS
PROJECT NHPP-V217(559)
SMART OVERLAY AND ADA IMPROVEMENTS
COOK COUNTY
C-91-151-21

DESIGN DESIGNATION
OGDEN AVENUE
OTHER PRINCIPAL ARTERIAL

2018 ADT =
27,800 (HARLEM AVE TO OAK PARK AVE)
26,000 (OAK PARK AVE TO RIDGELAND AVE)
20,400 (RIDGELAND AVE TO CENTRAL AVE)
23,200 (CENTRAL AVE TO 50TH AVE)

POSTED AND DESIGN SPEED LIMIT =
30 MPH (HARLEM AVE TO 59TH AVE)
40 MPH (59TH AVE TO 50TH AVE)

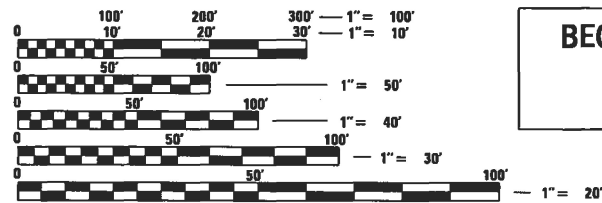

FULL SIZE PLANS HAVE BEEN PREPARED USING STANDARD
ENGINEERING SCALES. REDUCED SIZED PLANS WILL NOT
CONFORM TO STANDARD SCALES. IN MAKING MEASUREMENTS
ON REDUCED PLANS, THE ABOVE SCALES MAY BE USED.

J.U.L.I.E
JOINT UTILITY LOCATION INFORMATION FOR EXCAVATORS
1-800-892-0123
OR 811

PROJECT ENGINEER: LUKASZ POCIECHA, PE (847) 705-4255
PROJECT MANAGER: FAWAD AQUEEL, PE, PTOE (847) 705-4211

CONTRACT NO. 62N78

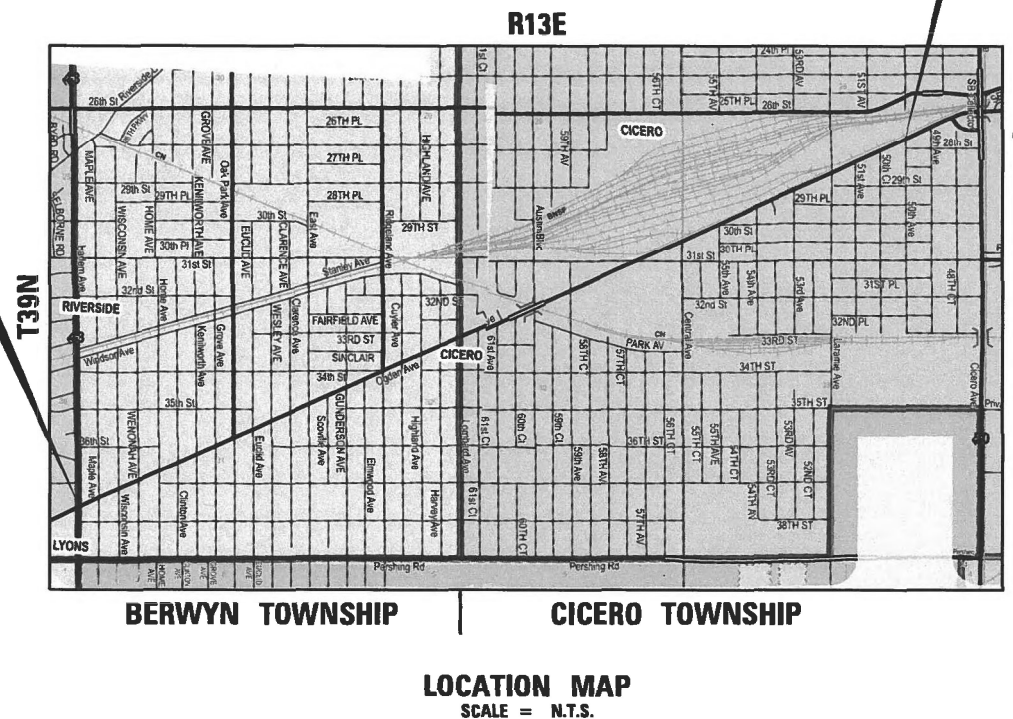

END IMPROVEMENTS
OGDEN AVE
STA. 176+29



BY: Eric Neuman DATE: 12/10/2021
HDR, INC.
DWGS: 1-47
LICENSE EXPIRES NOV. 30, 2023

STATE OF ILLINOIS
DEPARTMENT OF TRANSPORTATION

SUBMITTED December 20 21

Eric Neuman REGIONAL ENGINEER

February 4 20 22
Eric Neuman ENGINEER OF DESIGN AND ENVIRONMENT

February 4 20 22
Stephen M. Smith DIRECTOR OF HIGHWAYS PROJECT IMPLEMENTATION

PRINTED BY THE AUTHORITY
OF THE STATE OF ILLINOIS

PROJECT LENGTH (GROSSNET) = 16,052 FT (3.04 MILES)

HDR
HDR, Inc.
DESIGN FIRM REGISTRATION NUMBER 184.001070
9450 W. Bryn Mawr Ave., Suite 400
Chicago, IL 60618
773-380-7900

MODEL: 2D MODEL
 FILE NAME: P:\ghp\hds\csc01\HDR_US_Centex\01\Documents\1\DOT\DOT_Pls II Spec_Various TO s_199-15\DOT_PTB_199-15_T02_Ogden\6.0 CAD_BIM\6.2 WIP\6.2.3 CADD StreetRoadway\SUMMARY OF QUANTITIES

| CODE NO. | DESCRIPTION | UNIT | TOTAL QUANTITY URBAN | 0005 80% FED 20% STATE | 0005 100% STATE |
|----------|--|-------|----------------------|------------------------|-----------------|
| 20100110 | TREE REMOVAL (6 TO 15 UNITS DIAMETER) | UNIT | 89 | 89 | |
| 20100210 | TREE REMOVAL (OVER 15 UNITS DIAMETER) | UNIT | 23 | 23 | |
| 20101300 | TREE PRUNING (1 TO 10 INCH DIAMETER) | EACH | 1 | 1 | |
| 20101350 | TREE PRUNING (OVER 10 INCH DIAMETER) | EACH | 49 | 49 | |
| 20200100 | EARTH EXCAVATION | CU YD | 175.0 | 175.0 | |
| 20201200 | REMOVAL AND DISPOSAL OF UNSUITABLE MATERIAL | CU YD | 19 | 19 | |
| 21101615 | TOPSOIL FURNISH AND PLACE, 4" | SQ YD | 90 | 90 | |
| 25000750 | MOWING | ACRE | 0.2 | 0.2 | |
| 25003210 | INTERSEEDING, CLASS 2A | ACRE | 0.2 | 0.2 | |
| 25200110 | SODDING, SALT TOLERANT | SQ YD | 90 | 90 | |
| 25200200 | SUPPLEMENTAL WATERING | UNIT | 1 | 1 | |
| 28000510 | INLET FILTERS | EACH | 110 | 110 | |
| 30300001 | AGGREGATE SUBGRADE IMPROVEMENT | CU YD | 18 | 18 | |
| 30300112 | AGGREGATE SUBGRADE IMPROVEMENT 12" | SQ YD | 137 | 137 | |
| 31101200 | SUBBASE GRANULAR MATERIAL, TYPE B 4" | SQ YD | 308 | 308 | |
| 35400425 | PORTLAND CEMENT CONCRETE BASE COURSE WIDENING 9 1/4" | SQ YD | 137 | 137 | |
| 40600275 | BITUMINOUS MATERIALS (PRIME COAT) | POUND | 307 | 307 | |
| 40600290 | BITUMINOUS MATERIALS (TACK COAT) | POUND | 51,502 | 51,502 | |
| 40600370 | LONGITUDINAL JOINT SEALANT | FOOT | 47,714 | 47,714 | |
| 40600400 | MIXTURE FOR CRACKS, JOINTS, AND FLANGWAYS | TON | 64 | 64 | |
| 40600982 | HOT-MIX ASPHALT SURFACE REMOVAL - BUTT JOINT | SQ YD | 924 | 924 | |
| 40604172 | POLYMERIZED HOT-MIX ASPHALT SURFACE COURSE, IL-9.5, MIX "E", N70 | TON | 11,196 | 11,196 | |
| 42001300 | PROTECTIVE COAT | SQ YD | 394 | 394 | |
| 42300400 | PORTLAND CEMENT CONCRETE DRIVEWAY PAVEMENT, 8 INCH | SQ YD | 86 | 86 | |
| 42400200 | PORTLAND CEMENT CONCRETE SIDEWALK 5 INCH | SQ FT | 3,361 | 3,361 | |

| CODE NO. | DESCRIPTION | UNIT | TOTAL QUANTITY URBAN | 0005 80% FED 20% STATE | 0005 100% STATE |
|------------|---|--------|----------------------|------------------------|-----------------|
| 42400800 | DETECTABLE WARNINGS | SQ FT | 267 | 267 | |
| 44000156 | HOT-MIX ASPHALT SURFACE REMOVAL, 1 3/4" | SQ YD | 113,939 | 113,939 | |
| 44000200 | DRIVEWAY PAVEMENT REMOVAL | SQ YD | 76 | 76 | |
| 44000500 | COMBINATION CURB AND GUTTER REMOVAL | FOOT | 1,755 | 1,755 | |
| 44000600 | SIDEWALK REMOVAL | SQ FT | 3,338 | 3,338 | |
| 44201761 | CLASS D PATCHES, TYPE I, 10 INCH | SQ YD | 5 | 5 | |
| 44201765 | CLASS D PATCHES, TYPE II, 10 INCH | SQ YD | 1,507 | 1,507 | |
| 44201769 | CLASS D PATCHES, TYPE III, 10 INCH | SQ YD | 662 | 662 | |
| 44201771 | CLASS D PATCHES, TYPE IV, 10 INCH | SQ YD | 352 | 352 | |
| 60252800 | CATCH BASINS TO BE RECONSTRUCTED | EACH | 12 | 12 | |
| 60262700 | INLETS TO BE RECONSTRUCTED | EACH | 2 | 2 | |
| 60300305 | FRAMES AND LIDS TO BE ADJUSTED | EACH | 30 | 30 | |
| 60404800 | FRAMES AND GRATES, TYPE 11 | EACH | 2 | 2 | |
| 60406000 | FRAMES AND LIDS, TYPE 1, OPEN LID | EACH | 7 | 7 | |
| 60406100 | FRAMES AND LIDS, TYPE 1, CLOSED LID | EACH | 10 | 10 | |
| 60603800 | COMBINATION CONCRETE CURB AND GUTTER, TYPE B-6.12 | FOOT | 1,755 | 1,755 | |
| * 66900200 | NON-SPECIAL WASTE DISPOSAL | CU YD | 185 | 185 | |
| * 66900530 | SOIL DISPOSAL ANALYSIS | EACH | 5 | 5 | |
| * 66901001 | REGULATED SUBSTANCES PRE-CONSTRUCTION PLAN | L SUM | 1 | 1 | |
| * 66901003 | REGULATED SUBSTANCES FINAL CONSTRUCTION REPORT | L SUM | 1 | 1 | |
| * 66901006 | REGULATED SUBSTANCES MONITORING | CAL DA | 30 | 30 | |
| 67100100 | MOBILIZATION | L SUM | 1 | 1 | |
| 70102625 | TRAFFIC CONTROL AND PROTECTION, STANDARD 701606 | L SUM | 1 | 1 | |
| 70102630 | TRAFFIC CONTROL AND PROTECTION, STANDARD 701601 | L SUM | 1 | 1 | |
| * 70102632 | TRAFFIC CONTROL AND PROTECTION, STANDARD 701602 | L SUM | 1 | 1 | |

LEGEND

* - DENOTES SPECIALTY ITEM



HDR
 9450 W. BRYN MAWR AVE.
 ROSEMONT, IL 60018

| | | |
|------------------------------|-------------------|-----------|
| USER NAME = MMICZEK | DESIGNED - MM | REVISED - |
| | DRAWN - HL | REVISED - |
| PLOT SCALE = 200.0000' / in. | CHECKED - EN | REVISED - |
| PLOT DATE = 10/1/2021 | DATE - 12/10/2021 | REVISED - |

**STATE OF ILLINOIS
 DEPARTMENT OF TRANSPORTATION**

**SUMMARY OF QUANTITIES
 OGDEN AVE. - IL 43 (HARLEM AVE. TO 50TH AVE.)**

SCALE: N.T.S. SHEET 1 OF 2 SHEETS STA. TO STA.

| | | | | |
|---------------------------|-------------|--------|--------------|-----------|
| F.A.P. RTE. | SECTION | COUNTY | TOTAL SHEETS | SHEET NO. |
| 311 | 2021-029-R5 | COOK | 42 | 3 |
| CONTRACT NO. 62N78 | | | | |
| ILLINOIS FED. AID PROJECT | | | | |

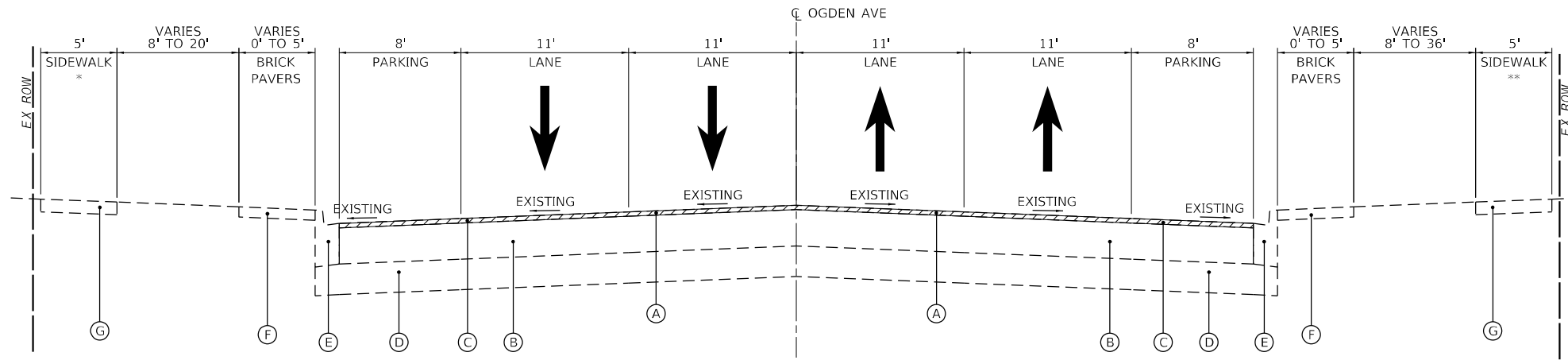

EXISTING LEGEND

- (A) EXISTING HOT-MIX ASPHALT SURFACE COURSE
- (B) EXISTING HOT-MIX ASPHALT BINDER/BASE COURSE
- (C) HOT-MIX ASPHALT SURFACE REMOVAL, 1.75"
- (D) EXISTING SUBBASE GRANULAR MATERIAL, TYPE B
- (E) EXISTING CONCRETE CURB & GUTTER
- (F) EXISTING BRICK PAVERS
- (G) EXISTING PORTLAND CEMENT CONCRETE SIDEWALK 5 INCH
- (H) EXISTING HOT-MIX ASPHALT MEDIAN SURFACE, 4 INCH
- (I) EXISTING CORRUGATED MEDIAN

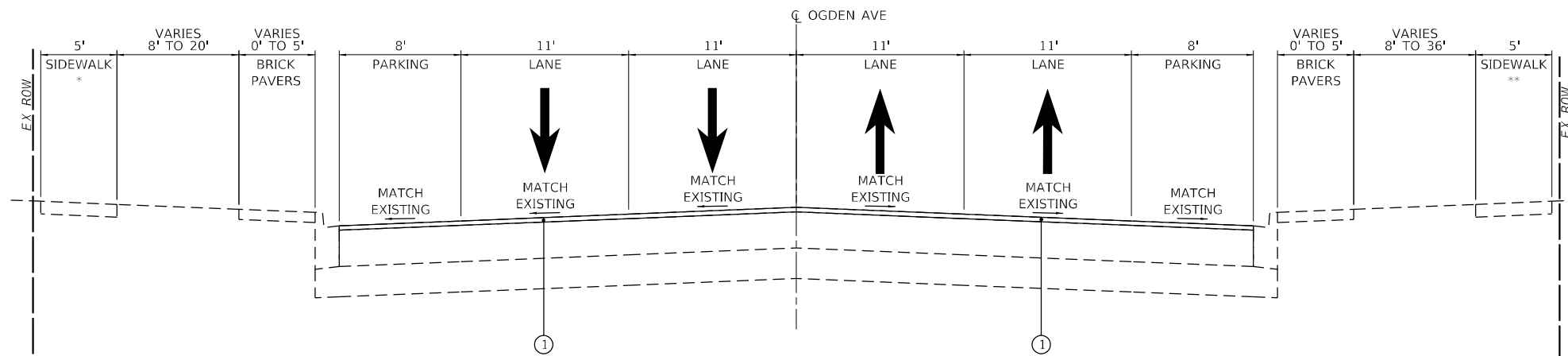

PROPOSED LEGEND

- (1) POLYMERIZED HOT-MIX ASPHALT SURFACE COURSE, IL-9.5, MIX "E", N70 (1.75")
- (2) HMA BASE COURSE WIDENING, 9.25"
- (3) AGGREGATE SUBGRADE IMPROVEMENT, 12"

MODEL: Default
 FILE NAME: p:\p\p\housenew01\HDR_US_Central_01\Documents\11\DOT\DOT_Phs_II_Serv_Varibus TO_199-15\DOT_PTB_199-15_T02_Ogden\6.0_CAD_BIM\6.2_VIP\6.2_VIP\6.2_3_CADD_SheetRoadway\EXISTING_TYPICAL_SECTION.02

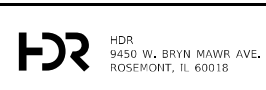

| | | |
|-----------------------------|-------------------|-----------|
| USER NAME = MMICZEK | DESIGNED - MSM | REVISED - |
| DRAWN - MSM | REVISIONS - | |
| PLOT SCALE = 10,0000 */ in. | CHECKED - EN | REVISED - |
| PLOT DATE = 10/1/2021 | DATE - 09/01/2021 | REVISED - |

**STATE OF ILLINOIS
 DEPARTMENT OF TRANSPORTATION**

**EXISTING TYPICAL SECTIONS
 OGDEN AVE. - IL-43 (HARLEM AVE. TO 50TH AVE.)**

SCALE: N.T.S. SHEET 2 OF 2 SHEETS STA. TO STA.

| F.A.P. RTE. | SECTION | COUNTY | TOTAL SHEETS | SHEET NO. |
|---------------------------|---------|--------|--------------|-----------|
| 311 | | | 42 | 6 |
| CONTRACT NO. 62N78 | | | | |
| ILLINOIS FED. AID PROJECT | | | | |

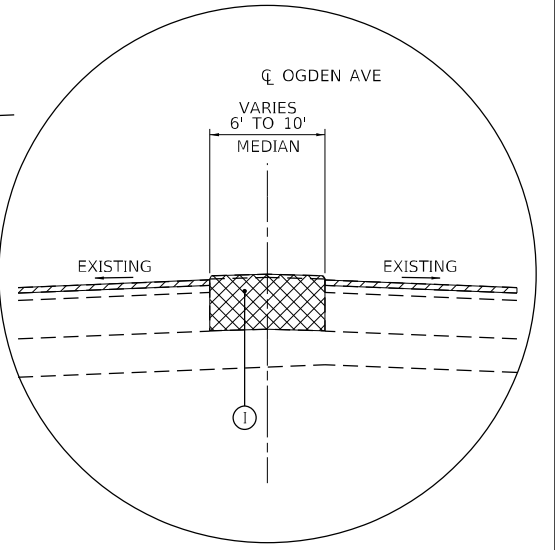
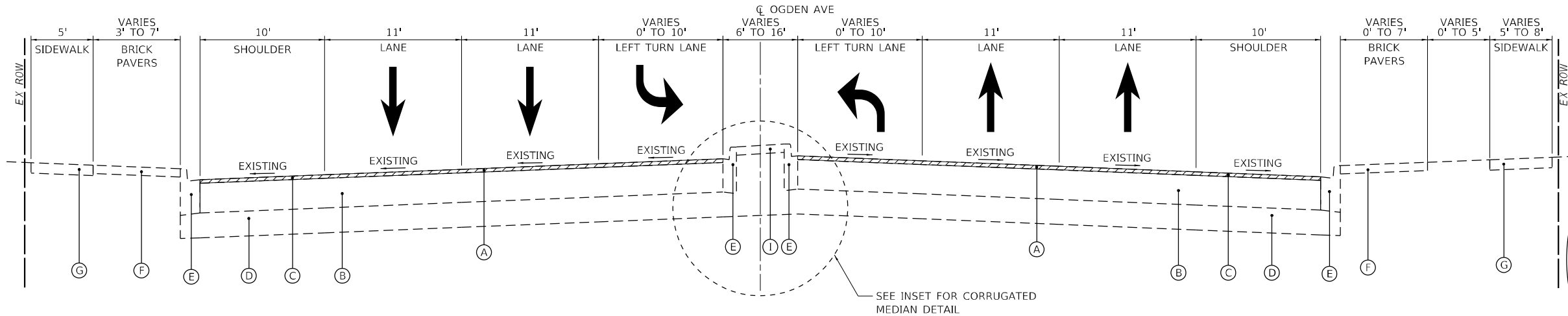

EXISTING LEGEND

- (A) EXISTING HOT-MIX ASPHALT SURFACE COURSE
- (B) EXISTING HOT-MIX ASPHALT BINDER/BASE COURSE
- (C) HOT-MIX ASPHALT SURFACE REMOVAL, 1.75"
- (D) EXISTING SUBBASE GRANULAR MATERIAL, TYPE B
- (E) EXISTING CONCRETE CURB & GUTTER
- (F) EXISTING BRICK PAVERS
- (G) EXISTING PORTLAND CEMENT CONCRETE SIDEWALK 5 INCH
- (H) EXISTING HOT-MIX ASPHALT MEDIAN SURFACE, 4 INCH
- (I) EXISTING CORRUGATED MEDIAN

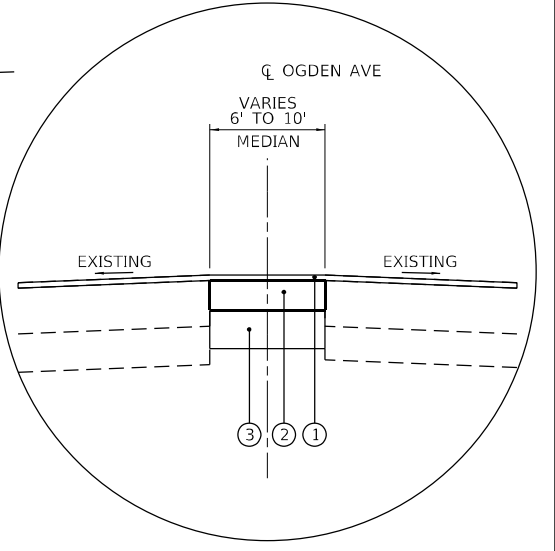
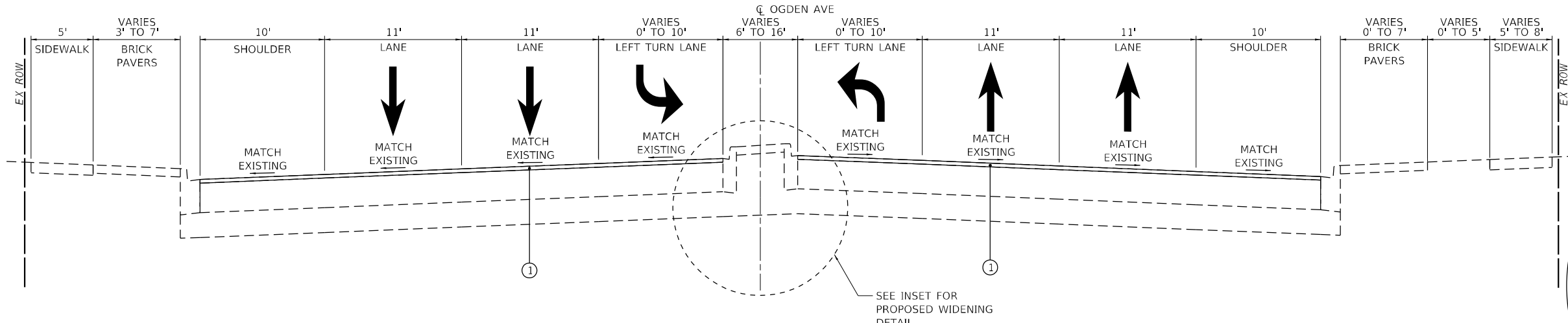

PROPOSED LEGEND

- (1) POLYMERIZED HOT-MIX ASPHALT SURFACE COURSE, IL-9.5, MIX "E", N70 (1.75")
- (2) HMA BASE COURSE WIDENING, 9.25"
- (3) AGGREGATE SUBGRADE IMPROVEMENT, 12"

MODEL: Default
 FILE NAME: p:\p\p\housenew01\HDR_US_Central_01\Documents\11\DOT\DOT_Phs_II_Sec3_Varibus TO 5_199-15\DOT_PTB_199-15_T02_Ogden6.0_CAD_BIM\6.2_VIP\6.2_VIP\6.2_3_CADD_SheetReady\PROPOSED TYPICAL SECTION 01

HDR
 HDR
 9450 W. BRYN MAWR AVE.
 ROSEMONT, IL 60018

| | | |
|-----------------------------|-------------------|-----------|
| USER NAME = MMICZEK | DESIGNED - MSM | REVISED - |
| DRAWN - MSM | REVISIONS - | |
| PLOT SCALE = 10,0000 */ in. | CHECKED - EN | REVISED - |
| PLOT DATE = 10/1/2021 | DATE - 12/10/2021 | REVISED - |

**STATE OF ILLINOIS
 DEPARTMENT OF TRANSPORTATION**

| | |
|--|---------------------|
| TYPICAL SECTIONS | |
| OGDEN AVE. - IL-43 (HARLEM AVE. TO 50TH AVE.) | |
| SCALE: N.T.S. | SHEET 3 OF 3 SHEETS |
| STA. | TO STA. |

| | | | | |
|---------------------------|-------------|--------|--------------|-----------|
| F.A.P. RTE. | SECTION | COUNTY | TOTAL SHEETS | SHEET NO. |
| 311 | 2021-029-R5 | COOK | 42 | 7 |
| CONTRACT NO. 62N78 | | | | |
| ILLINOIS FED. AID PROJECT | | | | |

PAVEMENT MARKING LEGEND

- ① THERMOPLASTIC PAVEMENT MARKING - LINE 4" SOLID WHITE
- ② THERMOPLASTIC PAVEMENT MARKING - LINE 6" SOLID WHITE
- ③ THERMOPLASTIC PAVEMENT MARKING - LINE 4" DOUBLE SOLID YELLOW
- ④ THERMOPLASTIC PAVEMENT MARKING - LINE 6" (6' SKIP - 2' DASH) WHITE
- ⑤ THERMOPLASTIC PAVEMENT MARKING - LINE 24" WHITE
- ⑥ THERMOPLASTIC PAVEMENT MARKING - LETTERS AND SYMBOLS (TYP)
- ⑦ THERMOPLASTIC PAVEMENT MARKING - LINE 4" SOLID WHITE 45° DIAGONAL 20' O.C.
- ⑧ THERMOPLASTIC PAVEMENT MARKING - LINE 12" SOLID YELLOW 45° DIAGONAL 20' O.C.
- ⑨ THERMOPLASTIC PAVEMENT MARKING - LINE 4" (30' SKIP - 10' DASH) WHITE
- ⑩ THERMOPLASTIC PAVEMENT MARKING - LINE 12" WHITE 3' O.C.
- ⑪ RAISED REFLECTIVE PAVEMENT MARKER

ROADWAY LEGEND

- Ⓐ HOT-MIX ASPHALT SURFACE REMOVAL-BUTT JOINT
- Ⓑ HOT-MIX ASPHALT SURFACE REMOVAL, 1 3/4" POLYMERIZED HOT-MIX ASPHALT SURFACE COURSE, MIX "E", IL-9.5, N70, 1 3/4"
- Ⓒ PROP. CURB RAMP IMPROVEMENT, SEE DETAIL DESIGN ON SHEETS 15 - 21

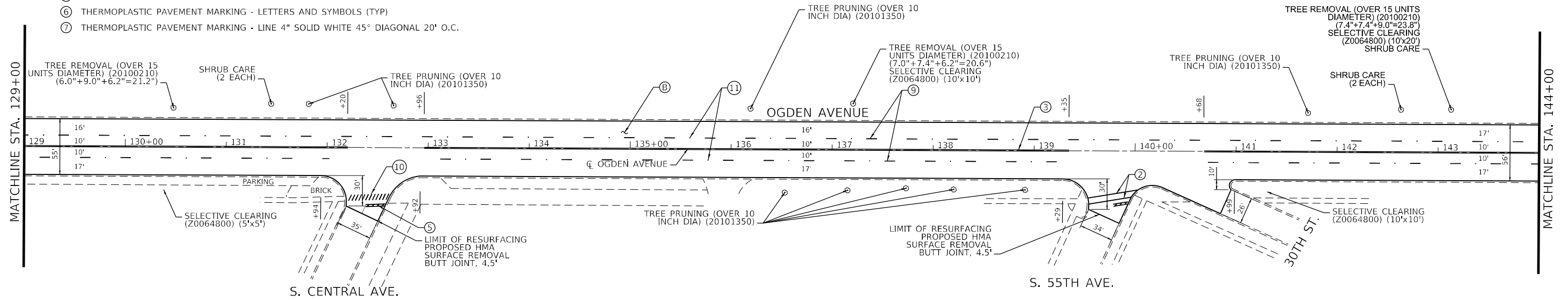

NOTES:

1. THE QUANTITY FOR CLASS D PATCHES, 10" INCLUDED IS TO BE USED AT THE DIRECTION OF THE ENGINEER IN THE FIELD AFTER THE SURFACE HAS BEEN REMOVED.
2. THE QUANTITY FOR COMBINATION CURB AND GUTTER REMOVAL AND REPLACEMENT INCLUDED IS TO BE USED AT THE DIRECTION OF THE ENGINEER IN THE FIELD EXCEPT AS NOTED ON THE PLANS.

PLAN NOTES:

- ALL PAVEMENT MARKINGS INSTALLED ACCORDING TO IDOT'S D-1 DETAIL TC-13
- ALL RAISED REFLECTIVE PAVEMENT MARKERS INSTALLED ACCORDING TO IDOT'S D1 DETAIL TC-11
- ALL CROSSWALKS WILL BE 6 FEET WIDE

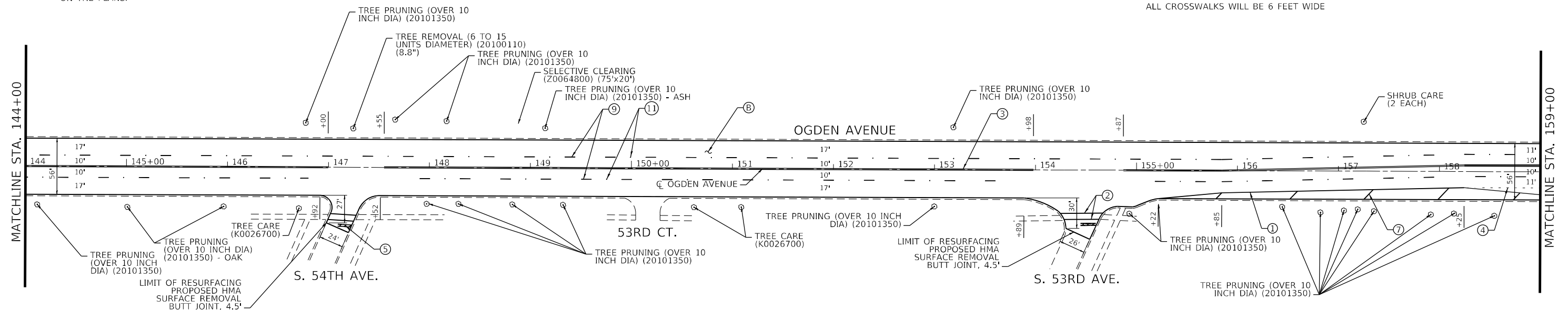

MODEL: Default
 FILE NAME: P:\p\p\road\62n78\11\DOT\DOT_Pls_11_Serv_Vorpus_TO_199-15\DOT_PTB_199-15_T02_Ogden\6.0_CAD_BIM\6.2_VIP\6.2_3_CADD_SheetRoadway\ROADWAY AND PAVEMENT MARKING PLAN 05

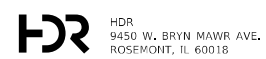

USER NAME = MMICZEK
 DESIGNED - MM
 DRAWN - HL
 CHECKED - EN
 DATE - 12/10/2021
 PLOT SCALE = 100,0000' / in.
 PLOT DATE = 10/11/2021

DESIGNED - MM
 DRAWN - HL
 CHECKED - EN
 DATE - 12/10/2021

REVISED -
 REVISED -
 REVISED -
 REVISED -

STATE OF ILLINOIS
 DEPARTMENT OF TRANSPORTATION

ROADWAY AND PAVEMENT MARKING PLANS
 OGDEN AVE. - IL 43 (HARLEM AVE. TO 50TH AVE.)

SCALE: 1"=50' SHEET 5 OF 6 SHEETS STA. TO STA.

| F.A.P. RTE. | SECTION | COUNTY | TOTAL SHEETS | SHEET NO. |
|---------------------------|-------------|--------|--------------|-----------|
| 311 | 2021-029-R5 | COOK | 42 | 12 |
| CONTRACT NO. 62N78 | | | | |
| ILLINOIS FED. AID PROJECT | | | | |

PAVEMENT MARKING LEGEND

- ① THERMOPLASTIC PAVEMENT MARKING - LINE 4" SOLID WHITE
- ② THERMOPLASTIC PAVEMENT MARKING - LINE 6" SOLID WHITE
- ③ THERMOPLASTIC PAVEMENT MARKING - LINE 4" DOUBLE SOLID YELLOW
- ④ THERMOPLASTIC PAVEMENT MARKING - LINE 6" (6' SKIP - 2' DASH) WHITE
- ⑤ THERMOPLASTIC PAVEMENT MARKING - LINE 24" WHITE
- ⑥ THERMOPLASTIC PAVEMENT MARKING - LETTERS AND SYMBOLS (TYP)
- ⑦ THERMOPLASTIC PAVEMENT MARKING - LINE 4" SOLID WHITE 45° DIAGONAL 20' O.C.
- ⑧ THERMOPLASTIC PAVEMENT MARKING - LINE 12" SOLID YELLOW 45° DIAGONAL 20' O.C.
- ⑨ THERMOPLASTIC PAVEMENT MARKING - LINE 4" (30' SKIP - 10' DASH) WHITE
- ⑩ THERMOPLASTIC PAVEMENT MARKING - LINE 12" WHITE 3' O.C.
- ⑪ RAISED REFLECTIVE PAVEMENT MARKER

ROADWAY LEGEND

- Ⓐ HOT-MIX ASPHALT SURFACE REMOVAL-BUTT JOINT
- Ⓑ HOT-MIX ASPHALT SURFACE REMOVAL, 1 3/4" POLYMERIZED HOT-MIX ASPHALT SURFACE COURSE, MIX "E", 1L-9.5, N70, 1 3/4"
- Ⓒ PROP. CURB RAMP IMPROVEMENT, SEE DETAIL DESIGN ON SHEETS 15 - 21
- Ⓓ CLASS D PAVEMENT PATCH

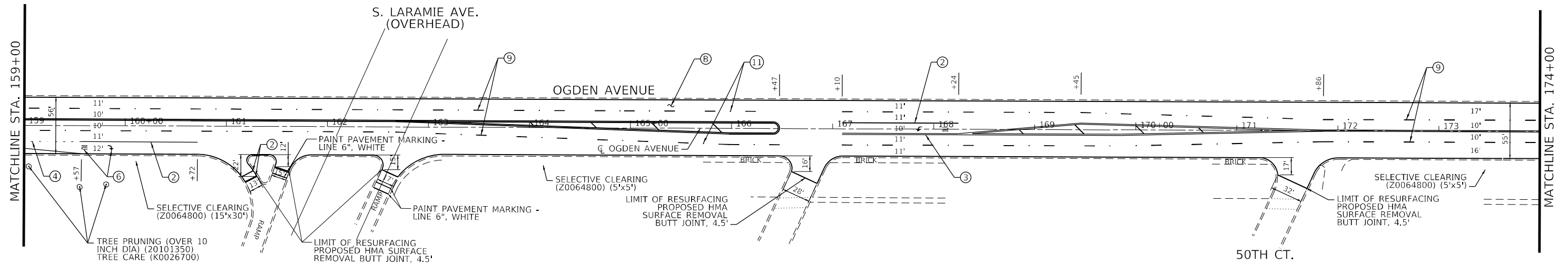

NOTES:

1. THE QUANTITY FOR CLASS D PATCHES, 10" INCLUDED IS TO BE USED AT THE DIRECTION OF THE ENGINEER IN THE FIELD AFTER THE SURFACE HAS BEEN REMOVED EXCEPT AS NOTED ON THE PLANS.
2. THE QUANTITY FOR COMBINATION CURB AND GUTTER REMOVAL AND REPLACEMENT INCLUDED IS TO BE USED AT THE DIRECTION OF THE ENGINEER IN THE FIELD EXCEPT AS NOTED ON THE PLANS.

PLAN NOTES:

- ALL PAVEMENT MARKINGS INSTALLED ACCORDING TO IDOT'S D-1 DETAIL TC-13
- ALL RAISED REFLECTIVE PAVEMENT MARKERS INSTALLED ACCORDING TO IDOT'S D1 DETAIL TC-11
- ALL CROSSWALKS WILL BE 6 FEET WIDE

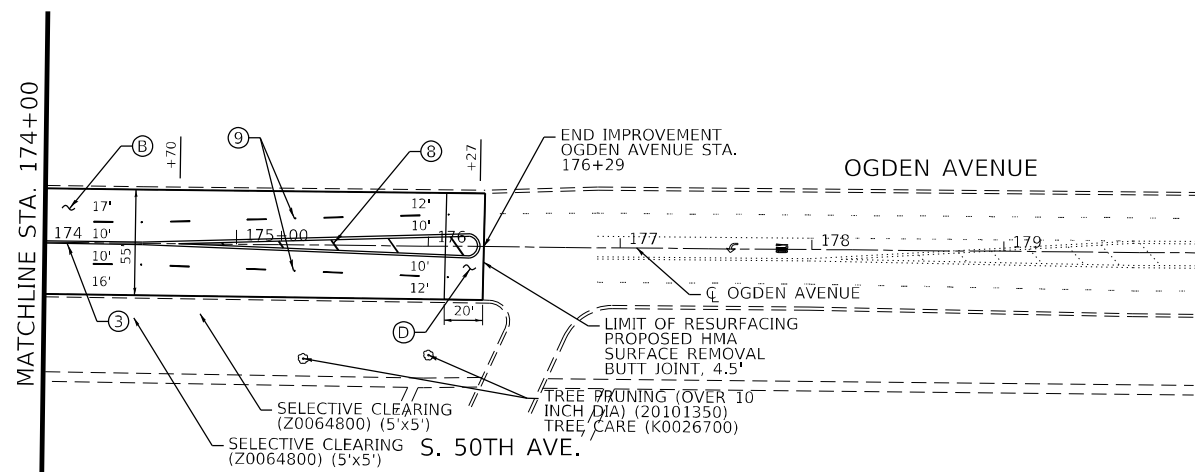

MODEL: Default
 FILE: N:\MISC\pavement\hdrcen01\hdrcen01\Documents\11\DOT\DOT_Plan_Serv_Various_TO_5_199-18\DOT_PTB_199-18_IDOT_College6.0_CAD_BMAP2_WBP2.2_CADD_Sheet\Roadway\ROADWAY AND PAVEMENT MARKING PLAN_06

HDR
 HDR
 9450 W. BRYN MAWR AVE.
 ROSEMONT, IL 60018

| | | |
|------------------------------|-------------------|-----------|
| USER NAME = MMICZEK | DESIGNED - MM | REVISED - |
| PLOT SCALE = 100.0434' / in. | DRAWN - HL | REVISED - |
| PLOT DATE = 10/1/2021 | CHECKED - EN | REVISED - |
| | DATE - 12/10/2021 | REVISED - |

**STATE OF ILLINOIS
 DEPARTMENT OF TRANSPORTATION**

**ROADWAY AND PAVEMENT MARKING PLANS
 OGDEN AVE. - IL 43 (HARLEM AVE. TO 50TH AVE.)**

SCALE: 1"=50' SHEET 6 OF 6 SHEETS STA. 159+00 TO STA. 179+00

| F.A.P. RTE. | SECTION | COUNTY | TOTAL SHEETS | SHEET NO. |
|---------------------------|-------------|--------|--------------|-----------|
| 311 | 2021-029-R5 | COOK | 42 | 13 |
| CONTRACT NO. 62N78 | | | | |
| ILLINOIS FED. AID PROJECT | | | | |

SCHEDULE OF QUANTITIES – CURB RAMPS

| LOCATION | | | EARTH EXCAVATION <i>20200100</i> | TOPSOIL FURNISH AND PLACE, 4" <i>21101615</i> | SODDING, SALT TOLERANT <i>25200110</i> | SUPPLEMENTAL WATERING <i>25200200</i> | PROTECTIVE COAT <i>42001300</i> | PORTLAND CEMENT CONCRETE DRIVEWAY PAVEMENT, 8 INCH <i>42300400</i> | PORTLAND CEMENT CONCRETE SIDEWALK 5 INCH <i>42400200</i> | DETECTABLE WARNINGS <i>42400800</i> | DRIVEWAY PAVEMENT REMOVAL <i>44000200</i> | COMBINATION CURB AND GUTTER REMOVAL <i>44000500</i> | SIDEWALK REMOVAL <i>44000600</i> | CLASS D PATCHES, TYPE I, 10 INCH <i>44201761</i> | CLASS D PATCHES, TYPE II, 10 INCH <i>44201765</i> | COMBINATION CONCRETE CURB AND GUTTER, TYPE B-6.12 <i>60603800</i> | REMOVE AND REINSTALL BRICK PAVERS <i>X0327611</i> |
|-----------|--------------|----|-------------------------------------|--|---|--|------------------------------------|---|---|--|--|--|-------------------------------------|---|--|--|--|
| LOCATION | | | CU YD | SQ YD | SQ YD | UNIT | SQ YD | SQ YD | SQ FT | SQ FT | SQ YD | FOOT | SQ FT | SQ YD | SQ YD | FOOT | SQ FT |
| OGDEN AVE | CLINTON AVE | SW | 3.0 | 15 | 15 | 0.2 | 98 | 0 | 253 | 30 | 0 | 27 | 254 | 0 | 6 | 27 | 0 |
| OGDEN AVE | CLINTON AVE | NW | 3.0 | 8 | 8 | 0.1 | 143 | 0 | 511 | 22 | 0 | 33 | 511 | 0 | 8 | 33 | 0 |
| OGDEN AVE | CLINTON AVE | NE | 2.5 | 0 | 0 | 0.0 | 82 | 0 | 273 | 16 | 0 | 20 | 273 | 5 | 0 | 20 | 41 |
| OGDEN AVE | OAK PARK AVE | SW | 3.0 | 10 | 10 | 0.2 | 123 | 0 | 286 | 22 | 0 | 35 | 286 | 0 | 8 | 35 | 37 |
| OGDEN AVE | EUCLID AVE | NE | 2.5 | 10 | 10 | 0.1 | 105 | 0 | 360 | 21 | 0 | 25 | 360 | 0 | 6 | 25 | 0 |
| OGDEN AVE | CLARENCE AVE | NE | 2.5 | 11 | 11 | 0.2 | 106 | 0 | 295 | 24 | 0 | 28 | 296 | 0 | 7 | 28 | 0 |
| OGDEN AVE | EAST AVE | NW | 3.0 | 9 | 9 | 0.1 | 146 | 0 | 329 | 20 | 0 | 42 | 324 | 0 | 10 | 42 | 0 |
| OGDEN AVE | EAST AVE | SE | 1.5 | 13 | 13 | 0.2 | 155 | 0 | 342 | 20 | 0 | 45 | 309 | 0 | 10 | 45 | 10 |
| OGDEN AVE | 34THST | NW | 1.5 | 1 | 1 | 0.0 | 84 | 0 | 76 | 12 | 0 | 29 | 77 | 0 | 7 | 29 | 0 |
| OGDEN AVE | LOMBARD AVE | NW | 3.0 | 10 | 10 | 0.2 | 139 | 0 | 274 | 30 | 0 | 42 | 259 | 0 | 10 | 42 | 12 |
| OGDEN AVE | 61ST AVE | NW | 1.5 | 2 | 2 | 0.0 | 92 | 86 | 47 | 10 | 76 | 0 | 43 | 0 | 0 | 0 | 0 |
| OGDEN AVE | 61ST AVE | NE | 1.5 | 0 | 0 | 0.0 | 6 | 0 | 49 | 10 | 0 | 0 | 87 | 0 | 0 | 0 | 21 |
| OGDEN AVE | 59TH AVE | SW | 1.5 | 0 | 0 | 0.0 | 136 | 0 | 265 | 30 | 0 | 41 | 259 | 0 | 10 | 41 | 37 |
| TOTAL | | | 30.0 | 90 | 90 | 1.4 | 1415 | 86 | 3361 | 267 | 76 | 367 | 3338 | 5 | 82 | 367 | 158 |

MODEL: 20 MODEL; FILE NAME: p:\p\p\housenew01\HDR_US_Central_01\Documents\1\DOT\DOT_Phs_II_Spec_Varibus_TO_5_199-15\DOT_PTB_199-15_T02_Ogden6.0_CAD_BIM6.2_VIP6.2_3_CADD_SpecRoadway\SCHEDULE OF QUANTITIES FOR CURB RAMPS

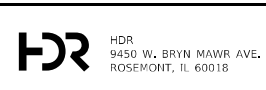

USER NAME = MMICZEK
 PLOT SCALE = 100,0000 ' / in.
 PLOT DATE = 10/1/2021

DESIGNED - MM
 DRAWN - HL
 CHECKED - EN
 DATE - 12/10/2021

REVISED -
 REVISED -
 REVISED -
 REVISED -

**STATE OF ILLINOIS
 DEPARTMENT OF TRANSPORTATION**

**SCHEDULE OF QUANTITIES FOR CURB RAMPS
 OGDEN AVE. – IL 43 (HARLEM AVE. TO 50TH AVE.)**

SCALE: NTS SHEET OF SHEETS STA. TO STA.

| | | | | |
|---------------------------|-------------|--------|--------------------|-----------|
| F.A.P. RTE. | SECTION | COUNTY | TOTAL SHEETS | SHEET NO. |
| 311 | 2021-029-R5 | COOK | 42 | 14 |
| ILLINOIS FED. AID PROJECT | | | CONTRACT NO. 62N78 | |

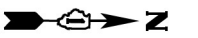

NOTES:

1. WORK SHALL MEET THE REQUIREMENTS OF THE SPECIAL PROVISION, "DETECTOR LOOP REPLACEMENT AND/OR INSTALLATION (ROADWAY GRINDING, RESURFACING & PATCHING OPERATIONS).
2. THIS PLAN IS FOR THE SOLE PURPOSE OF DETECTOR LOOP REPLACEMENT.

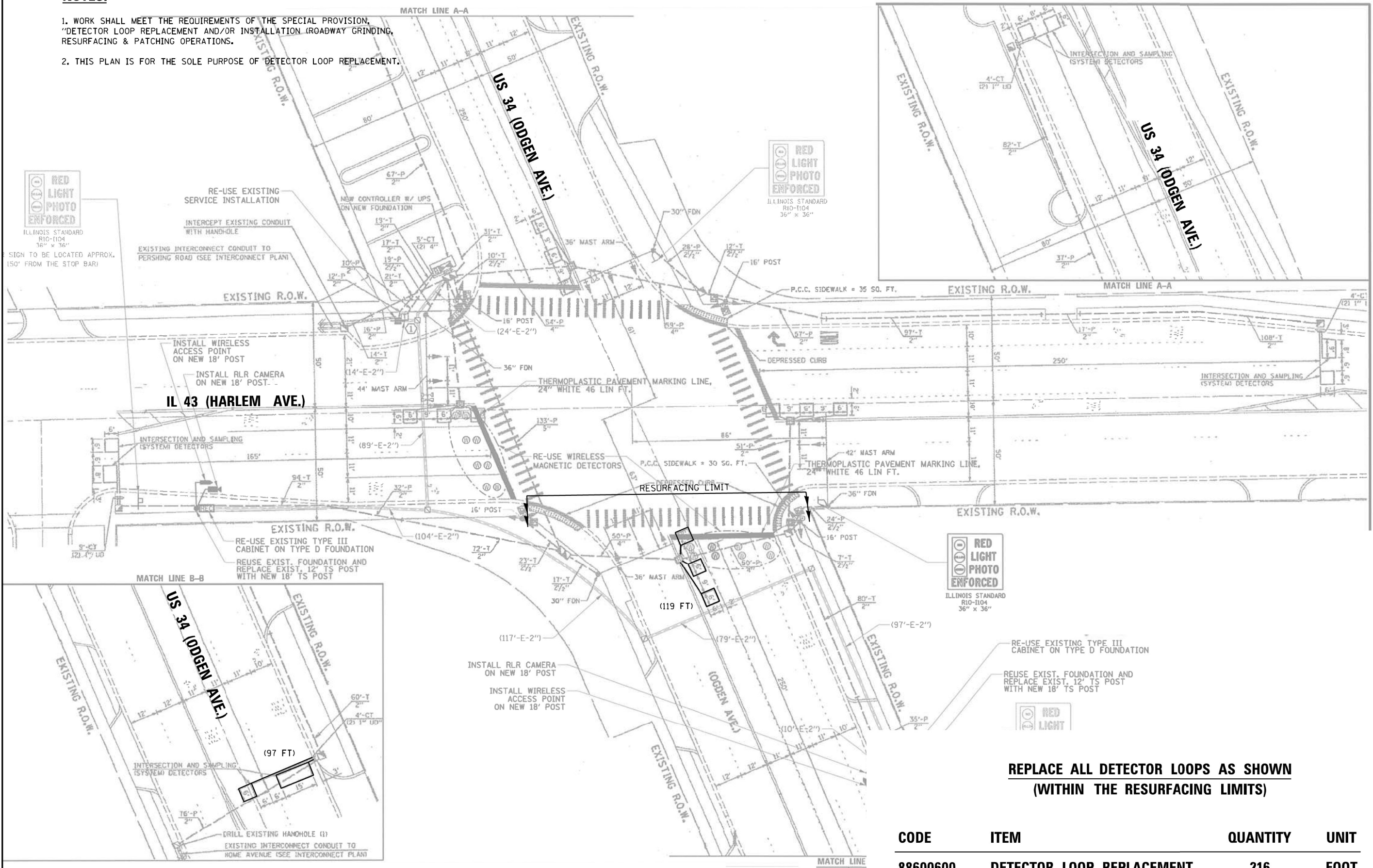

**REPLACE ALL DETECTOR LOOPS AS SHOWN
(WITHIN THE RESURFACING LIMITS)**

| CODE | ITEM | QUANTITY | UNIT |
|----------|---------------------------|----------|------|
| 88600600 | DETECTOR LOOP REPLACEMENT | 216 | FOOT |

| | | | |
|--|----------------------------|-----------------|-----------|
| FILE NAME = 62N78 - TS1455 US 34 Odgen Ave @ IL 43 | USER NAME = vargaso | DESIGNED - AV | REVISED - |
| | Harlem Avadgn | DRAWN - AV | REVISED - |
| | PLOT SCALE = 40,0000' / 1" | CHECKED - LP | REVISED - |
| | PLOT DATE = 6/1/2021 | DATE - 6/1/2021 | REVISED - |

**STATE OF ILLINOIS
DEPARTMENT OF TRANSPORTATION**

**DETECTOR LOOP REPLACEMENT PLAN
US 34 ODGEN AVE. AT IL 43 HARLEM AVE.**

| | | | | |
|---------------------------|---------------------|-------------|-----------------|--------------|
| F.A.P. RTE. 311 | SECTION 2021-029-R5 | COUNTY COOK | TOTAL SHEETS 42 | SHEET NO. 22 |
| CONTRACT NO. 62N78 | | | | |
| ILLINOIS FED. AID PROJECT | | | | |

SCALE: SHEET OF SHEETS STA. TO STA.

NOTES:

1. WORK SHALL MEET THE REQUIREMENTS OF THE SPECIAL PROVISION, "DETECTOR LOOP REPLACEMENT AND/OR INSTALLATION (ROADWAY GRINDING, RESURFACING & PATCHING OPERATIONS).
2. THIS PLAN IS FOR THE SOLE PURPOSE OF DETECTOR LOOP REPLACEMENT.

REPLACE HANDHOLE

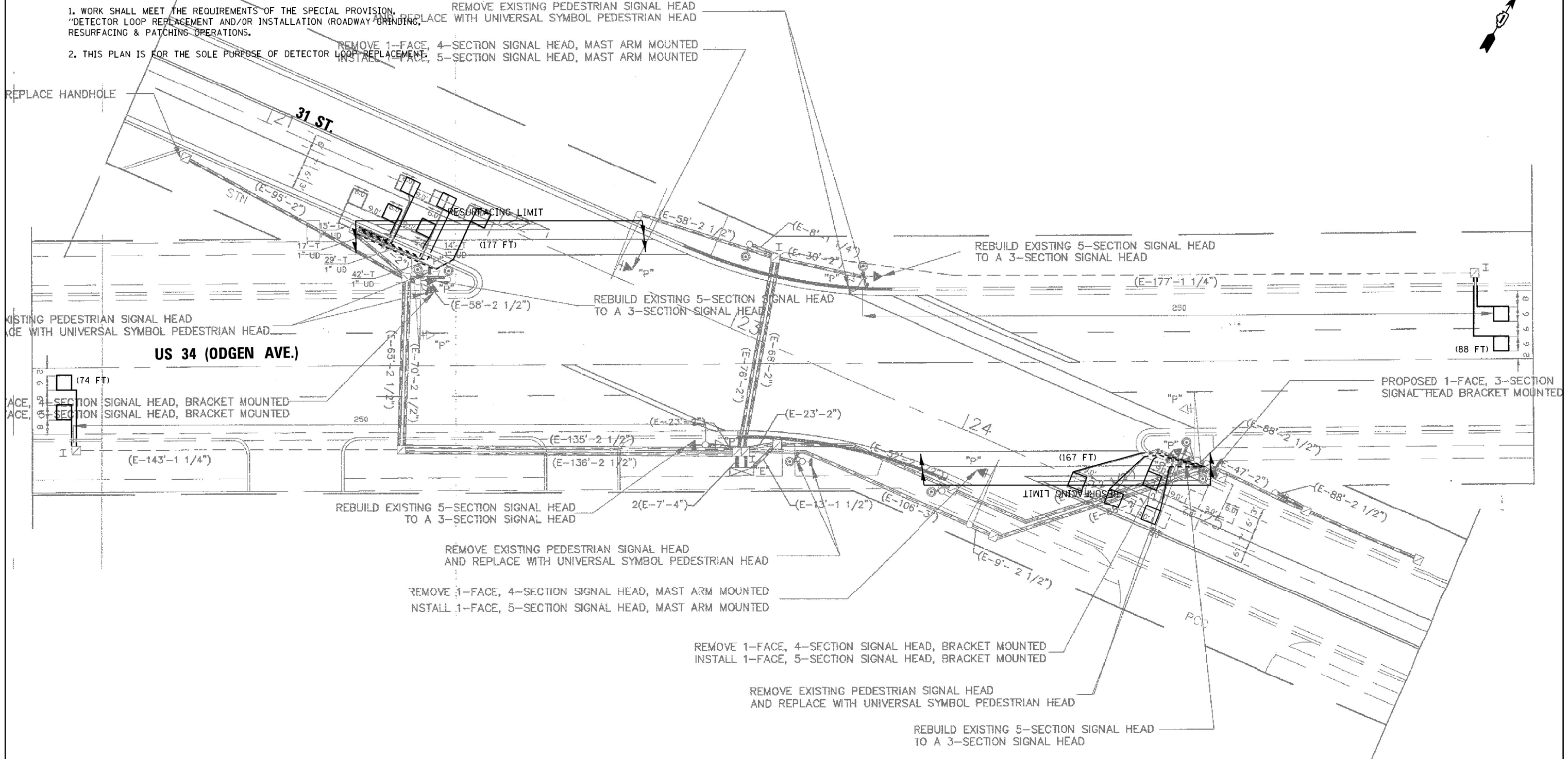

**REPLACE ALL DETECTOR LOOPS AS SHOWN
(WITHIN THE RESURFACING LIMITS)**

| CODE | ITEM | QUANTITY | UNIT |
|----------|---------------------------|----------|------|
| 88600600 | DETECTOR LOOP REPLACEMENT | 506 | FOOT |

| | | | |
|---|---------------------|-----------------|-----------|
| FILE NAME = 62N78 - TS5555 US 34 Odgen Ave @ 31St.dgn | USER NAME = vargaso | DESIGNED - AV | REVISED - |
| | | DRAWN - AV | REVISED - |
| | | CHECKED - LP | REVISED - |
| | | DATE - 6/2/2021 | REVISED - |

**STATE OF ILLINOIS
DEPARTMENT OF TRANSPORTATION**

| | | | |
|---------------------------------------|-------|-----------|--------------|
| DETECTOR LOOP REPLACEMENT PLAN | | | |
| US 34 ODGEN AVE. AT 31ST. | | | |
| SCALE: | SHEET | OF SHEETS | STA. TO STA. |

| | | | | |
|---------------------------|---------------------|-------------|-----------------|--------------|
| F.A.P. RTE. 311 | SECTION 2021-029-R5 | COUNTY COOK | TOTAL SHEETS 42 | SHEET NO. 24 |
| CONTRACT NO. 62N78 | | | | |
| ILLINOIS FED. AID PROJECT | | | | |

NOTES:

1. WORK SHALL MEET THE REQUIREMENTS OF THE SPECIAL PROVISION, "DETECTOR LOOP REPLACEMENT AND/OR INSTALLATION (ROADWAY GRINDING, RESURFACING & PATCHING OPERATIONS).
2. THIS PLAN IS FOR THE SOLE PURPOSE OF DETECTOR LOOP REPLACEMENT.

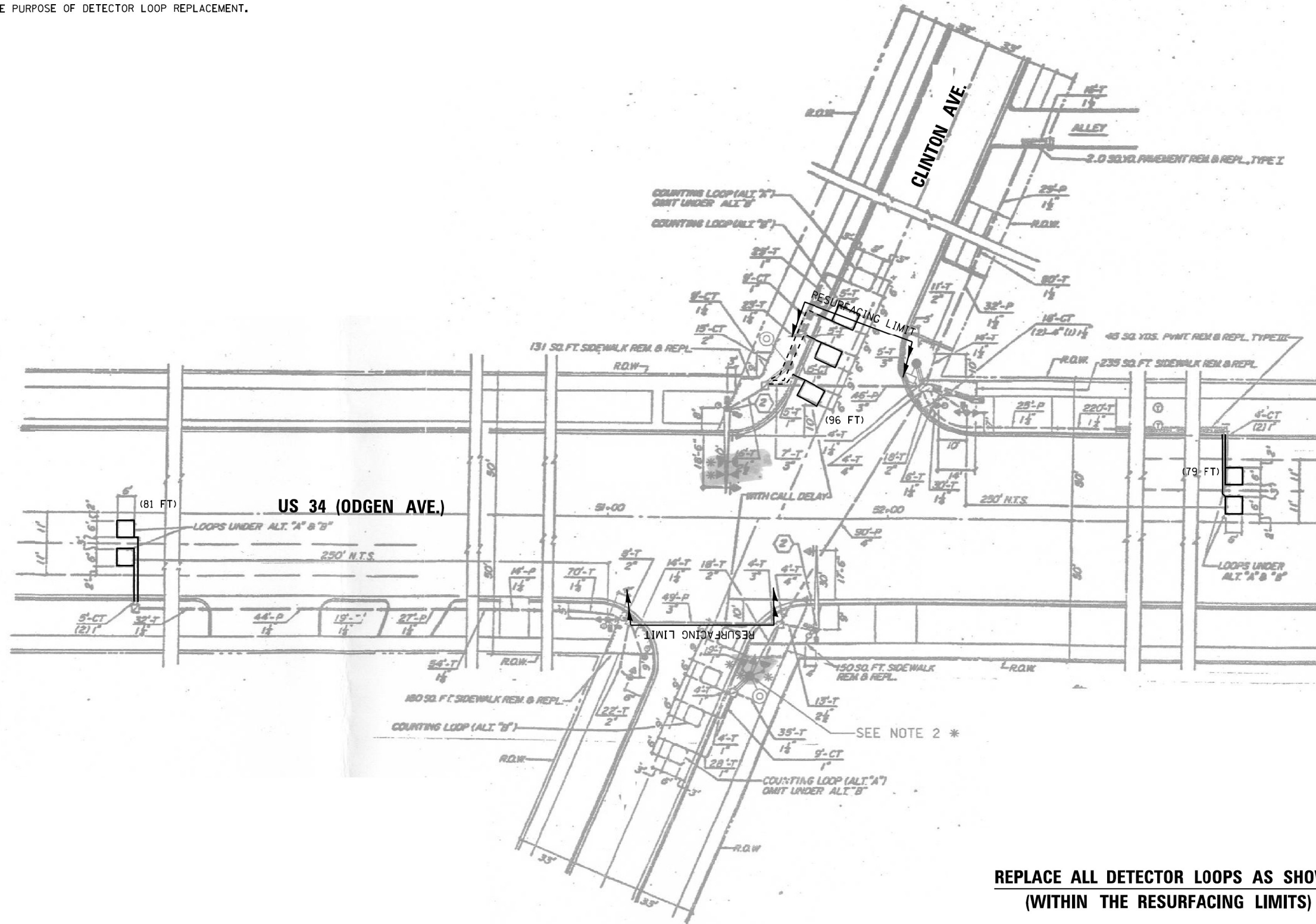

**REPLACE ALL DETECTOR LOOPS AS SHOWN
(WITHIN THE RESURFACING LIMITS)**

| CODE | ITEM | QUANTITY | UNIT |
|----------|---------------------------|----------|------|
| 88600600 | DETECTOR LOOP REPLACEMENT | 256 | FOOT |

| | | | |
|--|-----------------------------|-----------------|-----------|
| FILE NAME = | USER NAME = vargese | DESIGNED - AV | REVISED - |
| 62N78 - TS5575 US 34 Odgen Ave @ Clinton Ave.dgn | | DRAWN - AV | REVISED - |
| | PLOT SCALE = 40,0000' / in. | CHECKED - LP | REVISED - |
| Default | PLOT DATE = 6/2/2021 | DATE - 6/2/2021 | REVISED - |

**STATE OF ILLINOIS
DEPARTMENT OF TRANSPORTATION**

**DETECTOR LOOP REPLACEMENT PLAN
US 34 ODGEN AVE. AT CLINTON AVE.**

SCALE: SHEET OF SHEETS STA. TO STA.

| | | | | |
|---------------------------|-------------|--------|--------------|-----------|
| F.A.P. RTE. | SECTION | COUNTY | TOTAL SHEETS | SHEET NO. |
| 311 | 2021-029-R5 | COOK | 42 | 26 |
| CONTRACT NO. 62N78 | | | | |
| ILLINOIS FED. AID PROJECT | | | | |

NOTES:

1. WORK SHALL MEET THE REQUIREMENTS OF THE SPECIAL PROVISION, "DETECTOR LOOP REPLACEMENT AND/OR INSTALLATION (ROADWAY GRINDING, RESURFACING & PATCHING OPERATIONS).
2. THIS PLAN IS FOR THE SOLE PURPOSE OF DETECTOR LOOP REPLACEMENT.

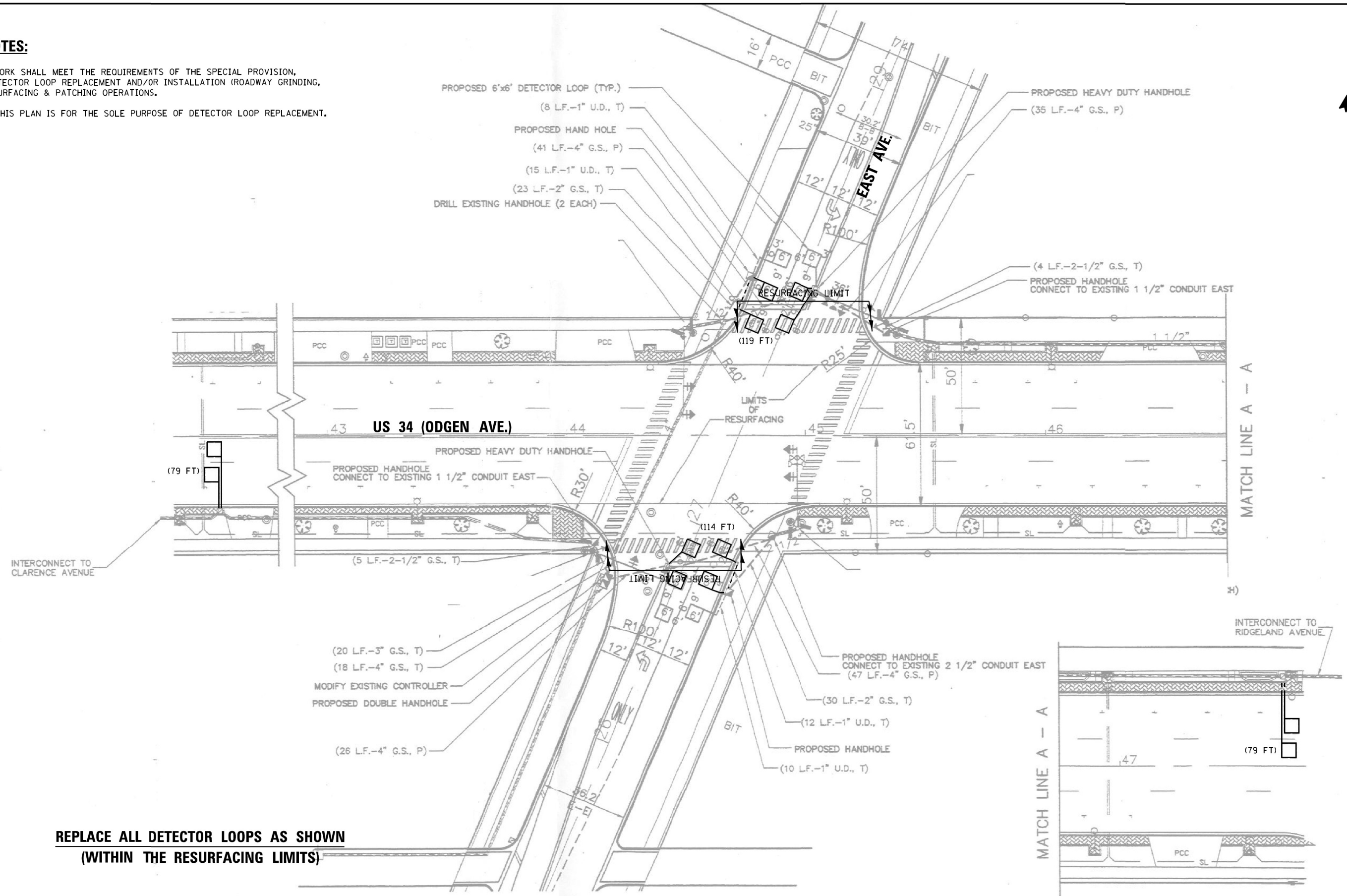

**REPLACE ALL DETECTOR LOOPS AS SHOWN
(WITHIN THE RESURFACING LIMITS)**

| CODE | ITEM | QUANTITY | UNIT |
|----------|---------------------------|----------|------|
| 88600600 | DETECTOR LOOP REPLACEMENT | 391 | FOOT |

TS 5580

| | | | | | | | | | | | | |
|---|----------------------|-----------------|-----------|---|---|-------------------|-----------------------|---------------|---------------------------|----------------|--|--|
| FILE NAME = 62N78 - TS5580 US 34 Odgen Ave @ East Ave.dgn | USER NAME = vargosa | DESIGNED - AV | REVISED - | STATE OF ILLINOIS DEPARTMENT OF TRANSPORTATION | DETECTOR LOOP REPLACEMENT PLAN US 34 ODGEN AVE. AT EAST AVE. | F.A.P. RTE. = 311 | SECTION = 2021-029-R5 | COUNTY = COOK | TOTAL SHEETS = 42 | SHEET NO. = 27 | | |
| PLOT SCALE = 40,0000' / in. | CHECKED - LP | REVISED - | REVISED - | | | SCALE: | SHEET OF SHEETS | STA. TO STA. | ILLINOIS FED. AID PROJECT | | | |
| Default | PLOT DATE = 6/2/2021 | DATE = 6/2/2021 | REVISED - | | | | | | | | | |
| CONTRACT NO. 62N78 | | | | | | | | | | | | |

NOTES:

1. WORK SHALL MEET THE REQUIREMENTS OF THE SPECIAL PROVISION, "DETECTOR LOOP REPLACEMENT AND/OR INSTALLATION (ROADWAY GRINDING, RESURFACING & PATCHING OPERATIONS).
2. THIS PLAN IS FOR THE SOLE PURPOSE OF DETECTOR LOOP REPLACEMENT.

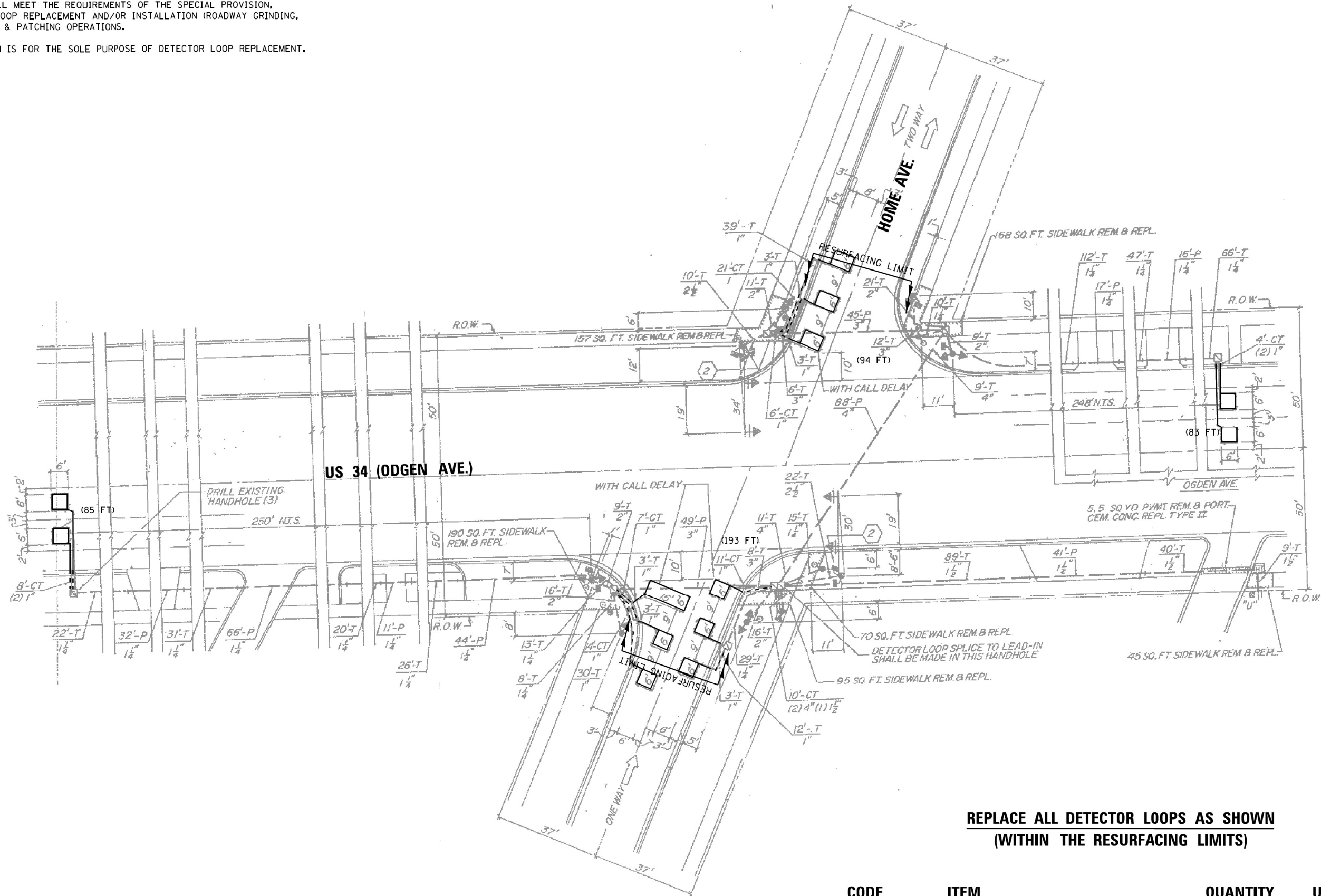

**REPLACE ALL DETECTOR LOOPS AS SHOWN
(WITHIN THE RESURFACING LIMITS)**

| CODE | ITEM | QUANTITY | UNIT |
|----------|---------------------------|----------|------|
| 88600600 | DETECTOR LOOP REPLACEMENT | 455 | FOOT |

| | | | |
|---|---------------------|-----------------|-----------|
| FILE NAME = 62N78 - TS5590 US 34 Odgen Ave @ Home Ave.dgn | USER NAME = vargaso | DESIGNED - AV | REVISED - |
| | | DRAWN - AV | REVISED - |
| | | CHECKED - LP | REVISED - |
| | | DATE - 6/1/2021 | REVISED - |

**STATE OF ILLINOIS
DEPARTMENT OF TRANSPORTATION**

**DETECTOR LOOP REPLACEMENT PLAN
US 34 ODGEN AVE. AT HOME AVE.**

| | | | | |
|---------------------------|---------------------|-------------|-----------------|--------------|
| F.A.P. RTE. 311 | SECTION 2021-029-R5 | COUNTY COOK | TOTAL SHEETS 42 | SHEET NO. 28 |
| CONTRACT NO. 62N78 | | | | |
| ILLINOIS FED. AID PROJECT | | | | |

SCALE: SHEET OF SHEETS STA. TO STA.

NOTES:

1. WORK SHALL MEET THE REQUIREMENTS OF THE SPECIAL PROVISION, "DETECTOR LOOP REPLACEMENT AND/OR INSTALLATION (ROADWAY GRINDING, RESURFACING & PATCHING OPERATIONS).
2. THIS PLAN IS FOR THE SOLE PURPOSE OF DETECTOR LOOP REPLACEMENT.

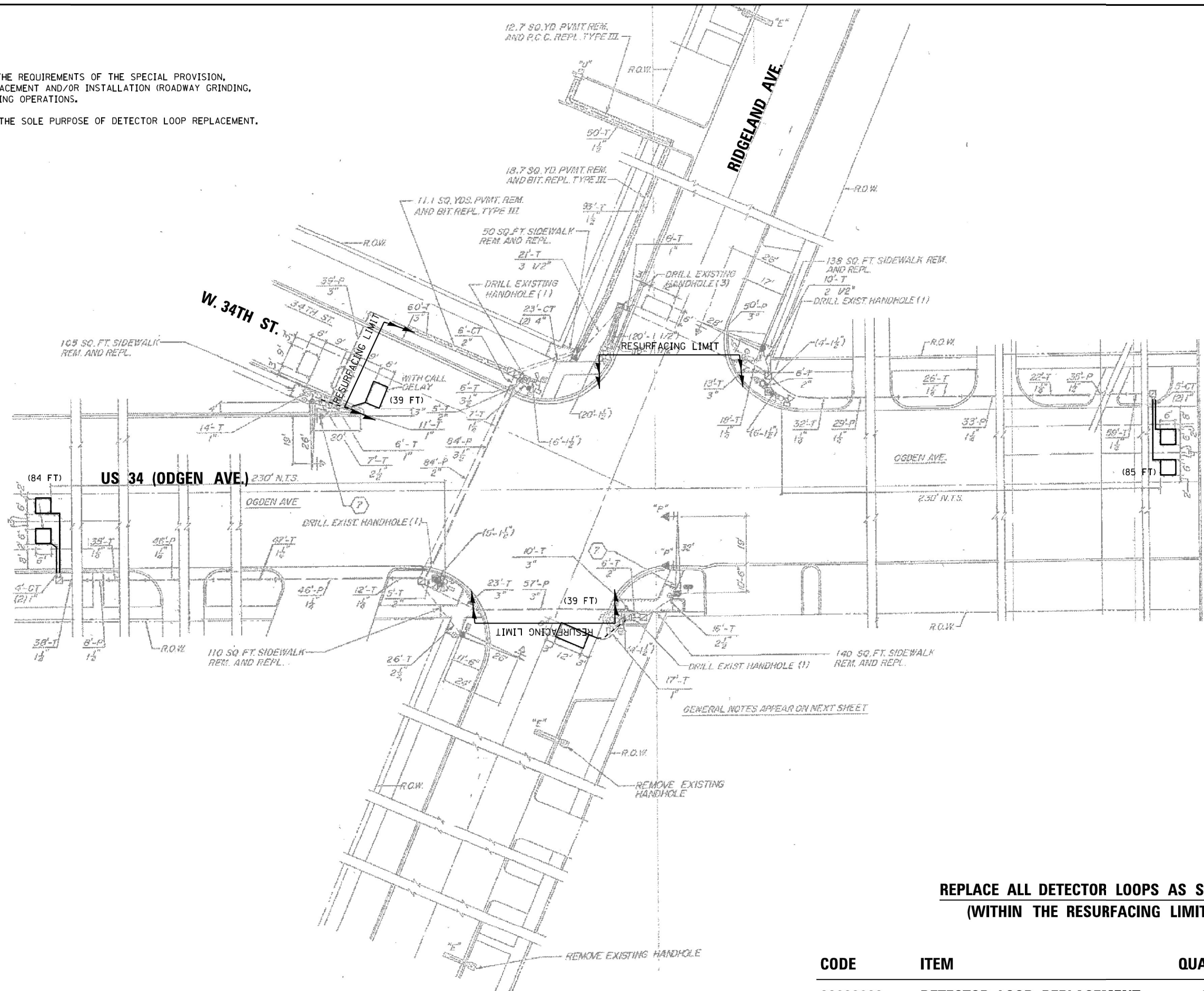

**REPLACE ALL DETECTOR LOOPS AS SHOWN
(WITHIN THE RESURFACING LIMITS)**

| CODE | ITEM | QUANTITY | UNIT |
|----------|---------------------------|----------|--------------|
| 88600600 | DETECTOR LOOP REPLACEMENT | 347 | FOOT TS 5595 |

| | | | |
|--|----------------------|-----------------|-----------|
| FILE NAME * | USER NAME * vargosa | DESIGNED - AV | REVISED - |
| 62N78 - TS5595 US 34 Odgen Ave @ Ridgeland Ave.dgn | | DRAWN - AV | REVISED - |
| Default | PLOT DATE = 6/2/2021 | CHECKED - LP | REVISED - |
| | | DATE - 6/2/2021 | REVISED - |

**STATE OF ILLINOIS
DEPARTMENT OF TRANSPORTATION**

| | | | |
|---|-------|-----------|--------------|
| DETECTOR LOOP REPLACEMENT PLAN | | | |
| US 34 ODGEN AVE. AT RIDGELAND AVE. | | | |
| SCALE: | SHEET | OF SHEETS | STA. TO STA. |

| | | | | |
|---------------------------|-------------|--------|--------------|-----------|
| F.A.P. RTE. | SECTION | COUNTY | TOTAL SHEETS | SHEET NO. |
| 311 | 2021-029-R5 | COOK | 42 | 29 |
| CONTRACT NO. 62N78 | | | | |
| ILLINOIS FED. AID PROJECT | | | | |

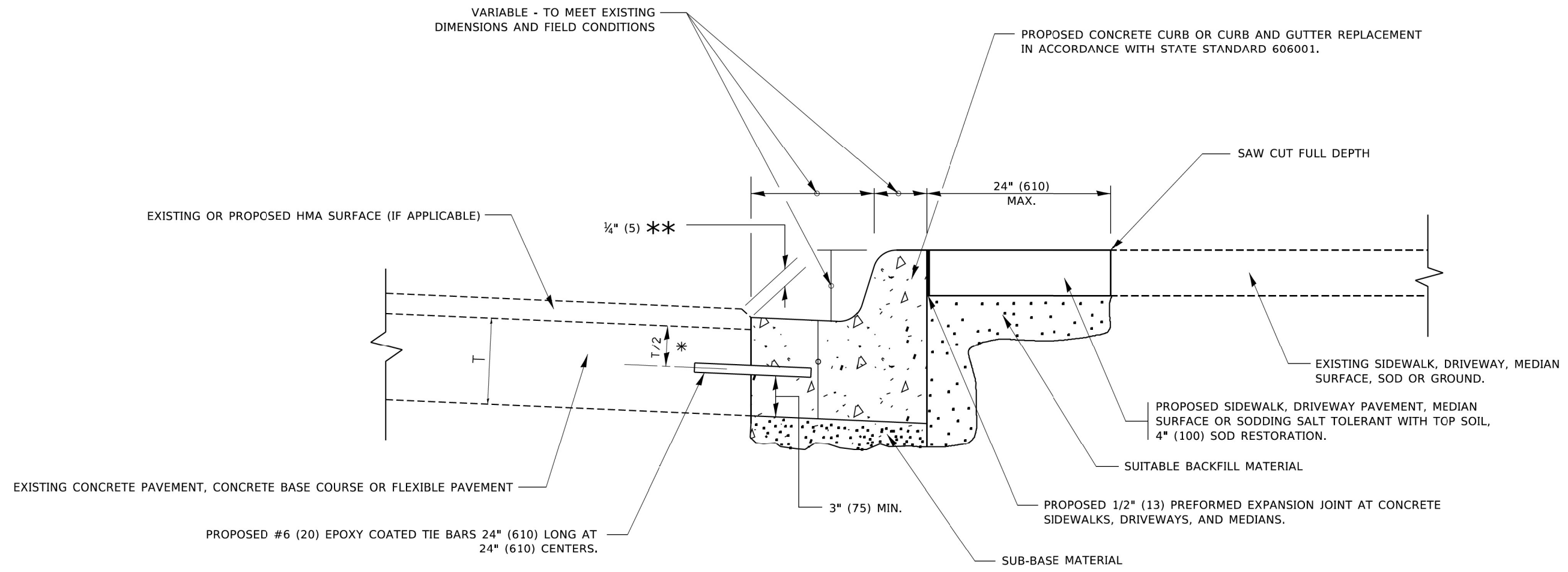

- * 3" (75) MINIMUM FROM TOP AND BOTTOM OF THE CONCRETE PAVEMENT OR BASE COURSE.
- ** IF THE FINAL SURFACE OF THE PAVEMENT IS CONCRETE, THE GUTTER IS TO BE FLUSH WITH THE PAVEMENT.

CURB OR CURB AND GUTTER REMOVAL AND REPLACEMENT

ALL DIMENSIONS ARE IN INCHES (MILLIMETERS) UNLESS OTHERWISE SHOWN.

MODEL: Default; FILE: \\millec-prod\pdm\com\edc_illinois\pwr\DOT\Documents\DOT_Offices\District_1\Projects\DH\5427231\CADD\ba\Curb\sheet1b24.dgn

| | | |
|------------------------------|----------------------|-----------------------------|
| USER NAME = footemj | DESIGNED - A. HOUSEH | REVISED - A. ABBAS 03-21-97 |
| | DRAWN - | REVISED - M. GOMEZ 01-22-01 |
| PLOT SCALE = 50,0000 ' / ft. | CHECKED - | REVISED - R. BORO 12-15-09 |
| PLOT DATE = 7/11/2019 | DATE - 03-11-94 | REVISED - K. SMITH 07-11-19 |

**STATE OF ILLINOIS
DEPARTMENT OF TRANSPORTATION**

**CURB OR CURB AND GUTTER
REMOVAL AND REPLACEMENT**

SCALE: NONE SHEET 1 OF 1 SHEETS STA. TO STA.

| | | | | |
|---------------------------|-------------|--------|--------------------|-----------|
| F.A.P. RTE. | SECTION | COUNTY | TOTAL SHEETS | SHEET NO. |
| 311 | 2021-029-R5 | COOK | 42 | 32 |
| BD600-06 (BD-24) | | | CONTRACT NO. 62N78 | |
| ILLINOIS FED. AID PROJECT | | | | |

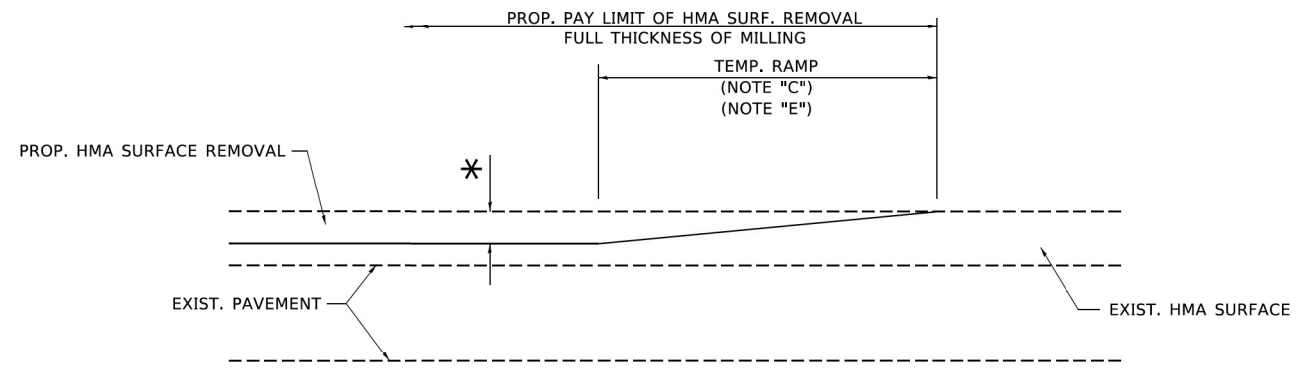

MILLED TEMPORARY RAMP

(FOR BUTT JOINT AND HMA TAPER SEE DETAIL BELOW)

OPTION 1

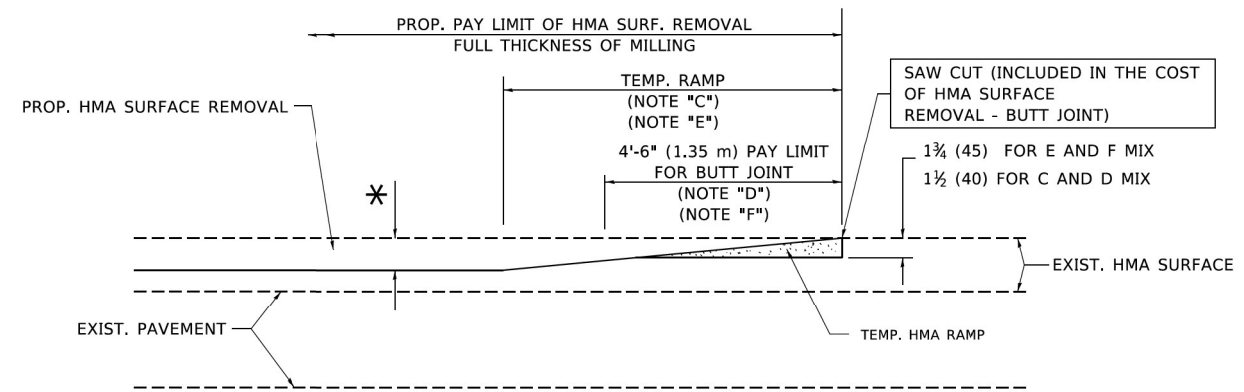

HMA CONSTRUCTED TEMPORARY RAMP

(FOR BUTT JOINT AND HMA TAPER SEE DETAIL BELOW)

OPTION 2

TYPICAL TEMPORARY RAMP

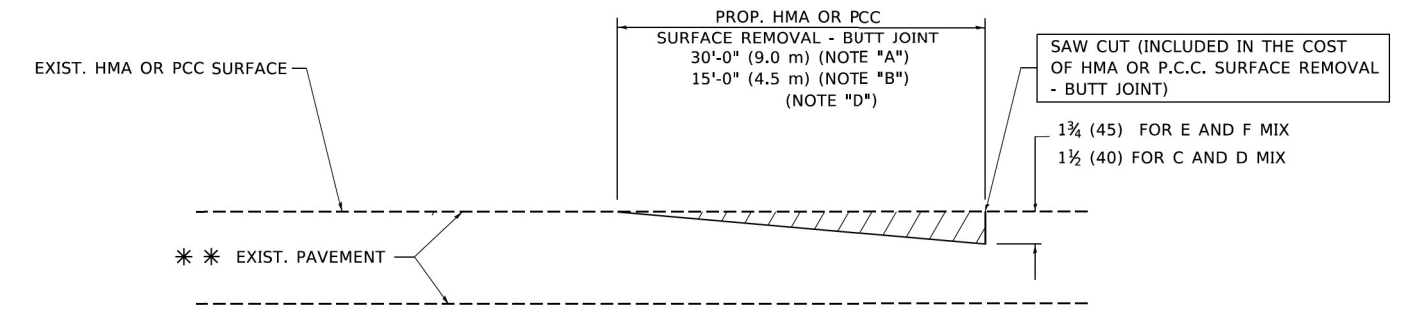

BUTT JOINT DETAIL

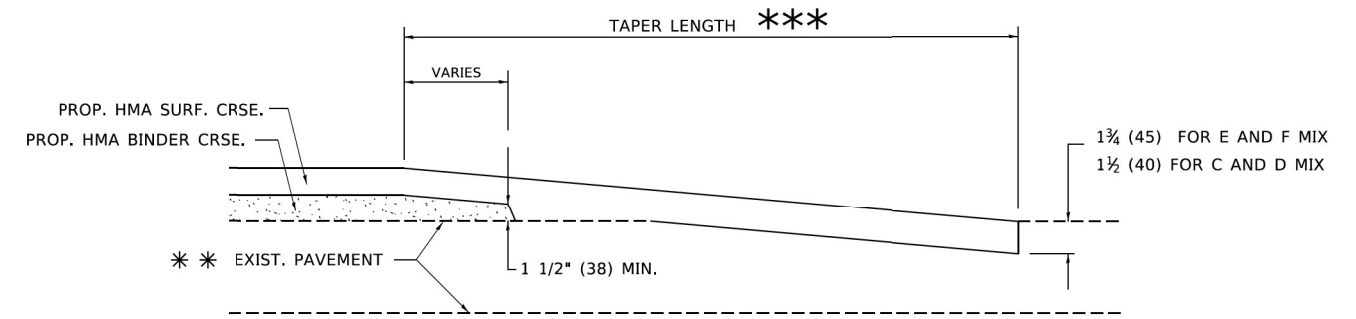

HMA TAPER DETAIL

TYPICAL BUTT JOINT AND HMA TAPER FOR RESURFACING ONLY

*** PC CONCRETE, HMA OR HMA RESURFACED PAVEMENT.

NOTES

- A. MAINLINE ROADWAYS AND MAJOR SIDE ROADS.
- B. MINOR SIDE ROADS.
- C. THE TEMP. RAMP SHALL BE CONSTRUCTED IMMEDIATELY UPON REMOVAL OF THE EXISTING HMA SURFACE.
- D. THE BUTT JOINT SHALL BE CONSTRUCTED IMMEDIATELY PRIOR TO PLACING THE PROPOSED HMA COURSES.
- E. TAPER THE TEMP. RAMP AT A RATE OF 3'-0" (900 mm) PER 1 INCH (25 mm) OF MILLING THICKNESS.
- F. INSTALLATION AND REMOVAL OF THE 4'-6" (1.35 m) TEMP. RAMP IS INCLUDED IN COST OF HMA SURFACE REMOVAL - BUTT JOINT.
* SEE TYPICAL SECTIONS FOR MILLING THICKNESS.
- G. SEE ARTICLE 406.08 AND 406.14 OF THE STANDARD SPECIFICATIONS FOR "HMA AND/OR PCC SURFACE REMOVAL, BUTT JOINT".
*** 20'-0" (6.1 m) PER 1 (25) RESURFACING (NOTE "A")
10'-0" (3.0 m) PER 1 (25) RESURFACING (NOTE "B")

BASIS OF PAYMENT

THE BUTT JOINT WILL BE PAID FOR AT THE CONTRACT UNIT PRICE PER SQUARE YARD (SQUARE METER) FOR "HOT-MIX ASPHALT SURFACE REMOVAL - BUTT JOINT" OR FOR "PORTLAND CEMENT CONCRETE SURFACE REMOVAL - BUTT JOINT".

ALL DIMENSIONS ARE IN INCHES (MILLIMETERS) UNLESS OTHERWISE SHOWN.

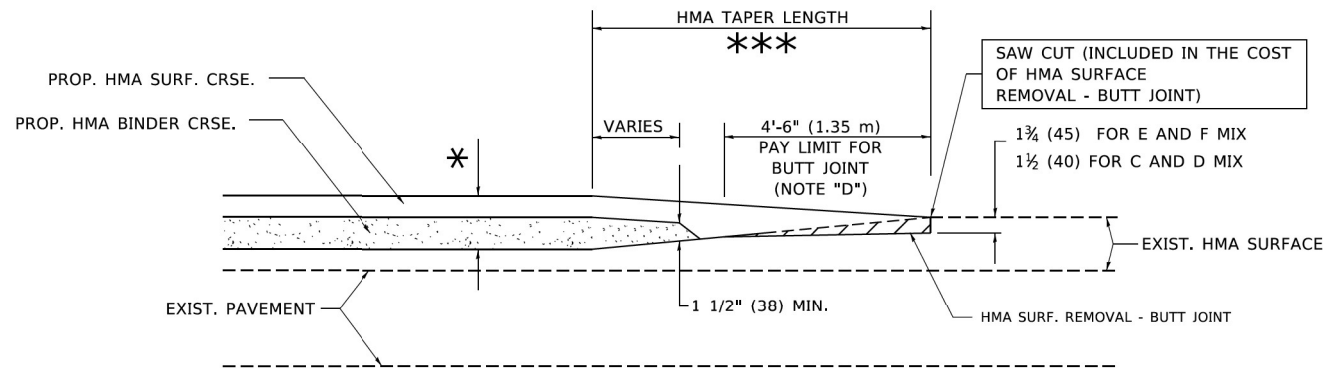

BUTT JOINT AND HMA TAPER

TYPICAL BUTT JOINT AND HMA TAPER FOR MILLING AND RESURFACING

MODEL: Default; FILE: M:\e...; PROJECT: ...; SHEET: ...

| | | |
|------------------------------|-----------------------|-----------------------------|
| USER NAME = footemj | DESIGNED - M. DE YONG | REVISED - R. SHAH 10-25-94 |
| | DRAWN - | REVISED - A. ABBAS 03-21-97 |
| PLOT SCALE = 50,0000 ' / ft. | CHECKED - | REVISED - M. GOMEZ 04-06-01 |
| PLOT DATE = 3/27/2019 | DATE - 06-13-90 | REVISED - R.BORO 01-01-07 |

**STATE OF ILLINOIS
DEPARTMENT OF TRANSPORTATION**

**BUTT JOINT AND
HMA TAPER DETAILS**

SCALE: NONE SHEET 1 OF 1 SHEETS STA. TO STA.

| F.A.P. RTE. | SECTION | COUNTY | TOTAL SHEETS | SHEET NO. |
|---------------------------|-------------|--------------------|--------------|-----------|
| 311 | 2021-029-R5 | COOK | 42 | 33 |
| BD400-05 BD32 | | CONTRACT NO. 62N78 | | |
| ILLINOIS FED. AID PROJECT | | | | |

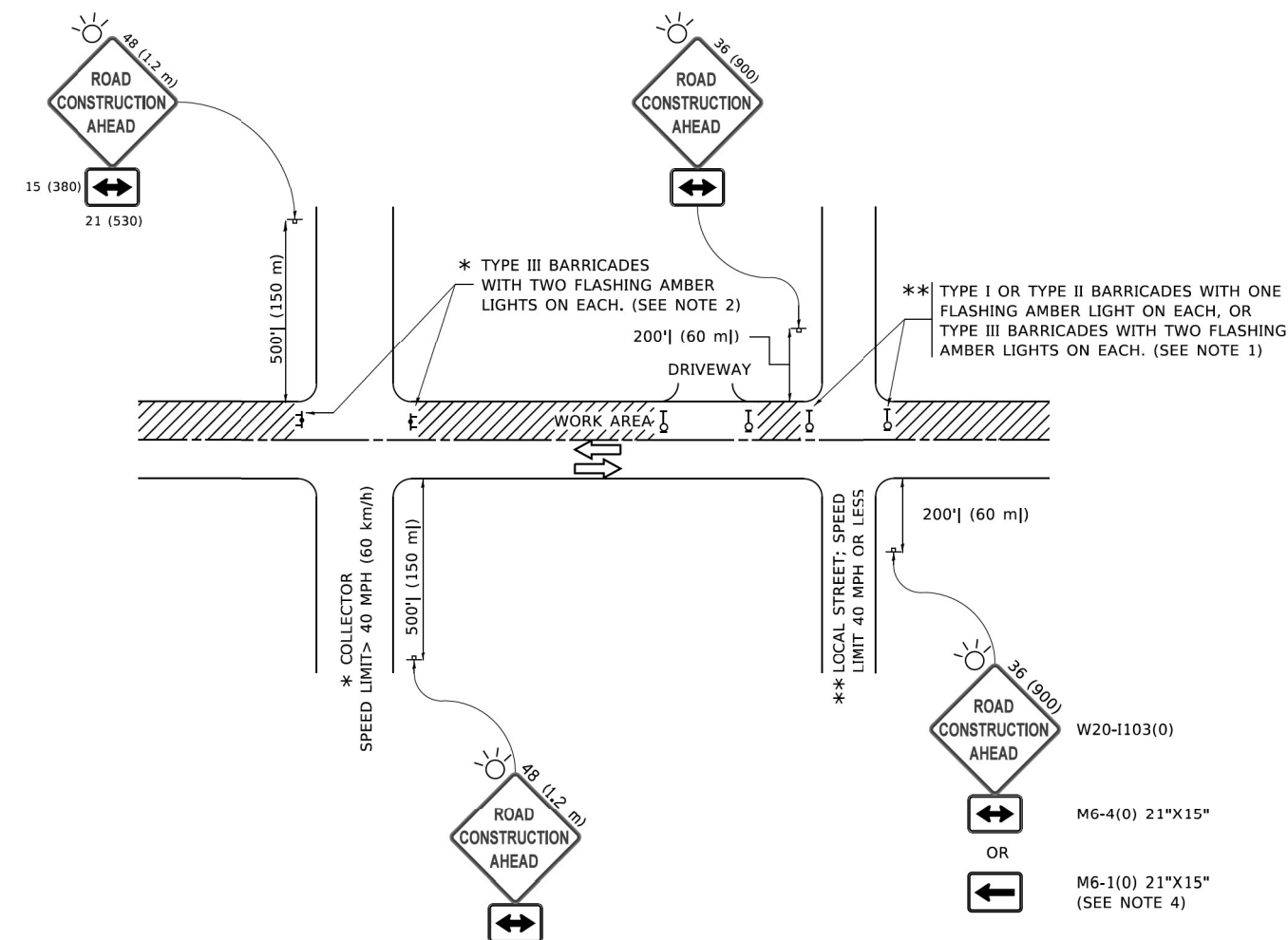

NOTES:

1. SIDE ROAD WITH A SPEED LIMIT OF 40 MPH (60 km/h) OR LESS AS SHOWN ON THE DRAWING AND AS DIRECTED BY THE ENGINEER:
 - a) ONE "ROAD CONSTRUCTION AHEAD" SIGN 36 x 36 (900x900) WITH A FLASHER MOUNTED ON IT APPROXIMATELY 200' (60 m) IN ADVANCE OF THE MAIN ROUTE.
 - b) THE CLOSED PORTION OF THE MAIN ROUTE SHALL BE PROTECTED BY BLOCKING WITH TYPE I, TYPE II OR TYPE III BARRICADES, 1/3 OF THE CROSS SECTION OF THE CLOSED PORTION.
2. SIDE ROAD WITH A SPEED LIMIT GREATER THAN 40 MPH (60 km/h) AS SHOWN ON THE DRAWING AND AS DIRECTED BY THE ENGINEER:
 - a) ONE "ROAD CONSTRUCTION AHEAD" SIGN 48 x 48 (1.2 m x 1.2 m) WITH A FLASHER MOUNTED ON IT APPROXIMATELY 500' (150 m) IN ADVANCE OF THE MAIN ROUTE.
 - b) BLOCKING WITH TYPE III BARRICADES, 1/2 OF THE CROSS SECTION OF THE CLOSED PORTION.
3. CONES MAY BE SUBSTITUTED FOR BARRICADES OR DRUMS AT HALF THE SPACING DURING DAY OPERATIONS. CONES SHALL BE A MINIMUM OF 28 (710) IN HEIGHT.
4. SIGNING AND THE WORK ZONE, A SINGLE HEADED ARROW (M6-1) SHALL BE USED IN LIEU OF THE DOUBLE HEADED ARROW (M6-4).
5. WHEN WORK IS BEING PERFORMED ON A SIDE ROAD OR DRIVEWAY, FOLLOW THE APPLICABLE STANDARD(S). THE DIRECTIONAL ARROW (M6-1 OR M6-4) SHALL BE COVERED OR REMOVED WHEN NO LONGER CONSISTENT WITH THE TRAFFIC CONTROL SET-UP.
6. ADVANCE WARNING SIGNS ARE TO BE OMITTED ON DRIVEWAYS UNLESS OTHERWISE SPECIFIED IN THE PLANS OR BY THE ENGINEER.
7. THE TRAFFIC CONTROL AND PROTECTION FOR SIDE ROADS, INTERSECTIONS, AND DRIVEWAYS SHALL BE INCLUDED IN THE COST OF SPECIFIED TRAFFIC CONTROL STANDARDS OR ITEMS.

All dimensions are in inches (millimeters) unless otherwise shown.

MODEL: Default; FILE NAME: p:\11084818\BID\NTEG\Illinois.gov\PIV\DOT\Documents\DOT Offices\District 1\Projects\Sub\22323\CAD\Drawn\CAD\Sheet\TC10.dgn

| | | |
|------------------------------|-------------------|---------------------------------|
| USER NAME = footemj | DESIGNED - L.H.A. | REVISED - A. HOUSEH 10-15-96 |
| | DRAWN - | REVISED - T. RAMMACHER 01-06-00 |
| PLOT SCALE = 50,0000 ' / ft. | CHECKED - | REVISED - A. SCHUETZE 07-01-13 |
| PLOT DATE = 3/4/2019 | DATE - 06-89 | REVISED - A. SCHUETZE 09-15-16 |

**STATE OF ILLINOIS
DEPARTMENT OF TRANSPORTATION**

**TRAFFIC CONTROL AND PROTECTION FOR
SIDE ROADS, INTERSECTIONS, AND DRIVEWAYS**

SCALE: NONE SHEET 1 OF 1 SHEETS STA. TO STA.

| F.A.P. RTE. | SECTION | COUNTY | TOTAL SHEETS | SHEET NO. |
|---------------------------|-------------|--------|--------------------|-----------|
| 311 | 2021-029-RS | COOK | 42 | 34 |
| TC-10 | | | CONTRACT NO. 62N78 | |
| ILLINOIS FED. AID PROJECT | | | | |

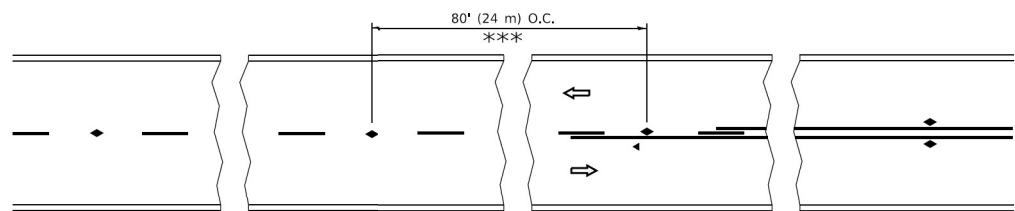

*** REDUCE TO 40' (12 m) O.C. ON CURVES WITH POSTED OR ADVISORY SPEED 45 M.P.H. (70 km/h) OR LESS.

TWO-LANE/TWO-WAY

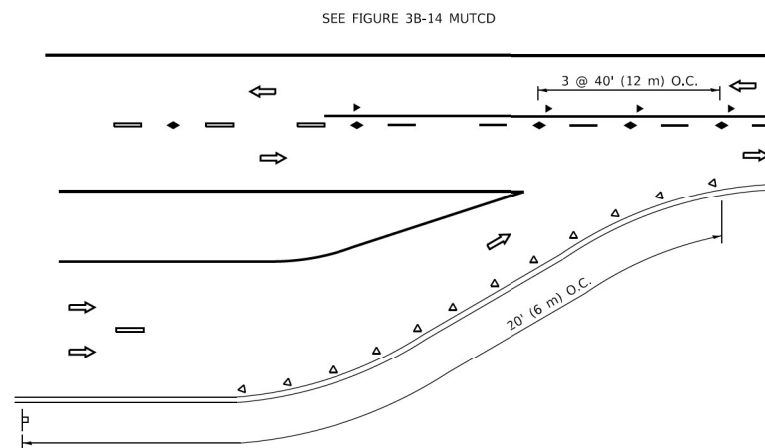

LANE REDUCTION TRANSITION

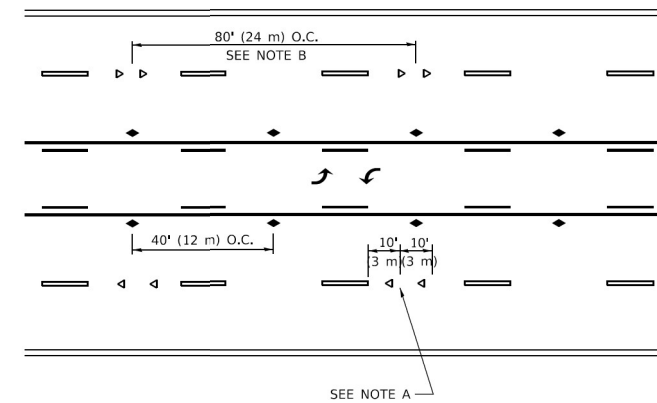

TWO-WAY LEFT TURN

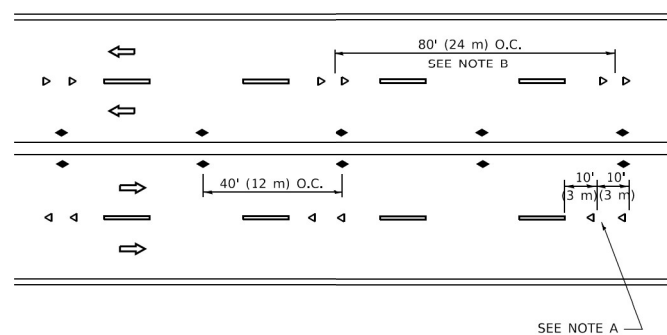

MULTI-LANE/UNDIVIDED

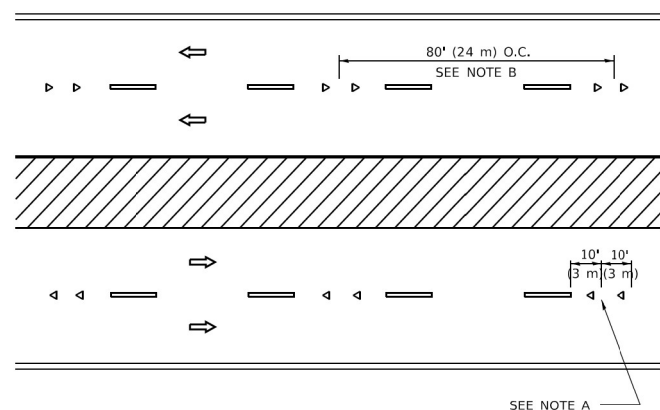

MULTI-LANE/DIVIDED

GENERAL NOTES

1. MARKERS USED WITH DASHED LINES SHALL BE CENTERED IN THE GAP BETWEEN SEGMENTS.
2. MARKERS USED ADJACENT TO SOLID LINES SHALL BE OFFSET 2 TO 3 (50 TO 75) TOWARD TRAFFIC AS SHOWN.
3. MARKERS THROUGH TANGENTS LESS THAN 500' (150 m) IN LENGTH BETWEEN CURVES SHALL BE INSTALLED AT THE LESSER OF THE TWO CURVE SPACINGS.
4. MARKERS ARE TO BE USED ADJACENT TO BOTH SOLID WHITE LINES IN DUAL LEFT TURN LANES

SYMBOLS

- YELLOW STRIPE
- WHITE STRIPE
- ◀ ONE-WAY AMBER MARKER
- ◀ ONE-WAY CRYSTAL MARKER (W/O)
- ◆ TWO-WAY AMBER MARKER

LANE MARKER NOTES

- A. USE DOUBLE LANE LINE MARKERS SPACED AS SHOWN.
- B. REDUCE TO 40' (12 m) O.C. ON CURVES WHERE ADVISORY SPEEDS ARE 10 M.P.H (20 km/h) LOWER THAN POSTED SPEEDS.

DESIGN NOTES

1. DOUBLE LANE LINE MARKERS SHALL BE USED UNLESS SPECIFIED OTHERWISE.
2. EXCEPT AS SHOWN ON THE LANE REDUCTION TRANSITION AND FREEWAY EXIT RAMP DETAIL, MARKERS ARE NOT TO BE SPECIFIED ON RIGHT EDGE LINES.
3. THE EXACT MARKER LIMITS, SPACING, AND COLOR SHALL BE INCLUDED IN THE PLANS WHEN STANDARD SPECIFICATIONS ARE NOT BEING USED.
4. MARKERS SHOULD NOT BE USED ALONGSIDE CURBS EXCEPT FOR EXTREMELY SHORT SECTIONS OF CJBRS WHERE NOT MORE THAN TWO MARKERS WOULD BE INVOLVED.

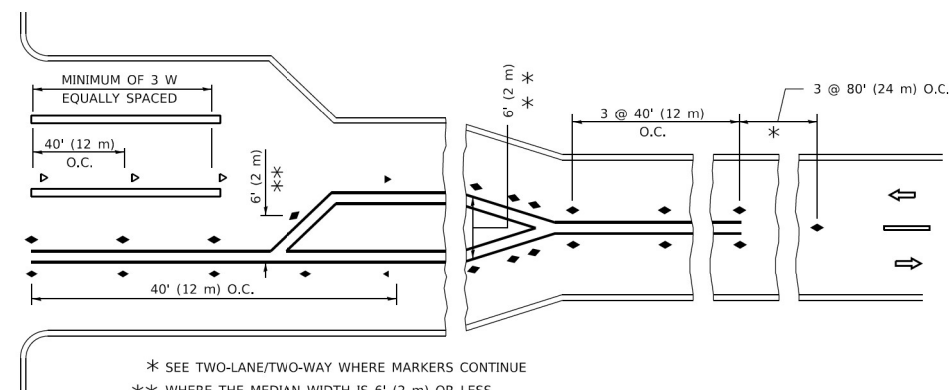
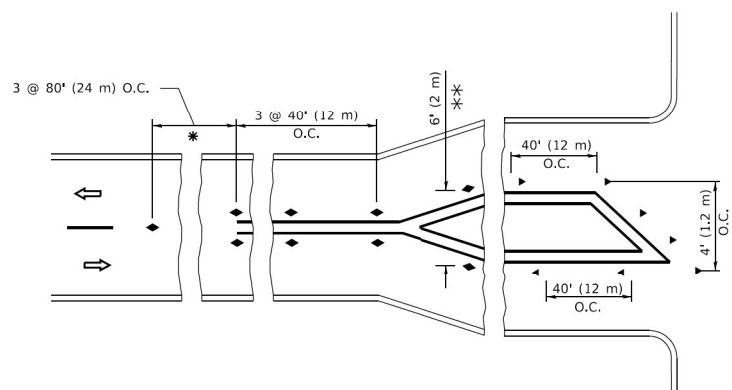

* SEE TWO-LANE/TWO-WAY WHERE MARKERS CONTINUE
 ** WHERE THE MEDIAN WIDTH IS 6' (2 m) OR LESS USE TWO-WAY MARKERS.

TURN LANES

All dimensions are in inches (millimeters) unless otherwise shown.

MODEL: Default; FILE NAME: p:\01084818\INTEG\Illinois.gov\PIV\DOT\Documents\DOT Offices\District 1\Projects\01084818\23-24\CADD\01\CAD\Sheet\11.dgn

| | | |
|----------------------------|------------|---------------------------------|
| USER NAME = footemj | DESIGNED - | REVISED - T. RAMMACHER 03-12-99 |
| | DRAWN - | REVISED - T. RAMMACHER 01-06-00 |
| PLOT SCALE = 50,0000' / 1" | CHECKED - | REVISED - C. JUCIUS 09-09-09 |
| PLOT DATE = 3/4/2019 | DATE - | REVISED - C. JUCIUS 07-01-13 |

**STATE OF ILLINOIS
 DEPARTMENT OF TRANSPORTATION**

| TYPICAL APPLICATIONS | | | |
|--|---------|-------------|--------------|
| RAISED REFLECTIVE PAVEMENT MARKERS (SNOW-PLOW RESISTANT) | | | |
| SCALE: NONE | SHEET 1 | OF 1 SHEETS | STA. TO STA. |

| F.A.P. RTE. | SECTION | COUNTY | TOTAL SHEETS | SHEET NO. |
|---------------------------|-------------|--------|--------------------|-----------|
| 311 | 2021-029-R5 | COOK | 42 | 35 |
| TC-11 | | | CONTRACT NO. 62N78 | |
| ILLINOIS FED. AID PROJECT | | | | |

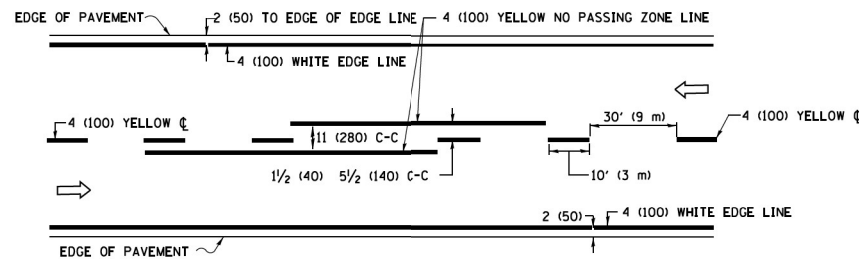

2-LANE ROADWAY

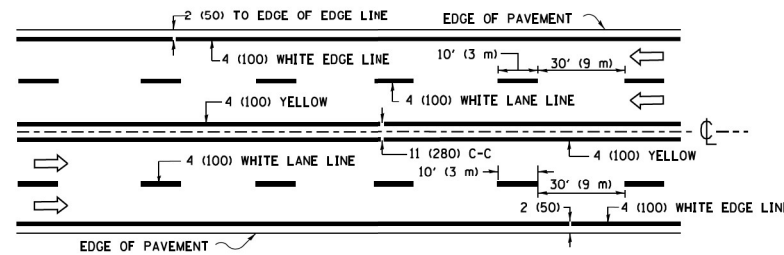

MULTI-LANE UNDIVIDED

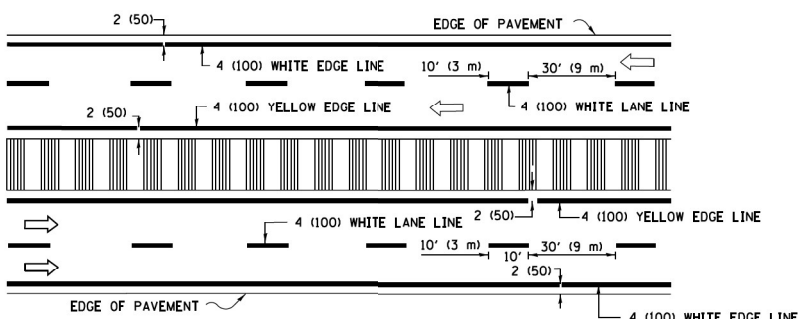

MULTI-LANE DIVIDED WITH MEDIAN

TYPICAL LANE AND EDGE LINE MARKING

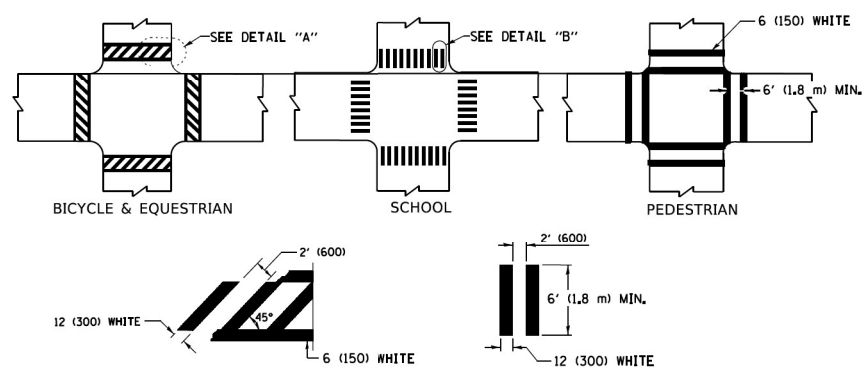

TYPICAL CROSSWALK MARKING

* MARKINGS SHALL BE INSTALLED PARALLEL TO THE CENTERLINE OF THE ROAD WHICH IT CROSSES

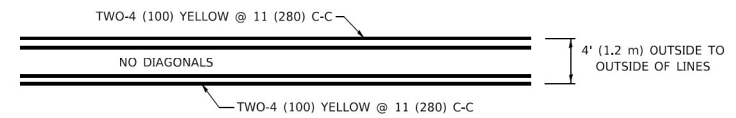

4' (1.2 m) WIDE MEDIANS ONLY

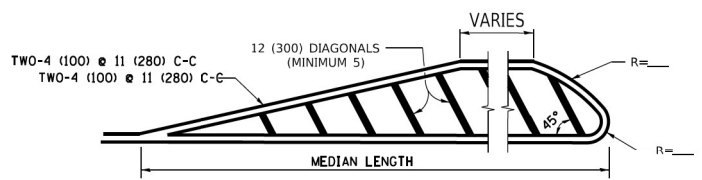

MEDIANS OVER 4' (1.2 m) WIDE

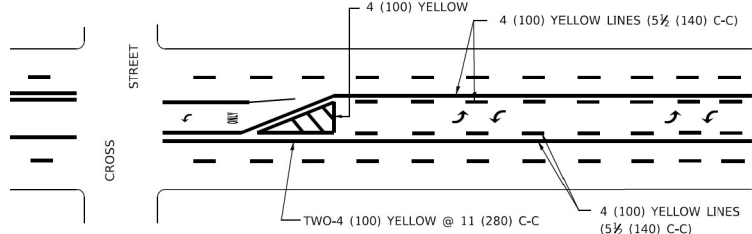

MEDIAN WITH TWO-WAY LEFT TURN LANE TYPICAL PAINTED MEDIAN MARKING

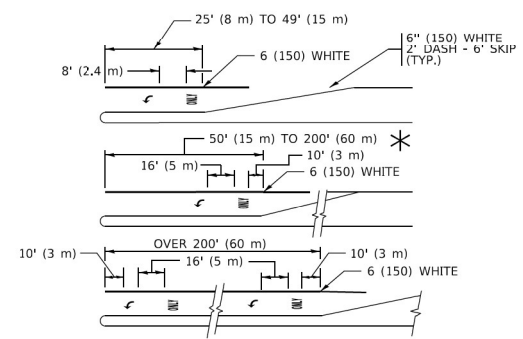

TYPICAL LEFT (OR RIGHT) TURN LANE

TYPICAL TURN LANE MARKING

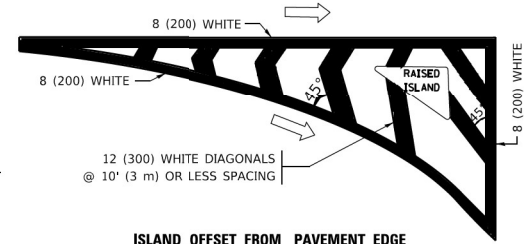

ISLAND OFFSET FROM PAVEMENT EDGE

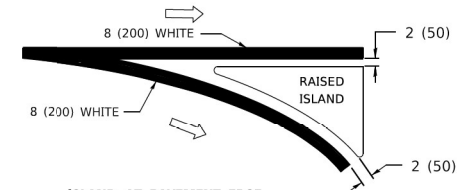

ISLAND AT PAVEMENT EDGE

TYPICAL ISLAND MARKING

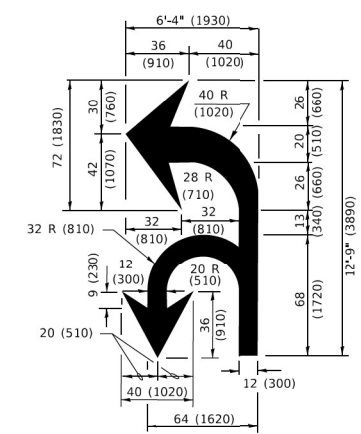

COMBINATION LEFT AND U-TURN

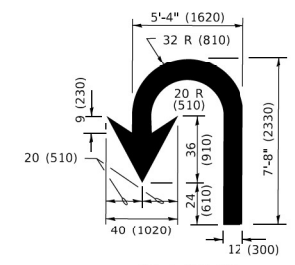

U-TURN

LANE REDUCTION TRANSITION

* LANE REDUCTION ARROWS REQUIRED AT SPEEDS OF 45 MPH OR GREATER OR WHEN SPECIFIED IN PLANS.

| D(FT) | SPEED LIMIT |
|-------|-------------|
| 345 | 30 |
| 425 | 35 |
| 500 | 40 |
| 580 | 45 |
| 665 | 50 |
| 750 | 55 |

| TYPE OF MARKING | WIDTH OF LINE | PATTERN | COLOR | SPACING / REMARKS |
|---|--|------------------------------|---|---|
| CENTERLINE ON 2 LANE PAVEMENT | 4 (100) | SKIP-DASH | YELLOW | 10' (3 m) LINE WITH 30' (9 m) SPACE |
| CENTERLINE ON MULTI-LANE UNDIVIDED PAVEMENT | 2 @ 4 (100) | SOLID | YELLOW | 11 (280) C-C |
| NO PASSING ZONE LINES: FOR ONE DIRECTION FOR BOTH DIRECTIONS | 4 (100) 2 @ 4 (100) | SOLID SOLID | YELLOW YELLOW | 5 1/2 (140) C-C FROM SKIP-DASH CENTERLINE 11 (280) C-C OMIT SKIP-DASH CENTERLINE BETWEEN |
| LANE LINES | 4 (100) 5 (125) ON FREEWAYS | SKIP-DASH SKIP-DASH | WHITE WHITE | 10' (3 m) LINE WITH 30' (9 m) SPACE |
| DOTTED LINES (EXTENSIONS OF CENTER, LANE OR TURN LANE MARKINGS) | SAME AS LINE BEING EXTENDED | SKIP-DASH | SAME AS LINE BEING EXTENDED | 2' (600) LINE WITH 6' (1.8 m) SPACE |
| EDGE LINES | 4 (100) | SOLID | YELLOW-LEFT WHITE-RIGHT | OUTLINE MEDIANS IN YELLOW |
| TURN LANE MARKINGS | 6 (150) LINE; FULL SIZE LETTERS & SYMBOLS (8' (2.4m)) | SOLID | WHITE | SEE TYPICAL TURN LANE MARKING DETAIL |
| TWO WAY LEFT TURN MARKING | 2 @ 4 (100) EACH DIRECTION 8' (2.4m) LEFT ARROW | SKIP-DASH AND SOLID IN PAIRS | YELLOW WHITE | 10' (3 m) LINE WITH 30' (9 m) SPACE FOR SKIP-DASH; 5 1/2 (140) C-C BETWEEN SOLID LINE AND SKIP-DASH LINE SEE TYPICAL TWO-WAY LEFT TURN MARKING DETAIL |
| CROSSWALK LINES (PEDESTRIAN) A. DIAGONALS (BIKE & EQUESTRIAN) B. LONGITUDINAL BARS (SCHOOL) | 2 @ 6 (150) 2' (600) APART 12 (300) @ 45° 12 (300) @ 90° | SOLID SOLID SOLID | WHITE WHITE WHITE | NOT LESS THAN 6' (1.8 m) APART 2' (600) APART SEE TYPICAL CROSSWALK MARKING DETAILS. |
| STOP LINES | 24 (600) | SOLID | WHITE | PLACE 4' (1.2 m) IN ADVANCE OF AND PARALLEL TO CROSSWALK, IF PRESENT, OTHERWISE, PLACE AT DESIRED STOPPING POINT. PARALLEL TO CROSSROAD CENTERLINE, WHERE POSSIBLE. |
| PAINTED MEDIANS | 2 @ 4 (100) WITH 12 (300) DIAGONALS @ 45° NO DIAGONALS USED FOR 4' (1.2 m) WIDE MEDIANS | SOLID | YELLOW: TWO WAY TRAFFIC WHITE: ONE WAY TRAFFIC | 11 (280) C-C FOR THE DOUBLE LINE SEE TYPICAL PAINTED MEDIAN MARKING. |
| GORE MARKING AND CHANNELIZING LINES | 8 (200) WITH 12 (300) DIAGONALS @ 45° | SOLID | WHITE | DIAGONALS: 15' (4.5 m) C-C (LESS THAN 30MPH (50 km/h)) 20' (6 m) C-C (30 MPH (50 km/h) TO 45MPH (70 km/h)) 30' (9 m) C-C (OVER 45MPH (70 km/h)) |
| RAILROAD CROSSING | 24 (600) TRANSVERSE LINES; "RR" 15' 6" (1.8 m) LETTERS; 16 (400) LINE FOR "X" | SOLID | WHITE | SEE STATE STANDARD 780001 AREA OF: "R"=3.6 SQ. FT. (0.33 m ² EACH) "X"=54.0 SQ. FT. (5.0 m ²) |
| SHOULDER DIAGONALS (REQUIRED FOR SHOULDERS ≥ 8') | 12 (300) @ 45° | SOLID | WHITE - RIGHT YELLOW - LEFT | 50' (15 m) C-C (LESS THAN 30MPH (50 km/h)) 75' (25 m) C-C (30 MPH (50 km/h) TO 45MPH (70 km/h)) 150' (45 m) C-C (OVER 45MPH (70 km/h)) |
| U TURN ARROW | SEE DETAIL | SOLID | WHITE | 16.3 SF |
| 2 ARROW COMBINATION LEFT AND U TURN | SEE DETAIL | SOLID | WHITE | 30.4 SF |

FOR FURTHER DETAILS ON PAVEMENT MARKING REFER TO STANDARD SPECIFICATIONS FOR ROAD AND BRIDGE CONSTRUCTION AND STATE STANDARD 780001.

All dimensions are in inches (millimeters) unless otherwise shown.

MODEL: Default
FILE NAME: p:\work\1104848\BID\INTEC\Illinois.gov\RIDOT\Documents\DOT Offices\Dist1ct 1\Projects\Dist1ct1\2023-24\CADD\Dist1\CADsheets\13.dgn

| | | |
|--------------------------|------------------|------------------------------|
| USER NAME = footemj | DESIGNED - EVERS | REVISED - C. JUCIUS 09-09-09 |
| | DRAWN - | REVISED - C. JUCIUS 07-01-13 |
| PLOT SCALE = 50,0000 1/1 | CHECKED - | REVISED - C. JUCIUS 12-21-15 |
| PLOT DATE = 3/4/2019 | DATE - 03-19-90 | REVISED - C. JUCIUS 04-12-16 |

STATE OF ILLINOIS DEPARTMENT OF TRANSPORTATION

DISTRICT ONE TYPICAL PAVEMENT MARKINGS

SCALE: NONE SHEET 1 OF 2 SHEETS STA. TO STA.

| | | | | |
|-----------------|---------------------|--------------------|-----------------|--------------|
| F.A.P. RTE. 311 | SECTION 2021-029-R5 | COUNTY COOK | TOTAL SHEETS 42 | SHEET NO. 36 |
| TC-13 | | CONTRACT NO. 62N78 | | |
| ILLINOIS | | FED. AID PROJECT | | |

TURN BAY ENTRANCE AT START OF LANE CLOSURE TAPER

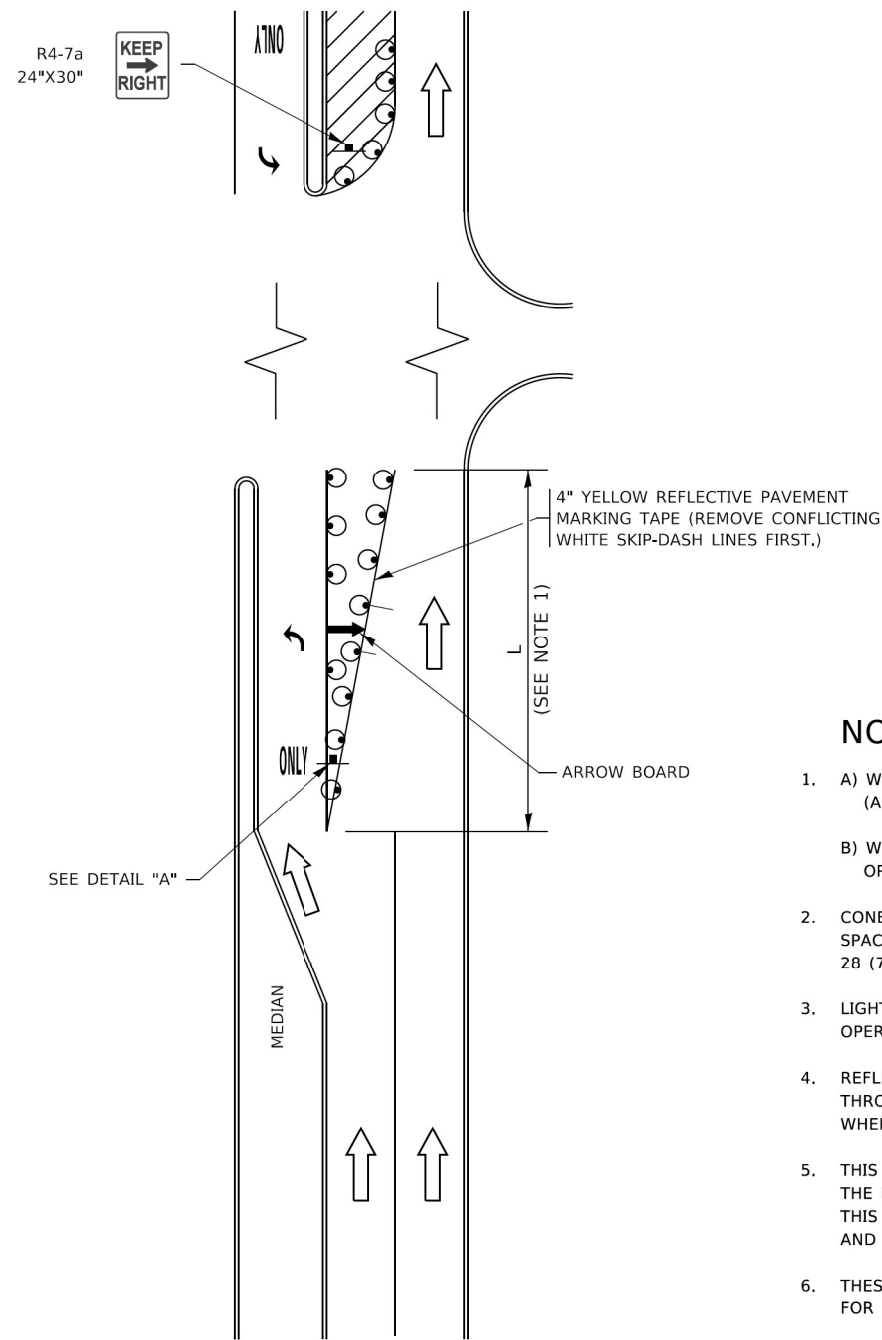

FIGURE 1

TURN BAY ENTRANCE WITHIN A LANE CLOSURE

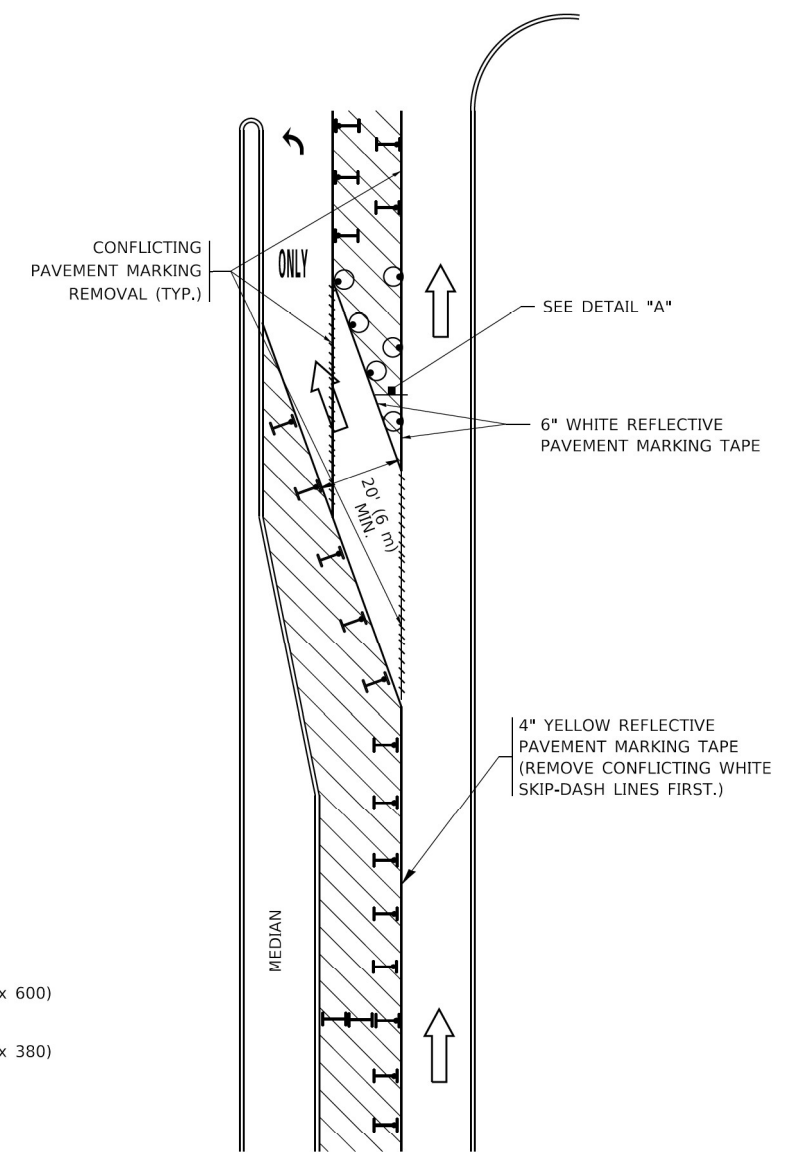

FIGURE 2

LEGEND

- WORK AREA
- LANE OPEN TO TRAFFIC
- ARROW BOARD
- TYPE I OR II BARRICADE OR DRUM WITH STEADY BURN LIGHT
- DRUM WITH STEADY BURN LIGHT
- SIGN ASSEMBLY
- TYPE I OR II CHECK BARRICADE WITH FLASHING LIGHT

NOTES:

1. A) WHEN "L" IS ≤ THE STORAGE LENGTH OF THE TURN LANE (AS SHOWN IN FIG. 1), USE FIGURE 1.
B) WHEN "L" IS > THE STORAGE LENGTH OF THE TURN LANE OR THE TURN LANE IS WITHIN THE LANE CLOSURE, USE FIGURE 2.
2. CONES MAY BE SUBSTITUTED FOR BARRICADES OR DRUMS AT HALF THE SPACING DURING DAY OPERATIONS. CONES SHALL BE A MINIMUM OF 28 (710) IN HEIGHT.
3. LIGHTS WILL NOT BE REQUIRED ON BARRICADES OR DRUMS FOR DAY OPERATIONS. ALL LIGHTS SHALL BE MONODIRECTIONAL.
4. REFLECTIVE TEMPORARY PAVEMENT MARKINGS SHALL BE PLACED THROUGHOUT THE BARRICADED AREAS OF EACH TURN BAY AS SHOWN WHERE THE CLOSURE TIME IS GREATER THAN FOURTEEN (14) DAYS.
5. THIS APPLICATION ALSO APPLIES WHEN WORK IS BEING PERFORMED IN THE RIGHT LANE(S) AND THE RIGHT TURN BAY IS TO REMAIN OPEN. UNDER THIS CONDITION, "RIGHT TURN LANE" R3-1100R 24 x 24 (600 x 600) AND M6-2R 21 x 15 (530 x 380) SHALL BE USED.
6. THESE CONTROLS SHALL SUPPLEMENT MAINLINE TRAFFIC CONTROL FOR LANE CLOSURES.
7. THE SIGNS SHALL BE MOUNTED ABOVE THE BARRICADES/DRUMS ON SEPARATE SIGN SUPPORTS THAT MEET NCHRP 350 OR MASH REQUIREMENTS.
8. TRAFFIC CONTROL AND PROTECTION AT TURN BAYS (TO REMAIN OPEN TO TRAFFIC) SHALL BE INCLUDED IN THE COST OF SPECIFIED TRAFFIC CONTROL STANDARDS OR ITEMS.

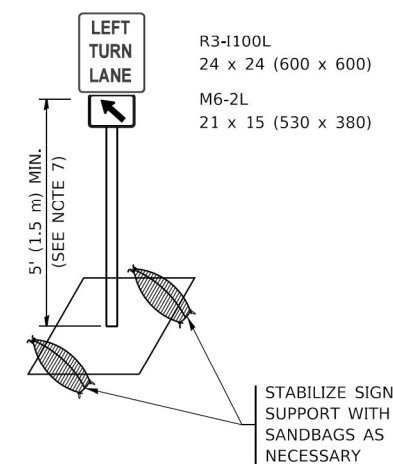

DETAIL A

All dimensions are in inches (millimeters) unless otherwise shown.

MODEL: Default; FILE NAME: p:\110848\BENTLEY\Illinois.gov\PIV\DOT\Documents\DOT Offices\District 1\Projects\Dist1\2021\21-CAD\Drawings\CAD\Sheet14.dgn

| | | |
|------------------------------|----------------------------------|--------------------------------|
| USER NAME = footemj | DESIGNED - T. RAMMACHER 09-08-94 | REVISED - R. BORO 09-14-09 |
| | DRAWN - A. HOUSEH 11-07-95 | REVISED - A. SCHUETZE 07-01-13 |
| PLOT SCALE = 50,0000 ' / ft. | CHECKED - A. HOUSEH 10-12-96 | REVISED - A. SCHUETZE 09-15-16 |
| PLOT DATE = 3/4/2019 | DATE - T. RAMMACHER 01-06-00 | REVISED - |

**STATE OF ILLINOIS
DEPARTMENT OF TRANSPORTATION**

**TRAFFIC CONTROL AND PROTECTION AT TURN BAYS
(TO REMAIN OPEN TO TRAFFIC)**

SCALE: NONE SHEET 1 OF 1 SHEETS STA. TO STA.

| | | | | |
|---------------------------|-------------|--------------------|--------------|-----------|
| F.A.P. RTE. | SECTION | COUNTY | TOTAL SHEETS | SHEET NO. |
| 311 | 2021-029-R5 | COOK | 42 | 37 |
| TC-14 | | CONTRACT NO. 62N78 | | |
| ILLINOIS FED. AID PROJECT | | | | |

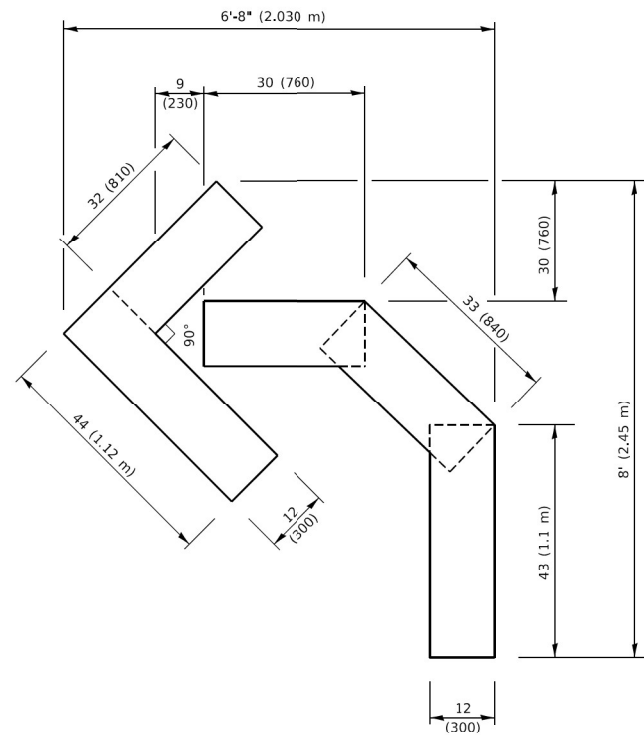

QUANTITY

4 (100) LINE = 45.5 ft. (13.9 m)
15.2 sq. ft. (1.41 sq. m)

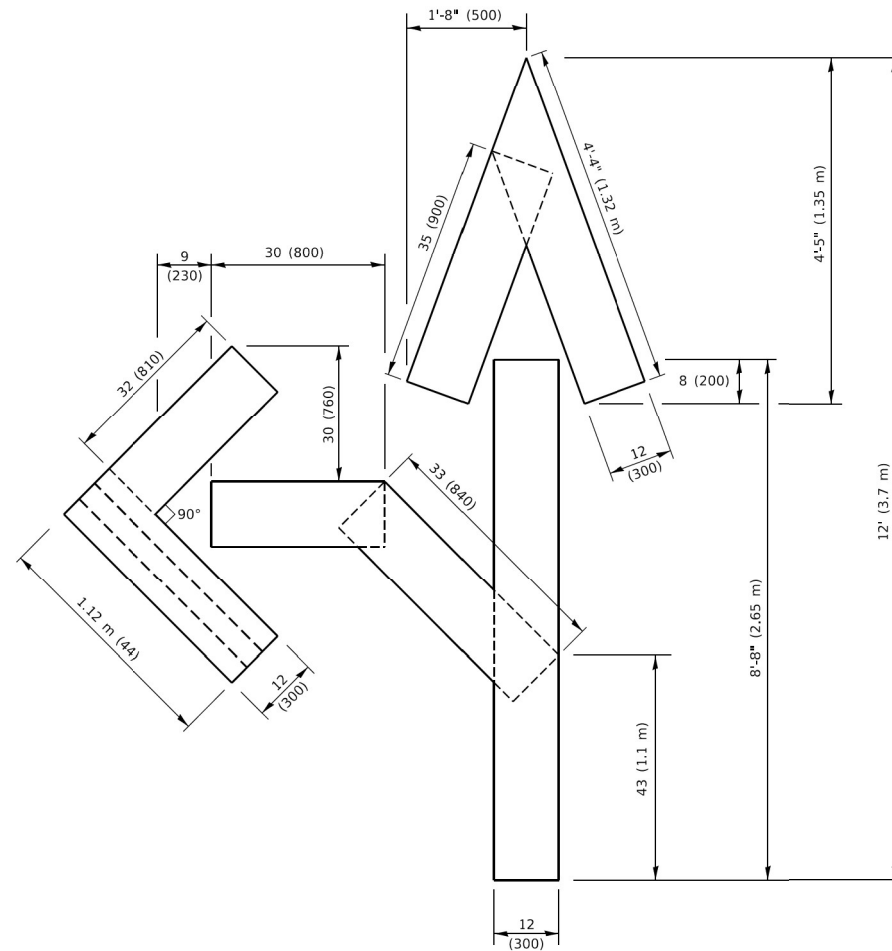

QUANTITY

4 (100) LINE = 82.5 ft. (25.1 m)
27.5 sq. ft. (2.53 sq. m)

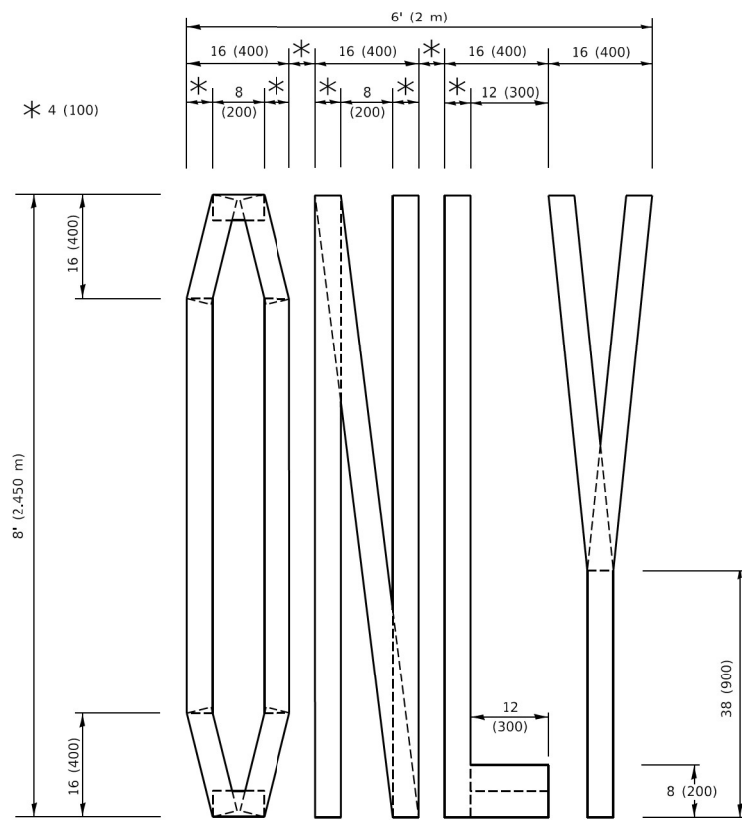

QUANTITY

4 (100) LINE = 64.1 ft. (19.5 m)
21.4 sq. ft. (1.99 sq. m)

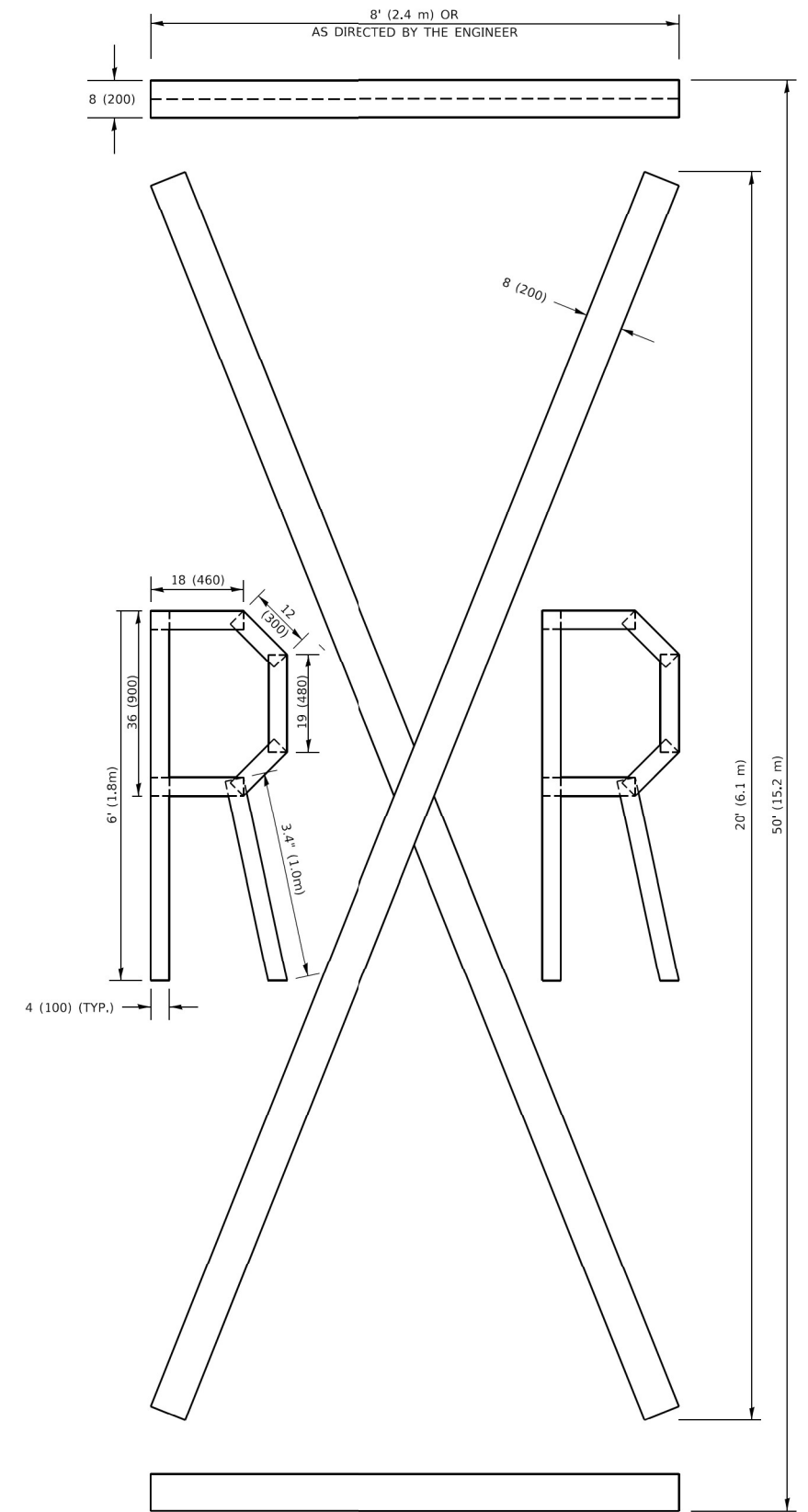

QUANTITY

4 (100) LINE = 225.9 ft. (68.9 m)
75.3 sq. ft. (6.99 sq. m)

NOTE:

ALL QUANTITIES OF PLACEMENT ARE REPRESENTED IN LINEAR FEET OF 4" LINES TO MATCH THE 4" TEMPORARY TAPE PAY ITEM AND REPRESENTS THE TOTAL QUANTITY OF 4" TAPE REQUIRED.

All dimensions are in inches (millimeters) unless otherwise shown.

MODEL: Defaulr
FILE NAME: p:\illinois\pav\DOT\Documents\DOT_Offices\Berket_1\Projects\IDS\S22\34\CADD\ba\CAD\sheet\16.dgn

| | | |
|-----------------------------|-----------------|---------------------------------|
| USER NAME = footemj | DESIGNED - | REVISED - T. RAMMACHER 03-02-98 |
| | DRAWN - | REVISED - E. GOMEZ 08-28-00 |
| PLOT SCALE = 50.0068" / ft. | CHECKED - | REVISED - E. GOMEZ 08-28-00 |
| PLOT DATE = 3/4/2019 | DATE - 09-18-94 | REVISED - A. SCHUETZE 09-15-16 |

**STATE OF ILLINOIS
DEPARTMENT OF TRANSPORTATION**

SHORT TERM PAVEMENT MARKING LETTERS AND SYMBOLS

SCALE: NONE SHEET 1 OF 1 SHEETS STA. TO STA.

| F.A.P. RTE. | SECTION | COUNTY | TOTAL SHEETS | SHEET NO. |
|---------------------------|-------------|--------|--------------------|-----------|
| 311 | 2021-029-R5 | COOK | 42 | 38 |
| TC-16 | | | CONTRACT NO. 62N78 | |
| ILLINOIS FED. AID PROJECT | | | | |

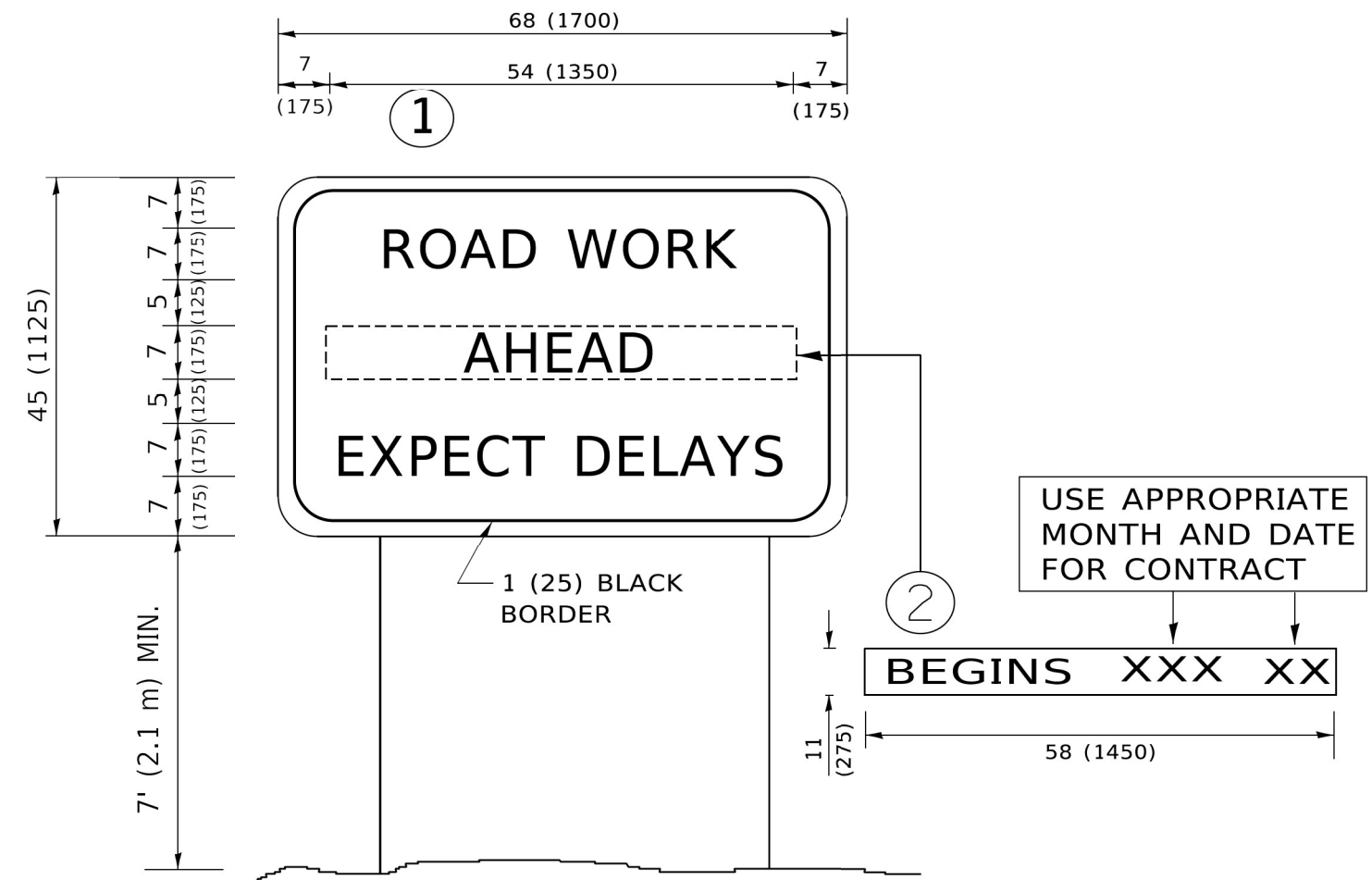

NOTES:

1. USE BLACK LETTERING ON ORANGE BACKGROUND.
2. ERECT SIGNS IN ADVANCE OF THE LOCATION FOR THE "ROAD CONSTRUCTION AHEAD" SIGN AT LOCATIONS AS DIRECTED BY THE ENGINEER.
3. ERECT SIGN ① WITH INSTALLED PANEL ② ONE WEEK PRIOR TO THE START OF CONSTRUCTION.
4. REMOVE PANEL ② SOON AFTER THE START OF CONSTRUCTION.
5. SEE SPECIAL PROVISION FOR "TEMPORARY INFORMATION SIGNING" FOR ADDITIONAL INFORMATION.
6. ONE SIGN ASSEMBLY EQUALS 25.70 SQ. FT. (2.3 SQ. M.)
7. SHALL BE PAID FOR AS TEMPORARY INFORMATION SIGNING.

ALL DIMENSIONS ARE IN INCHES (MILLIMETERS) UNLESS OTHERWISE SHOWN.

MODEL: Default; FILE NAME: p:\u00484EBD\NTEG\Illinois.gov\PIV\DOT\Documents\DOT Offices\District 1\Projects\DU\S423\21\CADD\NA\CAD\sheet122.dgn

| | | |
|------------------------------|------------|---------------------------------|
| USER NAME = footemj | DESIGNED - | REVISED - R. MIRS 09-15-97 |
| | DRAWN - | REVISED - R. MIRS 12-11-97 |
| PLOT SCALE = 50,0000 ' / ft. | CHECKED - | REVISED - T. RAMMACHER 02-02-99 |
| PLOT DATE = 3/4/2019 | DATE - | REVISED - C. JUCIUS 01-31-07 |

**STATE OF ILLINOIS
DEPARTMENT OF TRANSPORTATION**

**ARTERIAL ROAD
INFORMATION SIGN**

SCALE: NONE SHEET 1 OF 1 SHEETS STA. TO STA.

| F.A.P. RTE. | SECTION | COUNTY | TOTAL SHEETS | SHEET NO. |
|---------------------------|-------------|--------|--------------------|-----------|
| 311 | 2021-029-R5 | COOK | 42 | 39 |
| TC-22 | | | CONTRACT NO. 62N78 | |
| ILLINOIS FED. AID PROJECT | | | | |

LOOP DETECTOR NOTES

1. EACH PAIR OF LOOP WIRES SHALL BE PLACED IN A SEPARATE EMPTY COILABLE NONMETALLIC CONDUIT FROM THE EDGE OF PAVEMENT TO THE HANDHOLE. SPACING BETWEEN THE HOLES DRILLED IN THE PAVEMENT SHALL NOT BE LESS THAN 6" (150 mm). EMPTY COILABLE NONMETALLIC CONDUIT SHALL BE INCLUDED IN THE COST OF THE LOOP WIRE.
2. THE NUMBER OF LOOP TURNS SHALL BE AS RECOMMENDED BY THE AMPLIFIER MANUFACTURER. ALL ADJACENT SIDES OF THE LOOPS SHALL BE INSTALLED IN SUCH A WAY THAT THE CURRENT FLOW IS IN THE SAME DIRECTION TO REINFORCE ITS MAGNETIC FIELDS FOR SMALL VEHICLE DETECTION.
3. EACH LOOP LEAD-IN SHALL BE IDENTIFIED AND PERMANENTLY TAGGED IN THE HANDHOLE. EACH LEAD-IN CABLE TAG SHALL INDICATE THE LOCATION OF THE LOOP, LOOP ROTATION (CLOCKWISE/COUNTERCLOCKWISE), LOOP LEAD-IN DIRECTION (IN OR OUT), LOOP CABLE NUMBER AND LOCATION IN CABINET, AND NUMBER OF TURNS IN THE DETECTOR LOOPS IN WATER PROOF INK AS INDICATED ON THE DISTRICT 1 STANDARD TRAFFIC SIGNAL DESIGN DETAIL. THE CONTRACTOR SHALL MARK LOOP LOCATIONS ON RECORD DRAWINGS AND PRESENT TO THE ENGINEER AFTER FINAL INSPECTION. LOOPS SHALL BE MARKED BY LANE AND LOOP NUMBER. SEE DETAIL BELOW.
4. ALL LOOP CABLE SHALL BE FASTENED WITH PLASTIC TIE WRAP TO THE HANDHOLE HOOKS.
5. IN ASPHALT PAVEMENT, LOOPS SHOULD BE PLACED IN THE BINDER AND DIVESHOLES MARKED AT THE CURB WITH A SAW-CUT. THE SAW-CUT SHALL BE CUT IN ACCORDANCE WITH LOCAL AND E.P.A. DUST CONTROL REQUIREMENTS. DETECTOR LOOP(S) SHALL NOT BE INSTALLED IN WET CONDITIONS AND THE SAW-CUTS MUST BE FREE OF DEBRIS AND RESIDUE SUCH AS DUST AND WATER WHICH IS TO BE ACHIEVED BY THE USE OF COMPRESSED AIR, WIRE BRUSHING AND HEAT DRYING ACCORDING TO SEALANT MANUFACTURER REQUIREMENTS. THE DETECTOR WIRE SHALL BE HELD IN PLACE BY THE USE OF FORM WEDGES. WEDGES SHALL BE SPACED NO MORE THAN 18" (450 mm) APART.
6. LOOP SPLICES SHALL BE SOLDERED USING A SOLDERING IRON. BLOW TORCHES OR OTHER DEVICES WHICH OXIDIZE COPPER CABLE SHALL NOT BE ALLOWED FOR SOLDERING OPERATIONS. SEE DETAIL BELOW RIGHT.
7. PREFORMED DETECTOR LOOPS SHALL BE USED, AS SHOWN ON THE PLANS, WHERE NEW CONCRETE PAVEMENT IS PROPOSED. THE INSTALLATION OF PREFORMED LOOPS SHALL BE IN ACCORDANCE WITH THE DISTRICT 1 SPECIFICATIONS OR AS DIRECTED BY THE ENGINEER.

LOOP LEAD-IN CABLE TAG

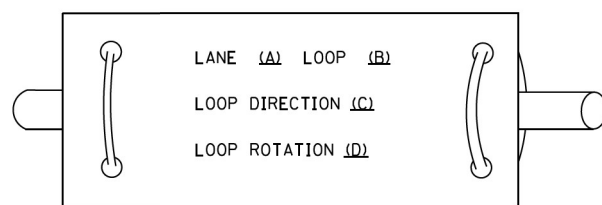

- A. LANE 1 IS THE LANE CLOSEST TO THE CENTERLINE OF THE ROADWAY
- B. LOOP #1 IS THE LOOP IN THE LANE CLOSEST TO THE INTERSECTION.
- C. LABEL LOOP CABLE "IN" OR LOOP CABLE "OUT".
- D. LABEL LOOP CABLE CLOCKWISE OR LOOP CABLE COUNTERCLOCKWISE.

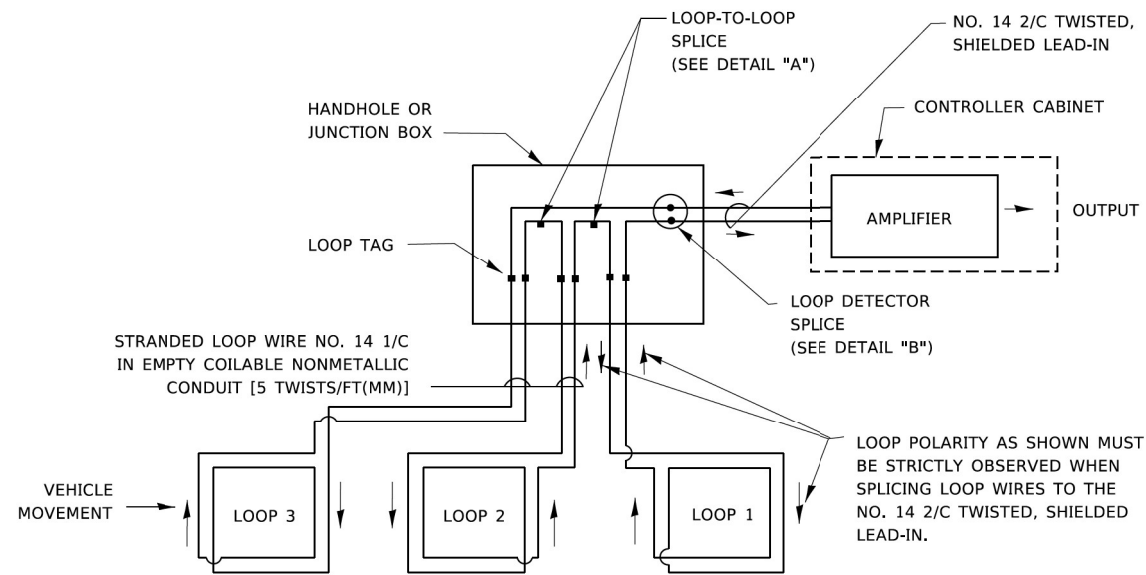

DETECTOR LOOP WIRING SCHEMATIC

- LOOPS SHALL BE SPLICED IN SERIES. SAW-CUTS SHALL BE A MINIMUM WIDTH OF 5/16" (8 mm).
- SAW-CUT DEPTHS SHALL BE 3" (75 mm). IF IN CONCRETE.
- THE SAW-CUT DEPTH SHALL BE TO THE TOP OF THE REINFORCEMENT.
- LOOP CORNERS SHALL BE DRILLED WITH A 2" (50 mm) DIAMETER CORE.

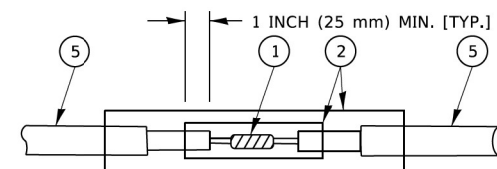

DETAIL "A"
LOOP-TO-LOOP SPLICE

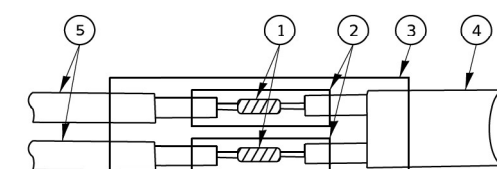

DETAIL "B"
LOOP-TO-CONTROLLER SPLICE

TYPE I LOOP

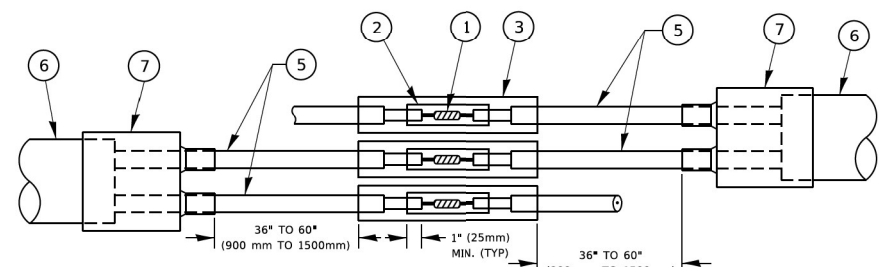

DETAIL "A"
LOOP-TO-LOOP SPLICE

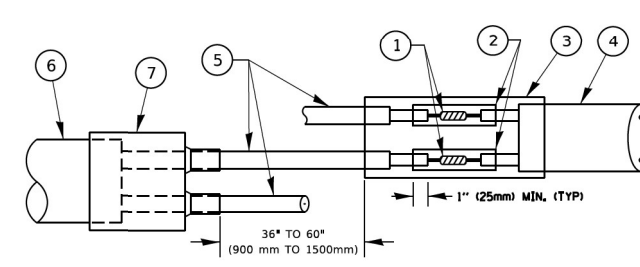

DETAIL "B"
LOOP-TO-CONTROLLER SPLICE

PREFORMED LOOP

LOOP DETECTOR SPLICE

- 1 WESTERN UNION SPLICE SOLDERED WITH ROSIN CORE FLUX. ALL EXPOSED SURFACES OF THE SOLDER SHALL BE SMOOTH. THE WESTERN UNION SPLICES SHALL BE STAGGERED.
- 2 WCSMW 30/100 HEAT SHRINK TUBE, MINIMUM LENGTH 3" (75 mm), UNDERWATER GRADE.
- 3 WCS 200/750 HEAT SHRINK TUBE, MINIMUM LENGTH 6" (150 mm), UNDERWATER GRADE.
- 4 NO. 14 2/C TWISTED, SHIELDED CABLE.
- 5 LOOP CONDUCTOR WITH FLEXIBLE PLASTIC TUBE. PREFORMED LOOP
- 6 XL POLYOLEFIN 2 CONDUCTOR
- 7 BREAKOUT SEALS. TYCO CBR-2 OR APPROVED EQUAL

MODEL: Default; FILE NAME: p:\0848EBD1\TEC\Illinois.gov\WIDOT\Documents\DOT Offices\District 1\Projects\DUK\S22\23\CA\DD\HA\CAD\sheetst05.dgn

| | | |
|------------------------------|------------|-----------|
| USER NAME = footemj | DESIGNED - | REVISED - |
| | DRAWN - | REVISED - |
| PLOT SCALE = 50,0000 ' / ft. | CHECKED - | REVISED - |
| PLOT DATE = 3/4/2019 | DATE - | REVISED - |

**STATE OF ILLINOIS
DEPARTMENT OF TRANSPORTATION**

**DISTRICT ONE
STANDARD TRAFFIC SIGNAL DESIGN DETAILS**

SCALE: NONE SHEET 2 OF 7 SHEETS STA. TO STA.

| | | | | |
|---------------------------|---------------------|--------------------|-----------------|--------------|
| F.A.P. RTE. 311 | SECTION 2021-029-R5 | COUNTY COOK | TOTAL SHEETS 42 | SHEET NO. 41 |
| TS-05 | | CONTRACT NO. 62N78 | | |
| ILLINOIS FED. AID PROJECT | | | | |

