

SI	SP	CODE NO.	ITEM	UNIT	TOTAL QUANTITY	CONSTRUCTION CODE	
						CMAQ/0021	STU/0004
*		20100110	TREE REMOVAL (6 TO 15 UNITS DIAMETER)	UNIT	6	6	
*		20100210	TREE REMOVAL (OVER 15 UNITS DIAMETER)	UNIT	54	54	
*		20200100	EARTH EXCAVATION	CU YD	3,175	2,500	675
*		20201200	REMOVAL AND DISPOSAL OF UNSUITABLE MATERIAL	CU YD	400		400
*		20400800	FURNISHED EXCAVATION	CU YD	185		185
*		20800150	TRENCH BACKFILL	CU YD	652	333	319
		25000400	NITROGEN FERTILIZER NUTRIENT	POUND	135		135
		25000500	PHOSPHORUS FERTILIZER NUTRIENT	POUND	135		135
		25000600	POTASSIUM FERTILIZER NUTRIENT	POUND	135		135
		25100115	MULCH, METHOD 2	ACRE	1.5		1.5
		25100630	EROSION CONTROL BLANKET	SQ YD	323	323	
		28000250	TEMPORARY EROSION CONTROL SEEDING	POUND	300	250	50
		28000305	TEMPORARY DITCH CHECKS	FOOT	10	10	
		28000400	PERIMETER EROSION BARRIER	FOOT	3,983	1,400	2,583

SI	SP	CODE NO.	ITEM	UNIT	TOTAL QUANTITY	CONSTRUCTION CODE	
						CMAQ/0021	STU/0004
		28000500	INLET AND PIPE PROTECTION	EACH	25	12	13
		28100107	STONE RIPRAP, CLASS A4	SQ YD	83	46	37
		28200200	FILTER FABRIC	SQ YD	83	46	37
		35100500	AGGREGATE BASE COURSE, TYPE A 6"	SQ YD	3,046	1,000	2,046
		35101100	AGGREGATE BASE COURSE, TYPE A 12"	SQ YD	3,929	3,929	
		35101600	AGGREGATE BASE COURSE, TYPE B 4"	SQ YD	1,156	300	856
		35102200	AGGREGATE BASE COURSE, TYPE B 10"	SQ YD	148	148	
		35102400	AGGREGATE BASE COURSE, TYPE B 12"	SQ YD	200		200
		35400200	PORTLAND CEMENT CONCRETE BASE COURSE WIDENING 7"	SQ YD	252	100	152
		40200500	AGGREGATE SURFACE COURSE, TYPE A 6"	SQ YD	78		78
		40201000	AGGREGATE FOR TEMPORARY ACCESS	TON	200	100	100
		40600275	BITUMINOUS MATERIALS (PRIME COAT)	POUND	8,228	8,228	
		40600290	BITUMINOUS MATERIALS (TACK COAT)	POUND	4,506	1,230	3,276
		40600990	TEMPORARY RAMP	SQ YD	133	114	19

NOTES: SP - SEE PROJECT SPECIFIC SPECIAL PROVISIONS
SI - SPECIALTY ITEM

MODEL: Default
FILE NAME: I:\1818124 - Columbia Quarry RedCAD\DWG\Microstation\PH II CAD - Sheets\0818124-514-500.dgn



USER NAME = brian.hell	DESIGNED -	REVISED Δ - 02/23/2022
PLOT SCALE = 100.0000' / in.	DRAWN -	REVISED -
PLOT DATE = 10/21/2021	CHECKED -	REVISED -
	DATE -	REVISED -

**STATE OF ILLINOIS
DEPARTMENT OF TRANSPORTATION**

SUMMARY OF QUANTITIES

SCALE: SHEET 1 OF 4 SHEETS STA. TO STA.

F.A.U. RTE. 9311	SECTION 18-00054-01-PV/ 19-00054-02-BS	COUNTY MONROE	TOTAL SHEETS 60	SHEET NO. 3
ILLINOIS FED. AID PROJECT			CONTRACT NO. 97767	

EARTHWORK

STATION	STATION	EARTH EXCAVATION (NOTE 4) (CU YD)	EARTH EXCAVATION ADJUSTED FOR SHRINKAGE (NOTE 1) (CU YD)	EMBANKMENT (NOTE 2) (CU YD)	EARTHWORK BALANCE WASTE (+) OR SHORTAGE (-) (NOTE 3) (CU YD)	FURNISHED EXCAVATION (CU YD)
44+94	47+50	75	60	493	-433	162
47+50	49+20	639	512	478	34	
49+20	71+20	2,278	1,822	1,585	237	
298+28	299+38	75	60	53	7	21
300+63	302+50	106	85	113	-28	
TOTAL		3,175	2,540	2,725	-185	185

EARTHWORK NOTES:

- ESTIMATED SHRINKAGE FACTOR = 20%.
- APPROXIMATE EMBANKMENT QUANTITY IS SHOWN FOR INFORMATION ONLY.
- APPROXIMATE EARTHWORK BALANCE IS SHOWN FOR INFORMATION ONLY.
- STATION 47+50 TO 49+20 AND 299+38 TO 300+63, CROSS SECTIONAL END AREAS NOT PROVIDED, PROPOSED AND EXISTING SURFACE USED TO DETERMINE EARTHWORK VOLUMES.

STORM SEWER

STATION	STATION	OFFSET	TRENCH BACKFILL (CU YD)	STONE RIPRAP CL A4 (SQ YD)	FILTER FABRIC (SQ YD)	PRC FLAR END SEC 12 (EACH)	PRC FLAR END SEC 24 (EACH)	SS RG CL A 1 (FOOT)	SS RG CL A 2 (FOOT)	SS RG CL A 2 (FOOT)	MAN TA 4 DIA T1F CL (EACH)	MAN TA 4 DIA T3F&G (EACH)	INLETS TA T3F&G (EACH)	INLETS TB T3F&G (EACH)	PIPE CULVERT REM (FOOT)
45+07	45+47	RT	49	14	14	1			81						
45+47	47+35	RT	119						188					1	
47+35	47+98	RT	22						68					1	
47+98	49+06	RT	30						108					1	
49+06	49+93	RT	20					91						1	
49+93	51+50	RT	29					150						1	
51+50	53+00	RT	26					150					1	1	
48+20	48+30	LT	1	29	29	1		18							
48+30	48+29	LT	1					10					1		
48+30	48+75	LT	8					49				1			
48+75	48+77	LT	1					10					1		
48+77	49+05	LT	9					49				1			
49+05	49+94	LT	18					92					1	1	
53+84	54+11	RT	18	26	26		1			33					
54+11	54+28	LT	14	14	14		1			48	1				
54+11	54+80	RT	16					69						1	
54+41		LT	44												49
54+80	56+50	RT	37					171						1	
56+50	58+00	RT	35					150						1	
58+00	59+50	RT	35					150						1	
59+50	60+75	RT	30					125						1	
60+75	62+50	RT	41					175							
62+50	64+00	RT	29					150					1	1	
66+00	66+45	RT	11						48						
67+30	67+07	RT	9						28				1		
													1		
TOTAL			652	83	83	2	2	1,609	521	81	1	2	7	13	49

SEEDING

STATION	STATION	OFFSET	SEEDING CL 2A (SPL) (ACRE)	NITROGEN FERT NUTR (POUND)	PHOSPHORUS FERT NUTR (POUND)	POTASSIUM FERT NUTR (POUND)	MULCH METHOD 2 (ACRE)	TEMP EROS SEEDING (NOTE 1) (POUND)
44+94	51+64	RT	0.25	23	23	23	0.25	50
44+94	51+64	LT	0.25	23	23	23	0.25	50
51+64	66+75	RT	0.50	45	45	45	0.50	100
51+64	71+20	LT	0.25	23	23	23	0.25	50
66+75	71+20	RT	0.25	23	23	23	0.25	50
TOTAL			1.5	135	135	135	1.5	300

SEEDING NOTES:

- THE QUANTITY FOR TEMPORARY EROSION CONTROL SEEDING ASSUMES TWO SEPARATE APPLICATIONS AT A RATE OF 100 POUNDS/ACRE PER APPLICATION. THE CONTRACTOR SHALL APPLY AS NECESSARY AND AS DIRECTED BY THE ENGINEER IN THE FIELD.

EROSION CONTROL

STATION	STATION	OFFSET	EROSION CONTR BLANKET (SQ YD)	TEMPORARY DITCH CHECK (FOOT)	PERIMETER EROS BAR (FOOT)	INLET & PIPE PROTECTION (EACH)
44+94	48+22	RT			348	3
44+94	48+08	LT			359	
48+28	50+00	LT				6
48+50	49+88	LT			303	
48+55	50+31	RT			141	2
51+50	54+46	RT			192	2
53+07	53+66	LT			72	
54+70	66+56	RT			1194	9
55+41	57+01	LT			161	1
63+50	71+23	LT			782	
67+00	71+36	RT			431	2
301+30	301+93	LT	323	10		
TOTAL			323	10	3,983	25

MODEL: Default
FILE NAME: I:\18124 - Columbus Quarry 80\CADD\Microstation\PH II CADD Sheets\0818124-15-1-1-1-Sht-Schedule.dgn



USER NAME = brian.heil
DESIGNED -
DRAWN -
PLOT SCALE = 100.0000 ' / in.
CHECKED -
DATE = 2/23/2022

DESIGNED -
DRAWN -
CHECKED -
DATE -
REVISED Δ - 02/23/2022
REVISED -
REVISED -
REVISED -

**STATE OF ILLINOIS
DEPARTMENT OF TRANSPORTATION**

SCHEDULES

SCALE: N/A SHEET 1 OF 4 SHEETS STA. TO STA.

F.A.U. RTE.	SECTION	COUNTY	TOTAL SHEETS	SHEET NO.
9311	18-00054-01-PV/ 19-00054-02-R5	MONROE	60	12
CONTRACT NO. 97767			ILLINOIS FED. AID PROJECT	

DATE	
BY	
FINAL SURVEY	SURVEYED
NOTE BOOK	PLOTTED
NO.	TEMPLATE
	AREAS CHECKED

DATE	
BY	
ORIGINAL SURVEY	SURVEYED
NOTE BOOK	PLOTTED
NO.	TEMPLATE
	AREAS CHECKED

MODEL: Definit
 FILE NAME: H:\18124 - Columbia Quarry Re-CADD\Information\PH II CADD Sheets\0818124-18-Phils-Shirley-VSC.dgn

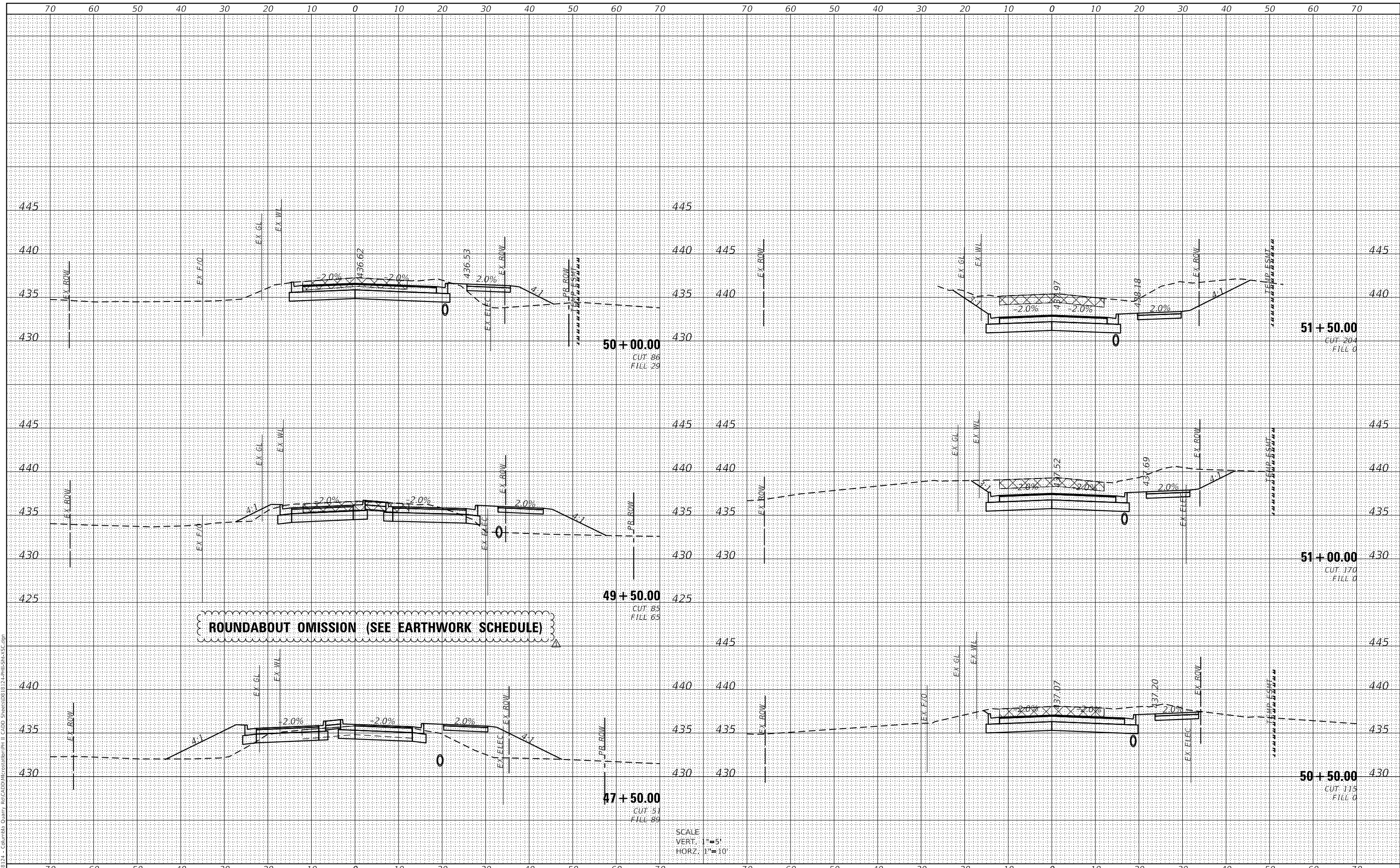

SCALE
 VERT. 1"=5'
 HORZ. 1"=10'



USER NAME =	brian.heil	DESIGNED -	REVISD Δ -	02/23/2022
		DRAWN -	REVISD -	
PLOT SCALE =	20.0000' / in.	CHECKED -	REVISD -	
PLOT DATE =	2/23/2022	DATE -	REVISD -	

STATE OF ILLINOIS
 DEPARTMENT OF TRANSPORTATION

CROSS SECTION SHEETS
 QUARRY ROAD

SCALE: SHEET 3 OF 9 SHEETS STA. 47+50.00 TO STA. 51+50.00

F.A.U. RTE.	SECTION	COUNTY	TOTAL SHEETS	SHEET NO.
9311	18-00054-01-PV/ 19-00054-02-R5	MONROE	60	53
CONTRACT NO. 97767			ILLINOIS FED. AID PROJECT	

DATE	
BY	
FINAL SURVEY	SURVEYED
NOTE BOOK	PLOTTED
NO.	TEMPLATE
	AREAS CHECKED

DATE	
BY	
ORIGINAL SURVEY	SURVEYED
NOTE BOOK	PLOTTED
NO.	TEMPLATE
	AREAS CHECKED

MODEL: Defaul
 FILE NAME: H:\18124 - Columbia Quarry Re-CADD\micr\station\PHI II CADD Sheets\0818124-Philis-Shr-VSC_PCD.dgn

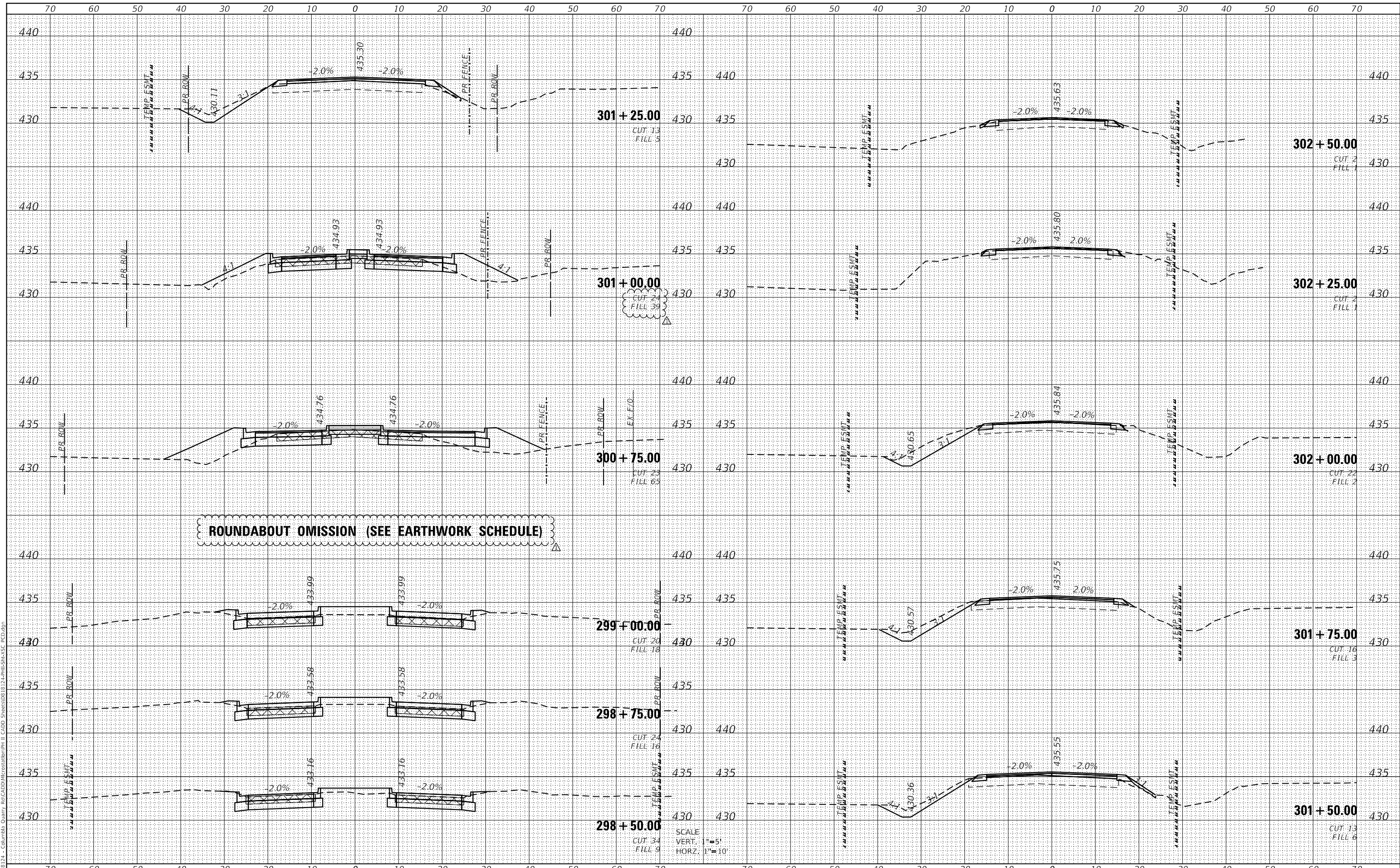

USER NAME =	brian.heil	DESIGNED -	REVISD -	02/23/2022
		DRAWN -	REVISD -	
PLOT SCALE =	20.0000' / in.	CHECKED -	REVISD -	
PLOT DATE =	2/23/2022	DATE -	REVISD -	

**STATE OF ILLINOIS
 DEPARTMENT OF TRANSPORTATION**

**CROSS SECTION SHEETS
 PALMER CREEK DRIVE**

SCALE: SHEET 1 OF 1 SHEETS STA. 298+50.00 TO STA. 302+50.00

F.A.U. RTE.	SECTION	COUNTY	TOTAL SHEETS	SHEET NO.
9311	18-00054-01-PV/ 19-00054-02-R5	MONROE	60	60
CONTRACT NO. 97767				
ILLINOIS		FED. AID PROJECT		