

IF WORKING ON CONCURRENT STRUCTURES, DRUMS WITH STEADY BURN MONODIRECTIONAL LIGHTS AT 100' CENTERS SHALL BE USED PER HIGHWAY STANDARD 701402. ONLY DRUMS ALONG THE LANE SHIFTS AND 500' IN ADVANCE OF THE LANE SHIFTS WILL REQUIRE MONODIRECTIONAL LIGHTS. OTHER DRUMS ALONG THE TANGENT BETWEEN STRUCTURES WILL NOT REQUIRE LIGHTS. CHECK BARRICADES WILL BE REQUIRED EVERY 1000'. COST INCLUDED WITH TRAFFIC CONTROL AND PROTECTION STANDARD 701402.

**TEMPORARY CONCRETE BARRIER LAYOUT - STAGE I**  
**S.N. 057-0183 (NB) & S.N. 057-0182 (SB)**

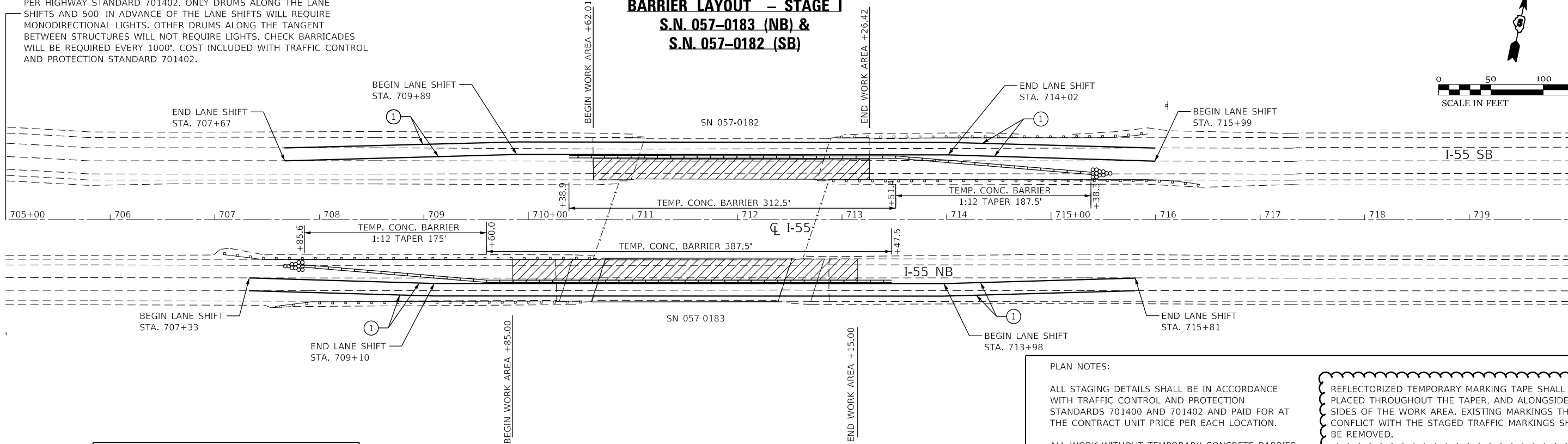
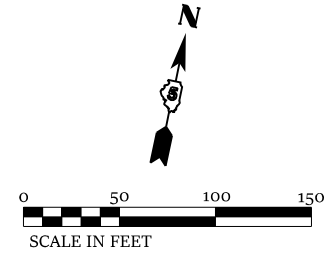

SYMBOLS	
	TEMPORARY CONCRETE BARRIER
	IMPACT ATTENUATOR
	WORK AREA
	TEMPORARY PAVEMENT MARKINGS

**PLAN NOTES:**

ALL STAGING DETAILS SHALL BE IN ACCORDANCE WITH TRAFFIC CONTROL AND PROTECTION STANDARDS 701400 AND 701402 AND PAID FOR AT THE CONTRACT UNIT PRICE PER EACH LOCATION.

ALL WORK WITHOUT TEMPORARY CONCRETE BARRIER IN PLACE SHALL BE IN ACCORDANCE WITH TRAFFIC CONTROL AND PROTECTION STANDARDS 701400 AND 701401.

FOR ADDITIONAL DETAILS ASSOCIATED WITH TEMPORARY CONCRETE BARRIER, SEE TRAFFIC CONTROL AND PROTECTION STANDARD 704001.

VERTICAL PANELS WITH LIGHTS AND REFLECTORS SHALL BE ATTACHED AT 25 FOOT CENTERS TO THE BARRIER WALL AND GUARDRAIL. COST INCLUDED WITH TRAFFIC CONTROL AND PROTECTION STANDARD 701402.

REFLECTORIZED TEMPORARY MARKING TAPE SHALL BE PLACED THROUGHOUT THE TAPER, AND ALONGSIDE BOTH SIDES OF THE WORK AREA. EXISTING MARKINGS THAT CONFLICT WITH THE STAGED TRAFFIC MARKINGS SHALL BE REMOVED.

PRIOR TO ROUTING TRAFFIC ONTO THE SHOULDERS, THE CONTRACTOR SHALL SECURE ANY GRATES ON SHOULDER INLETS AS DIRECTED BY THE ENGINEER. THIS WORK SHALL BE PAID FOR ACCORDING TO ARTICLE 109.04 OF THE STANDARD SPECIFICATIONS.

PORTABLE CHANGEABLE MESSAGE SIGNS ARE REQUIRED SEVEN DAYS PRIOR TO CONSTRUCTION. THE RESIDENT ENGINEER OR TRAFFIC CONTROL SUPERVISOR SHALL PROVIDE AN APPROPRIATE MESSAGE.

**TEMPORARY CONCRETE BARRIER LAYOUT - STAGE II**  
**S.N. 057-0183 (NB) & S.N. 057-0182 (SB)**

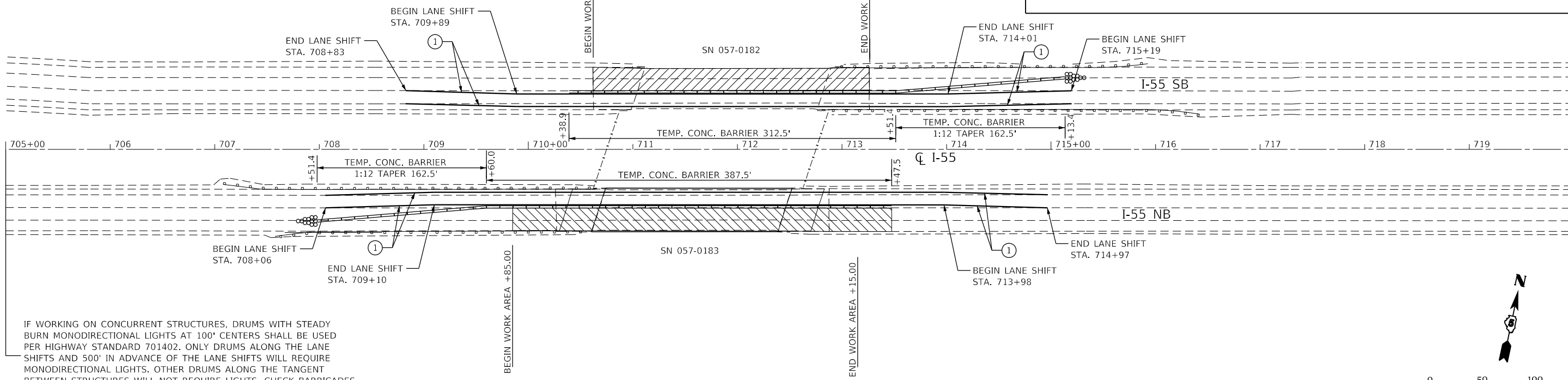

IF WORKING ON CONCURRENT STRUCTURES, DRUMS WITH STEADY BURN MONODIRECTIONAL LIGHTS AT 100' CENTERS SHALL BE USED PER HIGHWAY STANDARD 701402. ONLY DRUMS ALONG THE LANE SHIFTS AND 500' IN ADVANCE OF THE LANE SHIFTS WILL REQUIRE MONODIRECTIONAL LIGHTS. OTHER DRUMS ALONG THE TANGENT BETWEEN STRUCTURES WILL NOT REQUIRE LIGHTS. CHECK BARRICADES WILL BE REQUIRED EVERY 1000'. COST INCLUDED WITH TRAFFIC CONTROL AND PROTECTION STANDARD 701402.

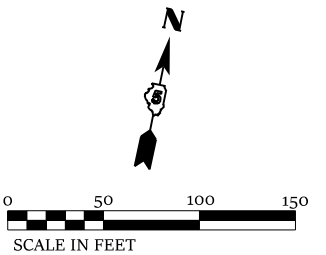

MODEL: D570012.dwg FILE: I:\MISC\_P\Effingham\m05454\_1\_PTB\_1801.DOT.D5\_V\Work Order #6\CardSheet\0570064\_rh\_Stage1\_1\_0813\_0182.dgn



USER NAME = rhanland	DESIGNED - WMK	REVISED - 2/24/2022
PLOT SCALE = 100.0000' / in.	DRAWN - DMM	REVISED -
PLOT DATE = 2/24/2022	CHECKED - RLH	REVISED -
	DATE - 2/24/2022	REVISED -

**STATE OF ILLINOIS DEPARTMENT OF TRANSPORTATION**

**TEMPORARY CONCRETE BARRIER LAYOUT**  
**S.N. 057-0182 SB & S.N. 057-0183 NB**  
 SCALE: 100.0000' / in SHEET 4 OF 28 SHEETS STA. 705+00.00 TO STA. 735+00.00

F.A.I. RTE.	SECTION	COUNTY	TOTAL SHEETS	SHEET NO.
55	(57-1,57-2)BD5	MCLEAN	88	14
CONTRACT NO. 70D64				
ILLINOIS FED. AID PROJECT				

IF WORKING ON CONCURRENT STRUCTURES, DRUMS WITH STEADY BURN MONODIRECTIONAL LIGHTS AT 100' CENTERS SHALL BE USED PER HIGHWAY STANDARD 701402. ONLY DRUMS ALONG THE LANE SHIFTS AND 500' IN ADVANCE OF THE LANE SHIFTS WILL REQUIRE MONODIRECTIONAL LIGHTS. OTHER DRUMS ALONG THE TANGENT BETWEEN STRUCTURES WILL NOT REQUIRE LIGHTS. CHECK BARRICADES WILL BE REQUIRED EVERY 1000'. COST INCLUDED WITH TRAFFIC CONTROL AND PROTECTION STANDARD 701402.

**TEMPORARY CONCRETE BARRIER LAYOUT - STAGE I**  
**S.N. 057-0174 (NB) & S.N. 057-0173 (SB)**

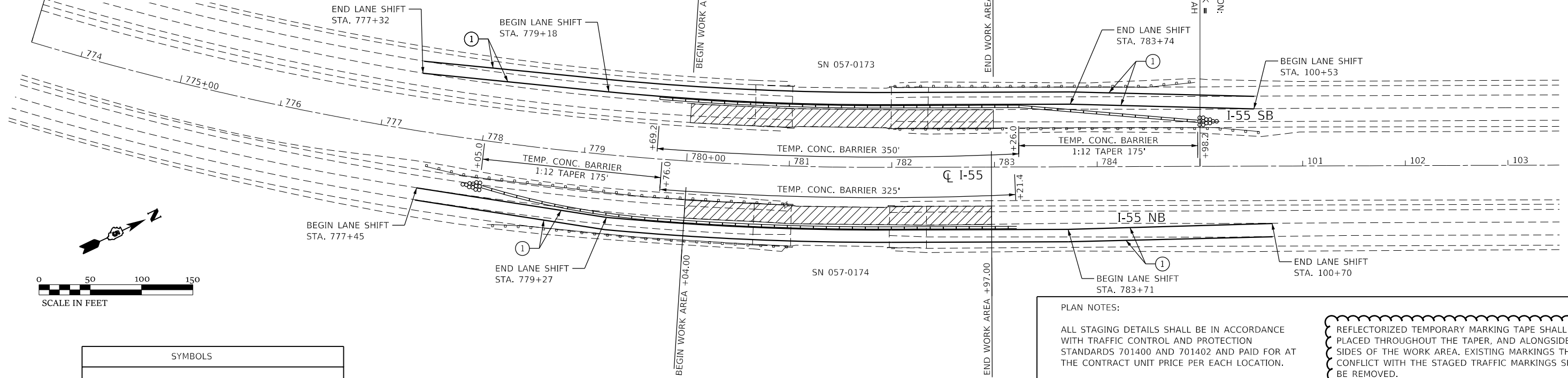

SYMBOLS	
	TEMPORARY CONCRETE BARRIER
	IMPACT ATTENUATOR
	WORK AREA
	TEMPORARY PAVEMENT MARKINGS

**PLAN NOTES:**

ALL STAGING DETAILS SHALL BE IN ACCORDANCE WITH TRAFFIC CONTROL AND PROTECTION STANDARDS 701400 AND 701402 AND PAID FOR AT THE CONTRACT UNIT PRICE PER EACH LOCATION.

ALL WORK WITHOUT TEMPORARY CONCRETE BARRIER IN PLACE SHALL BE IN ACCORDANCE WITH TRAFFIC CONTROL AND PROTECTION STANDARDS 701400 AND 701401.

FOR ADDITIONAL DETAILS ASSOCIATED WITH TEMPORARY CONCRETE BARRIER, SEE TRAFFIC CONTROL AND PROTECTION STANDARD 704001.

VERTICAL PANELS WITH LIGHTS AND REFLECTORS SHALL BE ATTACHED AT 25 FOOT CENTERS TO THE BARRIER WALL AND GUARDRAIL. COST INCLUDED WITH TRAFFIC CONTROL AND PROTECTION STANDARD 701402.

REFLECTORIZED TEMPORARY MARKING TAPE SHALL BE PLACED THROUGHOUT THE TAPER, AND ALONGSIDE BOTH SIDES OF THE WORK AREA. EXISTING MARKINGS THAT CONFLICT WITH THE STAGED TRAFFIC MARKINGS SHALL BE REMOVED.

PRIOR TO ROUTING TRAFFIC ONTO THE SHOULDERS, THE CONTRACTOR SHALL SECURE ANY GRATES ON SHOULDER INLETS AS DIRECTED BY THE ENGINEER. THIS WORK SHALL BE PAID FOR ACCORDING TO ARTICLE 109.04 OF THE STANDAR SPECIFICATIONS.

PORTABLE CHANGEABLE MESSAGE SIGNS ARE REQUIRED SEVEN DAYS PRIOR TO CONSTRUCTION. THE RESIDENT ENGINEER OR TRAFFIC CONTROL SUPERVISOR SHALL PROVIDE AN APPROPRIATE MESSAGE.

**TEMPORARY CONCRETE BARRIER LAYOUT - STAGE II**  
**S.N. 057-0174 (NB) & S.N. 057-0173 (SB)**

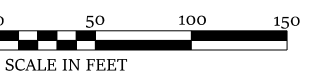
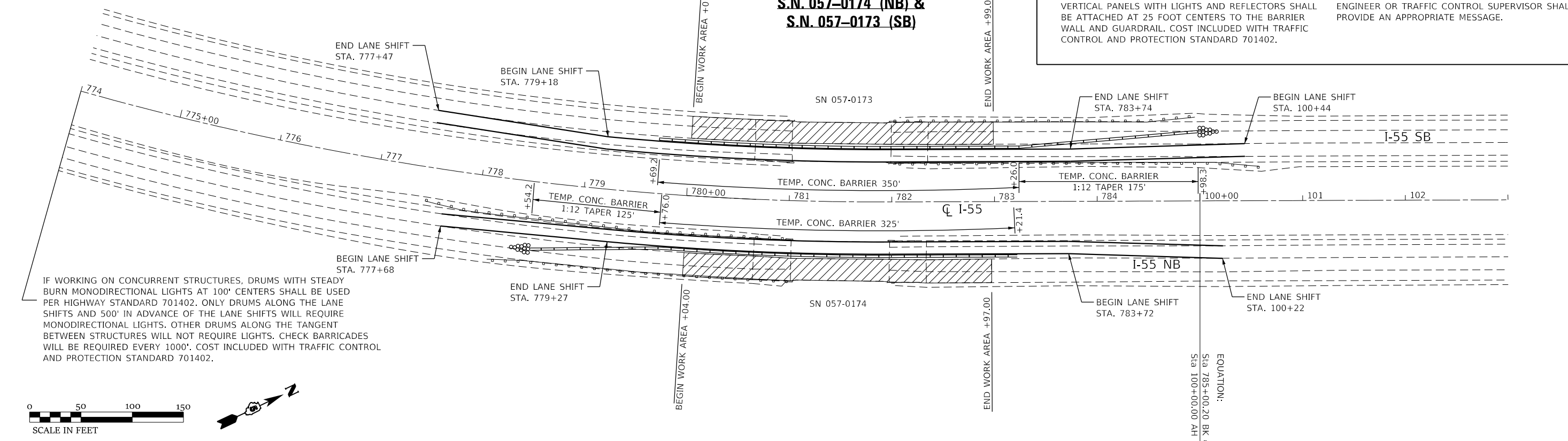

IF WORKING ON CONCURRENT STRUCTURES, DRUMS WITH STEADY BURN MONODIRECTIONAL LIGHTS AT 100' CENTERS SHALL BE USED PER HIGHWAY STANDARD 701402. ONLY DRUMS ALONG THE LANE SHIFTS AND 500' IN ADVANCE OF THE LANE SHIFTS WILL REQUIRE MONODIRECTIONAL LIGHTS. OTHER DRUMS ALONG THE TANGENT BETWEEN STRUCTURES WILL NOT REQUIRE LIGHTS. CHECK BARRICADES WILL BE REQUIRED EVERY 1000'. COST INCLUDED WITH TRAFFIC CONTROL AND PROTECTION STANDARD 701402.

MODEL: D570012\_Plan16  
 FILE NAME: P:\EIT\m3\m3\541\_PTB\_1881\_IDOT\_DS\_VAV\Work Order #6\Cadd\Sheet\0570064\_rh\_Station\_2\_0173-0174.dgn



CIVIL DESIGN, INC.  
 WBE / DBE  
 EFFINGHAM, IL  
 LICENSE # 184.003222

USER NAME = rhanfland	DESIGNED - WMK	REVISED - 2/24/2022
PLOT SCALE = 100.0000' / in.	DRAWN - DMM	REVISED -
PLOT DATE = 2/24/2022	CHECKED - RLH	REVISED -
	DATE - 2/24/2022	REVISED -

STATE OF ILLINOIS  
 DEPARTMENT OF TRANSPORTATION

TEMPORARY CONCRETE BARRIER LAYOUT  
 S.N. 057-0173 SB & S.N. 057-0174 NB

SCALE: 100.0000' / in SHEET 1 OF 1 SHEETS STA. 765+00.00 TO STA. 109+00.00

F.A.I. RTE.	SECTION	COUNTY	TOTAL SHEETS	SHEET NO.
55	(57-1,57-2)BD5	MCLEAN	88	15
CONTRACT NO. 70D64				
ILLINOIS FED. AID PROJECT				

IF WORKING ON CONCURRENT STRUCTURES, DRUMS WITH STEADY BURN MONODIRECTIONAL LIGHTS AT 100' CENTERS SHALL BE USED PER HIGHWAY STANDARD 701402. ONLY DRUMS ALONG THE LANE SHIFTS AND 500' IN ADVANCE OF THE LANE SHIFTS WILL REQUIRE MONODIRECTIONAL LIGHTS. OTHER DRUMS ALONG THE TANGENT BETWEEN STRUCTURES WILL NOT REQUIRE LIGHTS. CHECK BARRICADES WILL BE REQUIRED EVERY 1000'. COST INCLUDED WITH TRAFFIC CONTROL AND PROTECTION STANDARD 701402.

**TEMPORARY CONCRETE BARRIER LAYOUT - STAGE I**  
**S.N. 057-0153 (NB) & S.N. 057-0152 (SB)**

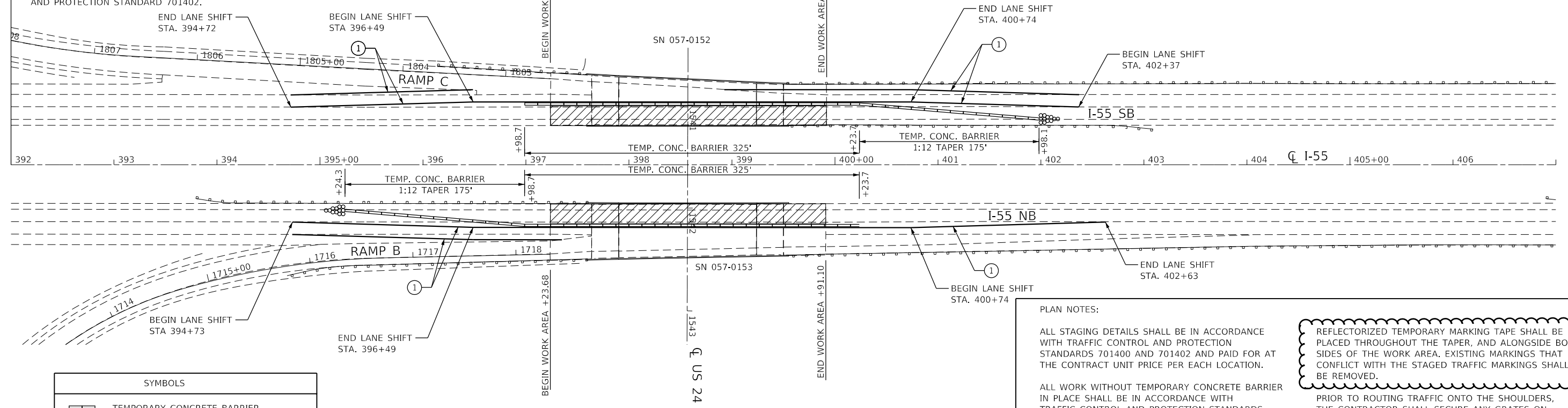
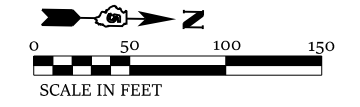

SYMBOLS	
	TEMPORARY CONCRETE BARRIER
	IMPACT ATTENUATOR
	WORK AREA
	TEMPORARY PAVEMENT MARKINGS

**PLAN NOTES:**

ALL STAGING DETAILS SHALL BE IN ACCORDANCE WITH TRAFFIC CONTROL AND PROTECTION STANDARDS 701400 AND 701402 AND PAID FOR AT THE CONTRACT UNIT PRICE PER EACH LOCATION.

ALL WORK WITHOUT TEMPORARY CONCRETE BARRIER IN PLACE SHALL BE IN ACCORDANCE WITH TRAFFIC CONTROL AND PROTECTION STANDARDS 701400 AND 701401.

FOR ADDITIONAL DETAILS ASSOCIATED WITH TEMPORARY CONCRETE BARRIER, SEE TRAFFIC CONTROL AND PROTECTION STANDARD 704001.

VERTICAL PANELS WITH LIGHTS AND REFLECTORS SHALL BE ATTACHED AT 25 FOOT CENTERS TO THE BARRIER WALL AND GUARDRAIL. COST INCLUDED WITH TRAFFIC CONTROL AND PROTECTION STANDARD 701402.

REFLECTORIZED TEMPORARY MARKING TAPE SHALL BE PLACED THROUGHOUT THE TAPER, AND ALONGSIDE BOTH SIDES OF THE WORK AREA. EXISTING MARKINGS THAT CONFLICT WITH THE STAGED TRAFFIC MARKINGS SHALL BE REMOVED.

PRIOR TO ROUTING TRAFFIC ONTO THE SHOULDERS, THE CONTRACTOR SHALL SECURE ANY GRATES ON SHOULDER INLETS AS DIRECTED BY THE ENGINEER. THIS WORK SHALL BE PAID FOR ACCORDING TO ARTICLE 109.04 OF THE STANDARD SPECIFICATIONS.

PORTABLE CHANGEABLE MESSAGE SIGNS ARE REQUIRED SEVEN DAYS PRIOR TO CONSTRUCTION. THE RESIDENT ENGINEER OR TRAFFIC CONTROL SUPERVISOR SHALL PROVIDE AN APPROPRIATE MESSAGE.

**TEMPORARY CONCRETE BARRIER LAYOUT - STAGE II**  
**S.N. 057-0153 (NB) & S.N. 057-0152 (SB)**

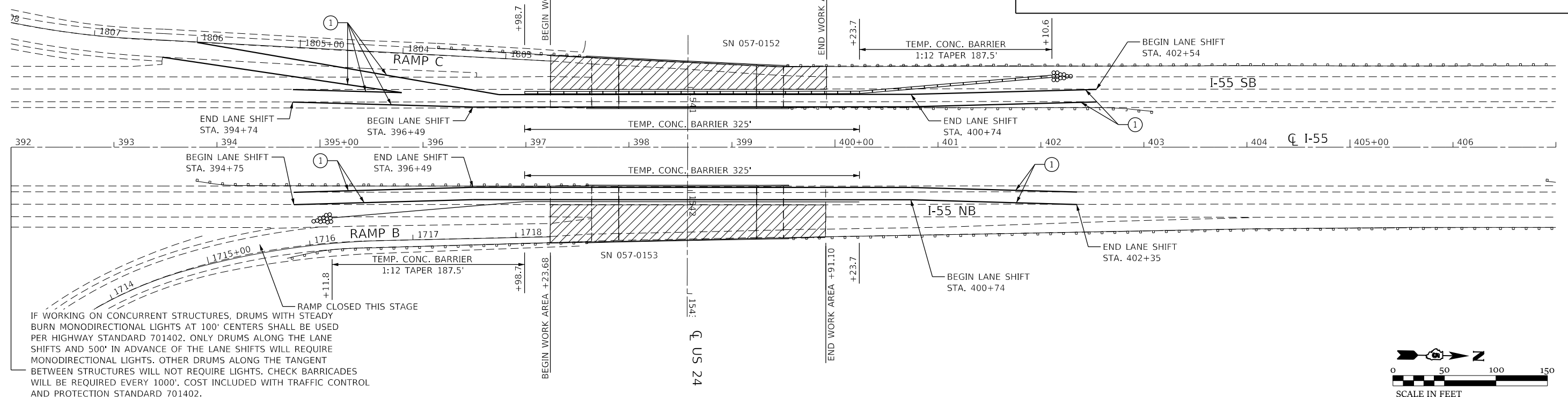

IF WORKING ON CONCURRENT STRUCTURES, DRUMS WITH STEADY BURN MONODIRECTIONAL LIGHTS AT 100' CENTERS SHALL BE USED PER HIGHWAY STANDARD 701402. ONLY DRUMS ALONG THE LANE SHIFTS AND 500' IN ADVANCE OF THE LANE SHIFTS WILL REQUIRE MONODIRECTIONAL LIGHTS. OTHER DRUMS ALONG THE TANGENT BETWEEN STRUCTURES WILL NOT REQUIRE LIGHTS. CHECK BARRICADES WILL BE REQUIRED EVERY 1000'. COST INCLUDED WITH TRAFFIC CONTROL AND PROTECTION STANDARD 701402.

RAMP CLOSED THIS STAGE

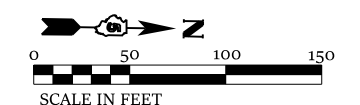

MODEL: D:\70012\_Plan16 FILE NAME: P:\EIT\m3454 - PTB 188 IDOT DS V\Work Order #6\Cadd\Sheet\0570064\_rh\_Stage1\_3\_0152-0153.dgn



USER NAME = rhanfland	DESIGNED - WMK	REVISED - 2/24/2022
PLOT SCALE = 100.0000' / in.	DRAWN - DMM	REVISED -
PLOT DATE = 2/24/2022	CHECKED - RLH	REVISED -
	DATE - 2/24/2022	REVISED -

**STATE OF ILLINOIS DEPARTMENT OF TRANSPORTATION**

**TEMPORARY CONCRETE BARRIER LAYOUT**  
**S.N. 057-0152 SB & S.N. 057-0153 NB**  
 SCALE: 100.0000' / in SHEET 1 OF 1 SHEETS STA. 379+00.00 TO STA. 409+00.00

F.A.I. RTE.	SECTION	COUNTY	TOTAL SHEETS	SHEET NO.
55	(57-1,57)BD5	MCLEAN	88	16
CONTRACT NO. 70D64				

IF WORKING ON CONCURRENT STRUCTURES, DRUMS WITH STEADY BURN MONODIRECTIONAL LIGHTS AT 100' CENTERS SHALL BE USED PER HIGHWAY STANDARD 701402. ONLY DRUMS ALONG THE LANE SHIFTS AND 500' IN ADVANCE OF THE LANE SHIFTS WILL REQUIRE MONODIRECTIONAL LIGHTS. OTHER DRUMS ALONG THE TANGENT BETWEEN STRUCTURES WILL NOT REQUIRE LIGHTS. CHECK BARRICADES WILL BE REQUIRED EVERY 1000'. COST INCLUDED WITH TRAFFIC CONTROL AND PROTECTION STANDARD 701402.

**TEMPORARY CONCRETE BARRIER LAYOUT - STAGE I**  
**S.N. 057-0179 (NB) & S.N. 057-0178 (SB)**

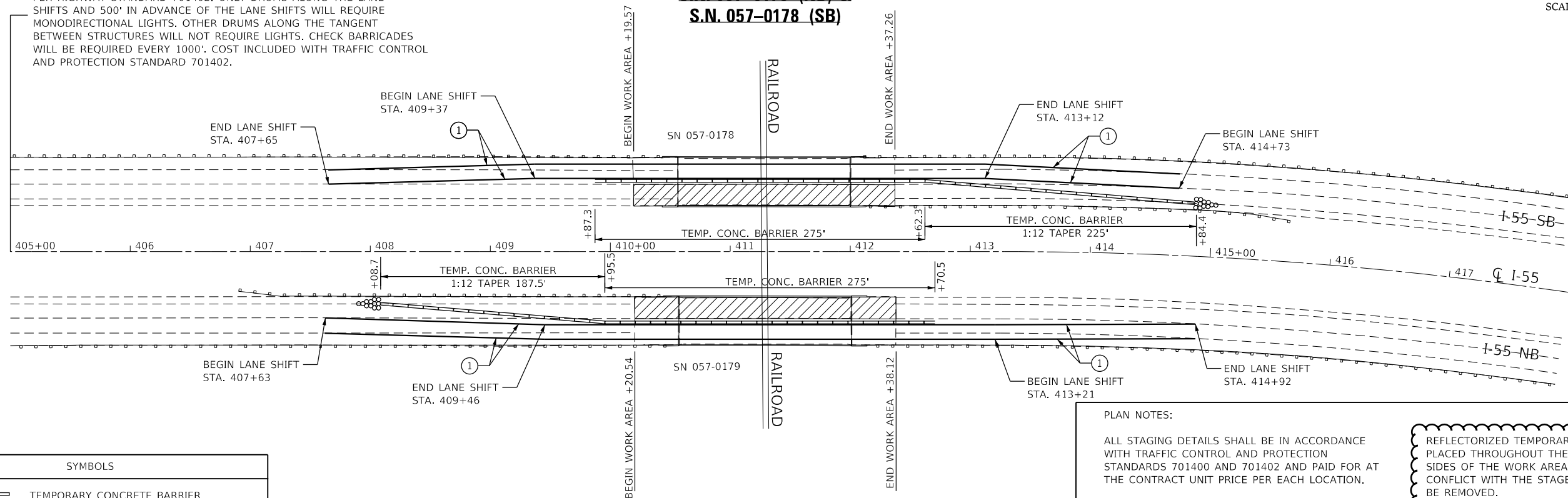
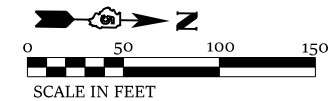

SYMBOLS	
	TEMPORARY CONCRETE BARRIER
	IMPACT ATTENUATOR
	WORK AREA
	TEMPORARY PAVEMENT MARKINGS

**PLAN NOTES:**

ALL STAGING DETAILS SHALL BE IN ACCORDANCE WITH TRAFFIC CONTROL AND PROTECTION STANDARDS 701400 AND 701402 AND PAID FOR AT THE CONTRACT UNIT PRICE PER EACH LOCATION.

ALL WORK WITHOUT TEMPORARY CONCRETE BARRIER IN PLACE SHALL BE IN ACCORDANCE WITH TRAFFIC CONTROL AND PROTECTION STANDARDS 701400 AND 701401.

FOR ADDITIONAL DETAILS ASSOCIATED WITH TEMPORARY CONCRETE BARRIER, SEE TRAFFIC CONTROL AND PROTECTION STANDARD 704001.

VERTICAL PANELS WITH LIGHTS AND REFLECTORS SHALL BE ATTACHED AT 25 FOOT CENTERS TO THE BARRIER WALL AND GUARDRAIL. COST INCLUDED WITH TRAFFIC CONTROL AND PROTECTION STANDARD 701402.

REFLECTORIZED TEMPORARY MARKING TAPE SHALL BE PLACED THROUGHOUT THE TAPER, AND ALONGSIDE BOTH SIDES OF THE WORK AREA. EXISTING MARKINGS THAT CONFLICT WITH THE STAGED TRAFFIC MARKINGS SHALL BE REMOVED.

PRIOR TO ROUTING TRAFFIC ONTO THE SHOULDERS, THE CONTRACTOR SHALL SECURE ANY GRATES ON SHOULDER INLETS AS DIRECTED BY THE ENGINEER. THIS WORK SHALL BE PAID FOR ACCORDING TO ARTICLE 109.04 OF THE STANDAR SPECIFICATIONS.

PORTABLE CHANGEABLE MESSAGE SIGNS ARE REQUIRED SEVEN DAYS PRIOR TO CONSTRUCTION. THE RESIDENT ENGINEER OR TRAFFIC CONTROL SUPERVISOR SHALL PROVIDE AN APPROPRIATE MESSAGE.

**TEMPORARY CONCRETE BARRIER LAYOUT - STAGE II**  
**S.N. 057-0179 (NB) & S.N. 057-0178 (SB)**

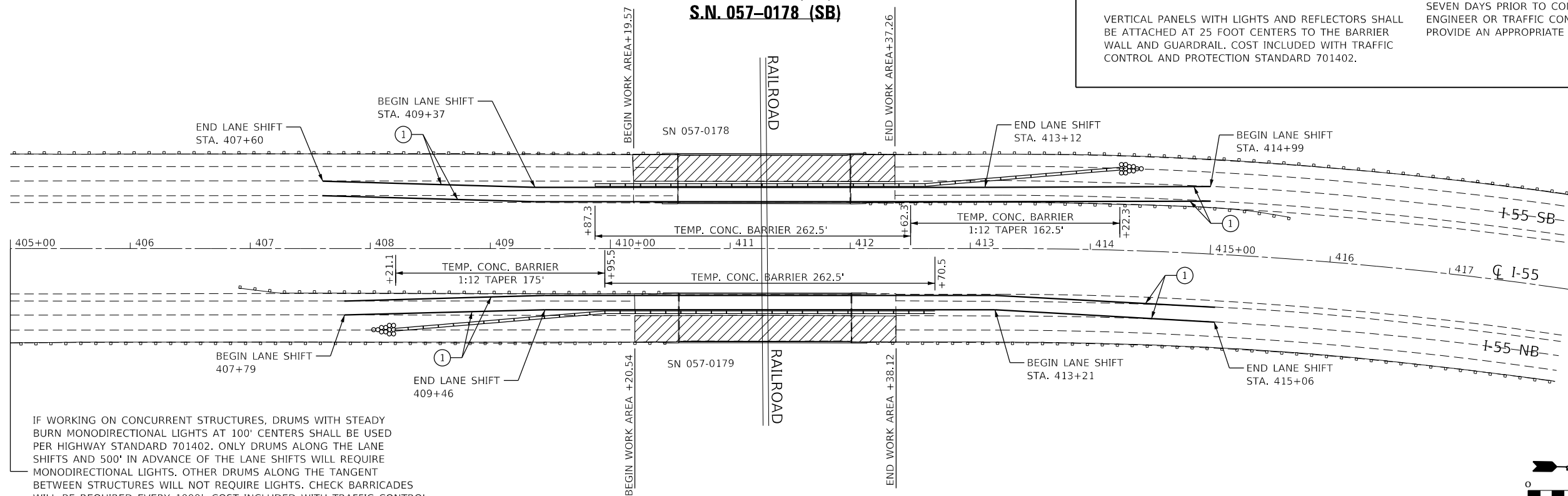

IF WORKING ON CONCURRENT STRUCTURES, DRUMS WITH STEADY BURN MONODIRECTIONAL LIGHTS AT 100' CENTERS SHALL BE USED PER HIGHWAY STANDARD 701402. ONLY DRUMS ALONG THE LANE SHIFTS AND 500' IN ADVANCE OF THE LANE SHIFTS WILL REQUIRE MONODIRECTIONAL LIGHTS. OTHER DRUMS ALONG THE TANGENT BETWEEN STRUCTURES WILL NOT REQUIRE LIGHTS. CHECK BARRICADES WILL BE REQUIRED EVERY 1000'. COST INCLUDED WITH TRAFFIC CONTROL AND PROTECTION STANDARD 701402.

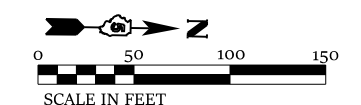

MODEL: D:\70012\_Plan17  
 FILE NAME: P:\EIT\m3454 - PTB 188 IDOT DS V\Work Order #6\Cadd\Sheet\0570064.ctb Stationing\_4\_0178\_0179.dgn



CIVIL DESIGN, INC.  
 WBE / DBE  
 EFFINGHAM, IL  
 LICENSE #184.003222

USER NAME = rhandland	DESIGNED - WMK	REVISED - 2/24/2022
PLOT SCALE = 100.0000' / in.	DRAWN - DMM	REVISED -
PLOT DATE = 2/24/2022	CHECKED - RLH	REVISED -
	DATE - 2/24/2022	REVISED -

STATE OF ILLINOIS  
 DEPARTMENT OF TRANSPORTATION

**TEMPORARY CONCRETE BARRIER LAYOUT**  
**S.N. 057-0178 SB & S.N. 057-0179 NB**  
 SCALE: 100.0000' / in SHEET 1 OF 1 SHEETS STA. 705+00.00 TO STA. 735+00.00

F.A.I. RTE.	SECTION	COUNTY	TOTAL SHEETS	SHEET NO.
55	(57-1,57-2)BD5	MCLEAN	88	17
				CONTRACT NO. 70D64
ILLINOIS FED. AID PROJECT				