

F.A.P. RTE.	SECTION	COUNTY	TOTAL SHEETS	SHEET NO.
662	(D) CR	MACOUPIN	5	1
		ILLINOIS	CONTRACT NO. 72E21	

STATE OF ILLINOIS  
DEPARTMENT OF TRANSPORTATION  
DIVISION OF HIGHWAYS  
**PROPOSED  
HIGHWAY PLANS**

FAP ROUTE 662 (IL 4)  
SECTION (D) CR

CULVERT REPLACEMENT  
MACOUPIN COUNTY

C-96-049-11

D-96-049-11

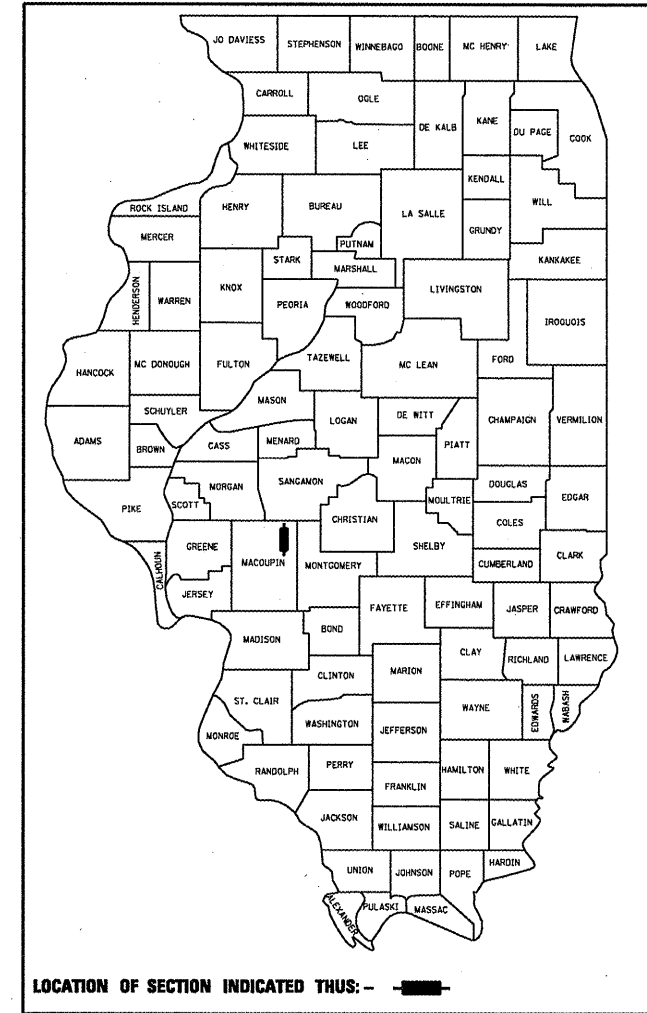

**INDEX OF SHEETS**

COVER SHEET	1
GENERAL NOTES	2
SUMMARY OF QUANTITIES	3
PLAN VIEW	4
CULVERT CROSS SECTION	5

**STANDARDS**

000001 - 06  
001006  
442201 - 03  
542301 - 03  
701201 - 04  
701901 - 01

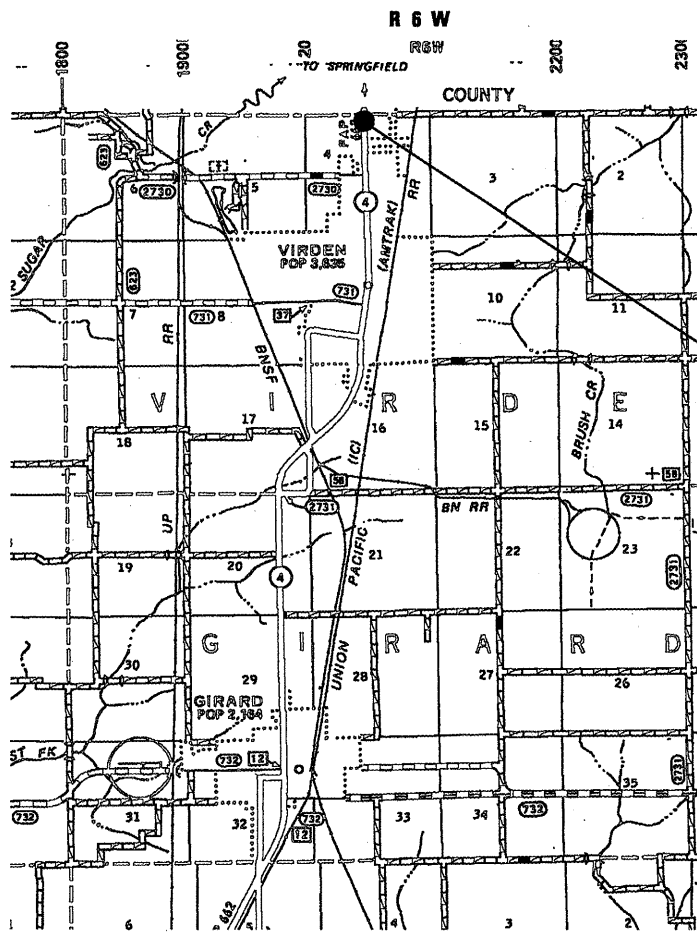

GROSS LENGTH = 30.0 FT. = 0.01 MILE  
NET LENGTH = 30.0 FT. = 0.01 MILE

CULVERT REPLACEMENT  
IL 4 S. OF SANGAMON CO. LINE  
STA. 248 + 55

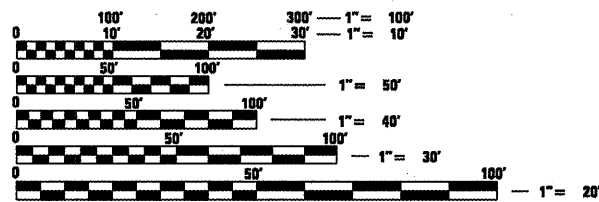

FULL SIZE PLANS HAVE BEEN PREPARED USING STANDARD ENGINEERING SCALES. REDUCED SIZED PLANS WILL NOT CONFORM TO STANDARD SCALES. IN MAKING MEASUREMENTS ON REDUCED PLANS, THE ABOVE SCALES MAY BE USED.

J.U.L.I.E.  
JOINT UTILITY LOCATION INFORMATION FOR EXCAVATION  
1-800-892-0123  
OR 811

STATE OF ILLINOIS  
DEPARTMENT OF TRANSPORTATION  
DIVISION OF HIGHWAYS

SUBMITTED *February 17, 20 11*  
*Roger Z. Dunkel*  
DEPUTY DIRECTOR OF HIGHWAYS, REGION ENGINEER

*March 4, 20 11*  
*Scott E. Still, P.E.*  
ENGINEER OF DESIGN AND ENVIRONMENT

*March 4, 20 11*  
*Christine M. Reed*  
DIRECTOR OF HIGHWAYS, CHIEF ENGINEER

**PRINTED BY THE AUTHORITY  
OF THE STATE OF ILLINOIS**

PROJECT ENGINEER: JOHN NEGANGARD (217) 782-6990  
SQUAD LEADER: MARK DUST (217) 785-0597

CONTRACT NO. 72E21

ADT = 7700 (2009)  
PV = 7350 (95.5%)  
SU = 225 (2.9%)  
MU = 125 (1.6%)

**GENERAL NOTES**

- 1 ALL ELEVATIONS SHOWN IN THE PLANS ARE U.S.G.S. MEAN SEA LEVEL DATUM.
- 2 ANY REFERENCE TO STANDARDS THROUGHOUT THE PLANS SHALL BE INTERPRETED TO BE THE LATEST STANDARDS OF THE DEPARTMENT AS INCLUDED IN THE BACK OF THE PLANS.
- 3 SEEDING WILL NOT BE PERMITTED AT ANY TIME WHEN THE GROUND IS FROZEN, WET OR IN AN UNTILLABLE CONDITION. AREAS TO BE SEEDED SHALL BE DETERMINED BY THE ENGINEER.
- 4 EXISTING PAVEMENT DAMAGED DUE TO THE CONTRACTOR'S OPERATIONS, AND NOT OTHER WISE NECESSARY TO REPLACE, SHALL BE REPLACED AT THE EXPENSE OF THE CONTRACTOR.
- 5 THE LOCATIONS OF THOSE BURIED AND ABOVE GROUND UTILITIES SHOWN ARE APPROXIMATE. THE CONTRACTOR SHALL BE RESPONSIBLE FOR PROTECTING UTILITY PROPERTY FROM CONSTRUCTION OPERATIONS AS OUTLINE IN ARTICLE 107.26 OF THE STANDARD SPECIFICATIONS. THE J.U.L.I.E. NUMBER IS 800-892-0123. A MINIMUM OF FORTY-EIGHT HOURS ADVANCED NOTICE IS REQUIRED.
- 6 THE EXISTING ROAD SIGNS THAT INTERFERE WITH CONSTRUCTION SHALL BE RELOCATED AS DIRECTED BY THE ENGINEER. AFTER THE CONSTRUCTION IS COMPLETED, THE CONTRACTOR WILL REPLACE THE SIGNS AS DIRECTED BY THE ENGINEER. THIS WORK WILL NOT BE PAID FOR SEPARATELY BUT SHALL BE CONSIDERED INCIDENTAL TO THE CONTRACT.
- 7 ABANDONED UNDERGROUND UTILITIES THAT CONFLICT WITH CONSTRUCTION SHALL BE DISPOSED OUTSIDE THE LIMITS OF RIGHT-OF-WAY ACCORDING TO ARTICLE 202.03 OF THE STANDARDS SPECIFICATIONS AND AS DIRECTED BY THE ENGINEER. THIS WORK WILL NOT BE PAID FOR SEPARATELY BUT SHALL BE CONSIDERED INCLUDED IN THE COST OF EARTH EXCAVATION AND NO ADDITIONAL COMPENSATION WILL BE ALLOWED.
- 8 WHERE SECTION OR SUBSECTION MONUMENTS ARE ENCOUNTERED THE DEPARTMENT SHALL BE NOTIFIED BEFORE SUCH MONUMENTS ARE REMOVED. THE CONTRACTOR SHALL PROTECT AND CAREFULLY PRESERVE ALL PROPERTY MARKERS AND MONUMENTS UNTIL THE OWNER AND AUTHORIZED SURVEYOR OR AGENT HAS WITNESSED OR OTHERWISE REFERENCED THEIR LOCATION. IF THE ENGINEER DECIDES TO HAVE THE CONTRACTOR RESET THE MONUMENT, THIS WORK WILL BE PAID FOR IN ACCORDANCE WITH ARTICLE 109.04.
- 9 THE FOLLOWING APPLICATION RATES WERE USED FOR QUANTITY CALCULATIONS.

AGGREGATE ITEMS	2.05 TON / CU YD
HOT-MIX ASPHALT BINDER COURSE, IL-9.5, N**	112 lbs/sq. yd. Inch
HOT-MIX ASPHALT SURFACE COURSE, MIX "--", N**	112 lbs/sq. yd. Inch
HOT-MIX ASPHALT SHOULDER	112 lbs/sq. yd. Inch
INCIDENTAL HMA SURFACE	112 lbs/sq. yd. Inch
AGGREGATE (PRIME COAT)	0.002 TON / SQ YD
BITUMINOUS MATERIAL (PRIME COAT) (ON BITUMINOUS)	0.00038 TON / SQ YD
BITUMINOUS MATERIAL (PRIME COAT) (ON AGGREGATE)	0.001425 TON / SQ YD
NITROGEN	90 LBS / ACRE
PHOSPHOROUS	90 LBS / ACRE
POTASSIUM	90 LBS / ACRE
MULCH	2 TON / ACRE
AGRICULTURAL GROUND LIMESTONE	2.0 TON / ACRE
TEMPORARY EROSION CONTROL SEEDING	100 LB / ACRE
RIPRAP	1.75 TON / CU YD

10 THE FOLLOWING MIXTURE REQUIREMENTS ARE APPLICABLE FOR THIS PROJECT.

MIXTURE USES:	PATCHING
PG:	PG 62-22
DESIGN AIR VOIDS:	4.0% @ N70
MIXTURE COMPOSITION:	IL 19.0
FRICTION AGGREGATE:	N/A

**COMMITMENTS**

THE RESIDENT ENGINEER SHALL CONTACT STUDIES & PLANS CONCERNING ANY MAJOR PLAN CHANGE, TO MAKE SURE NO PREVIOUS COMMITMENTS (NOT LISTED) WERE MADE AFFECTING THE DESIGN AND ALLOW AN IMPROVED DESIGN FOR FUTURE PROJECTS.

<b>DISTRICT SIX</b>	
EXAMINED <u>FEB 17</u> 20 <u>11</u>	<i>Chris Walker</i>
OPERATIONS ENGINEER	
EXAMINED <u>FEB 16</u> 20 <u>11</u>	<i>Tommy Furt</i>
PROJECT IMPLEMENTATION ENGINEER	
EXAMINED <u>FEBRUARY 17</u> 20 <u>11</u>	<i>John C. W. Ryan</i>
PROGRAM DEVELOPMENT ENGINEER	

SUMMARY OF QUANTITIES		UNITS	TOTAL QUANTITY	100% STATE
CODE NUMBER	ITEM			CONSTR. CODE
				0040
28100207	STONE RIPRAP, CLASS A4	TON	11	11
28200200	FILTER FABRIC	SQ YD	13	13
44200144	PAVEMENT PATCHING, TYPE II, 12 INCH	SQ YD	25	25
50105220	PIPE CULVERT REMOVAL	FOOT	47	47
50104400	CONCRETE HEADWALL REMOVAL	EACH	2	2
542A0241	PIPE CULVERTS, CLASS A, TYPE 136"	FOOT	41	41
54213681	PRECAST REINFORCED CONCRETE FLARED END SECTIONS 36"	EACH	2	2
59300100	CONTROLLED LOW-STRENGTH MATERIAL	CU YD	30	30
67100100	MOBILIZATION	L SUM	1	1
70100450	TRAFFIC CONTROL AND PROTECTION, STANDARD 701201	L SUM	1	1

BM UEL218C: USGS BENCHMARK. CHISLED SQUARE IN CENTER OF WEST CONCRETE HEADWALL OF 36" CMP UNDER IL 4 & LOCATED 42 FT SOUTH OF MONTGOMERY ROAD AT NORTH EDGE OF VIRDEN  
 STA. 248+66.8; 23.6' RT ELEV. = 650.760

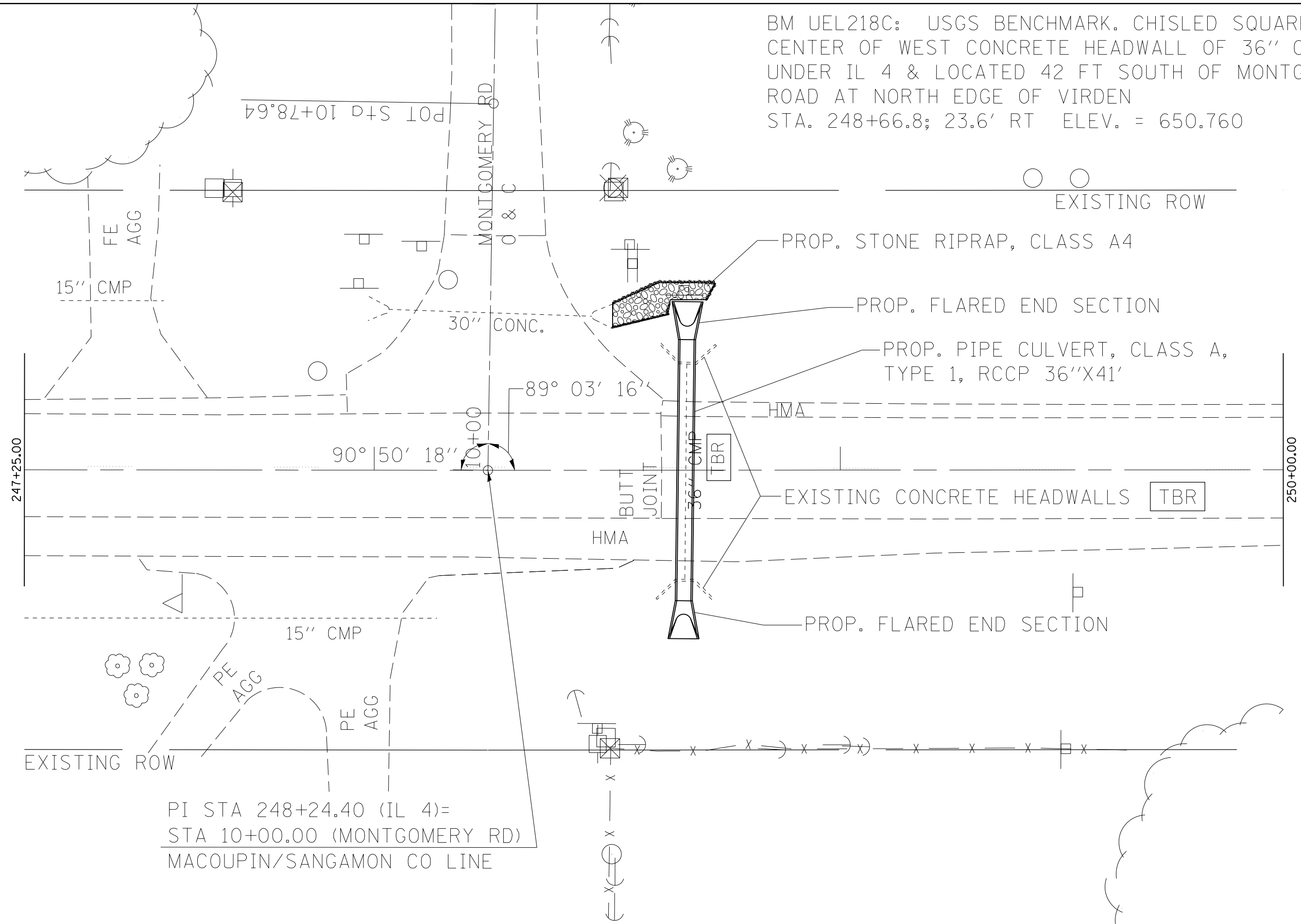

PI STA 248+24.40 (IL 4) =  
 STA 10+00.00 (MONTGOMERY RD)  
 MACOUPIN/SANGAMON CO LINE

FILE NAME =	USER NAME = laughl1n1	DESIGNED -	REVISED -
et:\pwork\pwork\laughl1n1\0254343\0672E21-sh:plansheets.dgn		DRAWN -	REVISED -
		CHECKED -	REVISED -
		DATE -	REVISED -

**STATE OF ILLINOIS  
 DEPARTMENT OF TRANSPORTATION**

**PLAN VIEW**

SCALE:      SHEET NO.    OF    SHEETS    STA.      TO STA.

F.A.P. RTE.	SECTION	COUNTY	TOTAL SHEETS	SHEET NO.
662	(D)CR	MACOUPIN	5	4
CONTRACT NO. 72E21				
ILLINOIS FED. AID PROJECT				

DATE	
BY	
FINAL SURVEY NO.	
SURVEYED AREAS CHECKED	
PLOTTED TEMPLATE	
NOTE BOOK	
AREAS CHECKED	

DATE	
BY	
ORIGINAL SURVEY NO.	
SURVEYED AREAS CHECKED	
PLOTTED TEMPLATE	
NOTE BOOK	
AREAS CHECKED	

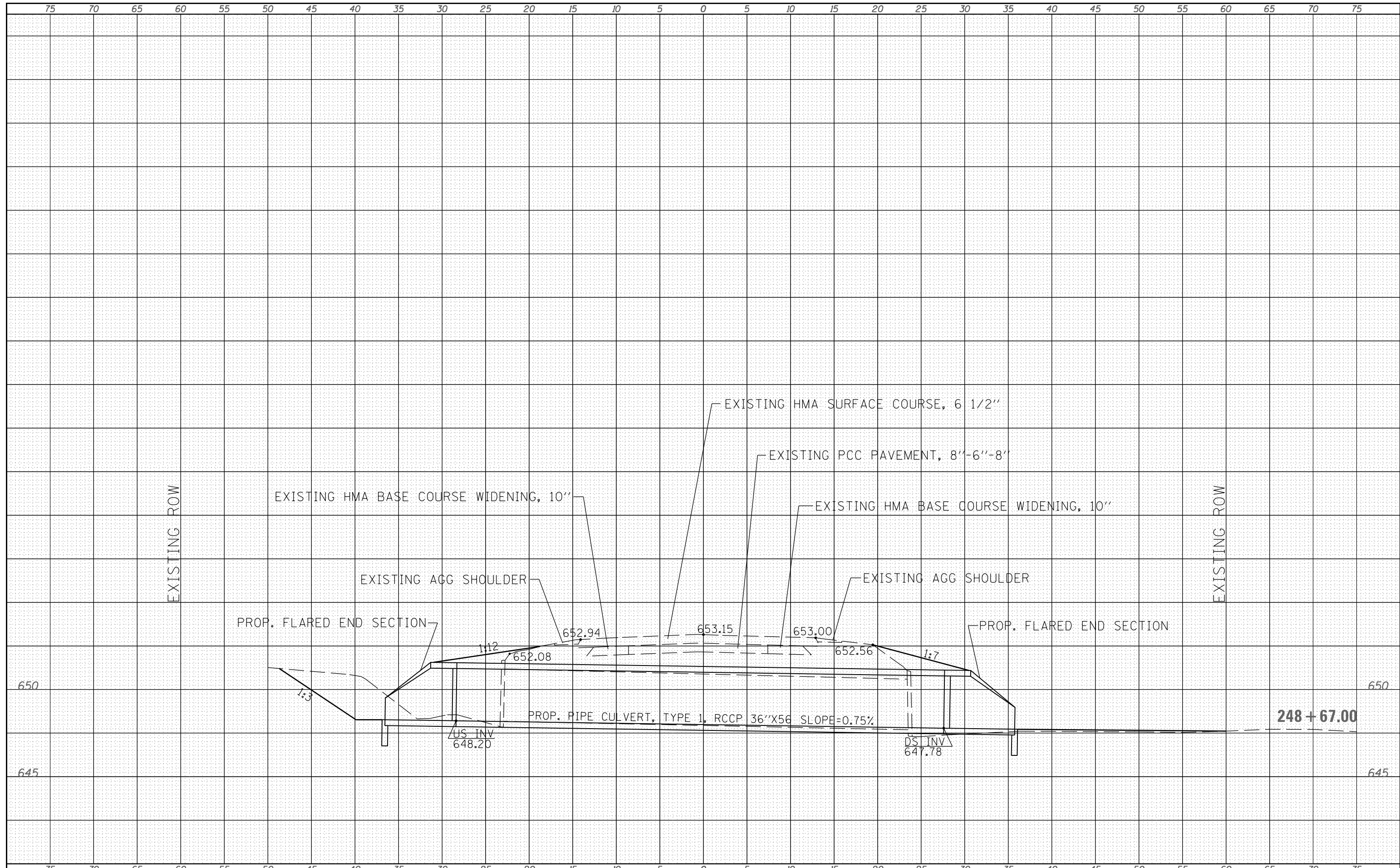

FILE NAME =	USER NAME = laughl1nr1	DESIGNED -	REVISED -	<b>STATE OF ILLINOIS DEPARTMENT OF TRANSPORTATION</b>	<b>CULVERT CROSS SECTION</b>			F.A.P. RTE. 662	SECTION (D)CR	COUNTY MACOUPIN	TOTAL SHEETS 5	SHEET NO. 5
es:\pw_work\p1dot\laughl1nr1\d0254343\0672E21-sh1t-xssh.t.dgn		DRAWN -	REVISED -		SCALE:	SHEET NO.	OF SHEETS	STA. 248+67.00	TO STA. 248+67.00	CONTRACT NO. 72E21		
PLOT SCALE = 10.0000' / in.		CHECKED -	REVISED -		ILLINOIS FED. AID PROJECT							
PLOT DATE = Feb-18-2011 10:35:13AM		DATE -	REVISED -									