

STATE OF ILLINOIS
DEPARTMENT OF TRANSPORTATION

ROUTE NO.	SECTION	COUNTY	TOTAL SHEETS	SHEET NO.
F.A.I. 57	★	COOK	75	36
FED. ROAD DIST. NO. 7	ILLINOIS	FED. AID PROJECT		

Contract 60366
★ 2122B

NORTH EDGE OF PAVEMENT

Location	Station	Offset	Theoretical Grade Elevations
Bk E Closure Pour	Sta 6+32.983	-24.000	615.462
A	Sta 6+42.983	-24.000	615.326
B	Sta 6+52.983	-24.000	615.199
Bk E Appr Pvmt	Sta 6+62.983	-24.000	615.082

NORTH LANE LINE

Location	Station	Offset	Theoretical Grade Elevations
Bk E Closure Pour	Sta 6+32.983	-12.000	615.712
A	Sta 6+42.983	-12.000	615.576
B	Sta 6+52.983	-12.000	615.449
Bk E Appr Pvmt	Sta 6+62.983	-12.000	615.332

☉ 103rd STREET & PG

Location	Station	Offset	Theoretical Grade Elevations
Bk E Closure Pour	Sta 6+32.983	0.000	615.899
A	Sta 6+42.983	0.000	615.763
B	Sta 6+52.983	0.000	615.637
Bk E Appr Pvmt	Sta 6+62.983	0.000	615.520

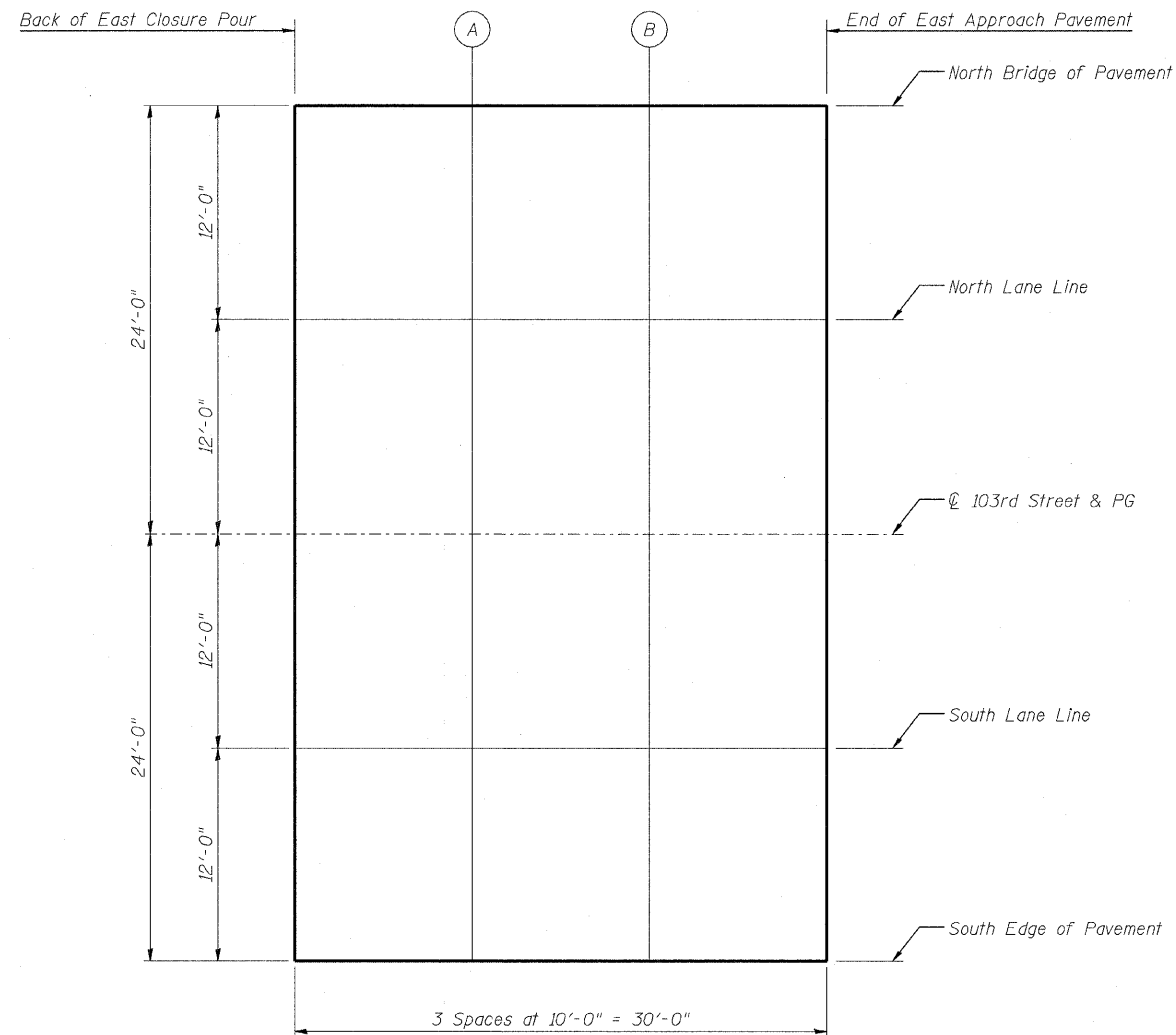

PLAN

SOUTH LANE LINE

Location	Station	Offset	Theoretical Grade Elevations
Bk E Closure Pour	Sta 6+32.983	12.000	615.712
A	Sta 6+42.983	12.000	615.576
B	Sta 6+52.983	12.000	615.449
Bk E Appr Pvmt	Sta 6+62.983	12.000	615.332

SOUTH EDGE OF PAVEMENT

Location	Station	Offset	Theoretical Grade Elevations
Bk E Closure Pour	Sta 6+32.983	24.000	615.462
A	Sta 6+42.983	24.000	615.326
B	Sta 6+52.983	24.000	615.199
Bk E Appr Pvmt	Sta 6+62.983	24.000	615.082

DESIGNED	NDR
CHECKED	DSE
DRAWN	RTT
CHECKED	DSE
DATE	JAN 16, 2009

E-AS 10-1-08

Illinois Firm Registration No. 184-00533



Stanley Consultants Inc.
850 West Higgins Road, Suite 730, Chicago, Illinois 60631-2801
www.stanleygroup.com

TOP OF EAST APPROACH SLAB ELEVATIONS
103RD STREET OVER
FAI 57 (DAN RYAN-WEST LEG)
FAI RTE 57 SECTION 2122B
COOK COUNTY
STA 5+47.40
STRUCTURE NO 016-2127

Q:\15560\06_103r\sh1\asbr00208.dgn 15 JAN 2009 9:15