

BEAM #1

Location	Station	Offset	Theoretical Grade Elevation	Theoretical Grade Elevations Adjusted For Dead Load Deflections
Bk. N. Abut.	9+20.79	29.50	646.52	646.52
☉ Brg. N. Abut.	9+18.12	29.50	646.53	646.53
A	9+08.12	29.50	646.60	646.60
B	8+98.12	29.50	646.67	646.67
C	8+88.12	29.50	646.75	646.75
☉ Pier #1	8+80.62	29.50	646.80	646.80
D	8+70.62	29.50	646.88	646.91
E	8+60.62	29.50	646.95	647.01
F	8+50.62	29.50	647.03	647.11
G	8+40.62	29.50	647.08	647.16
H	8+30.62	29.50	647.10	647.17
I	8+20.62	29.50	647.11	647.16
J	8+10.62	29.50	647.08	647.10
☉ Pier #2	8+03.12	29.50	647.05	647.05
K	7+93.12	29.50	646.98	647.02
L	7+83.12	29.50	646.89	646.96
M	7+73.12	29.50	646.77	646.87
N	7+63.12	29.50	646.63	646.74
O	7+53.12	29.50	646.46	646.56
P	7+43.12	29.50	646.27	646.35
Q	7+33.12	29.50	646.05	646.10
R	7+23.12	29.50	645.81	645.82
☉ Pier #3	7+19.87	29.50	645.73	645.73
S	7+09.87	29.50	645.45	645.45
T	6+99.87	29.50	645.15	645.15
U	6+89.87	29.50	644.88	644.88
☉ Brg. S. Abut.	6+86.62	29.50	644.80	644.80
Bk. S. Abut.	6+83.95	29.50	644.74	644.74

BEAM #2

Location	Station	Offset	Theoretical Grade Elevation	Theoretical Grade Elevations Adjusted For Dead Load Deflections
Bk. N. Abut.	9+20.64	22.94	646.61	646.61
☉ Brg. N. Abut.	9+17.97	22.94	646.63	646.63
A	9+07.97	22.94	646.70	646.70
B	8+97.97	22.94	646.77	646.77
C	8+87.97	22.94	646.85	646.85
☉ Pier #1	8+80.47	22.94	646.90	646.90
D	8+70.47	22.94	646.98	647.01
E	8+60.47	22.94	647.05	647.11
F	8+50.47	22.94	647.12	647.20
G	8+40.47	22.94	647.18	647.26
H	8+30.47	22.94	647.20	647.27
I	8+20.47	22.94	647.20	647.25
J	8+10.47	22.94	647.18	647.20
☉ Pier #2	8+02.97	22.94	647.15	647.15
K	7+92.97	22.94	647.08	647.12
L	7+82.97	22.94	646.99	647.06
M	7+72.97	22.94	646.87	646.97
N	7+62.97	22.94	646.72	646.83
O	7+52.97	22.94	646.56	646.66
P	7+42.97	22.94	646.36	646.44
Q	7+32.97	22.94	646.15	646.20
R	7+22.97	22.94	645.90	645.91
☉ Pier #3	7+19.72	22.94	645.82	645.82
S	7+09.72	22.94	645.54	645.54
T	6+99.72	22.94	645.25	645.25
U	6+89.72	22.94	644.97	644.97
☉ Brg. S. Abut.	6+86.47	22.94	644.90	644.90
Bk. S. Abut.	6+83.80	22.94	644.84	644.84

BEAM #3

Location	Station	Offset	Theoretical Grade Elevation	Theoretical Grade Elevations Adjusted For Dead Load Deflections
Bk. N. Abut.	9+20.50	16.39	646.71	646.71
☉ Brg. N. Abut.	9+17.83	16.39	646.73	646.73
A	9+07.83	16.39	646.80	646.80
B	8+97.83	16.39	646.87	646.87
C	8+87.83	16.39	646.95	646.95
☉ Pier #1	8+80.33	16.39	647.00	647.00
D	8+70.33	16.39	647.08	647.11
E	8+60.33	16.39	647.15	647.21
F	8+50.33	16.39	647.22	647.30
G	8+40.33	16.39	647.27	647.35
H	8+30.33	16.39	647.30	647.37
I	8+20.33	16.39	647.30	647.35
J	8+10.33	16.39	647.28	647.30
☉ Pier #2	8+02.83	16.39	647.24	647.24
K	7+92.83	16.39	647.17	647.21
L	7+82.83	16.39	647.08	647.15
M	7+72.83	16.39	646.96	647.06
N	7+62.83	16.39	646.82	646.93
O	7+52.83	16.39	646.65	646.75
P	7+42.83	16.39	646.46	646.54
Q	7+32.83	16.39	646.24	646.29
R	7+22.83	16.39	646.00	646.01
☉ Pier #3	7+19.58	16.39	645.92	645.92
S	7+09.58	16.39	645.64	645.64
T	6+99.58	16.39	645.34	645.34
U	6+89.58	16.39	645.07	645.07
☉ Brg. S. Abut.	6+86.33	16.39	644.99	644.99
Bk. S. Abut.	6+83.66	16.39	644.93	644.93

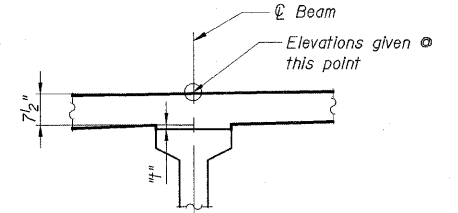

FILLET HEIGHTS

To determine "f": after all beams have been erected, elevations of the top flanges of the beams shall be taken at intervals show below. These elevations subtracted from the "Theoretical Grade Elevations Adjusted For Dead Load Deflection" show on sheets S4 thru S6, minus deck thickness, equals the fillet heights "f" above top flange on beams.

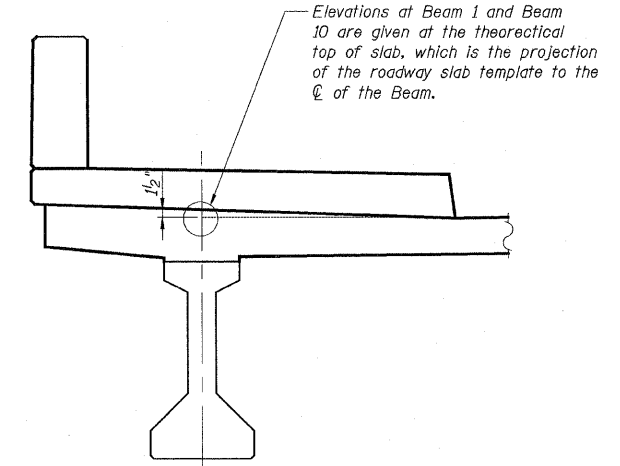

LOCATION OF ELEVATIONS AT EDGE OF BEAMS

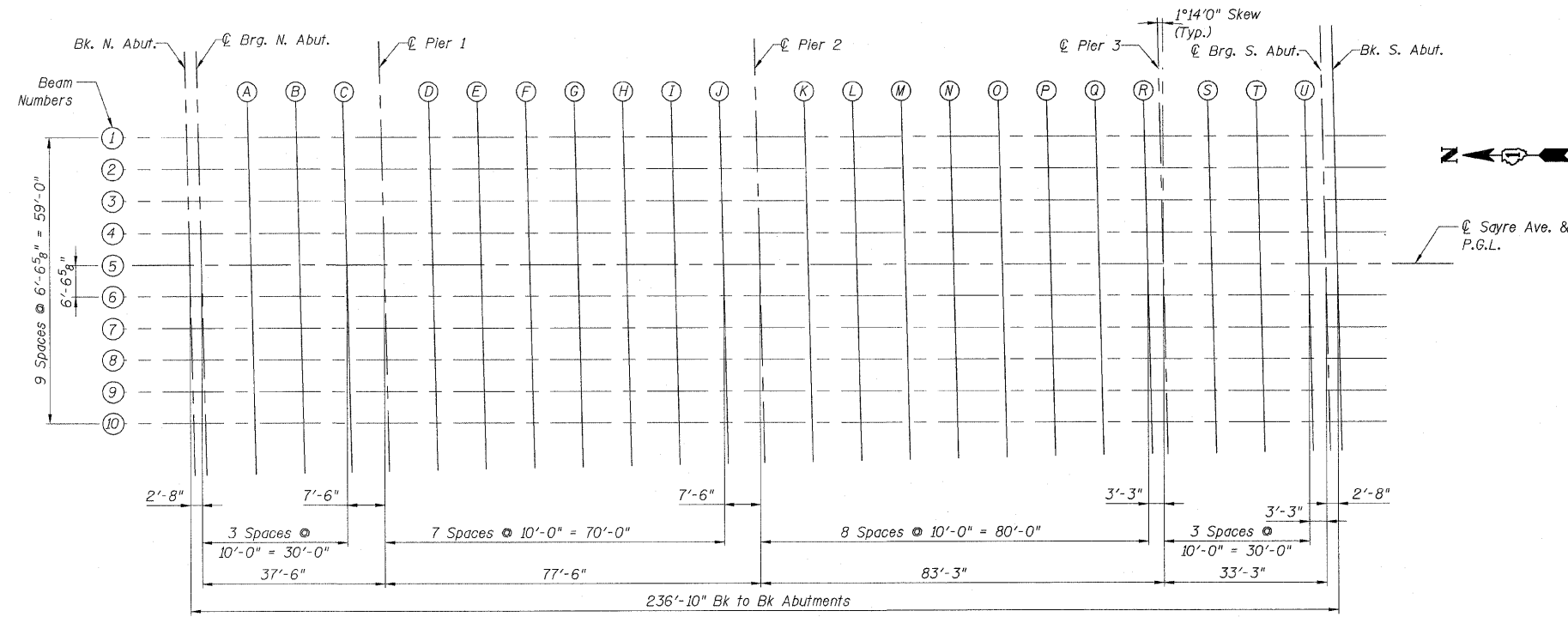

PLAN

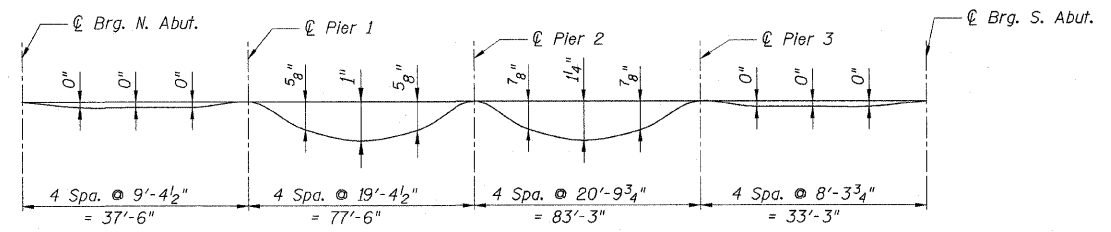

DEAD LOAD DEFLECTION DIAGRAM

(Includes weight of cast-in-place concrete only)

Note: The above deflections are not to be used in the field if the engineer is working from the grade elevations adjusted for dead load dereflections as shown above.

REVISIONS	
NAME	DATE

ILLINOIS DEPARTMENT OF TRANSPORTATION
 TOP OF DECK SLAB ELEVATIONS I
 FA ROUTE 173 (SAYRE AVENUE) OVER
 INTERSTATE 90 (KENNEDY EXPRESSWAY)
 COOK COUNTY STATION 8+02.48
 SECTION NO. 267-1414-15D
 STRUCTURE NO. 016-1104
 SCALE: NONE DRAWN BY: R. Clinton
 DATE: DEC. 2007 CHECKED BY: G. Hatlestad